

LOT 13, BLOCK A  
(56,556 S.F.)  
1.298 ACRES

LOT 1, BLOCK A  
M.R.P. ADDITION  
(CAB. D, SLIDE. 327)

ALLEN ANDERSON  
(VOL. 950, PG. 309)

**ROCKWALL  
PARKWAY**  
(CAB. E, SLIDE. 149)

LOT 4, BLOCK B  
HORIZON RIDGE ADDITION  
(CAB. F, SLIDE. 130)

GAIL C. PARKHILL, ET AL  
(VOL. 3649, PG. 232)

$\Delta=9^{\circ}10'15''$   
 $R=915.00'$   
 $L=146.46'$   
 $T=73.38'$   
 $CB=N 26^{\circ}44'10'' E$   
 $CD=146.30'$

LOT 5, BLOCK B  
HORIZON RIDGE ADDITION  
(CAB. F, SLIDE. 130)

ARKOMA REALTY LTD.  
(VOL. 1753, PG. 263)

LOT 9, BLOCK A  
HORIZON RIDGE CENTER  
(CAB. E, SLIDE. 149)

CITY OF ROCKWALL  
(VOL. 1738, PG. 8)

LOT 11, BLOCK A  
(235,474 S.F.)  
5.406 ACRES

LOT 10, BLOCK A  
(586,563 S.F.)  
13.466 ACRES

LOT 12, BLOCK A  
(36,949 S.F.)  
0.848 ACRES

**SUMMER LEE DRIVE**  
(CAB. G, SLIDE 11 & 12)

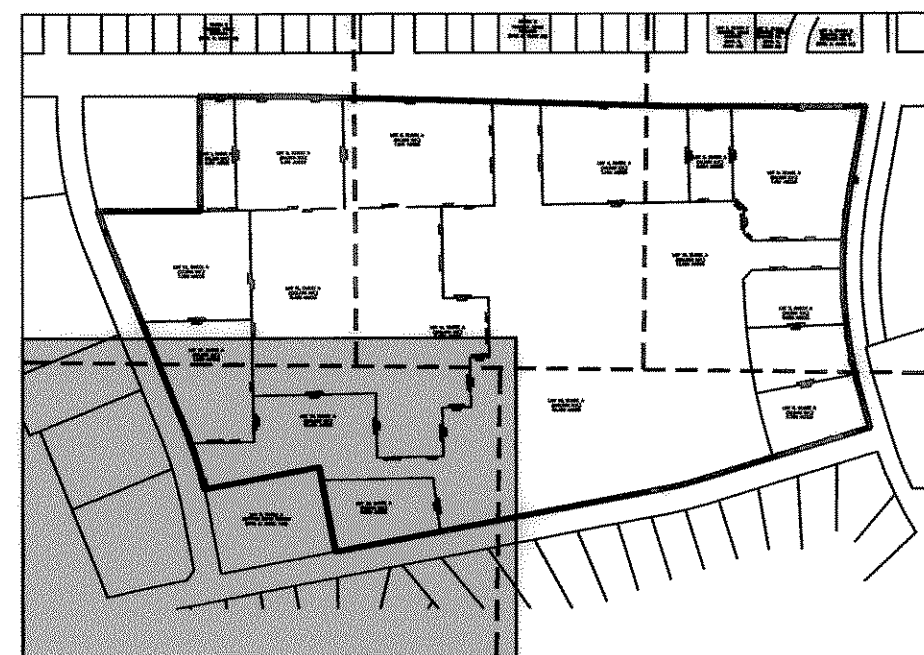

**KEY MAP**  
SHEET 5 OF 5

BLOCK E  
FOXCHASE  
PHASE V ADDITION  
(CAB. D, PG. 110)

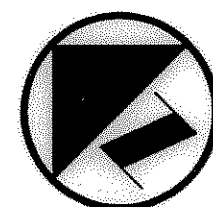

SHEET 5 OF 7  
FINAL PLAT  
**LOT'S 1 THRU 14, BLOCK A  
PRESBYTERIAN HOSPITAL  
OF ROCKWALL ADDITION**  
33.201 ACRES, ZONED GR  
LOCATED IN THE CITY OF ROCKWALL, TEXAS  
AND BEING OUT OF THE  
EDWARD TEAL SURVEY, ABSTRACT NO. 207,  
ROCKWALL COUNTY, TEXAS

<b>Pacheco Koch Consulting Engineers</b>				
8350 N. CENTRAL EXPWY. SUITE 1000 DALLAS, TX. 75206 972.235.3031				
<b>DRAWN BY</b>	<b>CHECKED BY</b>	<b>SCALE</b>	<b>DATE</b>	<b>JOB NUMBER</b>
RRL	EMH	1"=50'	09/06/2006	1567-06.023

Presbyterian Hospital of  
Rockwall Addition  
Page 5

PRESBYTERIAN HOSPITAL OF ROCKWALL

546