

IRRIGATION PLAN

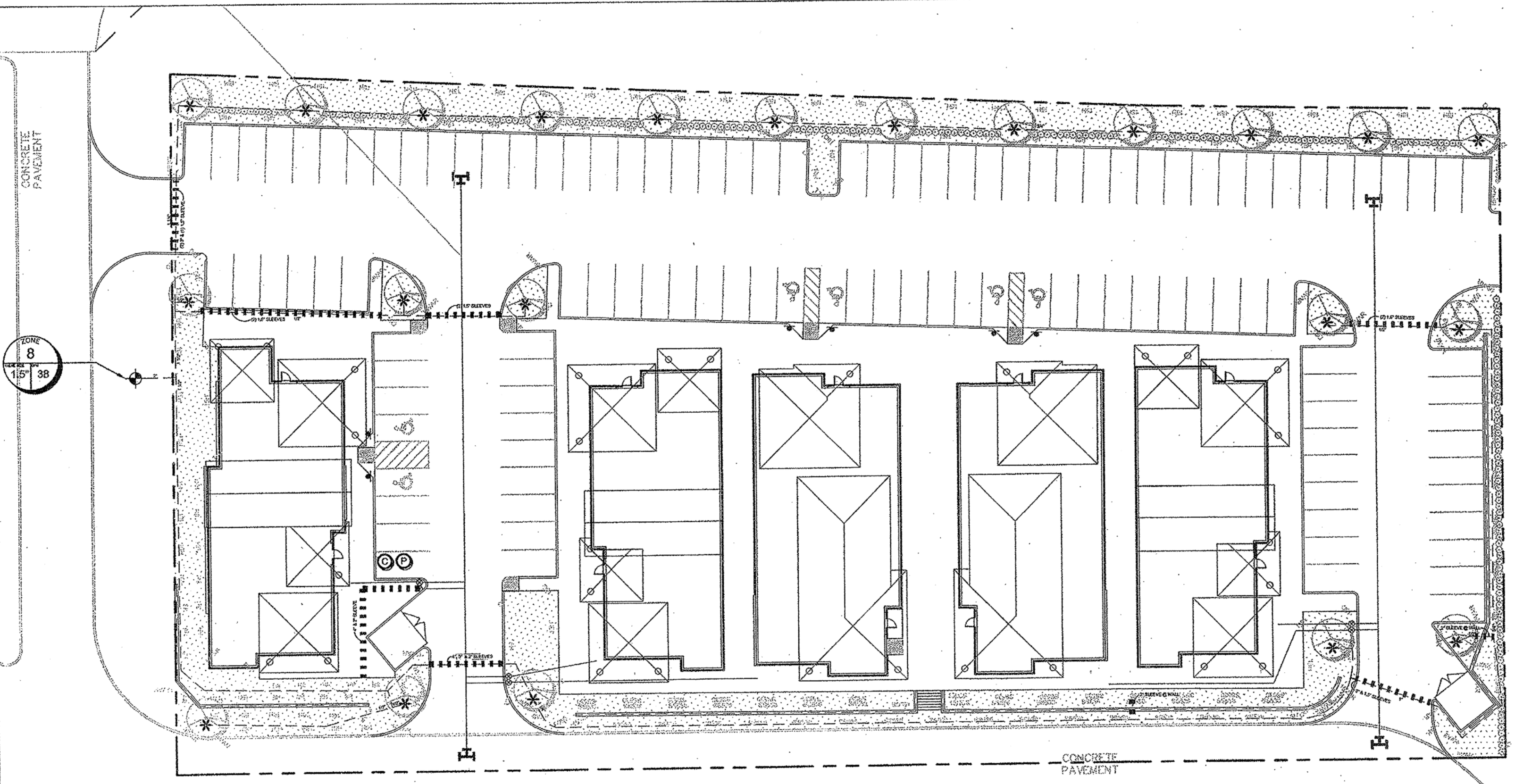

TREE BUBBLER PLAN

SPRAY HEAD LEGEND AND NOZZLE CHART						
Symbol	MFR	DESCRIPTION	Nozzle Type	Radius ft.	PSI	Flow GPM
●	RAIN BIRD	360° Arc 1806-PRS-F.C. (6" POP-UP SPRAY) Installed Using 1" x 12" PVC Flex Pipe.	15F	15'	30	3.70
			12F	12'	30	2.80
			10F	10'	30	1.99
			8F	8'	30	1.05
●	RAIN BIRD	180° Arc 1806-PRS-H (6" POP-UP SPRAY) Installed Using 1" x 12" PVC Flex Pipe.	15F	15'	30	1.85
			12F	12'	30	1.42
			10F	10'	30	0.97
			8F	8'	30	0.48
●	RAIN BIRD	90° Arc 1806-PRS-Q (6" POP-UP SPRAY) Installed Using 1" x 12" PVC Flex Pipe.	15F	15'	30	0.93
			12F	12'	30	0.71
			10F	10'	30	0.49
			8F	8'	30	0.24
●	RAIN BIRD	Adj° Arc 1806-PRS-VAN (6" POP-UP SPRAY) Installed Using 1" x 12" PVC Flex Pipe.	15VAN	15'	30	Varies
			12VAN	12'	30	Varies
			10VAN	10'	30	Varies
			8VAN	8'	30	Varies
●	RAIN BIRD	Strips 1806-PRS-STRIPS (6" POP-UP SPRAY) Installed Using 1" x 12" PVC Flex Pipe.	16LCS	4" x 16"	30	48
			15CS	4" x 30"	30	130
			15CS	4" x 30"	30	121
			15ST	4" x 16"	30	85
●	RAIN BIRD	Bubblers 1300 A-F (6" POP-UP SPRAY) Installed Using 1" x 12" PVC Flex Pipe.	1300 A-F	6"	30	1.7
			1300 A-F	6"	30	1.7

PIPE, VALVE AND EQUIPMENT		
Symbol	MFR	DESCRIPTION
⊗	RAIN BIRD	PESB Series electric remote-control valve & a line size PVC ball valve installed in a Rain Bird VB-STD-L valve box. (refer to valve ID on plan for size).
⊗	MATCO	Line size brass gate valve installed in Rain Bird VB-10RND valve box.
⊗	HUNTER	CC - 80D-PL 8-Station Base Unit Controller with Plastic Cabinet. Installed per manufacturer specifications at this approximate location.
⊗	EXISTING	2" Water Meter as specified by the project engineer and approved by City. Refer to plans by ECDLP.
⊗	APPROVED	PVC SCH. 40 IPS Plastic Pipe "Mainline". Location shown on plan is approximate and shall be field located with owners rep. approval.
⊗	APPROVED	PVC SCH. 40 IPS Plastic Pipe "Lateral line". Location shown on plan is approximate and shall be field located.
⊗	APPROVED	PVC SCH. 40 IPS Plastic Pipe "Sleeve". Size shall be twice the dia. of the required inner pipe.
⊗	NETAFIM	TLCV-8-12 In-line pressure compensating drip tubing and accessories installed in 18" rows per manufacturer written specifications.
⊗	NETAFIM	PVC SCH. 40 IPS Plastic Pipe supply header to Netafim drip tubing connection.
⊗	NETAFIM	WTLSLOV Shut Off Valve located in a valve box with a gravel sump. Install per manufacturer written specifications.
⊗	APPROVED	Install one spare control wire from the irrigation controller to the nearest valve box located in this area.
⊗	RAIN BIRD	XGZ-100-COM Series electric remote-control zone control kit installed in Rain Bird VB-IMB-L valve box. For drip zones under 20 gpm install Rain Bird Drip Zone Control Kit # XGZ-100-B-COM per the Manufacturer specifications.

ZONE CHART		
ZONE #	TYPE	GPM
1	SPRAY	50
2	SPRAY	38
3	SPRAY	42
4	SPRAY	32
5	SPRAY	32
6	SPRAY	41
7	SPRAY	37
8	BUBBLER	38

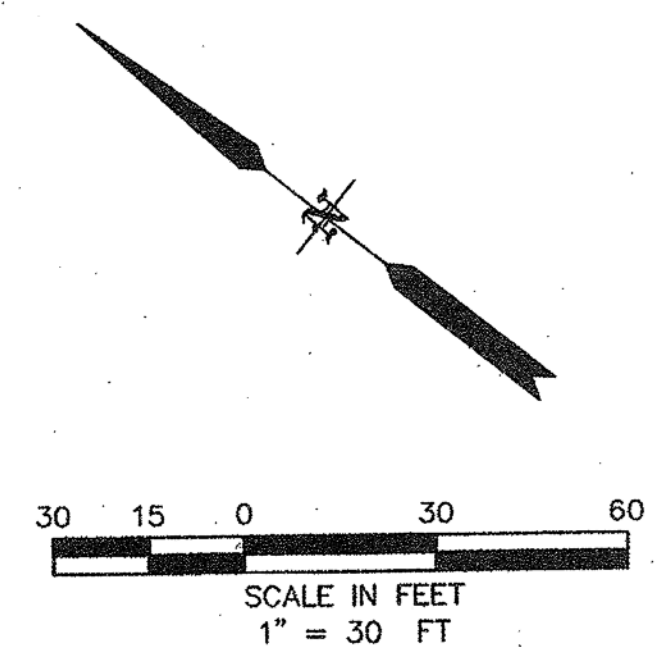

RECORD DRAWINGS
 THESE RECORD DRAWINGS HAVE BEEN PREPARED BASED ON INFORMATION PROVIDED BY OTHERS. THE ENGINEER HAS NOT VERIFIED THE ACCURACY OF THIS INFORMATION AND SHALL NOT BE RESPONSIBLE FOR ANY DISCREPANCIES WHICH MAY BE INCORPORATED HEREIN AS A RESULT.
 ENGINEERING CONCEPTS & DESIGNS, L.P.
 TODD WINTTERS, P.E. 12-11-12 DATE

RELEASED FOR CONSTRUCTION
 ALL RESPONSIBILITY FOR ADEQUACY OF DESIGN REMAINS WITH THE DESIGN ENGINEER. THE CITY OF ROCKWALL, IN REVIEWING AND RELEASING PLANS FOR CONSTRUCTION, ASSUMES NO RESPONSIBILITY FOR ADEQUACY OR ACCURACY OF DESIGN.
 CITY _____ DATE _____

ORCHID DESIGN GROUP
 Landscape Architecture
 5400 Bayou Grande Blvd NE
 St. Petersburg, Florida 33703
 Telephone: 727-773-7907
 Facsimile: 727-527-3819
 Landscape Architect of Record:
 Jarrett S. Kest
 TX License# 2482

ENGINEERING CONCEPTS & DESIGN, L.P.
 ENGINEERING / PROJECT MANAGEMENT / CONSTRUCTION SERVICES
 2801 CAPITAL, WYLIE, TX 75098
 972-941-8400 FAX: 972-941-8401 WWW.ECDLP.COM

REVISIONS:	
DRAWN: JK	DATE: 05-05-09
CHECKED: JK	DATE: 05-05-09
PROJECT NO: 9016	
DWG FILE NAME: Irrigation Plan.dwg	

THIS DOCUMENT IS RELEASED FOR THE PURPOSE OF CONSTRUCTION. THE SEAL APPEARING ON THIS DOCUMENT WAS AUTHORIZED BY JARRETT S. KEST, RLA REGISTRATION # 2482

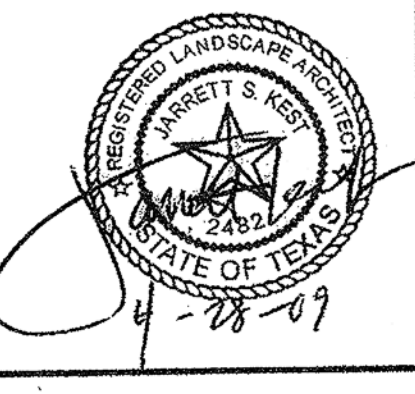

IRRIGATION PLAN
LOTS 4&5 BLK A, (PROP LOT 4R)
PRESBYTERIAN HOSPITAL ADDN.
 CITY OF ROCKWALL, ROCKWALL COUNTY, TEXAS

SHEET
IR1.0