

# CONSTRUCTION PLANS FOR THR PRESBYTERIAN HOSPITAL PARKING LOT EXPANSION

3150 HORIZON ROAD  
ROCKWALL, TX 75032  
LOT 6  
BLOCK A

**OWNER**  
TEXAS HEALTH RESOURCES  
9300 AMBERTON PKWY, SUITE 1000  
DALLAS, TX 75243  
(214) 208-1429  
RUSTY HERRON  
RUSTYHERRON@TEXASHEALTH.ORG

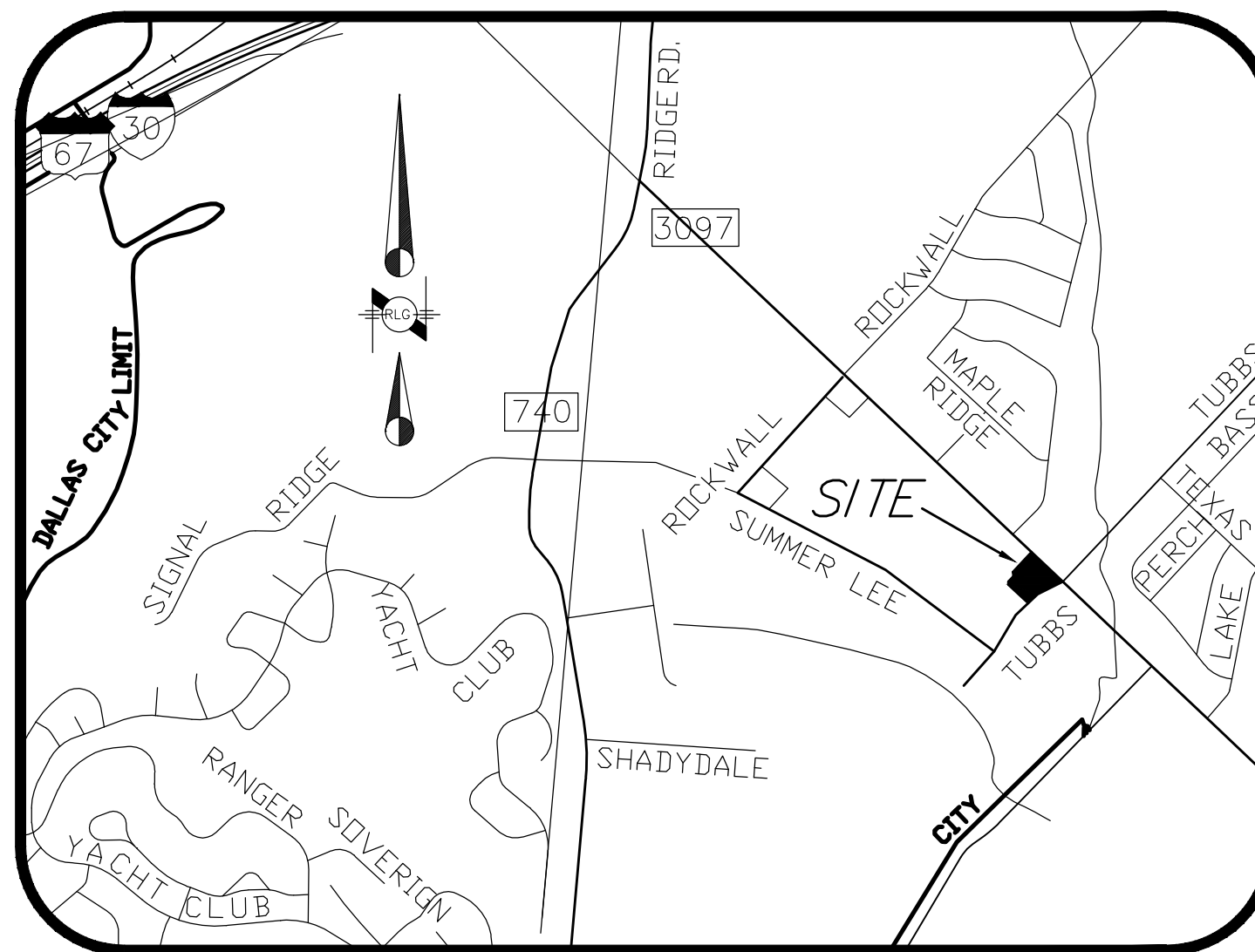

Vicinity Map  
NTS

### SHEET INDEX

- C0.00 COVER SHEET
- C0.01 COPY OF PLAT
- C1.00 TOPOGRAPHIC SURVEY
- C2.00 DEMOLITION PLAN
- C3.00 PAVING & DIMENSIONAL CONTROL PLAN
- C4.00 GRADING PLAN
- C5.00 PRE-DRAINAGE AREA MAP
- C5.01 POST-DRAINAGE AREA MAP
- C6.00 STORM & UTILITY PLAN
- C6.01 STORM SEWER PROFILES
- C7.00 EROSION CONTROL PLAN
- C8.00 GENERAL NOTES
- C9.00 DETAILS SHEET

Construction Start: January 2020



## RLG CONSULTING ENGINEERS

12001 N. CENTRAL EXPRESSWAY  
SUITE 300 DALLAS, TEXAS 75243  
(214) 739-8100  
FIRM REG: F-493  
KRUEGER BRODBECK  
KBRODBECK@RLGINC.COM

**RECORD DRAWING**  
TO THE BEST OF OUR KNOWLEDGE, RLG INC.  
HEREBY STATES THAT THESE PLANS ARE  
RECORD DRAWINGS. THIS INFORMATION IS  
BASED ON SURVEYING AT THE SITE AND  
INFORMATION PROVIDED BY THE CONTRACTOR.  
DATE: 06/18/2020

ALL RESPONSIBILITY FOR ADEQUACY OF  
DESIGN REMAINS WITH THE DESIGN ENGINEER.  
THE CITY OF ROCKWALL, IN REVIEWING AND  
RELEASING PLANS FOR CONSTRUCTION,  
ASSUMES NO RESPONSIBILITY FOR  
ADEQUACY OR ACCURACY OF DESIGN.