

SANITARY SEWER LINE 'B'

NOTE: ALL WASTEWATER PIPE LOCATED INSIDE THE CITY OF DALLAS TAKE LINE SHALL BE PVC PRESSURE RATED WASTEWATER PIPE, ASTM D2241 (SDR-26)/ASTM D3139 WITH CLASS "B-1a" OR "B-2a" EMBEDMENT.

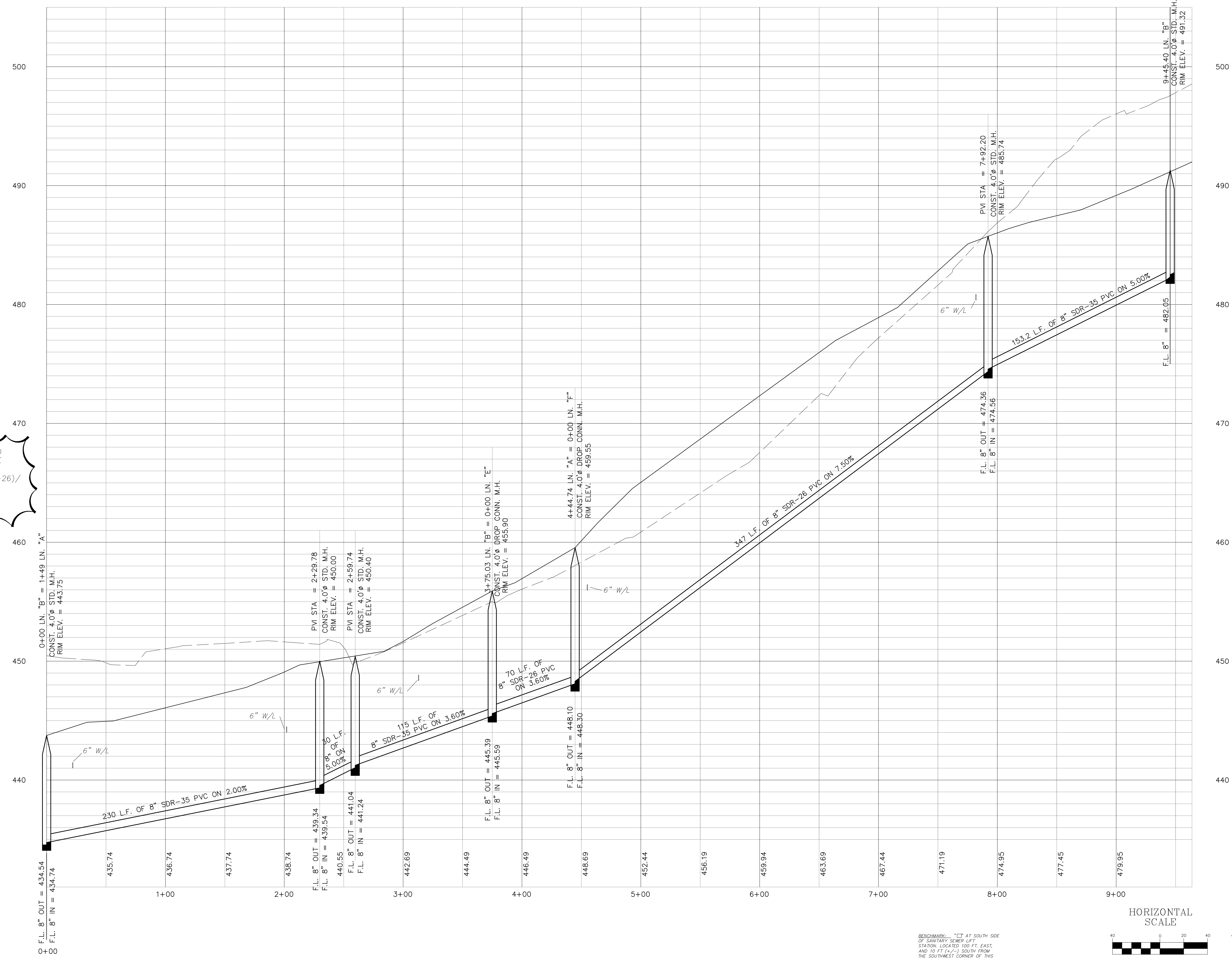

BENCHMARK: "C" AT SOUTH SIDE OF SANITARY SEWER LIFT STATION, LOCATED 100 FT. EAST, AND 10 FT. (4+7.2) SOUTH FROM THE SOUTHWEST CORNER OF THIS PROPERTY. ELEV. 450.45.

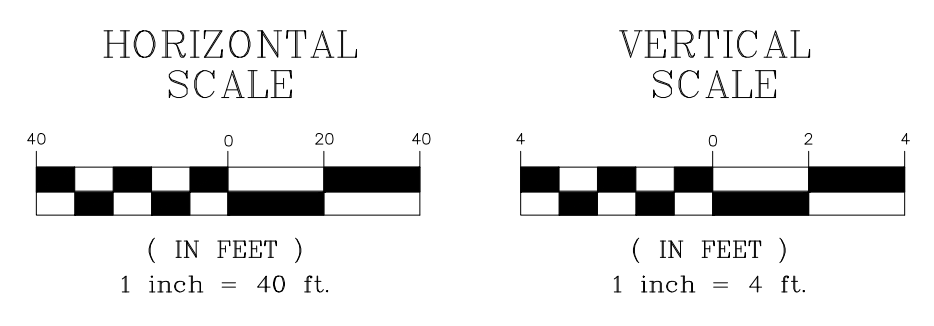

M:\proj\9953\9953SWRP2.dwg 04/10/02 09:26:03 PM CDT

REVISION	PER CITY COMMENTS	DATE
1	PER CITY COMMENTS	08/27/2001
2	PER CITY OF DALLAS	10/10/2001
3	REV'D RIM ELEV'S	04/10/2002

CHECKED BY
WLD.

DRAWN BY
WLD.

DATE
6/12/01

PROJECT NO.
9953

DRAWING NAME
9953SWRP2

SANITARY SEWER LINE PROFILE
LINE 'B'
VILLAS DE PORTOFINO PHASE 2
CITY OF ROCKWALL
COUNTY OF ROCKWALL

DOUPHRATE & ASSOCIATES, INC.
ENGINEERING • PROJECT MANAGEMENT • SURVEYING
2235 RIDGE RD., # 200 ROCKWALL, TEXAS 75087
PHONE: (972)771-9004 FAX: (972)771-9005

THE SEAL APPEARS ON THIS DOCUMENT WAS APPROVED BY
W.L. DOUPHRATE II, TEXAS P.E.
NO. 60102 ON