

NOTE: INFORMATION ON THIS SHEET AND OTHER SHEETS THROUGHOUT THIS PLAN SET IS PART OF A UNIFIED DESIGN. THE CONTRACTOR SHALL NOT SEPERATE DRAWINGS FROM THE SET FOR DISTRIBUTION TO SPECIFIC DISCIPLINES. EACH SUBCONTRACTOR SHALL BE PROVIDED WITH ALL SHEETS WITHIN THIS PLAN SET.

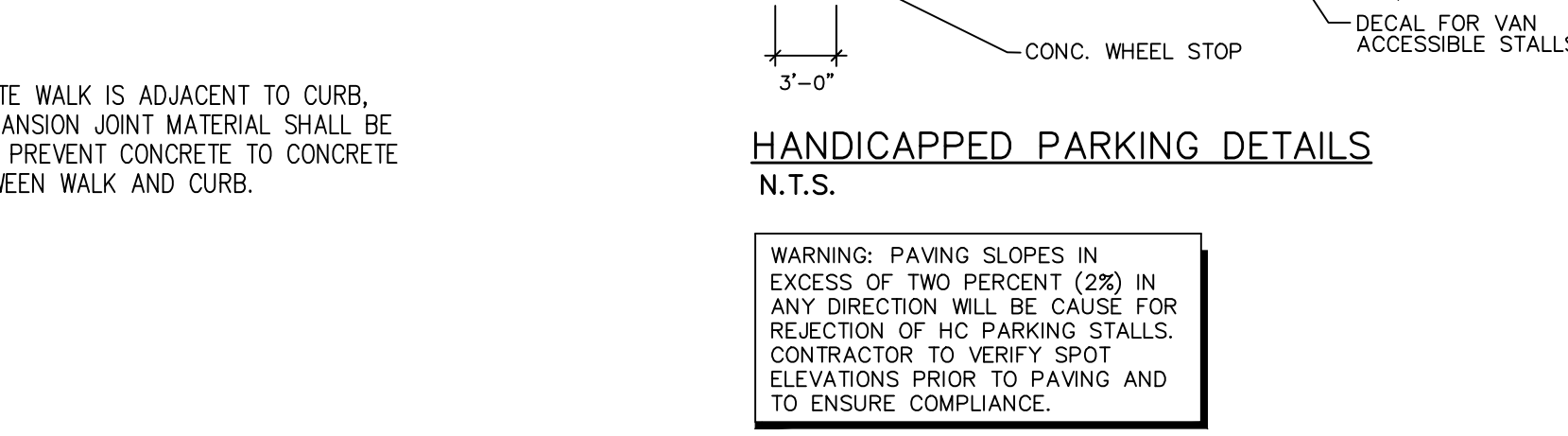
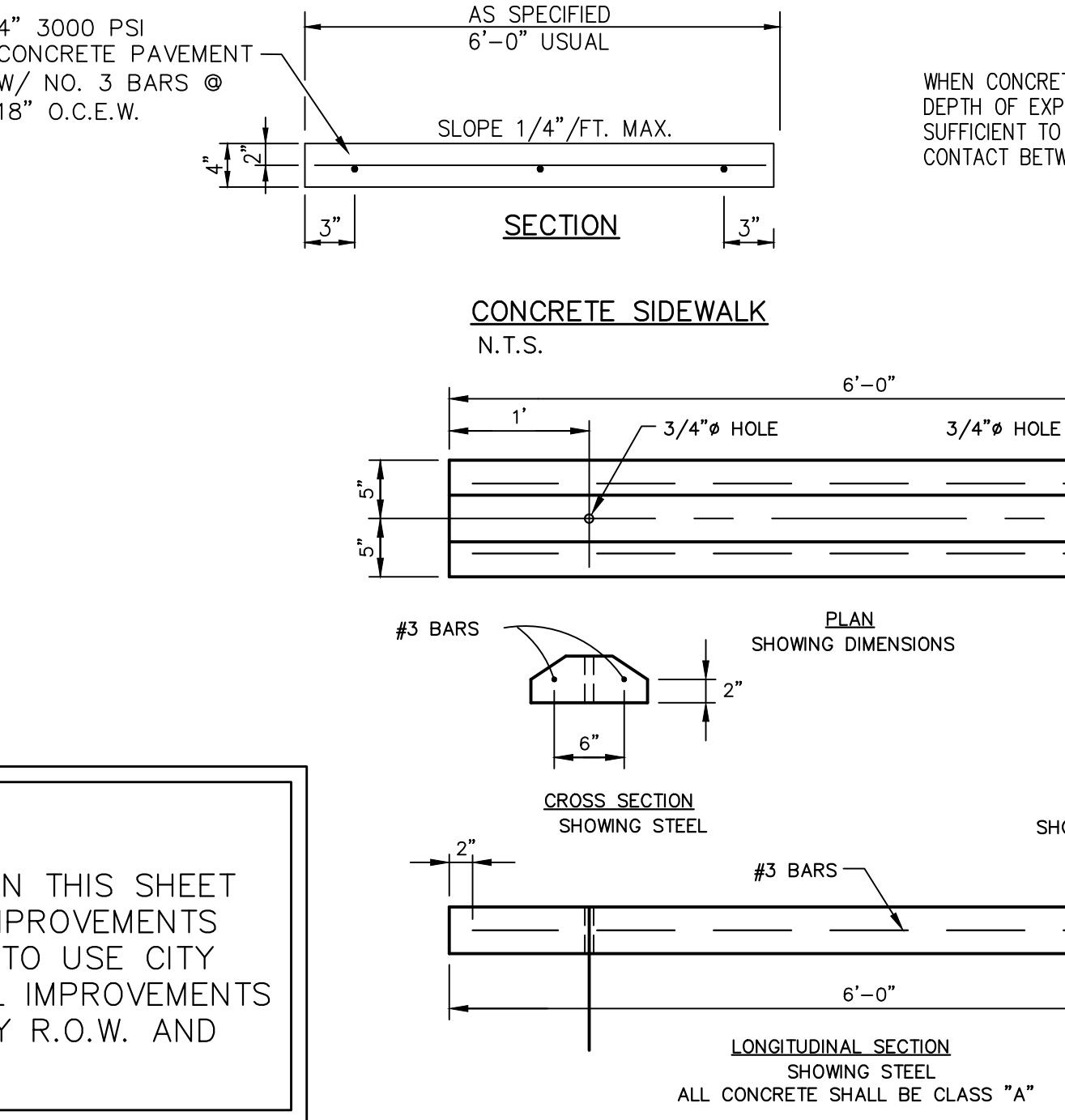
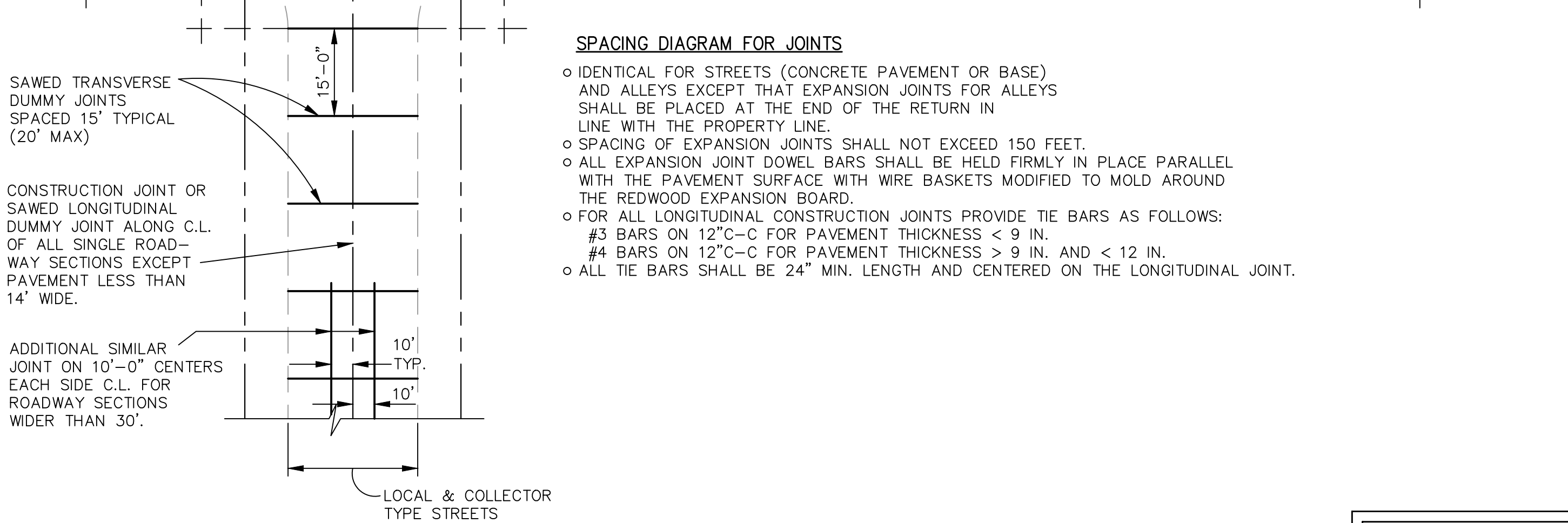
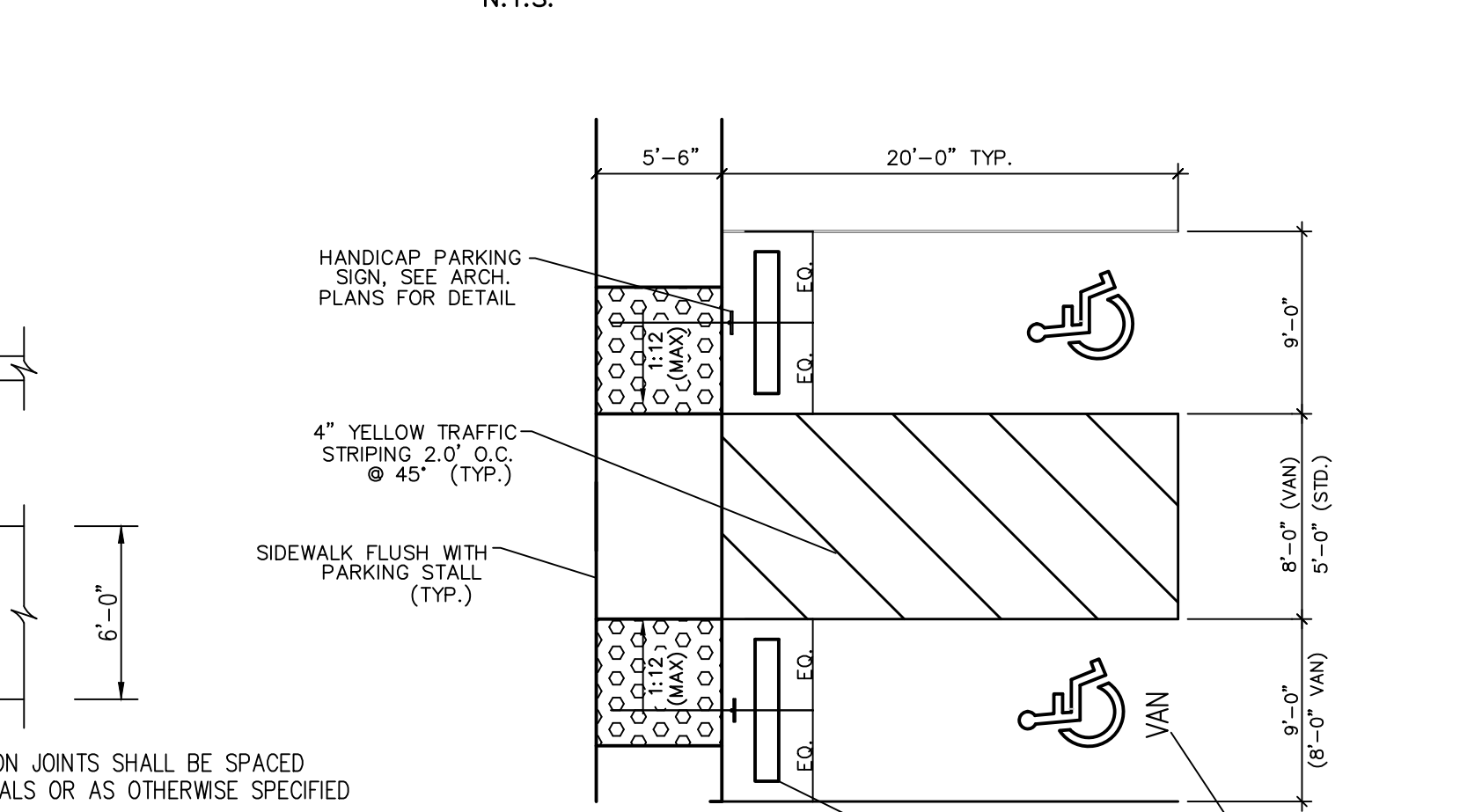
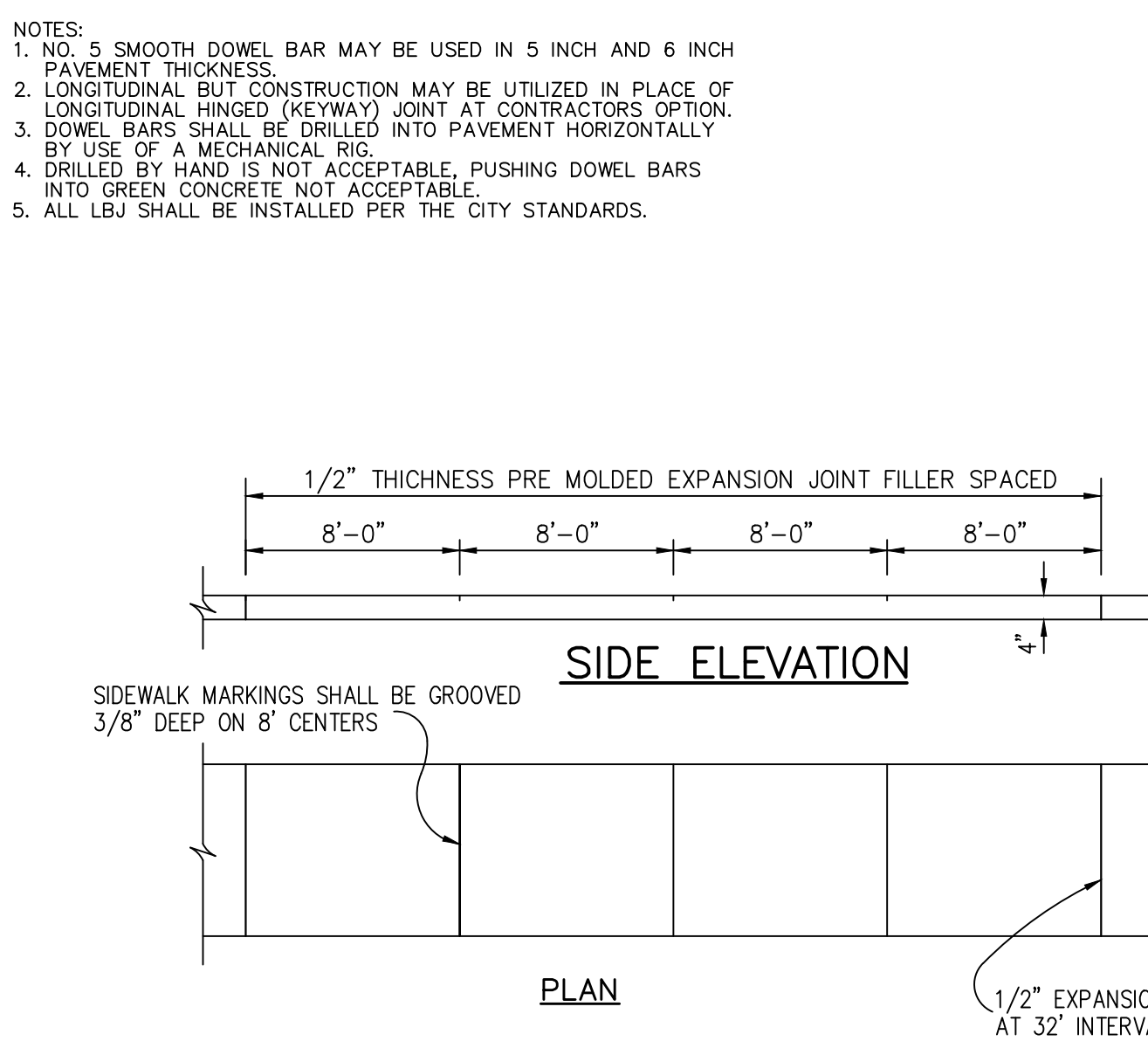
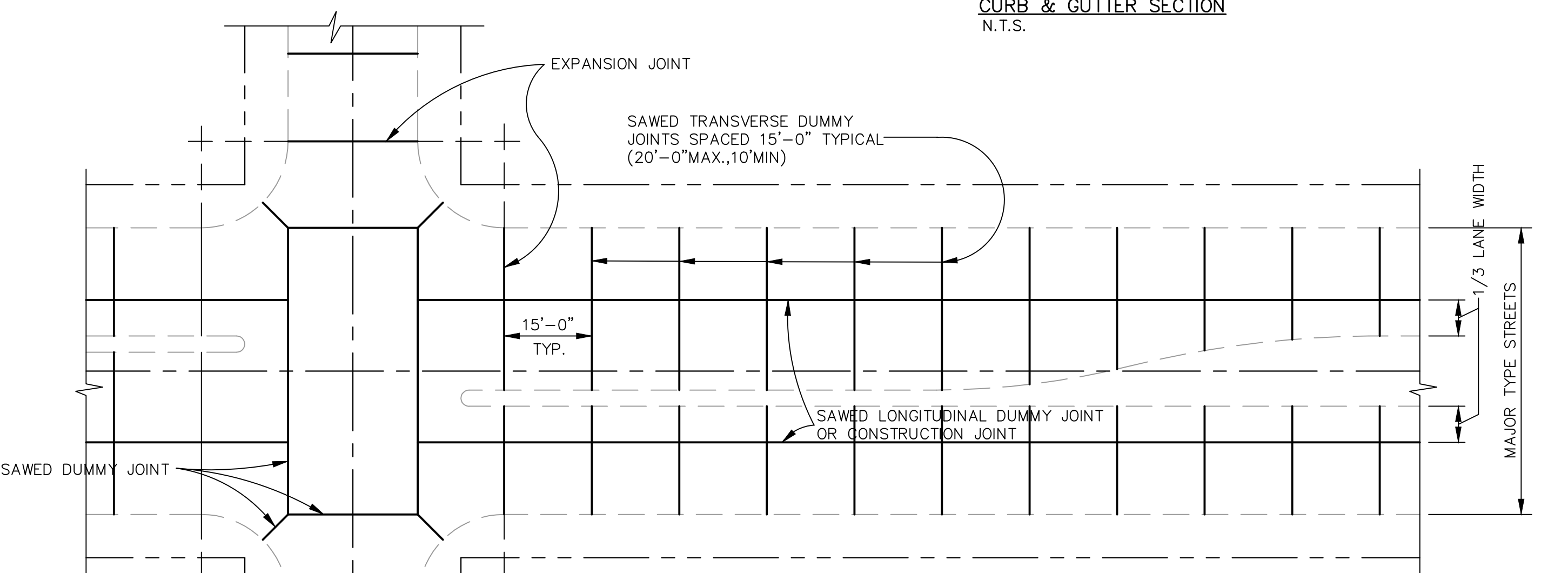
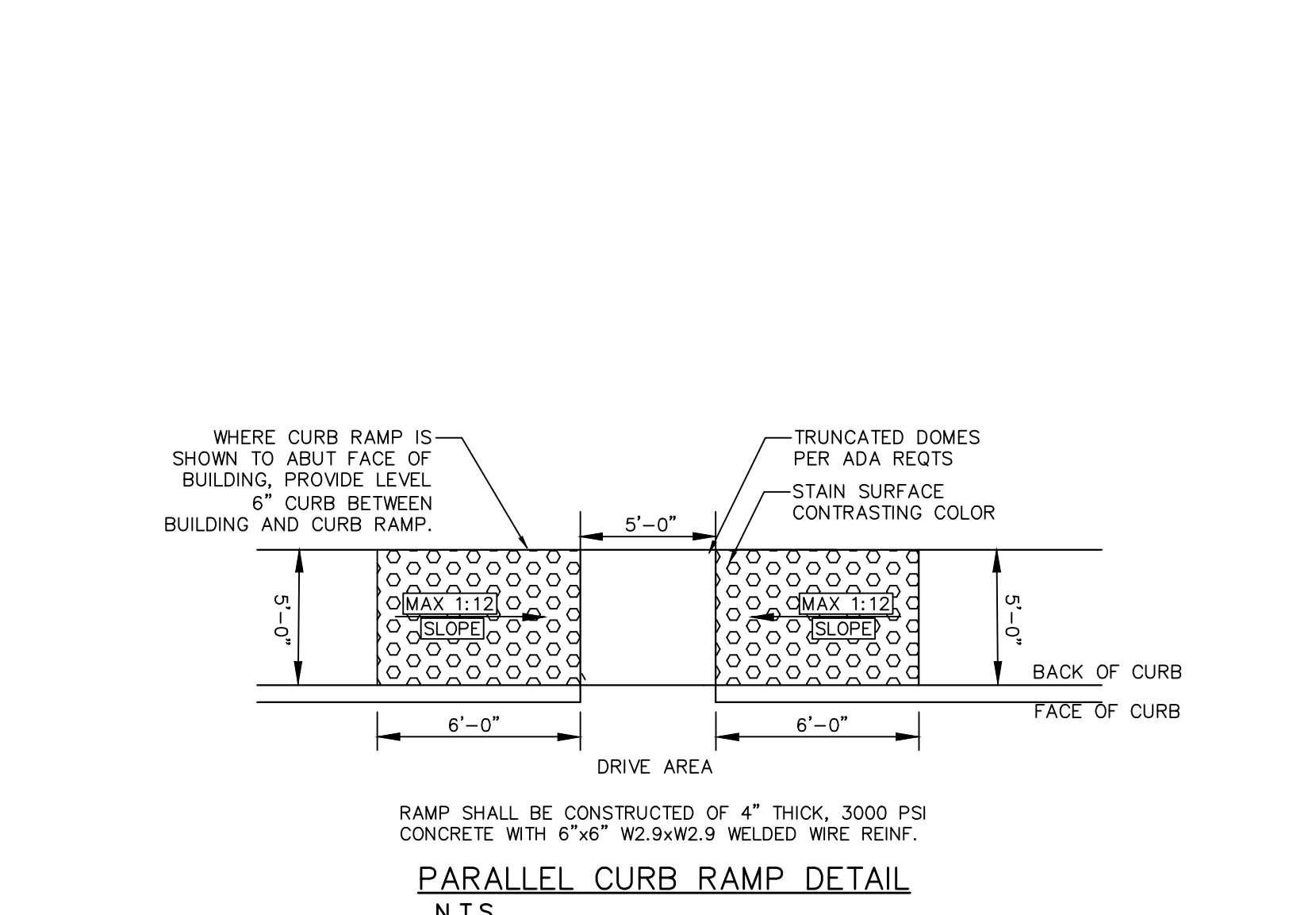
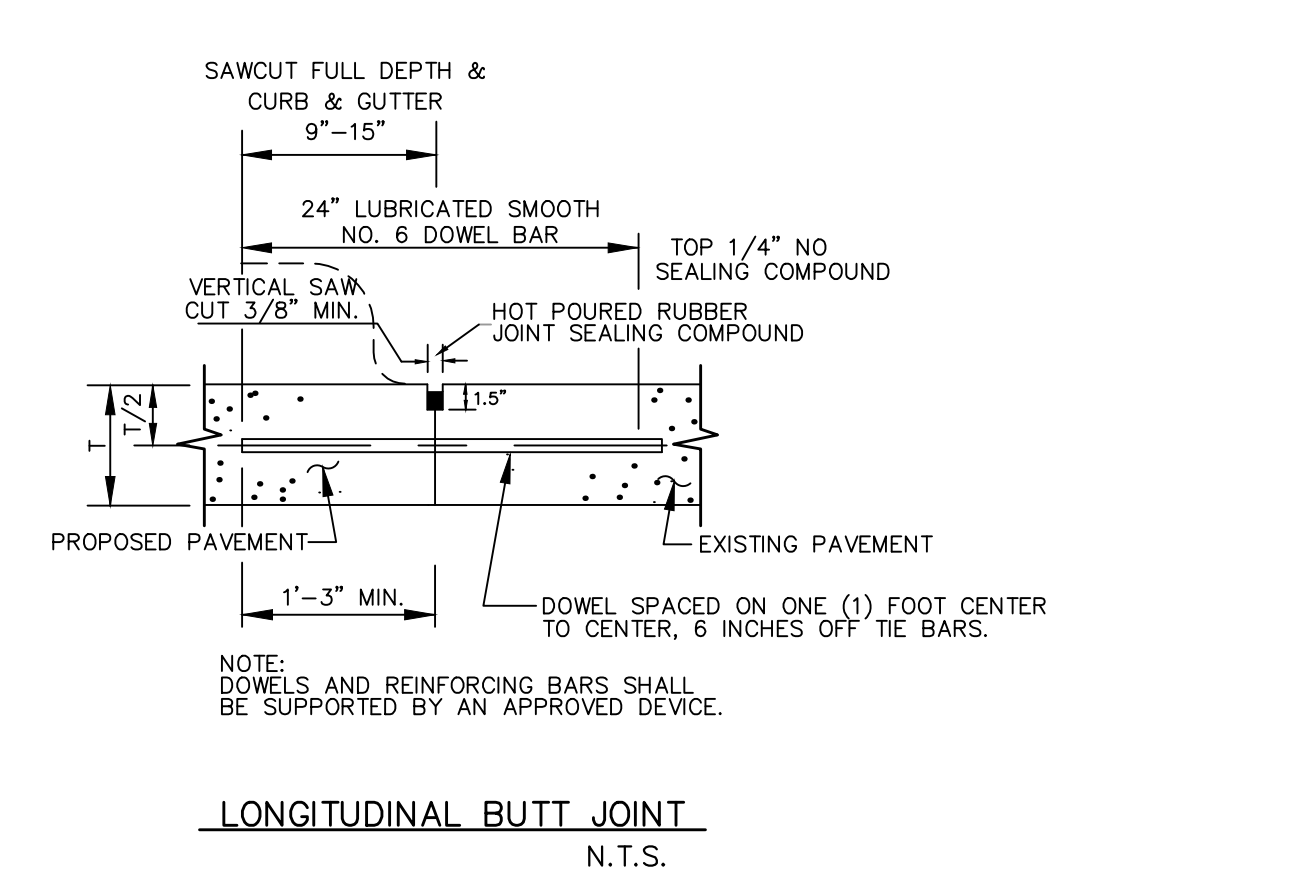
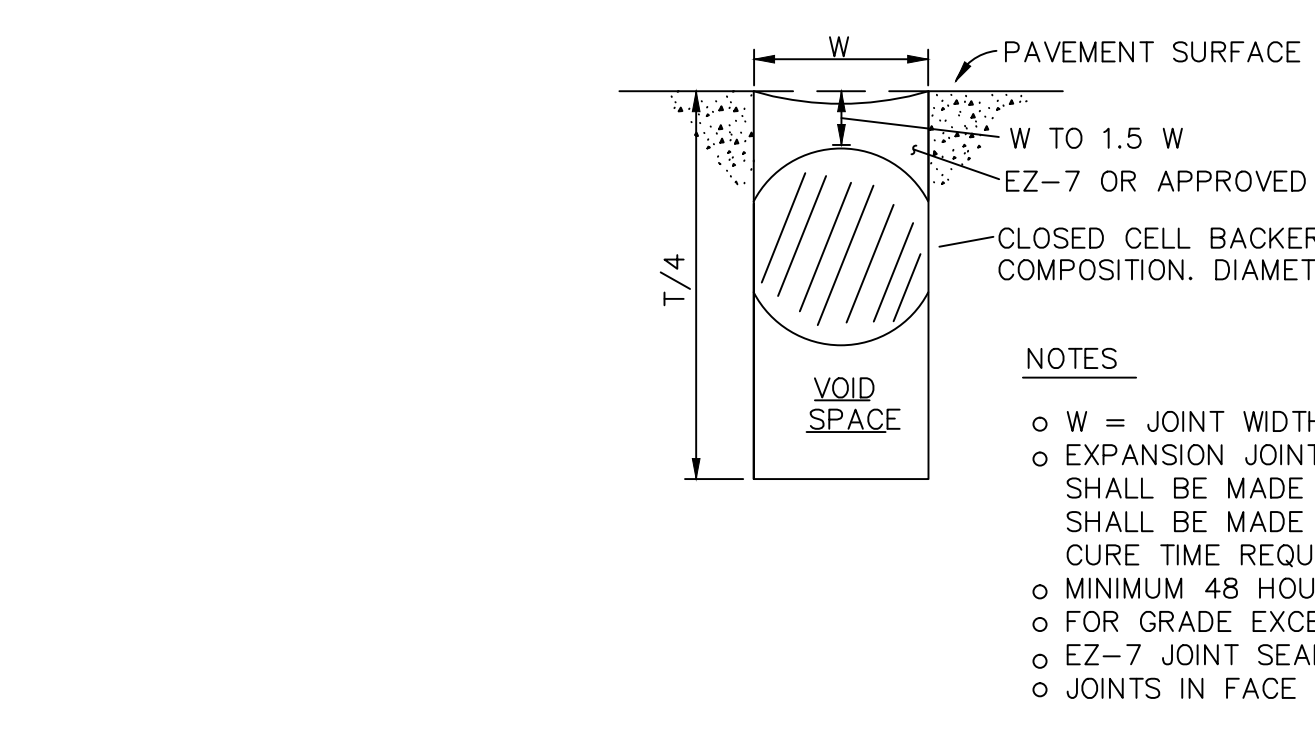
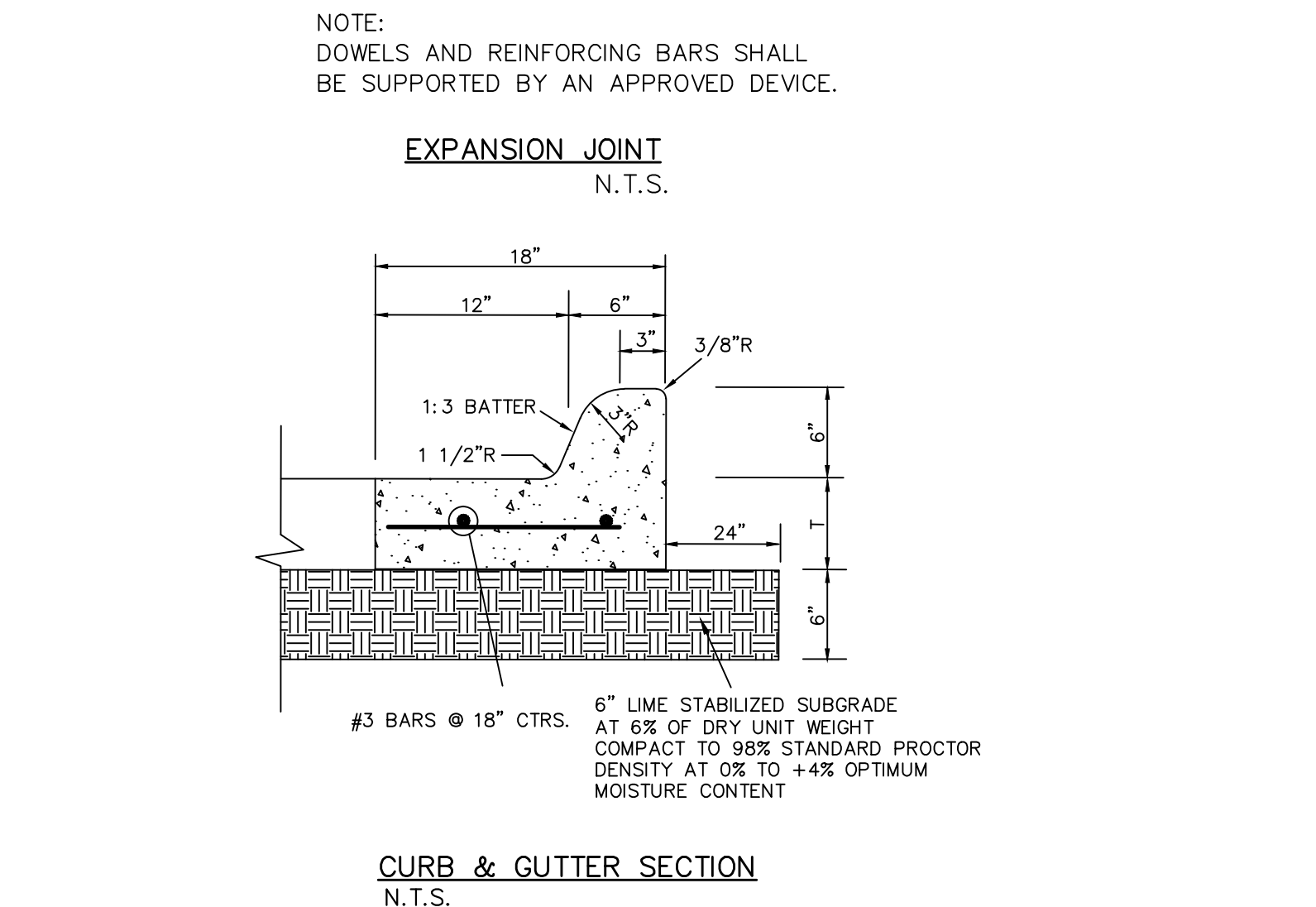
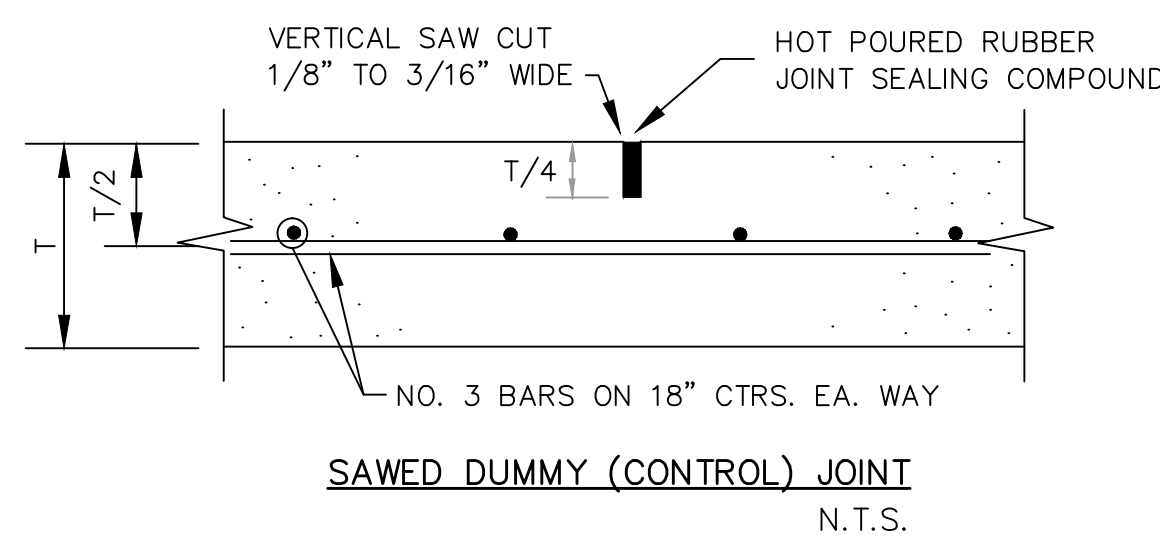
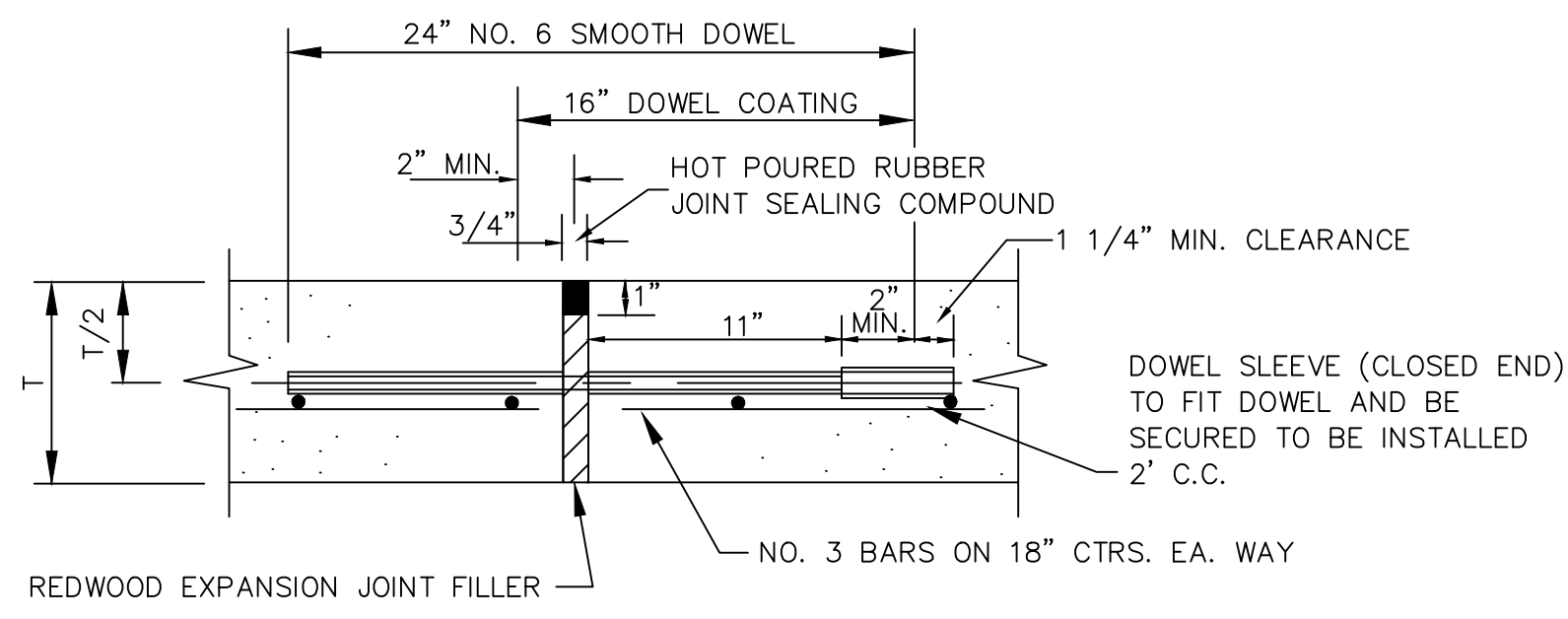
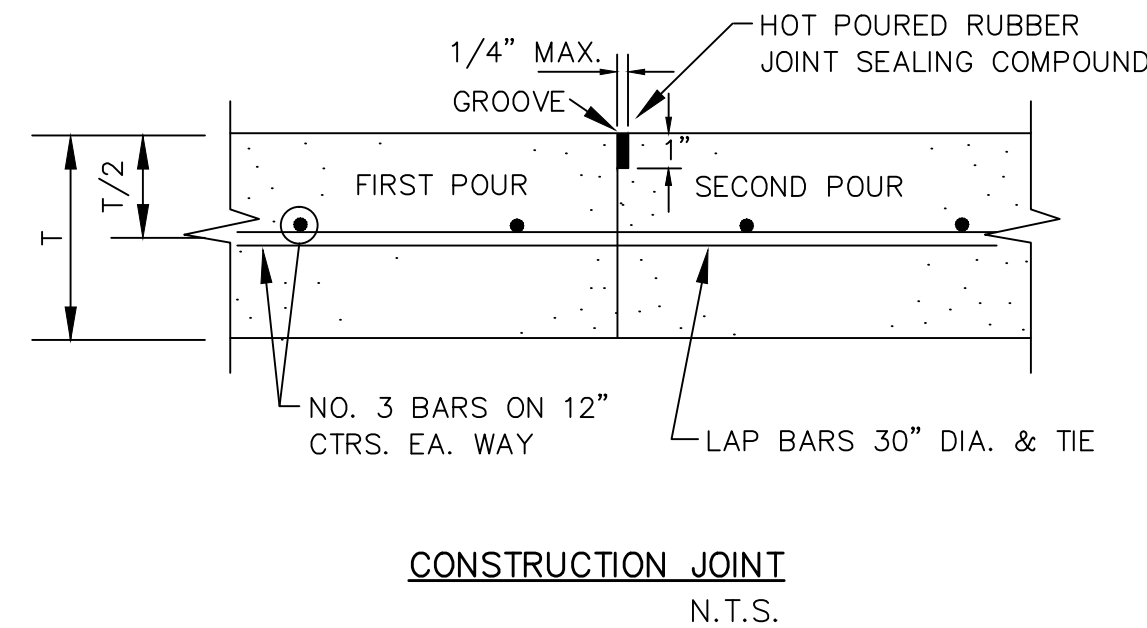

**NOTE:**  
DETAILS PROVIDED ON THIS SHEET ARE FOR PRIVATE IMPROVEMENTS ONLY. CONTRACTOR TO USE CITY STANDARDS FOR ALL IMPROVEMENTS LOCATED WITHIN CITY R.O.W. AND PUBLIC EASEMENTS.

**RECORD DRAWING**  
TO THE BEST OF OUR KNOWLEDGE, BANNISTER ENGINEERING, LLC, HEREBY STATES THAT THIS PLAN IS AS-BUILT. THE INFORMATION PROVIDED IS BASED ON SURVEYING AT THE SITE AND INFORMATION PROVIDED BY THE CONTRACTOR. IN THE EVENT THAT THE ORIGINAL DESIGN WAS MODIFIED IN THE FIELD WITHOUT THE ENGINEER'S KNOWLEDGE, THE SEAL OR SIGNATURE ON THIS DRAWING IS NOT INTENDED TO INDICATE THE ENGINEER'S APPROVAL OR ACCEPTANCE OF ANY SUCH DEVIATIONS FROM THE DESIGN.  
DATE: 09.25.15  
DAVID A. GREER, P.E. 109928