

INTERSTATE HIGHWAY NO. 30
(A VARIABLE WIDTH PUBLIC RIGHT-OF-WAY)

N 35°21'38" E 886.42'

LOT 10
12.661 ACRES
(551,528 SQ. FT.)

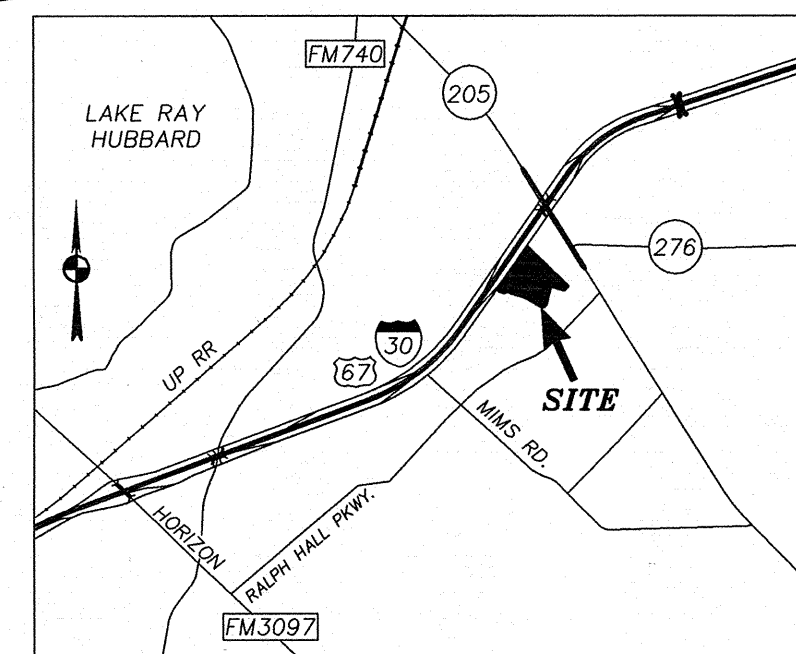

VICINITY MAP
(NOT TO SCALE)
MAPSCO 300-D

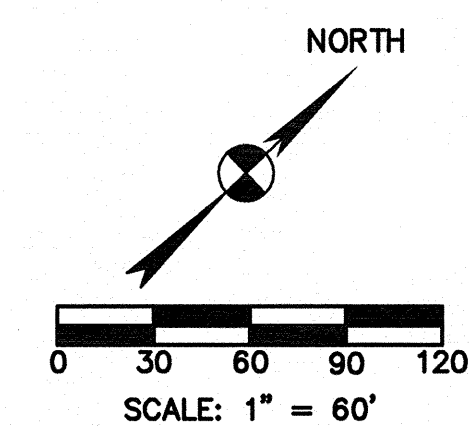

LEGEND

- CIRP 5/8-INCH IRON ROD WITH YELLOW PLASTIC CAP STAMPED "BURY + PARTNERS" FOUND
- DRRCT DEED RECORDS, ROCKWALL COUNTY, TEXAS
- PRRCT PLAT RECORDS, ROCKWALL COUNTY, TEXAS
- CCFN. COUNTY CLERK'S FILE NUMBER
- CAB. CABINET
- SL. SLIDE
- (CM) CONTROL MONUMENT
- VOL. VOLUME
- PG. PAGE
- ESMT. EASEMENT
- FND FOUND
- LAND HOOK (DENOTES COMMON OWNERSHIP)
- EXISTING ESMT. RECORDED IN CABINET G, SLIDE 231 (UNLESS OTHERWISE NOTED)

LOT 6
ROCKWALL BUSINESS PARK EAST SUBDIVISION
CAB. G, SL. 231, PRRCT

OWNER:
EXCEL ROCKWALL LLC CCFN. 2010-00435617, VOL. 6157, PG. 173, DRRCT

BOUNDARY LINE TABLE

LINE	BEARING	LENGTH
L1	S40°39'43"W	61.13'
L2	N68°56'25"W	50.26'
L3	N70°41'07"W	68.73'
L4	N64°37'04"W	52.69'
L5	S72°46'32"W	49.30'
L6	S81°03'24"W	24.67'
L7	N70°14'07"W	77.72'
L8	N54°38'22"W	18.49'

$\Delta=08^{\circ}44'20''$
 $R=1822.29'$
 $L=277.94'$
 $CB=N59^{\circ}48'41''W$
 $CD=277.67'$

$\Delta=118^{\circ}25'53''$
 $R=41.68'$
 $L=86.15'$
 $CB=S68^{\circ}00'07''W$
 $CD=71.61'$

LOT 9
ROCKWALL BUSINESS PARK EAST SUBDIVISION
CAB. G, SL. 231, PRRCT

LOT 3, BLOCK A

TRAVEL CENTERS OF AMERICA ADDITION
CABINET G, SLIDE 137
PRRCT

OWNER:
HPT TA PROPERTIES TRUST
CCFN. 2007-00373923,
DRRCT

Preliminary
This document shall not be recorded for any purpose.
For Review Purposes Only
David J. De Weirtdt, R.P.L.S.
Registration No. 5066
October 1, 2010

OVERALL EASEMENT ABANDONMENT SHEET

LOT 10
ROCKWALL BUSINESS PARK EAST SUBDIVISION
BEING A REPLAT OF LOT 9, OF ROCKWALL BUSINESS PARK EAST SUBDIVISION LOCATED IN THE J.D. McFARLAND SURVEY, ABSTRACT NO. 145 CITY OF ROCKWALL, ROCKWALL COUNTY, TEXAS
OCTOBER 1, 2010

OWNER:
EXCEL ROCKWALL LLC
801 NORTH 500 WEST, SUITE 201
BOUNTIFUL, UTAH 84010

SURVEYOR:
BURY + PARTNERS-DFW, INC.
5310 HARVEST HILL, SUITE 100
DALLAS, TEXAS 75230
PHONE: (972) 991-0011
CONTACT: DAVID J. DE WEIRDT, R.P.L.S.