

MATCHLINE B SEE SH C3.2

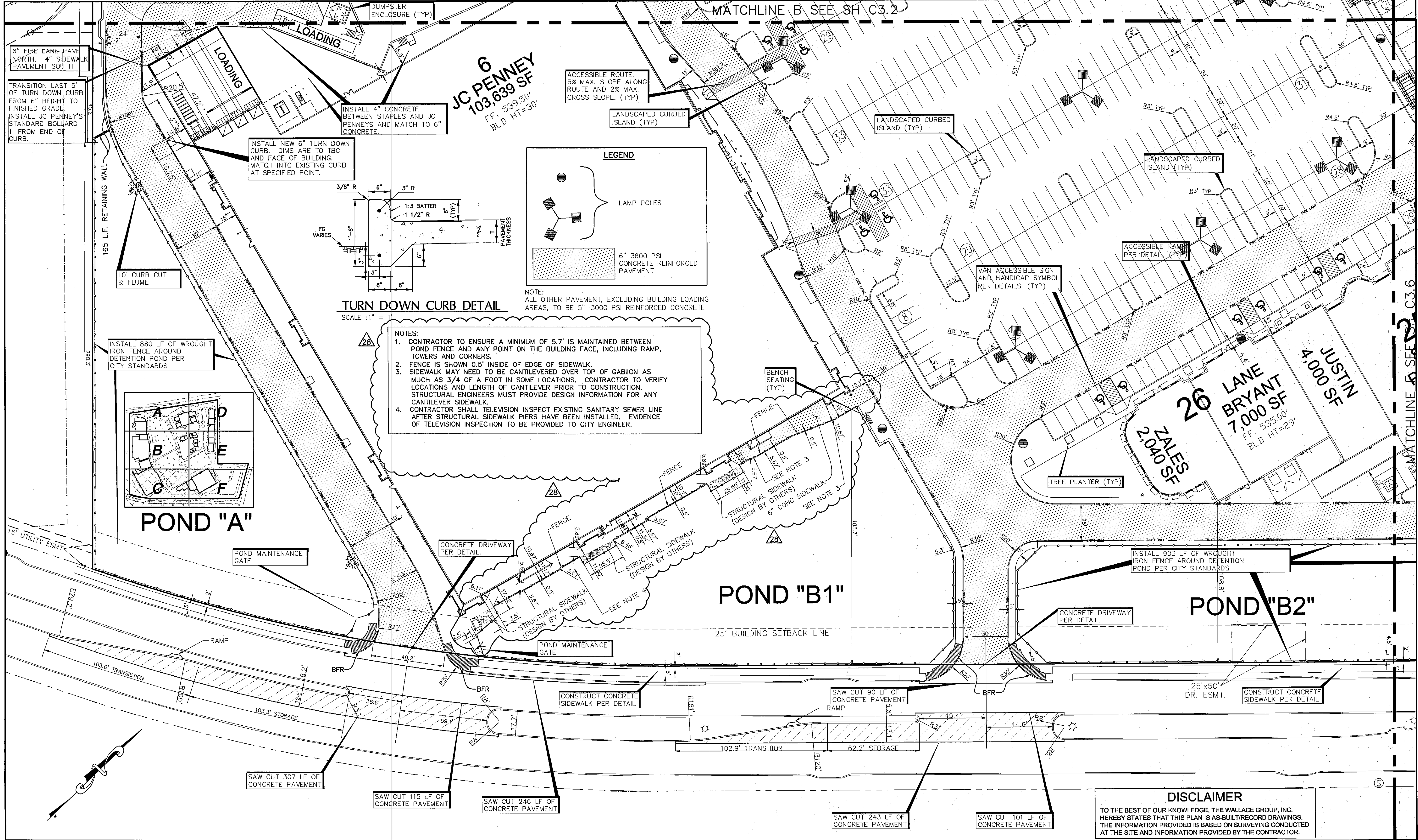

DISCLAIMER
TO THE BEST OF OUR KNOWLEDGE, THE WALLACE GROUP, INC. HEREBY STATES THAT THIS PLAN IS AS-BUILT/RECORD DRAWINGS. THE INFORMATION PROVIDED IS BASED ON SURVEYING CONDUCTED AT THE SITE AND INFORMATION PROVIDED BY THE CONTRACTOR.

REV	DATE	BY	DESCRIPTION
1-16-08		MM	REVISED SIDEWALK & FENCE AROUND POND B-1
12-12-07		MM	REVISED BLDG 25 & 26 FOOTPRINT & VARIOUS DIMENSION CALLOUTS
11-8-07		MM	REVISED FIRE LANE AND REVISED CURB LOCATION AND TYPE.
9-19-07		MM	CLARIFIED CONCRETE BETWEEN 42' POSTERS AND STAPLES
8-29-07		MM	REVISED POND A SIDE SLOPES TO 1.5:1
4-16-07		MM	REVISED BLDG 25 & 26 FOOTPRINT & VARIOUS DIMENSION CALLOUTS
3-19-07		MM	ENTRIES AND BUILDINGS
3-19-07		MM	ADDED HATCHING FOR PAVEMENT SECTIONS

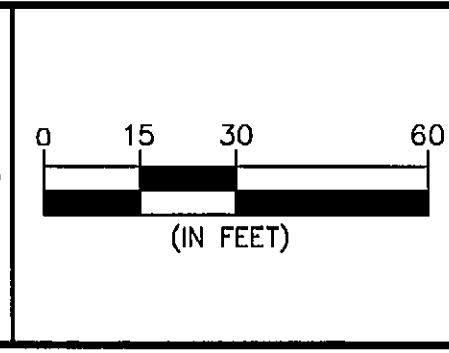
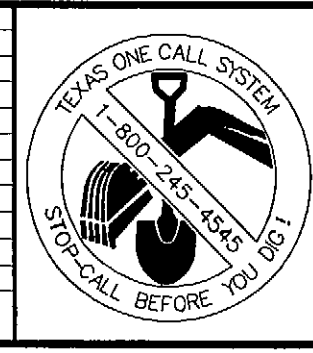

DESIGNED: _____
DRAWN: _____
CHECKED: _____

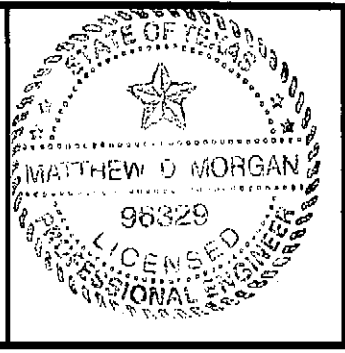

"THE SEAL APPEARING ON THIS DOCUMENT WAS AUTHORIZED BY MATTHEW D. MORGAN, P.E. # 98329 ON THE DATE SHOWN ON THE DAYSTAMP. ALTERATION OF A SEALED DOCUMENT WITHOUT PROPER NOTIFICATION TO THE RESPONSIBLE ENGINEER IS AN OFFENSE UNDER THE TEXAS ENGINEERING PRACTICE ACT"

3/25/08 *Matthew D. Morgan*
DATE NAME

THE WALLACE GROUP INC.
ENGINEERS ARCHITECTS SURVEYORS PLANNERS

THE WOODMONT COMPANY
PLAZA AT ROCKWALL
SITE PLAN C