

Harold L. Evans
 Rev. 3-12-91

BENCHMARK:
 Top-of-Curb at the Northwest corner of the existing paving on Highview Lane
 Elevation 521.21

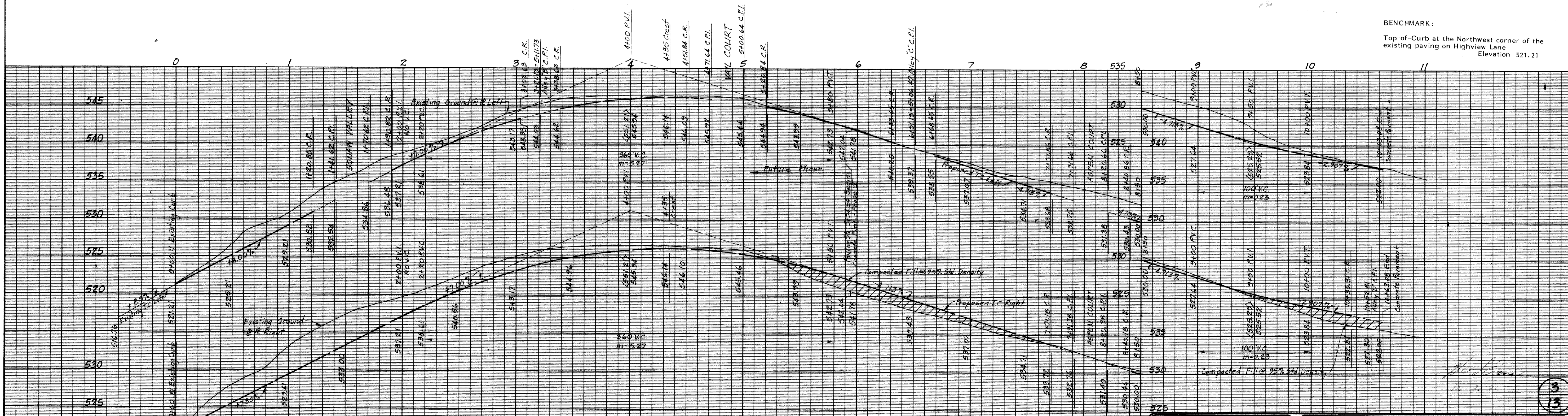

HAROLD L. EVANS
 CONSULTING ENGINEER
 2331 GUS THOMASSON RD. SUITE 102
 DALLAS, TEXAS 75228
 PHONE (214) 328-8133

PAVING PLAN
THE PINNACLE
 CITY OF ROCKWALL, ROCKWALL COUNTY, TEXAS
HIGHVIEW LANE

SCALE: 1"=40'H, 1"=60'
 DATE: 10-31-90
 JOB NO.: 90115