

**PROPOSED 8" PUBLIC SANITARY SEWER PROFILE**

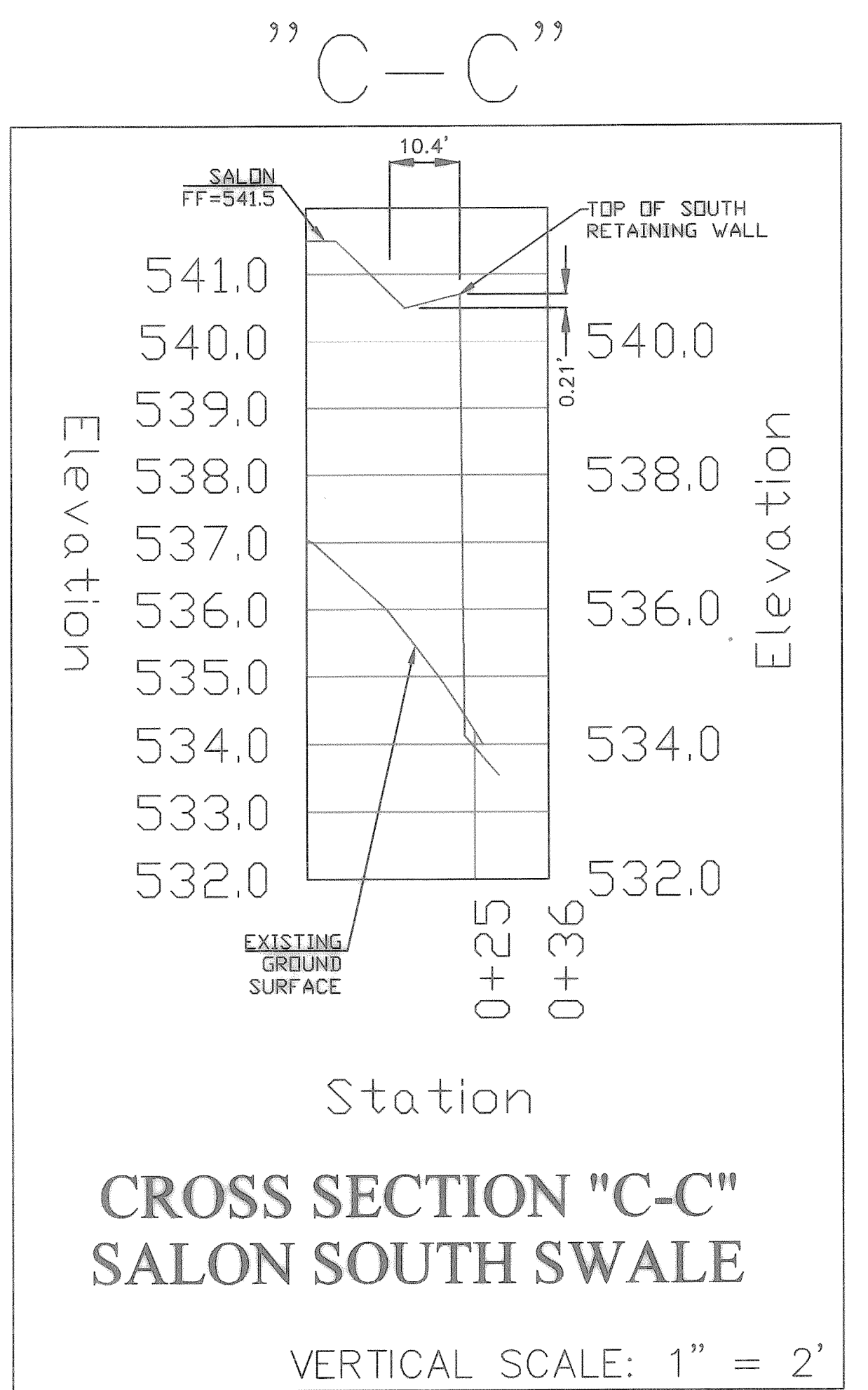
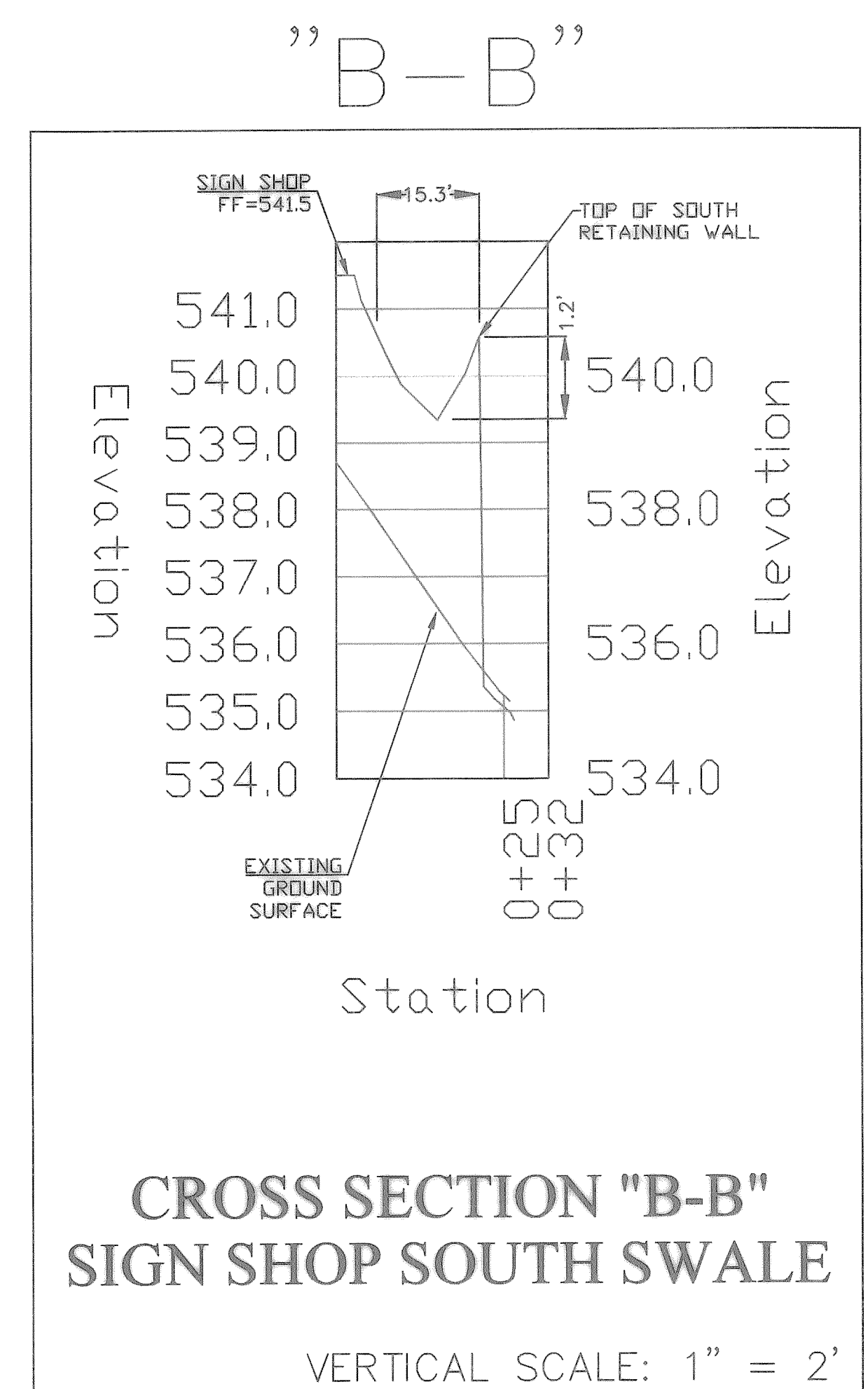
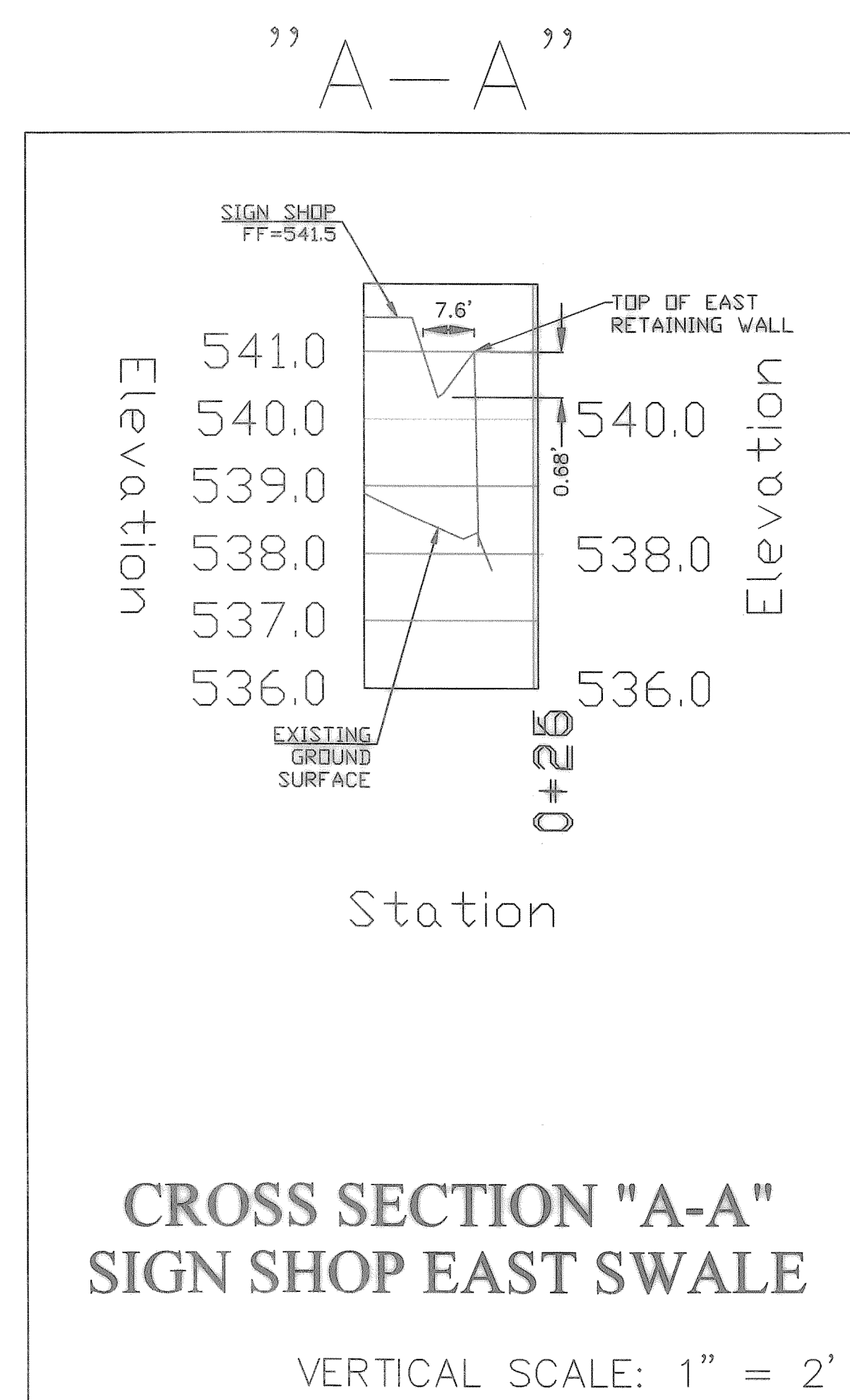
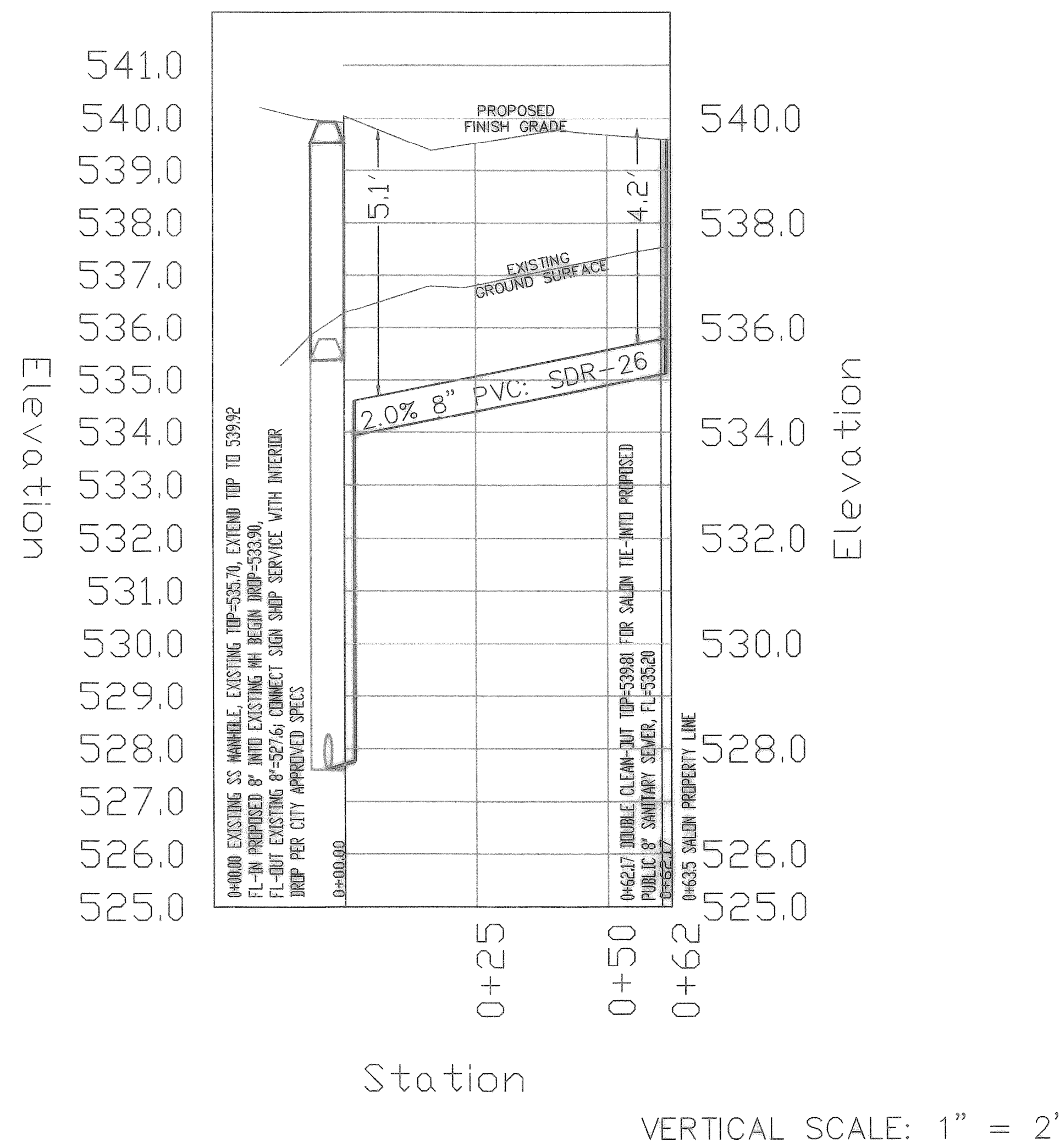

CONSTRUCTION DETAILS ARE AS OUTLINED IN THE STANDARD SPECIFICATIONS FOR PUBLIC WORKS CONSTRUCTION, NORTH CENTRAL TEXAS, THIRD EDITION AND CITY OF ROCKWALL STANDARDS OF DESIGN AND CONSTRUCTION

**WELDON BROWN ENGINEERING, LC**  
 TBPE #10477  
 297 WATERFORD WAY  
 MONTGOMERY  
 TEXAS 77356  
 (832) 691-1581

STATE OF TEXAS  
 REESE W. BROWN, III  
 6511  
 LICENSED  
 PROFESSIONAL ENGINEER  
 R. W. BROWN, III  
 THE SEAL AND SIGNATURE APPEARING ON THIS DOCUMENT WAS AUTHORIZED BY REESE W. BROWN, III, P.E. TBPE #65511 ON 11-13-12

OWNER:  
**ROCKWALL SALONS, LLC**  
 dba SALONS ELITE  
 P.O. BOX 846  
 SEAGOVILLE, TX 75159

TO THE BEST OF OUR KNOWLEDGE WELDON BROWN ENGINEERING, LC HEREBY STATES THAT THIS PLAN IS AS-BUILT. THIS INFORMATION PROVIDED IS BASED ON SURVEYING AT THE SITE AND INFORMATION PROVIDED BY THE CONTRACTOR.

**PFEFFER/INMAN ADDITION**  
 2 LOTS - 1.6989 ACRES  
 J.D. McFARLAND SURVEY, ABSTRACT NO. 145  
 CITY OF ROCKWALL, ROCKWALL COUNTY, TEXAS

SHEET TITLE:  
**AS-BUILT SANITARY & SWALE PROFILES**  
 DATE: 11/13/12

**C-6**