

LEGEND	
---	WATER LINE
---	SANITARY SEWER
---	STORM SEWER
---	ELECTRIC
---	RIGHT OF WAY
---	LOT BOUNDARY
---	FIRELANE
---	EASEMENT BOUNDARY
---	100 YEAR FLOODPLAIN
---	SIDEWALK
---	GRADING BREAKLINE
---	EDGE OF PAVING/BACK OF CURB
---	FIRE HYDRANT
---	WATER BLOW OFF VALVE
---	WATER GATE VALVE
---	SANITARY MANHOLE
---	SANITARY CLEANOUT
---	STORM INLET/JUNCTION
---	DRAINAGE SLOPE/DIRECTION
---	EXISTING CONTOURS
---	PROPOSED CONTOURS

SURVEY/REPLAT PROVIDED BY:  
**TerraCorp Associates LLC**  
 3960 Broadway Blvd. Ste 236  
 Garland, TX 75043  
 ph. 972-805-4529, fax 972-805-4527  
 www.terracorpsurvey.com

SURVEY LEGEND	
(CM)	CONTROL MONUMENT
IPF	IRON PIPE FOUND
SRF	STEEL ROD FOUND
TCS	5/8-INCH STEEL ROD
W/TERRACORP	CAP SET
( )	DEED CALLS

GRADING LEGEND	
---	TOP OF PAVING
---	EDGE OF CONCRETE
---	TOP OF CURB
---	TOP OF SIDEWALK
---	FLOWLINE

**SURVEY NOTES**  
 1. Bearings shown herein are based on NAD83(CORS96, EPOCH 2002) tied to the Texas Coordinate System of 1983, North Central Zone (4202) using the Geoshack "GeoNet" RTK GPS Network.  
 The convergence/mapping angle at the P.O.B is 01°07'01" with a combined scale factor of 0.999864015.

CONSTRUCTION DETAILS ARE AS OUTLINED IN THE STANDARD SPECIFICATIONS FOR PUBLIC WORKS CONSTRUCTION, NORTH CENTRAL TEXAS, THIRD EDITION AND CITY OF ROCKWALL STANDARDS OF DESIGN AND CONSTRUCTION

**Capacity of 18" RCP Storm Sewer Pipe out of East Y-inlet (East Drop Inlet)**

$A = 1.77 \text{ sqft, pipe slope} = 2.55\%$   
 $Q(100) = 6.24 + 0.741 + 0.529 = 7.51 \text{ cfs}$   
 Critical Depth = 14.04 in from Figure 3.23  
 $wp = 4.39 \text{ ft}$

$Q(\text{cap}) = 1.77(1.486/0.13)^2(1.77/4.39)^{1/2}(0.0255)^{1/2} = 17.63 \text{ cfs}$   
 $V(\text{max}) = 17.63 \text{ cfs} / 1.77 = 9.86 \text{ ft/s} \approx 4/-9.5 \text{ ft/s from Figure 3.17}$   
 $R = 1.77 / 4.39 = 0.403$   
 $S = Qn^2 / 1.486AR^4(2.3)$   
 $S = 7.51(0.013^2) / 1.486(1.77)(0.403^2)^2$   
 $S = 0.088 \%$ , therefore  
**CAPACITY EXCEEDS REQUIREMENTS**

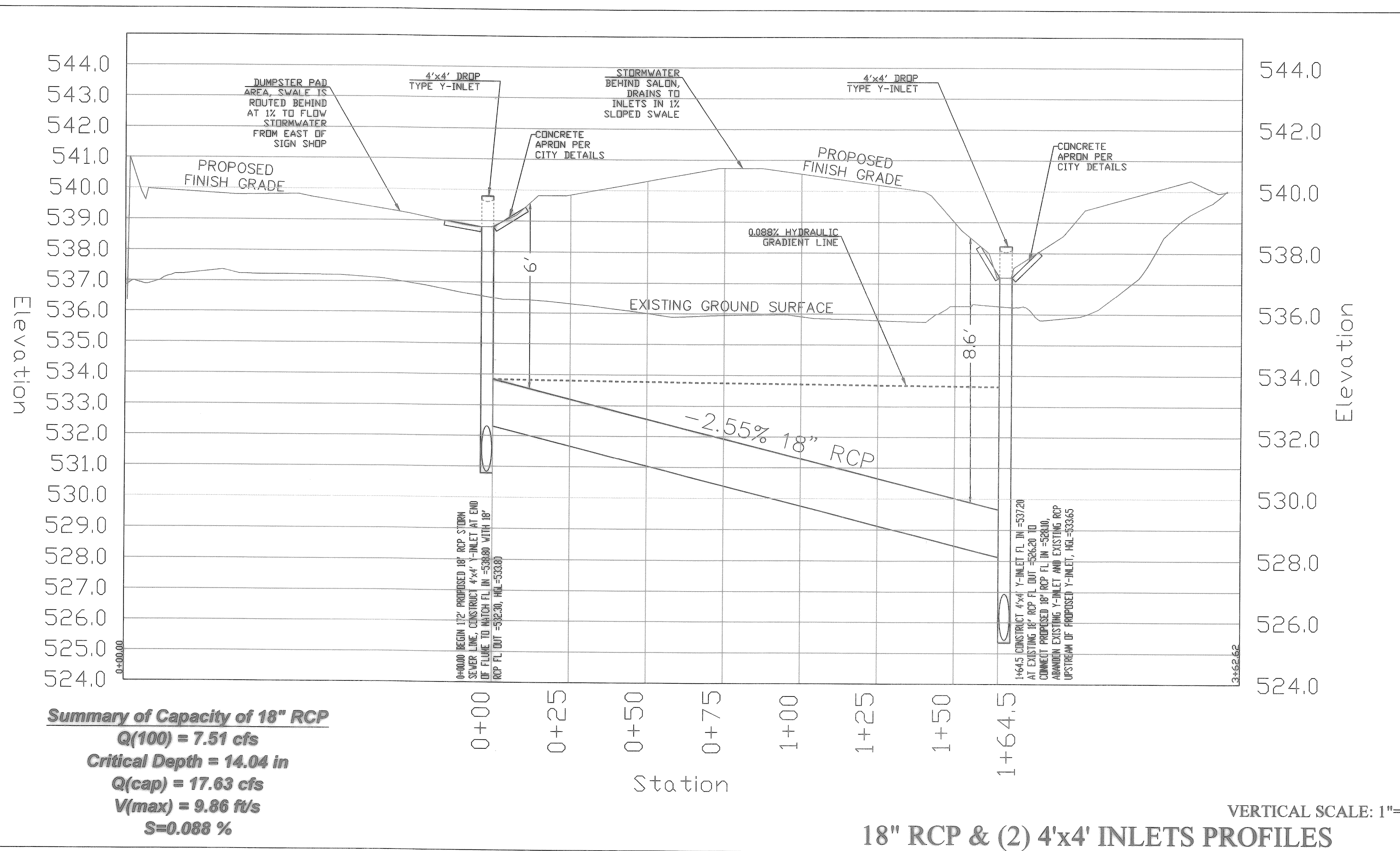
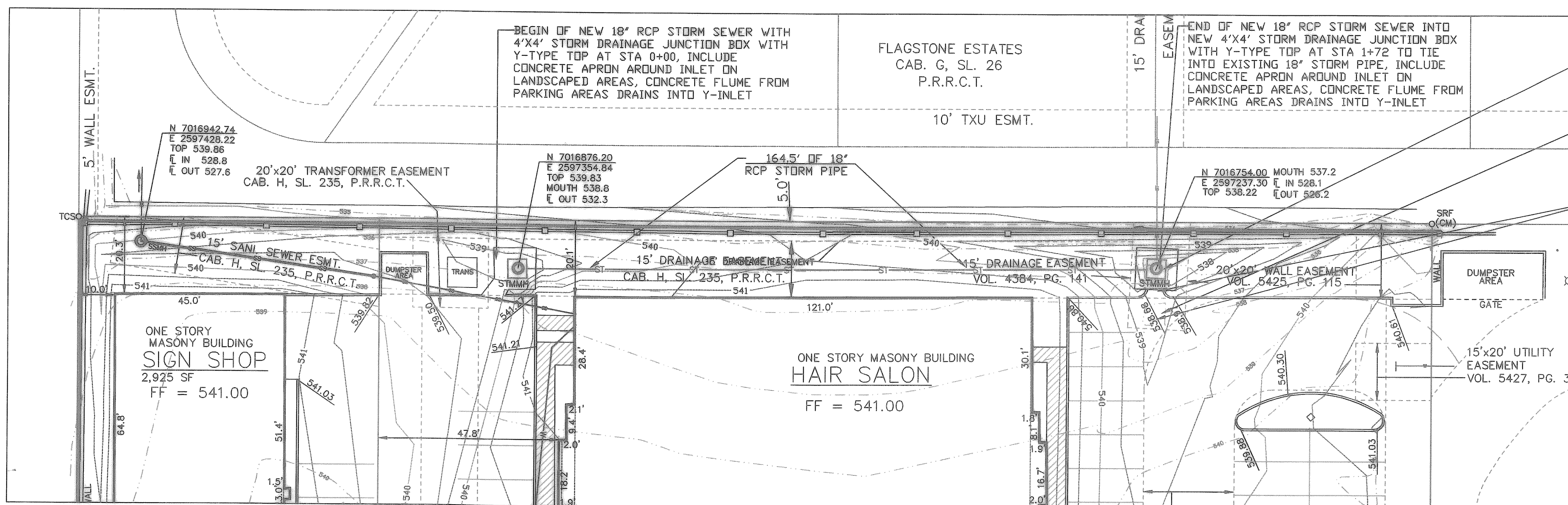

**18" RCP & (2) 4'x4' INLETS PROFILES**

**WELDON BROWN ENGINEERING, L.C.**

TBPE #10477  
 297 WATERFORD WAY  
 MONTGOMERY  
 TEXAS 77356  
 (832) 691-1581

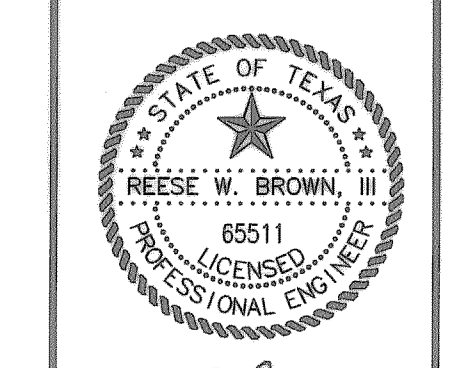

THE SEAL AND SIGNATURE APPEARING ON THIS DOCUMENT WAS AUTHORIZED BY REESE W. BROWN, III, P.E. TBPE #65511 ON 11-13-12

OWNER:  
**ROCKWALL SALONS, LLC**  
 dba SALONS ELITE  
 P.O. BOX 846  
 SEAGOVILLE, TX 75159

TO THE BEST OF OUR KNOWLEDGE WELDON BROWN ENGINEERING, L.C. HEREBY STATES THAT THIS PLAN IS AS-BUILT. THIS INFORMATION PROVIDED IS BASED ON SURVEYING AT THE SITE AND INFORMATION PROVIDED BY THE CONTRACTOR.

**PFEFFER/INMAN ADDITION**  
 2 LOTS - 1.6989 ACRES  
 J.D. McFARLAND SURVEY, ABSTRACT NO. 145  
 CITY OF ROCKWALL, ROCKWALL COUNTY, TEXAS

SHEET TITLE:  
**AS-BUILT STORM SEWER PROFILE**  
 DATE: 11/13/12

**C-5**