

DISCLAIMER
The use of this standard is governed by the "Texas Engineering Practice Act". No warranty of any kind is made by TxDOT for any purpose whatsoever. TxDOT assumes no responsibility for the conversion of this standard to other formats or for incorrect results or damages resulting from its use.

LEVELS DISPLAYED	DATE:
1 2 3 4 5 6 7 8 9 10 11 12 13 14 15 16	ACC:
17 18 19 20 21 22 23 24 25 26 27 28 29 30 31 32	FILE:
33 34 35 36 37 38 39 40 41 42 43 44 45 46 47 48	
49 50 51 52 53 54 55 56 57 58 59 60 61 62 63	
64 65 66 67 68 69 70 71 72 73 74 75 76 77 78	
79 80 81 82 83 84 85 86 87 88 89 90 91 92 93	
94 95 96 97 98 99 100	

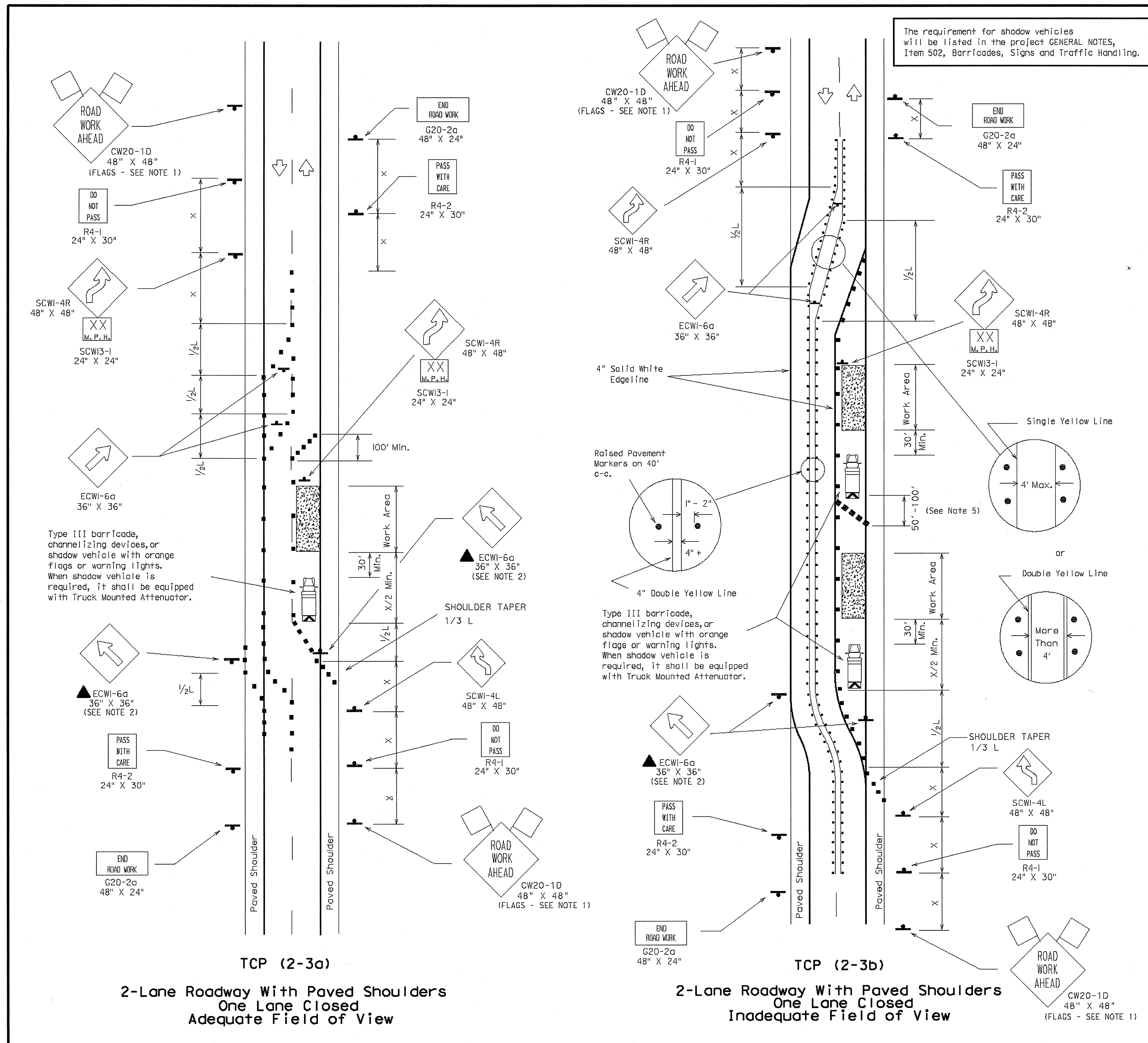

LEGEND

- Type III Barricade
- Channelizing Devices
- Flag
- Heavy Work Vehicle
- Truck Mounted Attenuator
- Trailer Mounted Flashing Arrow Panel
- Portable Changeable Message Sign
- Flagger
- Sign Post
- Raised Pavement Markers Type II-A-A (40' spacing)

Posted Speed	Formula	Minimum Desirable Taper Lengths			Suggested Maximum Spacing of Device		Minimum Sign Spacing Distance
		10' Offset	11' Offset	12' Offset	On a Taper	On a Tangent	
30	$L = \frac{WS^2}{60}$	150'	165'	180'	30'	60'-75'	120'
35		205'	225'	245'	35'	70'-90'	160'
40	L=WS	265'	295'	320'	40'	80'-100'	240'
45		450'	495'	540'	45'	90'-110'	320'
50	L=WS	500'	550'	600'	50'	100'-125'	400'
55		550'	605'	660'	55'	110'-140'	500'
60	L=WS	600'	660'	720'	60'	120'-150'	* 600'
65		650'	715'	780'	65'	130'-165'	* 700'
70	L=WS	700'	770'	840'	70'	140'-175'	* 800'
75		750'	825'	900'	75'	150'-190'	* 900'

* Conventional Roads Only
 ** Taper lengths have been rounded off.
 L=Length of Taper (FT.) W=Width of Offset (FT.) S=Posted Speed (MPH)

TYPICAL USAGE:

MOBILE	SHORT DURATION	SHORT TERM STATIONARY	INTERMEDIATE TERM STATIONARY	LONG TERM STATIONARY

- GENERAL NOTES:
- Unless otherwise stated in the plans, flags attached to signs are REQUIRED.
 - All traffic control devices illustrated are REQUIRED, except those denoted with the triangle symbol may be omitted when stated elsewhere in the plans.
 - When work area will be in place more than one day but less than 2 weeks existing pavement markings may remain in place. Channelizing devices shall be used to separate traffic.
 - Flagger control should NOT be used unless roadway conditions or heavy traffic volume require additional emphasis to safely control traffic. Flagger should be positioned at end of traffic queue.
 - DO NOT PASS, PASS WITH CARE, and construction regulatory speed zone signs may be installed within ROAD WORK AHEAD signs. Proper spacing of signs shall be maintained.
 - When the work zone will be in place more than two weeks, conflicting pavement markings shall be removed, unless approved by the Engineer. New markings shall be placed and maintained to the satisfaction of the Engineer.
 - For intermediate term situations, when it is not feasible to remove and restore pavement markings, the channelizing must be made dominant by using a very close spacing. This is especially important in locations of conflicting information, such as where traffic is directed over a double yellow centerline. In such locations a maximum channelizing device spacing of 10 feet is recommended. The 10 foot channelizing device spacing recommendation is intended for the area of conflicting information and not the entire work zone.

STANDARD PLANS
 TEXAS DEPARTMENT OF TRANSPORTATION
 Traffic Operations Division

TRAFFIC CONTROL PLAN
 TCP (2-3) - 03

163

© TxDOT December 1985	DM - LR	CO - MT	DM - DN	CS - DM	RES. 10.1
REVISIONS	DATE	DISTRICT	REGION	FEDERAL AID PROJECT	SHEET
8-95					
1-97					
4-98					
3-03					

RECORD DRAWING
 THIS RECORD DRAWING HEREIN REFLECTS TO THE BEST OF THE DESIGN ENGINEER'S KNOWLEDGE, THE APPROXIMATE LOCATION OF THE CONSTRUCTED WORK, USING INFORMATION AS PROVIDED BY THE CONTRACTORS AND SURVEYED GRADES.

Kimley-Horn and Associates, Inc.
 Tel. No. (972) 355-3660
 Fax No. (972) 355-3776

Pecan Valley Drive
 Quail Run Road
 City of Rockwall, Texas

TxDOT
 TRAFFIC CONTROL PLAN
 TCP(2-3)-03

Scale: Not To Scale
 Designed by: TxDOT
 Drawn by: TxDOT
 Checked by: P.D.K.
 Date: Feb. 27, 2008
 Project No. 068237002

SHEET
 C-29
 OF 47