

PNEUMA VENTURES, LTD.
VOL. 2924, PG. 314
D.R.R.C.T.

REVISED TO CONFORM TO CONSTRUCTION RECORDS.
h. h. h. h. h. DATE: 12-15-15

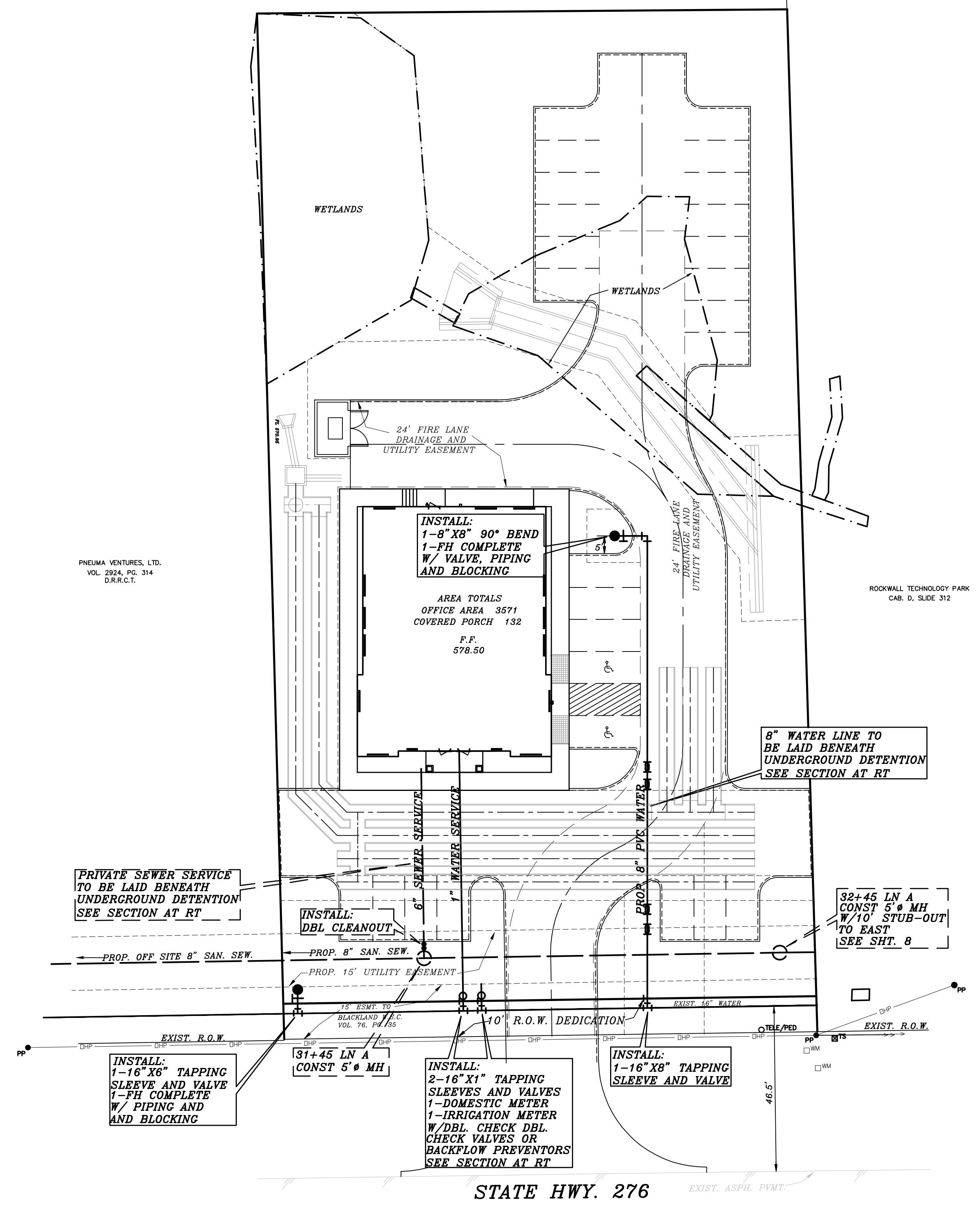

PNEUMA VENTURES, LTD.
VOL. 2924, PG. 314
D.R.R.C.T.

ROCKWALL TECHNOLOGY PARK
CAB. D. SLIDE 312

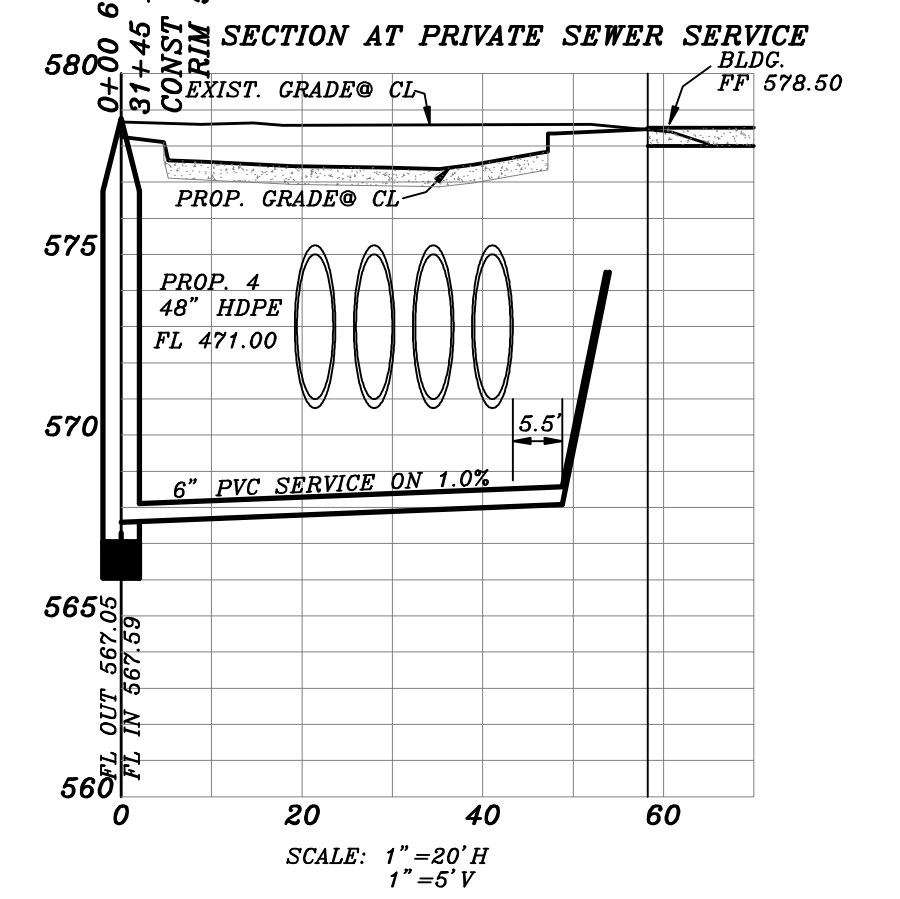
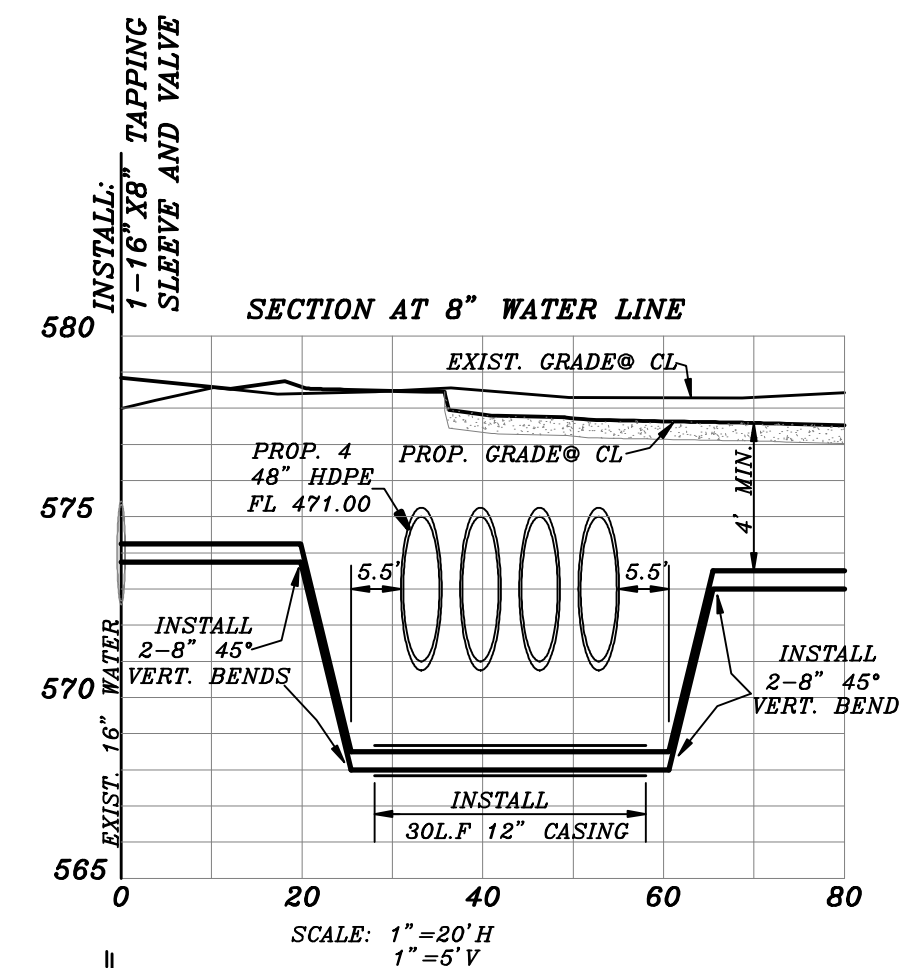

BENCHMARK:
BRASS CAP MONUMENT NO. 19 SET IN
CONCRETE AT THE NORTHWEST CORNER
OF SILVER VIEW AND DIAMOND WAY
N 7018063.211, E 2609533.550
ELEV. = 600.69

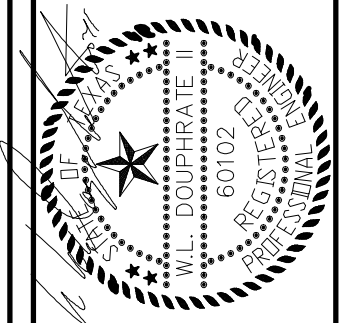

THE SEAL APPEARING ON THIS
DOCUMENT WAS AUTHORIZED BY
THE BOARD OF ENGINEERING
EXAMINERS, STATE OF TEXAS,
NO. 60102, F-686, ON
DATE, MAY 19, 2014.

DOUPHRATE
& ASSOCIATES, INC.
ENGINEERING • PROJECT MANAGEMENT • SURVEYING
2235 RIDGE RD. # 200 ROCKWALL, TEXAS 75087
PHONE: (972)771-9004 FAX: (972)771-9005

PROPOSED UTILITIES ON SITE
LOT 1, BLOCK A
PEAR PEDI MEDICAL OFFICE
J.M. ALLEN SURVEY, ABST. 2
CITY OF ROCKWALL
ROCKWALL COUNTY, TEXAS

CITY REVIEW 6-12-14
REVISION

WLD.

CHECKED

G.C.W.

DRAWN

SCALE
1" = 20'H
1" = 5' V

JUNE 12, 2014
DATE

13029
PROJECT

9 OF 10