

S:\Land Projects 2004\293-07.dwg\01C225SPRO.dwg 04/05/2005 2:52:18 PM CST

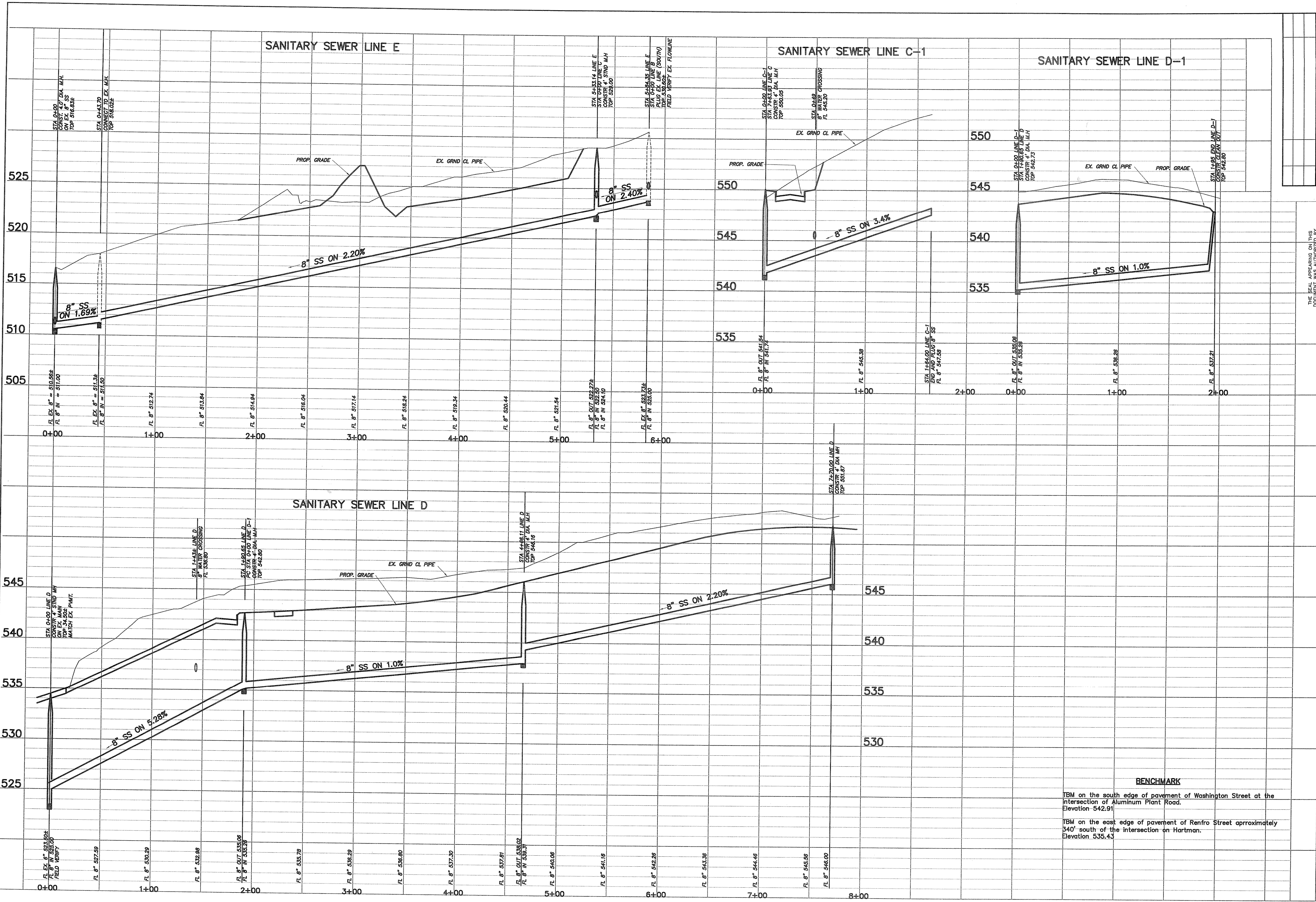

No.	Date	Revisions	App.

TOMDEN ENGINEERING, L.L.P.
 12655 N. Central Expy., Suite 1016
 Dallas, Texas 75243
 Ph: 972.386.6446 Fax: 972.386.6409
 mail@tomden.com

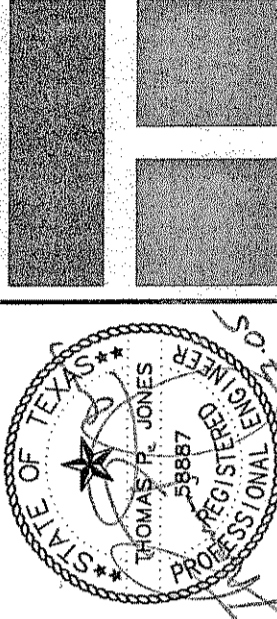

PARK PLACE - WEST
PHASE II

OWNER:
 COLUMBIA GAS SYSTEM CORP.
 2200 E. WASHINGTON
 ROCKWALL, TX 75087
 972-771-7109

SANITARY SEWER
PROFILES
LINES "C-1", "D", "D-1" & "E"

Scale: 1" = 40' H, 1" = 4' V
 Designed by T.P.J.
 Drawn by R.V.A.
 Checked by T.P.J.
 /dwg/293-02/01C01PAVING.dwg
 Date: 04/05/05 14:52