

N:\BC13054 (Columbia - Bricker)\05A CAD Files\Phase 3\13054BC-WSS-PRO.dwg--SANITARY SEWER PROFILES LINE K, LINE L & LINE M Plotted May 30, 2018 at 3:51pm by jfitzgerald | Last Saved by jfitzgerald

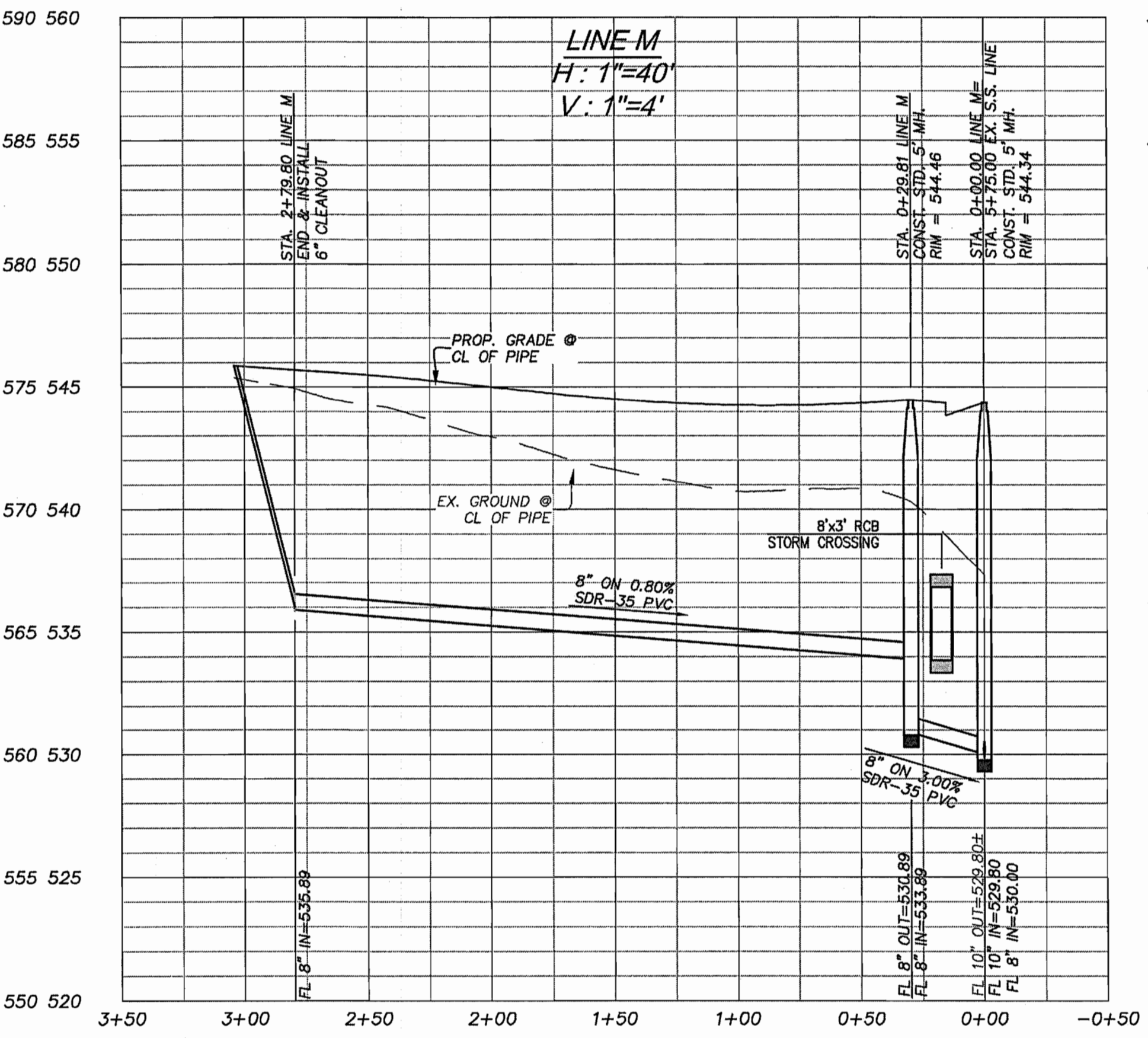
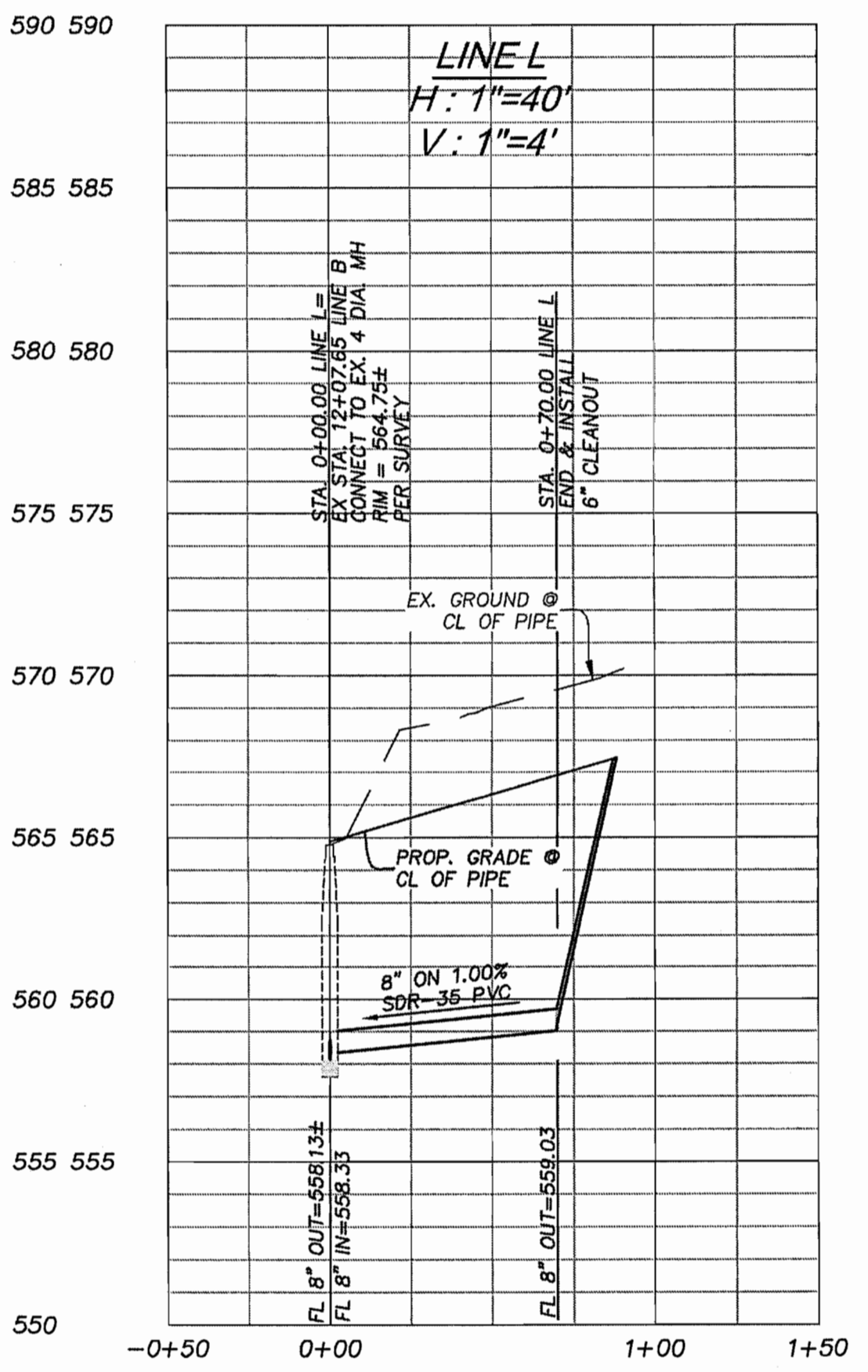
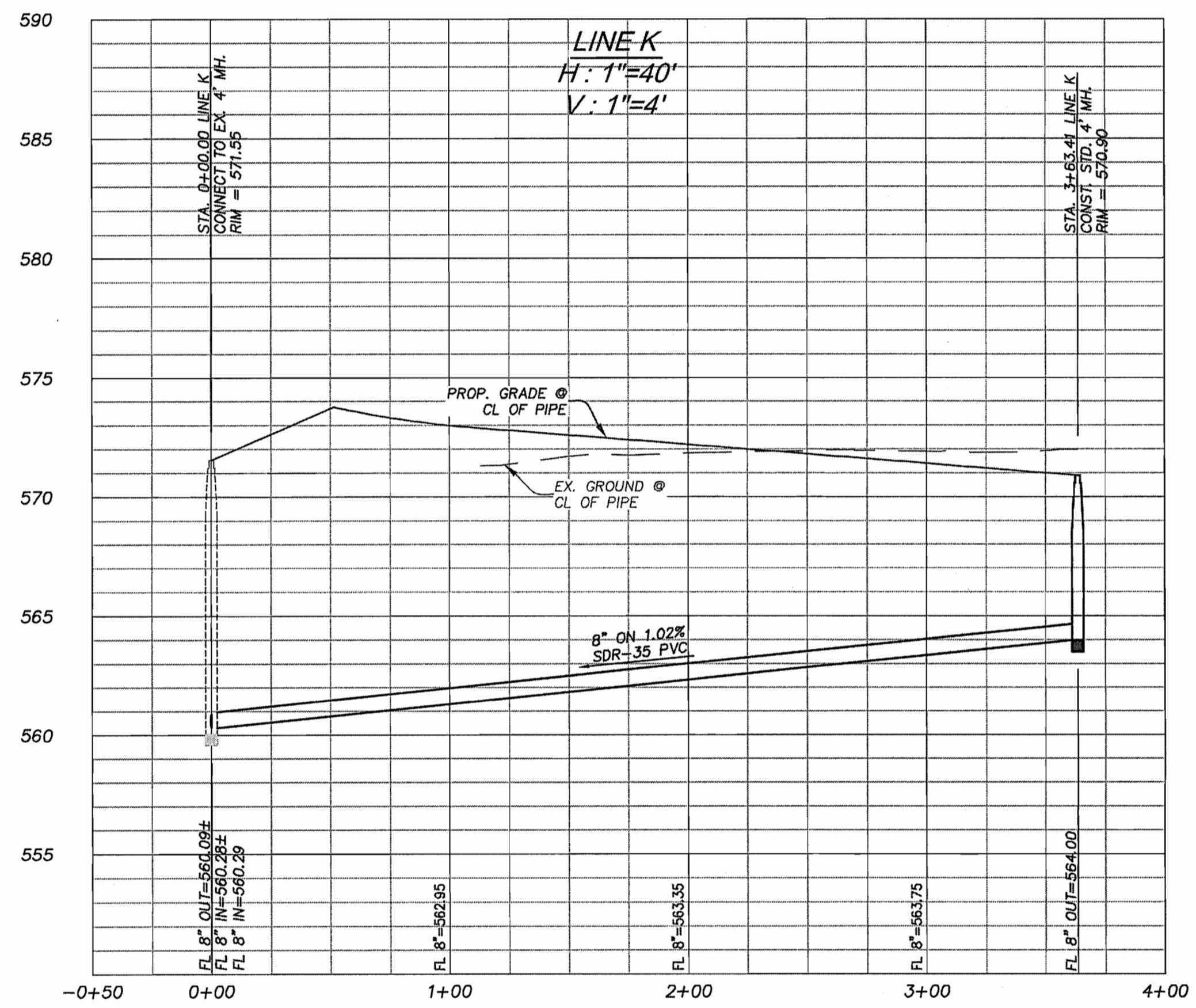

CAUTION: EXISTING UNDERGROUND UTILITIES. CONTRACTOR TO FIELD VERIFY THE LOCATION OF ALL EXISTING UTILITIES PRIOR TO EXCAVATION.

CONSTRUCTION RECORDS
 DATE: 10-10-2017 BY: TDS
 THIS DRAWING INDICATES THE WORK COMPLETED PER INFORMATION SUPPLIED BY THE CONTRACTOR. THE ACCURACY AND COMPLETENESS OF THIS INFORMATION HAS NOT BEEN VERIFIED. ACTUAL ON THE GROUND SURVEY VERIFICATION WAS NOT PERFORMED EXCEPT AS SPECIFICALLY NOTED. TOMDEN ENGINEERING, L.L.P. SHALL NOT BE RESPONSIBLE FOR ANY ERRORS OR OMISSIONS THAT MAY BE INCORPORATED AS A RESULT OF ERRONEOUS INFORMATION PROVIDED BY OTHERS.
 TOMDEN ENGINEERING, L.L.P.

BENCHMARKS
 TBM ON THE SOUTH EDGE OF PAVEMENT OF WASHINGTON STREET AT THE INTERSECTION OF ALUMINUM PLANT ROAD. ELEVATION = 542.91'
 TBM ON THE EAST EDGE OF PAVEMENT OF REDFORD STREET APPROXIMATELY 340' SOUTH OF THE INTERSECTION ON HARTMAN. ELEVATION = 535.43'

Designed By: BBI	App: AS SHOWN
Drawn By: BBI	Date: 05-30-2018
Checked By: BBI	Scale: AS SHOWN
Job No.: BC13054	
Date: 05-30-2018	
Scale: AS SHOWN	
The seal appearing on this document was authorized by Jonathan L. Alvarado, P.E., License No. 227104. All other information on this drawing without proper notification to the responsible engineer is an offense under the Texas Engineering Practice Act, 05-30-2018.	
Binkley & Barfield, Inc. Consulting Engineers Texas Registration Number F-257 1801 Gateway Blvd., Suite 101, Richardson, Texas 75080 Phone (972) 644-2800 www.binkleybarfield.com	
PARK PLACE WEST - PHASE III R. BALLARD SURVEY ABSTRACT NO. 29 ROCKWALL, ROCKWALL COUNTY, TEXAS SANITARY SEWER PROFILES LINE K, LINE L & LINE M	
Sheet No:	C34
	of 37