

CAUTION: EXISTING UNDERGROUND UTILITIES. CONTRACTOR TO FIELD VERIFY THE LOCATION OF ALL EXISTING UTILITIES PRIOR TO EXCAVATION.

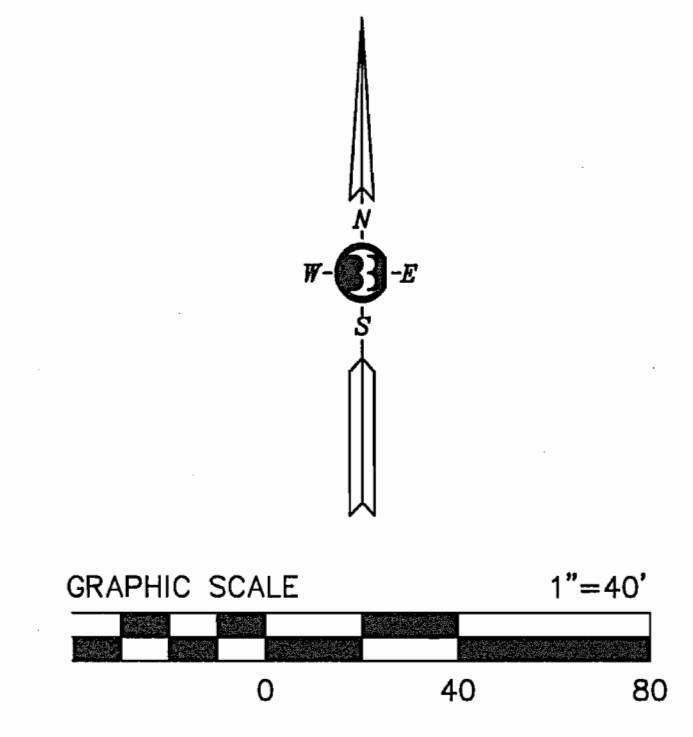

NOTES

- SEE SHT. C1 FOR GENERAL NOTES AND UTILITY NOTES.
- SEE SHT. C19-C27 FOR STORM SEWER PLANS & PROFILES.
- SEE SHT. C31-C34 FOR SANITARY SEWER PROFILES.
- FIRE HYDRANTS SHALL BE INSTALLED A MINIMUM OF THREE FEET (3') AND NO GREATER THAN SIX FEET (6') BEHIND CURB OF A FIRE LANE, DRIVEWAY, ACCESS, AND/OR STREET. ALL FIRE HYDRANTS SHALL HAVE FIVE FEET (5') OF CLEARANCE AROUND.
- ALL WATER & SEWER SERVICES, INSTALLATIONS, TESTING, & INSPECTION SHALL BE PER CITY OF ROCKWALL PUBLIC WORKS STANDARDS OF DESIGN AND CONSTRUCTION.
- WATER SERVICES SHALL BE 1" UNLESS OTHERWISE NOTED AND PLACED AT THE CENTER OF EACH LOT BEHIND THE CURB UNLESS OTHERWISE SHOWN.
- ALL SEWER SERVICES SHALL BE 4" AND LOCATED 10' "DOWNSTREAM" OF THE WATER SERVICE AT THE PROPERTY LINE UNLESS OTHERWISE SHOWN.
- ALL WATER VALVES NOT IN PAVEMENT SHALL HAVE A 12" X 12" X 6" CONCRETE "HOUSEKEEPING" PAD.
- WATER MAIN SHALL BE PVC DR14 C-900 CLASS 200 WITH 4' MINIMUM COVER.

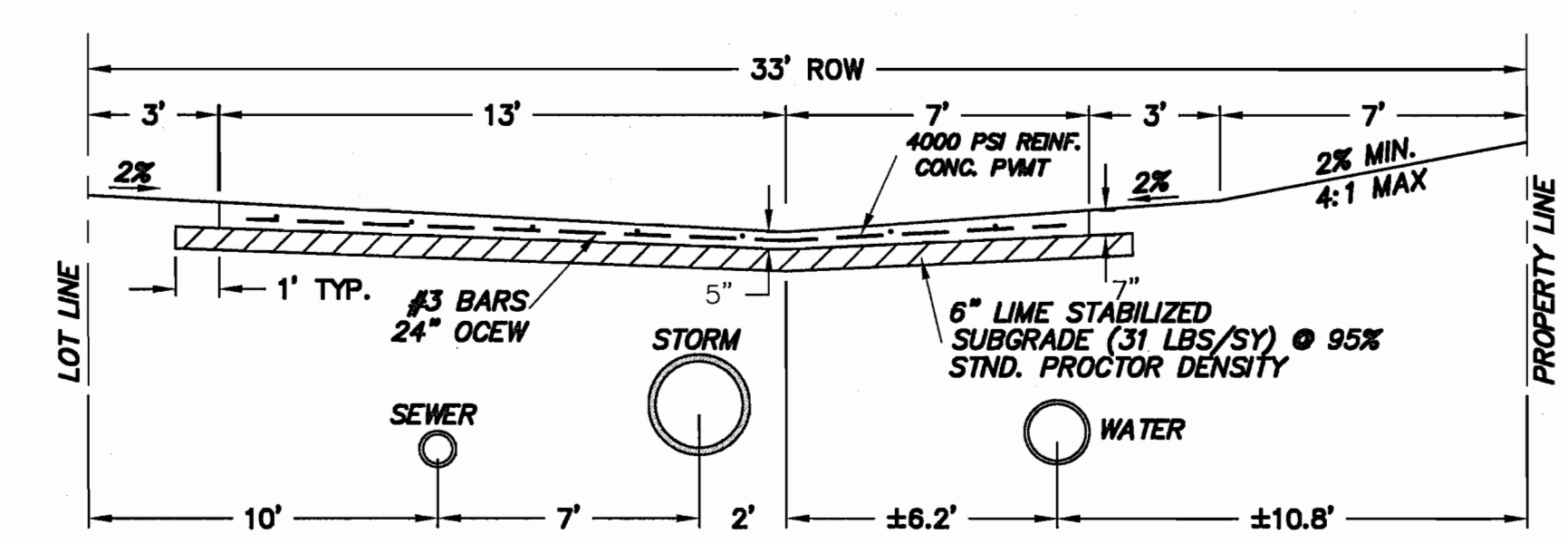

CONSTRUCTION RECORDS

DATE: 10-10-2017 BY: JTS

THIS DRAWING INDICATES THE WORK COMPLETED PER INFORMATION SUPPLIED BY THE CONTRACTOR. THE ACCURACY AND COMPLETENESS OF THIS INFORMATION HAS NOT BEEN VERIFIED, ACTUAL ON THE GROUND SURVEY VERIFICATION WAS NOT PERFORMED EXCEPT AS SPECIFICALLY NOTED. TOMDEN ENGINEERING, L.L.P. SHALL NOT BE RESPONSIBLE FOR ANY ERRORS OR OMISSIONS THAT MAY BE INCORPORATED AS A RESULT OF ERRONEOUS INFORMATION PROVIDED BY OTHERS.

TOMDEN ENGINEERING, L.L.P.

BENCHMARKS

BM ON THE SOUTH EDGE OF PAVEMENT OF WASHINGTON STREET AT THE INTERSECTION OF ALUMINUM PLANT ROAD. ELEVATION = 542.91'

BM ON THE EAST EDGE OF PAVEMENT OF RENEVO STREET APPROXIMATELY 340' SOUTH OF THE INTERSECTION ON HARTMAN. ELEVATION = 535.43'

THIS SHEET SUPPLEMENTS ORIGINAL SHT. C30 AND SHALL BE USED FOR THE CONSTRUCTION OF THE CLOUDED INFORMATION ONLY. BINKLEY BARFIELD SHALL BE RESPONSIBLE FOR ALL OTHER DESIGN INFORMATION SHOWN.

DESIGNED BY: TPJ
DRAWN BY: VSB
CHECKED BY: TPJ
JOB NO.: 10.07.2019
DATE: 10.28.2019
SCALE: AS SHOWN

REMOVED STORM LINE/FINAL MH RIM ELEVATIONS
ADJUST MH RIM ELEVATION

TOMDEN ENGINEERING, L.L.P.
5815 MEADOWCREST
DALLAS, TX 75230
(214) 679-1679
firm@tomden.com
FIRM No. 19244

PARK PLACE WEST - PHASE III
R. BALLARD SURVEY ABSTRACT NO. 29
ROCKWALL, ROCKWALL COUNTY, TEXAS
WATER & SANITARY SEWER PLAN
AREA III

Sheet No: C30.1 OF 37