

N:\BCI3054 (Columbia - Bricker)\05A CAD Files\Phase 3\13054BC-FAY.dwg--Paving Profile, Michael Gardens - Angela Crescent & Bow St. Plotted May 30, 2018 at 3:40pm by jfitzgerald | Last Saved by: jfitzgerald

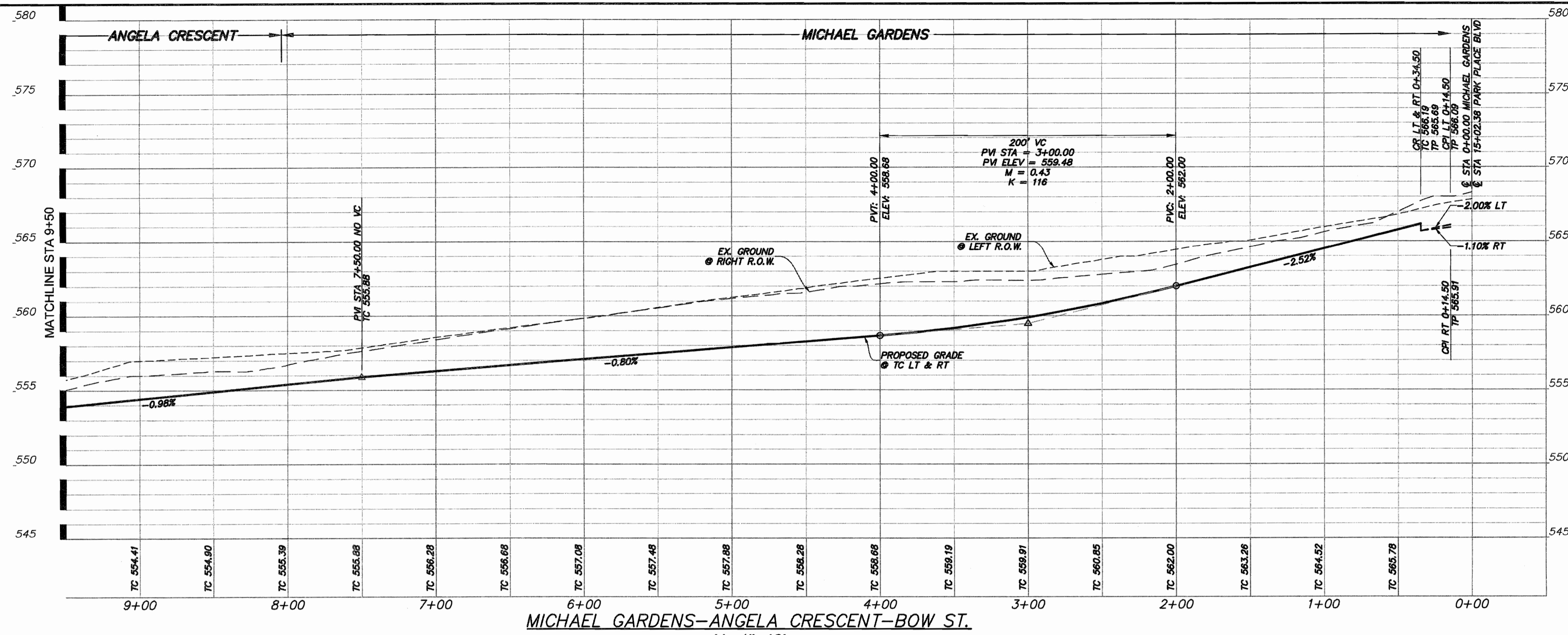

MICHAEL GARDENS-ANGELA CRESCENT-BOW ST.  
 H: 1"=40'  
 V: 1"=4'

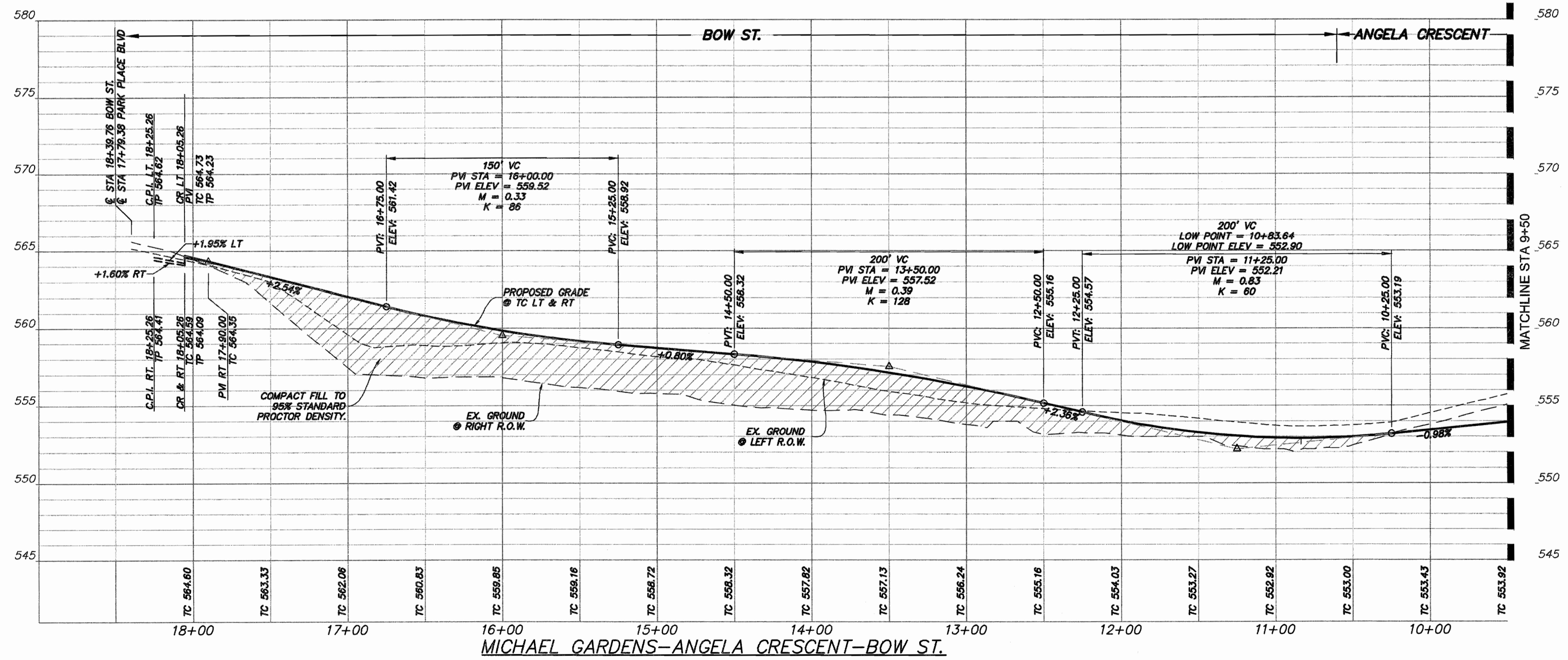

MICHAEL GARDENS-ANGELA CRESCENT-BOW ST.  
 H: 1"=40'  
 V: 1"=4'

CAUTION: EXISTING UNDERGROUND UTILITIES. CONTRACTOR TO FIELD VERIFY THE LOCATION OF ALL EXISTING UTILITIES PRIOR TO EXCAVATION.

App.	Description	Date	Rev

The seal appearing on this document was authorized by Jonathan L. Richardson, L.L.P. All other seals are the property of the responsible engineer. It is the responsibility of the engineer to ensure that the seal is not used for any other project.

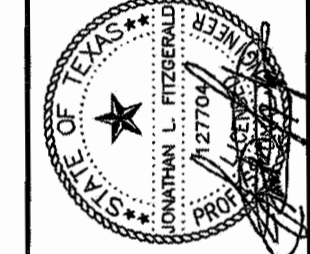

**Binkley & Barfield, Inc.**  
 consulting engineers  
 Texas Registration Number F-257  
 1801 Gateway Blvd, Suite 101 Richardson, Texas 75080 Phone (972) 644-2800  
 www.binkleybarfield.com

**CONSTRUCTION RECORDS**  
 DATE: 10.10.2019 BY: JTB  
 THIS DRAWING INDICATES THE WORK COMPLETED PER INFORMATION SUPPLIED BY THE CONTRACTOR. THE ACCURACY AND COMPLETENESS OF THIS INFORMATION HAS NOT BEEN VERIFIED, ACTUAL ON THE GROUND SURVEY VERIFICATION WAS NOT PERFORMED EXCEPT AS SPECIFICALLY NOTED. TOMDEN ENGINEERING, L.L.P. SHALL NOT BE RESPONSIBLE FOR ANY ERRORS OR OMISSIONS THAT MAY BE INCORPORATED AS A RESULT OF ERRONEOUS INFORMATION PROVIDED BY OTHERS.

**BENCHMARKS**  
 TBM ON THE SOUTH EDGE OF PAVEMENT OF WASHINGTON STREET AT THE INTERSECTION OF ALUMINUM PLANT ROAD. ELEVATION = 542.91'  
 TBM ON THE EAST EDGE OF PAVEMENT OF RENFRO STREET APPROXIMATELY 340' SOUTH OF THE INTERSECTION ON HARTMAN. ELEVATION = 535.45'

PARK PLACE WEST - PHASE III  
 R. BALLARD SURVEY ABSTRACT NO. 29  
 ROCKWALL, ROCKWALL COUNTY, TEXAS  
**PAVING PROFILE**  
 ST MICHAEL, ANGELA CRESCENT & ST JAMES  
 Sheet No: **C5**  
 of 37