

# CIVIL CONSTRUCTION PLANS FOR OLIVE GARDEN I-30 & PLAZA DRIVE PLAZA AT ROCKWALL PORTION OF LOT 10 ROCKWALL BUSINESS PARK EAST SUBDIVISION 1043 EAST IH-30 ROCKWALL, TEXAS



**SITE SPECIFIC NOTES TO CONTRACTOR:**

- CONTRACTOR TO VERIFY PAVEMENT AND STORM INLET ELEVATIONS AT TIE-IN LOCATIONS PRIOR TO CONSTRUCTION AND NOTIFY CIVIL ENGINEER IF THEY DIFFER FROM THOSE SHOWN ON THESE PLANS.

**"RECORD DRAWING"**  
THIS DRAWING HAS BEEN REVISED TO SHOW THOSE CHANGES DURING THE CONSTRUCTION PROCESS VISUALLY VERIFIED BY A REPRESENTATIVE FROM OUR OFFICE AND REPORTED BY THE CONTRACTOR TO KIMLEY-HORN AND ASSOCIATES, INC. AND CONSIDERED TO BE SIGNIFICANT. THIS DRAWING IS NOT GUARANTEED TO BE "AS-BUILT" BUT IS BASED ON THE INFORMATION MADE AVAILABLE.

**C · R · H · O**  
Architecture Interior Planning  
195 South "C" Street 200  
Tustin, California 92780  
714 832-1834  
FAX 832-1910

ARCHITECTS PROJECT #:  
11194

**Kimley-Horn and Associates, Inc.**  
601 NW LOOP 410, SUITE 350  
SAN ANTONIO, TEXAS 78216  
PHONE: 210-541-8166  
FAX: 210-541-8699  
WWW.KIMLEY-HORN.COM  
TBP# Firm No. 928

© 2011 KIMLEY-HORN AND ASSOCIATES, INC.  
KHA PROJECT # 063887045

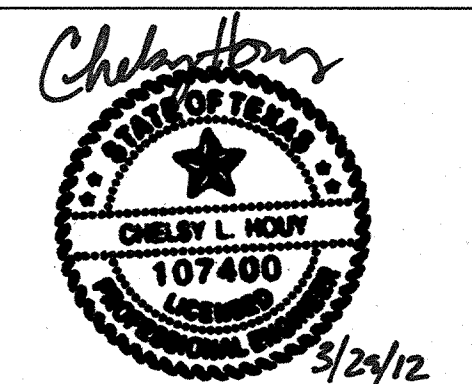

Issue Date: 07/18/11

**REVISION INFORMATION**

NO.	DATE	DESCRIPTION
1	07/21/11	GENERAL REVISIONS
2	09/07/11	CITY COMMENTS
3	10/06/11	AGENCY REVISIONS
4	10/19/11	AGENCY REVISIONS
5		
6		
7		

Restaurant #: 11L0042

**OLIVE GARDEN  
PROTOTYPE OG-P-75R  
ROCKWALL BUSINESS  
PARK EAST SUBDIVISION  
1043 EAST IH-30**

**AUTHORIZED FOR: PERMIT/BID  
ROCKWALL, TEXAS**

DRAWING

**COVER SHEET**

**C1.1**

**INDEX OF SHEETS**

SHEET NO.	DESCRIPTION	REVISION
<b>CIVIL ENGINEERING (KIMLEY-HORN AND ASSOCIATES)</b>		
C1.1	COVER SHEET	△ △ △
C1.2	REPLAT (1 OF 2)	△
C1.3	REPLAT (2 OF 2)	△
C1.4	ALTA SURVEY	△
C1.5	GENERAL CONSTRUCTION NOTES	△ △
C2.1	EROSION CONTROL PLAN	△
C2.2	EROSION CONTROL DETAILS	△
C3.1	SITE AND DIMENSION CONTROL PLAN	△ △
C3.2	PAVING PLAN	△
C4.1	GRADING PLAN	△
C4.2	DRAINAGE AREA MAP	△ △ △
C4.3	STORM SEWER PLAN	△
C5.1	UTILITY PLAN	△ △ △ △
C6.1	MISCELLANEOUS CONSTRUCTION DETAILS	△
C7.1	CITY UTILITY DETAILS	
C8.1	GEOTECHNICAL REPORT (1 OF 6)	
C8.2	GEOTECHNICAL REPORT (2 OF 6)	
C8.3	GEOTECHNICAL REPORT (3 OF 6)	
C8.4	GEOTECHNICAL REPORT (4 OF 6)	
C8.5	GEOTECHNICAL REPORT (5 OF 6)	
C8.6	GEOTECHNICAL REPORT (6 OF 6)	
<b>LANDSCAPE ARCHITECTURE (KIMLEY-HORN AND ASSOCIATES)</b>		
L1.1	LANDSCAPE PLAN	△ △
L1.2	LANDSCAPE DETAILS	

**PLAN REVISION LOG**

NO.	DATE	DESCRIPTION
1	07/21/11	GENERAL REVISIONS
2	09/07/11	CITY COMMENTS
3	10/06/11	AGENCY REVISIONS
4	10/19/11	AGENCY REVISIONS

**BENCHMARKS**

**VERTICAL DATUM - NAVD 88**  
City of Rockwall monument No. 50 (reset R005-1) - a concrete monument with brass cap found in the center median of Summit Ridge Drive at its intersection with F.M. HWY No. 740. Elevation=578.63'

City of Rockwall monument No. 51 (reset #1) - a concrete monument with brass cap found near the northwest corner of a parking lot adjacent to the southwest corner of the intersection of Summer Lee and F.M. 740. Elevation=567.70'

**BM-1**  
"X" set on the west corner of a concrete curb inlet located on the northwest side of a parking lot approximately 60 feet southeast from the center of the east bound service road of IH 30 and 270 feet southwest from the center of the northernmost entrance to Plaza of Rockwall. Elevation=552.98'

ANTICIPATED CONSTRUCTION START DATE:  
NOVEMBER 2011

NOTE: ALL RESPONSIBILITY FOR ADEQUACY OF DESIGN REMAINS WITH THE DESIGN ENGINEER. THE CITY OF ROCKWALL, IN REVIEWING AND RELEASING PLANS FOR CONSTRUCTION, ASSUMES NOT RESPONSIBILITY FOR ADEQUACY OR ACCURACY OF DESIGN.

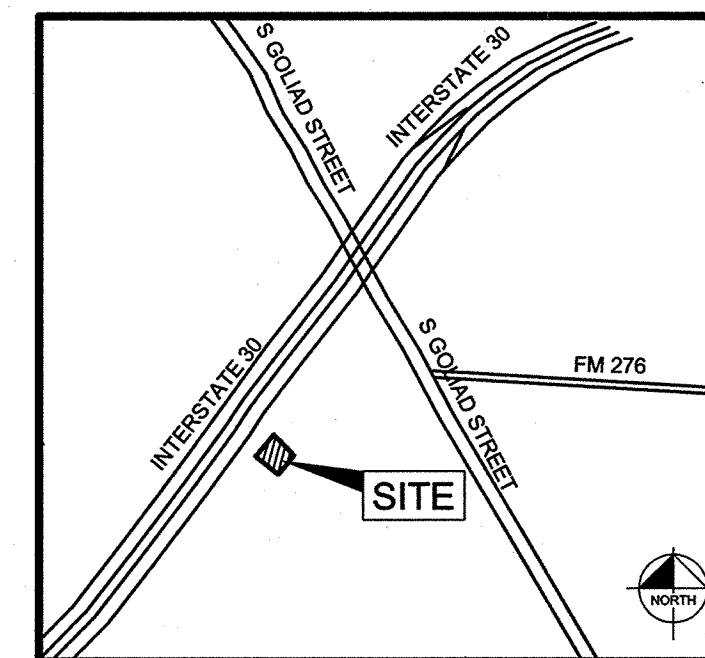

**LOCATION MAP**  
NOT TO SCALE

**PLANS SUBMITTAL/REVIEW LOG**

PERMIT SUBMITTAL 7/18/2011

**PROJECT TEAM:**

**DEVELOPER/APPLICANT**

**DARDEN**  
1000 DARDEN CENTER DRIVE  
ORLANDO, FLORIDA 32837  
PH. (407) 245-5935  
FAX (407) 342-6781  
CONTACT: JACK DeGAGNE  
JDEGAGNE@DARDEN.COM

**CIVIL ENGINEER**

**KIMLEY-HORN AND ASSOCIATES, INC.**  
601 NW LOOP 410, SUITE 350  
SAN ANTONIO, TEXAS 78216  
PH. (210) 541-9166  
FAX (210) 541-8699  
CONTACT: CHELSY L. HOUY, P.E.  
CHELSY.HOUY@KIMLEY-HORN.COM

**ARCHITECT**

**CRHO**  
195 SOUTH "C" STREET 200  
TUSTIN, CALIFORNIA 92780  
PH. (714) 832-1834  
FAX (714) 832-1910  
CONTACT: ROBERTO DIAZ

**LANDSCAPE ARCHITECT**

**KIMLEY-HORN AND ASSOCIATES, INC.**  
2201 WEST ROYAL LANE, SUITE 275  
IRVING, TEXAS 75063  
PH. (214) 420-5632  
FAX (214) 420-5680  
CONTACT: DAVID YOUNG, RLA  
DAVID.YOUNG@KIMLEY-HORN.COM

**LIST OF CONTACTS:**

**SANITARY SEWER**

**CITY OF ROCKWALL ENGINEERING  
DEPARTMENT**  
385 S. GOLIAD ST.  
ROCKWALL, TEXAS 75087  
PH. (972) 771-7746  
CONTACT: AMY WILLIAMS

**GAS**

**ATMOS ENERGY**  
1310 STATE WHY 66  
GARLAND, TEXAS 75040  
PH. (972) 485-6277  
CONTACT: DINAH WOOD

**ELECTRIC**

**ONCOR ELECTRIC DELIVERY COMPANY**  
400 WEST VIRGINIA  
MCKINNEY, TEXAS 75069  
PH. (972) 569-6310  
CONTACT: RUSSELL LEWIS

**PHONE**

**AT&T**  
PH. (903) 475-2092  
CONTACT: DUANE WELS

**WATER**

**CITY OF ROCKWALL ENGINEERING  
DEPARTMENT**  
385 S. GOLIAD ST.  
ROCKWALL, TEXAS 75087  
PH. (972) 771-7746  
CONTACT: AMY WILLIAMS

**STORM SEWER**

**CITY OF ROCKWALL ENGINEERING  
DEPARTMENT**  
385 S. GOLIAD ST.  
ROCKWALL, TEXAS 75087  
PH. (972) 771-7746  
CONTACT: AMY WILLIAMS

**CABLE**

**CHARTER COMMUNICATION**  
15100 TRINITY BLVD., SUITE 500  
FT. WORTH, TEXAS 76155  
PH. (817) 298-3528  
CONTACT: TONY OBAS

Drawing name: K:\SNA\_Civil\080807045\080807045\080807045\080807045.dwg C:\P-CITY Mar 28, 2012 1:43pm by: jmh/kmh/ekw THIS DOCUMENT, TOGETHER WITH THE CONCEPTS AND RESPONSES PRESENTED HEREIN, AS AN INSTRUMENT OF SERVICE, IS INTENDED ONLY FOR THE SPECIFIC PURPOSE AND CLIENT FOR WHICH IT WAS PREPARED. REUSE OF AND IMPROPER RELIANCE ON THIS DOCUMENT WITHOUT WRITTEN AUTHORIZATION AND ADAPTATION BY KIMLEY-HORN AND ASSOCIATES, INC. SHALL BE WITHOUT LIABILITY TO KIMLEY-HORN AND ASSOCIATES, INC.