

BOUNDARY CURVE DATA

CURVE	RADIUS	DELTA	LENGTH	TANGENT	CHORD	BEARING
C-1	5779.58'	03°45'14"	378.68'	189.41'	378.61'	S47°52'37"W
C-2	175.00'	30°11'40"	92.22'	47.21'	91.16'	S74°54'12"E

NAD-83 TEXAS STATE PLANE COORDINATES

POINT	X	Y
A	7,008,735.2662	2,603,598.6804
B	7,008,706.4952	2,605,607.9914
C	7,007,477.4464	2,606,999.8103
D	7,005,763.6086	2,605,207.2274

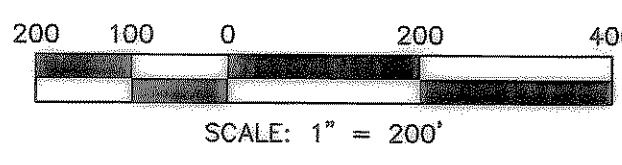

LINE TABLE

TANGENT	BEARING	LENGTH
T1	N89°10'53"E	88.02'
T2	N66°53'53"W	119.80'
T3	N46°00'00"E	139.99'
T4	S45°22'00"W	459.81'
T5	S62°03'31"W	442.73'
T6	S89°34'25"W	195.63'
T7	S00°06'12"W	425.67'
T8	N46°00'00"E	77.04'
T9	S44°00'00"E	156.38'
T10	S07°08'04"W	57.74'
T11	S07°08'04"W	98.71'
T12	N44°00'00"W	172.24'
T13	N35°38'30"W	137.59'
T14	N15°09'41"W	173.85'
T15	S18°03'10"W	160.01'
T16	S27°13'42"E	216.91'
T17	S27°13'42"E	220.07'
T18	N89°00'00"W	7.07'
T19	N01°00'00"E	7.07'
T20	S87°53'32"W	200.15'
T21	N84°26'27"W	63.01'

CURVE TABLE

CURVE	RADIUS	DELTA	LENGTH	TANGENT	CHORD	BEARING
C-1	170.000'	89°22'00"	265.152'	168.131'	239.084'	N00°41'00"E
C-2	200.000'	89°22'00"	311.943'	197.801'	281.275'	N00°41'00"E
C-3	230.000'	59°36'27"	239.275'	131.742'	228.634'	N14°11'47"W
C-4	60.000'	300°00'00"	314.154'	34.641'	60.000'	N44°00'00"W
C-5	150.000'	67°06'07"	175.670'	99.475'	165.804'	N79°33'04"E
C-6	120.000'	67°06'07"	140.536'	79.580'	132.643'	N79°33'04"E
C-7	180.000'	67°06'07"	210.804'	119.370'	198.965'	N79°33'04"E
C-8	60.000'	300°00'00"	314.154'	34.641'	60.000'	N44°00'00"W
C-9	60.000'	185°44'46"	194.510'	119.560'	60.000'	N44°00'00"W
C-10	30.000'	89°22'00"	46.791'	29.670'	42.191'	N89°19'00"W
C-11	60.000'	300°00'00"	314.154'	34.641'	60.000'	N44°00'00"E
C-12	300.000'	44°38'00"	233.696'	123.141'	227.835'	N22°19'00"W
C-13	270.000'	44°38'00"	210.326'	110.827'	205.052'	N22°19'00"W
C-14	330.000'	11°28'34"	66.096'	33.160'	65.987'	N38°53'43"W
C-15	330.000'	22°43'32"	130.887'	66.316'	130.033'	N11°21'46"W
C-16	200.000'	27°30'53"	96.043'	48.967'	95.125'	S75°48'58"W
C-17	170.000'	27°30'53"	81.637'	41.622'	80.856'	S75°48'58"W
C-18	230.000'	27°30'53"	110.450'	56.312'	109.393'	S75°48'58"W
C-19	40.000'	89°53'48"	62.76'	39.93'	56.52'	N45°03'06"E
C-20	60.000'	186°16'34"	195.065'	94.420'	119.820'	N45°03'06"E
C-21	30.000'	89°53'48"	47.069'	29.946'	42.388'	N45°03'06"E
C-22	230.000'	14°46'12"	59.289'	29.810'	59.126'	N37°58'54"E

** NOTE: APPROXIMATE ALIGNMENT OF FUTURE ROAD IS INDICATED. EXACT ALIGNMENT OF ROAD IS TO BE DETERMINED WHEN TRACT IS DEVELOPED IN THE FUTURE.

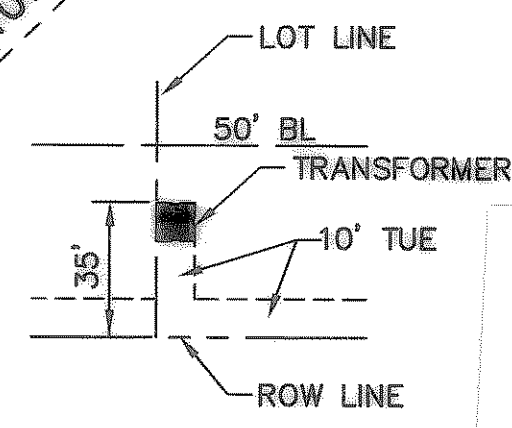

TYPICAL T.U. ELECTRIC TRANSFORMER LOCATION
N.T.S.
NOTE: TUE = T.U. ELECTRIC

FINAL PLAT THE OAKS OF BUFFALO WAY

AN ADDITION TO THE COUNTY OF ROCKWALL, SITUATED IN THE W.W. FORD SURVEY, ABSTRACT 80 ROCKWALL COUNTY, TEXAS

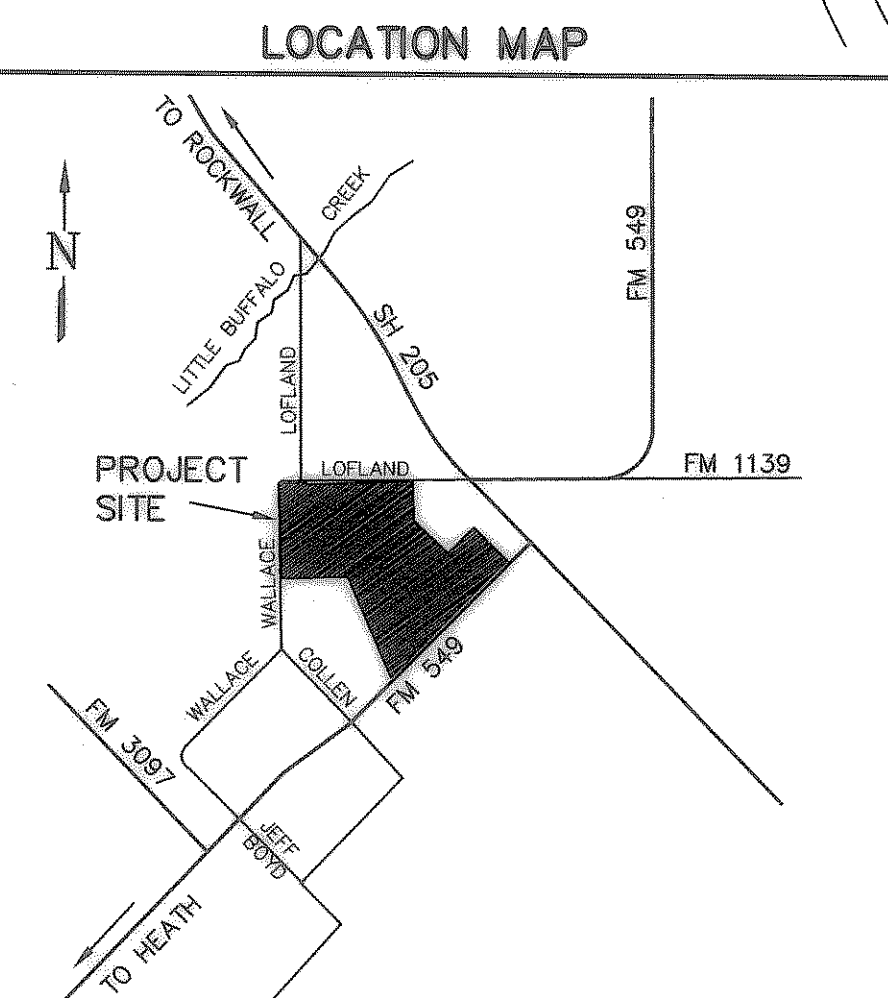

- NOTE:**
1. ALL STREETS ARE PRIVATE AND SHALL BE MAINTAINED BY HOME OWNERS ASSOCIATION.
 2. ALL STREETS SHALL BE A 60 FOOT UTILITY, DRAINAGE, AND ACCESS EASEMENT.
 3. ALL COMMON AREAS SHALL BE MAINTAINED BY THE HOME OWNERS ASSOCIATION.
 3. ALL STREETS SHALL BE CONSTRUCTED OF 6" 3600 PSI CONCRETE AND A WIDTH OF 22 FEET.

58 SINGLE FAMILY LOTS
2 COMMON AREAS
109.57 ACRES

OAKS OF BUFFALO WAY, L.L.C. OWNER
P.O. BOX 85 (970) 468-8313
DILLON, COLORADO 80435-0085

JOHN B. FINCHER SURVEYOR
2001 PINEHURST LANE, #2202 (972) 613-9274
MESQUITE, TEXAS 75150

JANUARY 1997

CONTACT: MARC O. BENTLEY, P.E.
3200 BROADWAY, STE. 160
GARLAND, TEXAS 75043
(972) 278-2850

35 South

SHEET 1 OF 2