

NOTE:
Water & San. Sew. Lines to be Warped to 5' off Back of Curb at Storm Sewer Inlets.

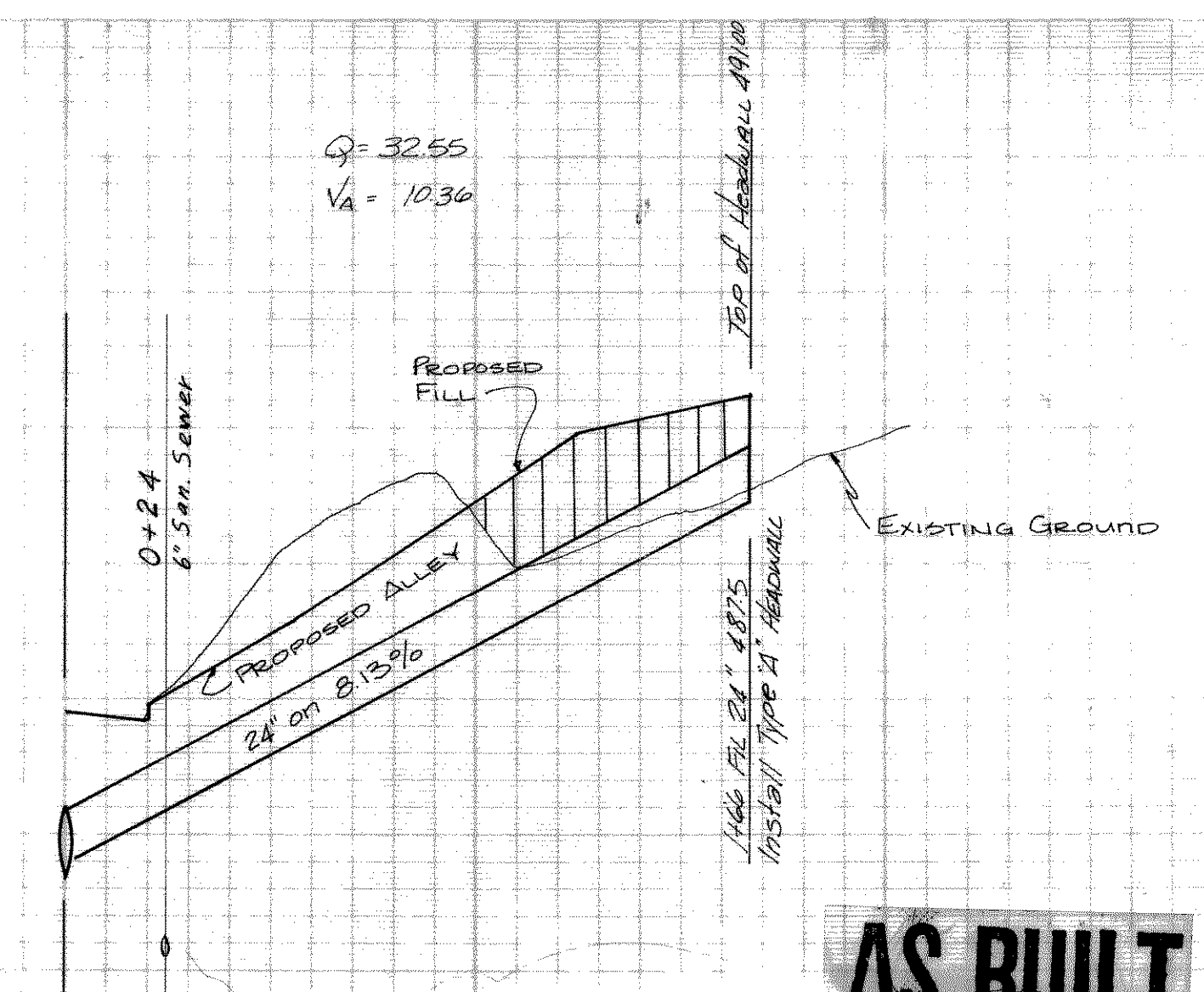
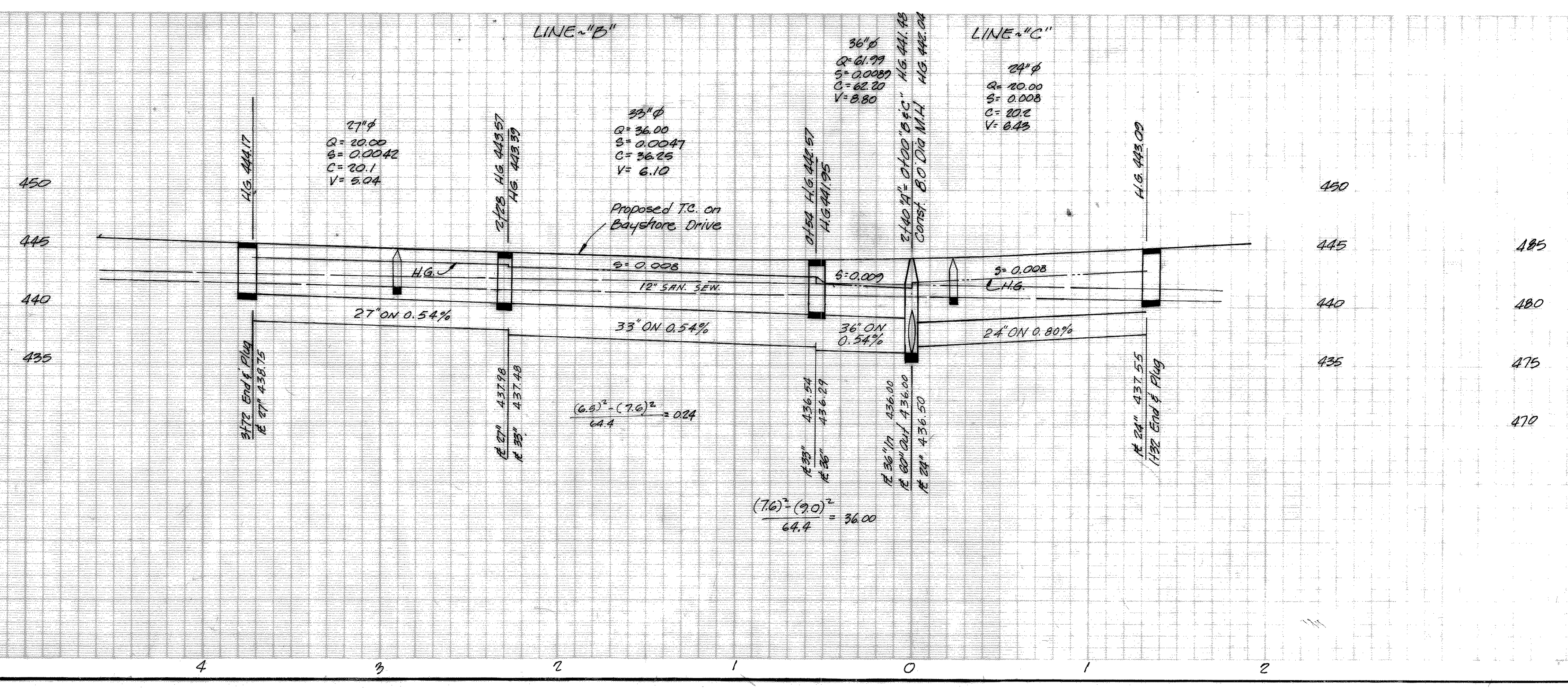

AS BUILT

REVISED: 9-18-80

NORTHSHORE PHASE I-A						
PROPOSED STORM SEWER						
BAYSHORE DRIVE						
ROCKWALL COUNTY, TEXAS						
HAROLD L. EVANS & CONSULTING ENGINEER						
DESIGN	DRAWN	DATE	SCALE	NOTES	FILE	NO.
H.L.E.	R.N.	6-25-80	1"=40' H 1/2"=6' V			