

NOTE:
SHAPE AND GRADE CHANNEL
UPSTREAM AND DOWNSTREAM
FOR MAXIMUM CAPACITY OF
WATER THROUGH BOX CULVERT.

Q CURVE DATA
Δ = 34° 02' 31"
R = 200.00'
T = 61.23'
L = 118.83'

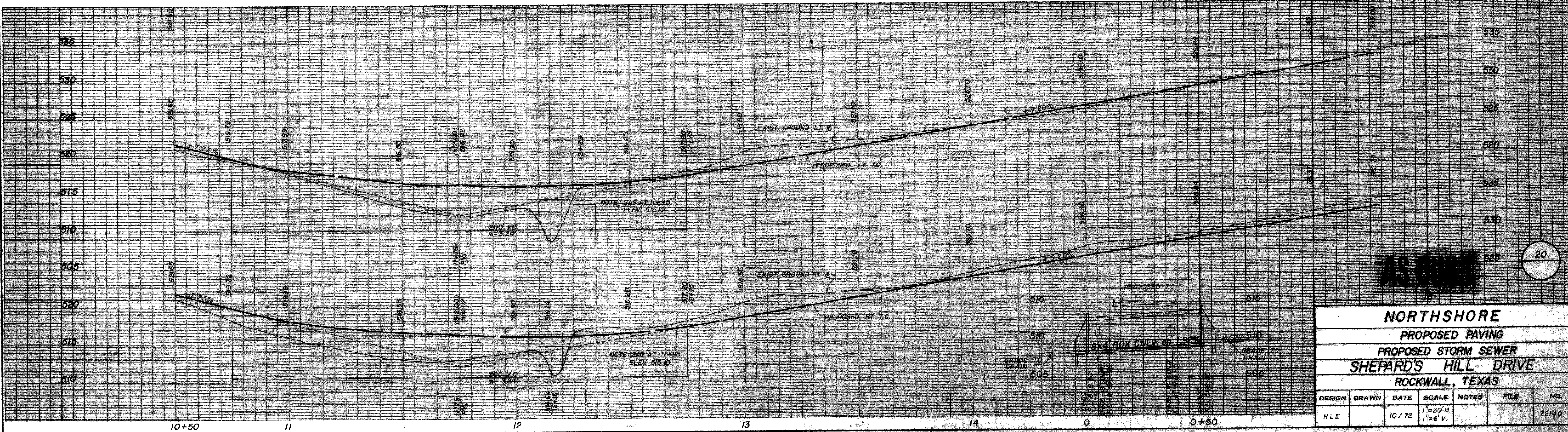
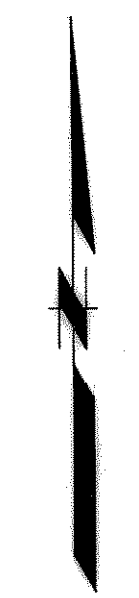

NORTHSHORE						
PROPOSED PAVING						
PROPOSED STORM SEWER						
SHEPARD'S HILL DRIVE						
ROCKWALL, TEXAS						
DESIGN	DRAWN	DATE	SCALE	NOTES	FILE	NO.
HLE		10/72	1"=20' H. 1"=6' V.			72140