

Plotted By: Laporte, Brian Sheet: S&K:Kha Layout: C5.1 STORM SEWER PROFILE July 08, 2013 06:48:35pm K:\HOU_Civil\67781100-MidSouth Bank\DWG\PlanSheets\C-Storm_Profile.dwg
 This document, together with the concepts and designs presented herein, is intended only for the specific purpose and client for which it was prepared. Reproduction or use of any part of this document without written authorization and copyright by Kimley-Horn and Associates, Inc. shall be without liability to Kimley-Horn and Associates, Inc.

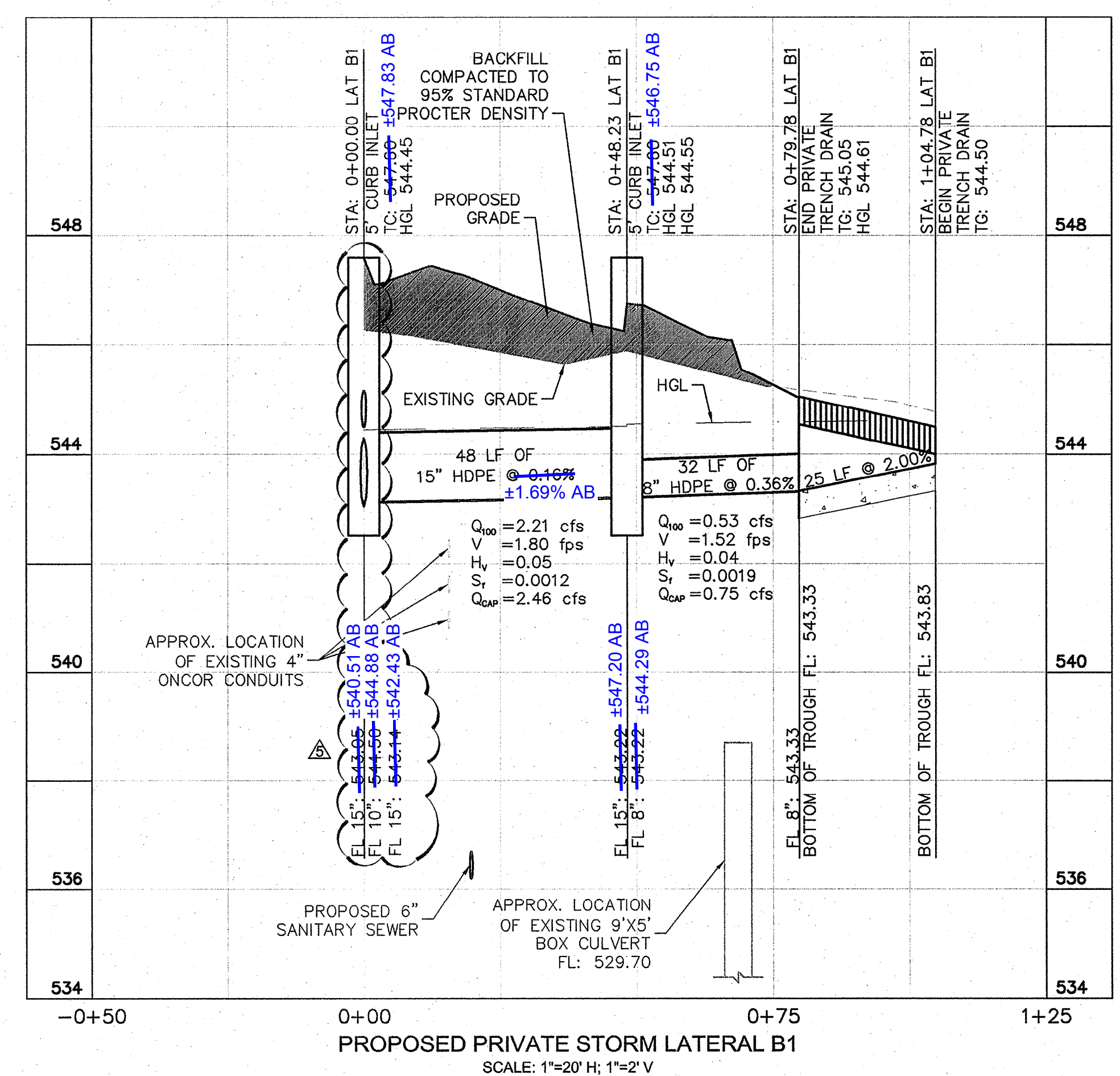

RECORD DRAWING
 THIS RECORD DRAWING HEREIN REFLECTS TO THE BEST OF THE DESIGN ENGINEER'S KNOWLEDGE, THE APPROXIMATE LOCATION OF THE CONSTRUCTED WORK, USING INFORMATION AS PROVIDED BY THE CONTRACTORS AND SURVEYED GRADES.
 M. A. KIRKLAND 7/20/13

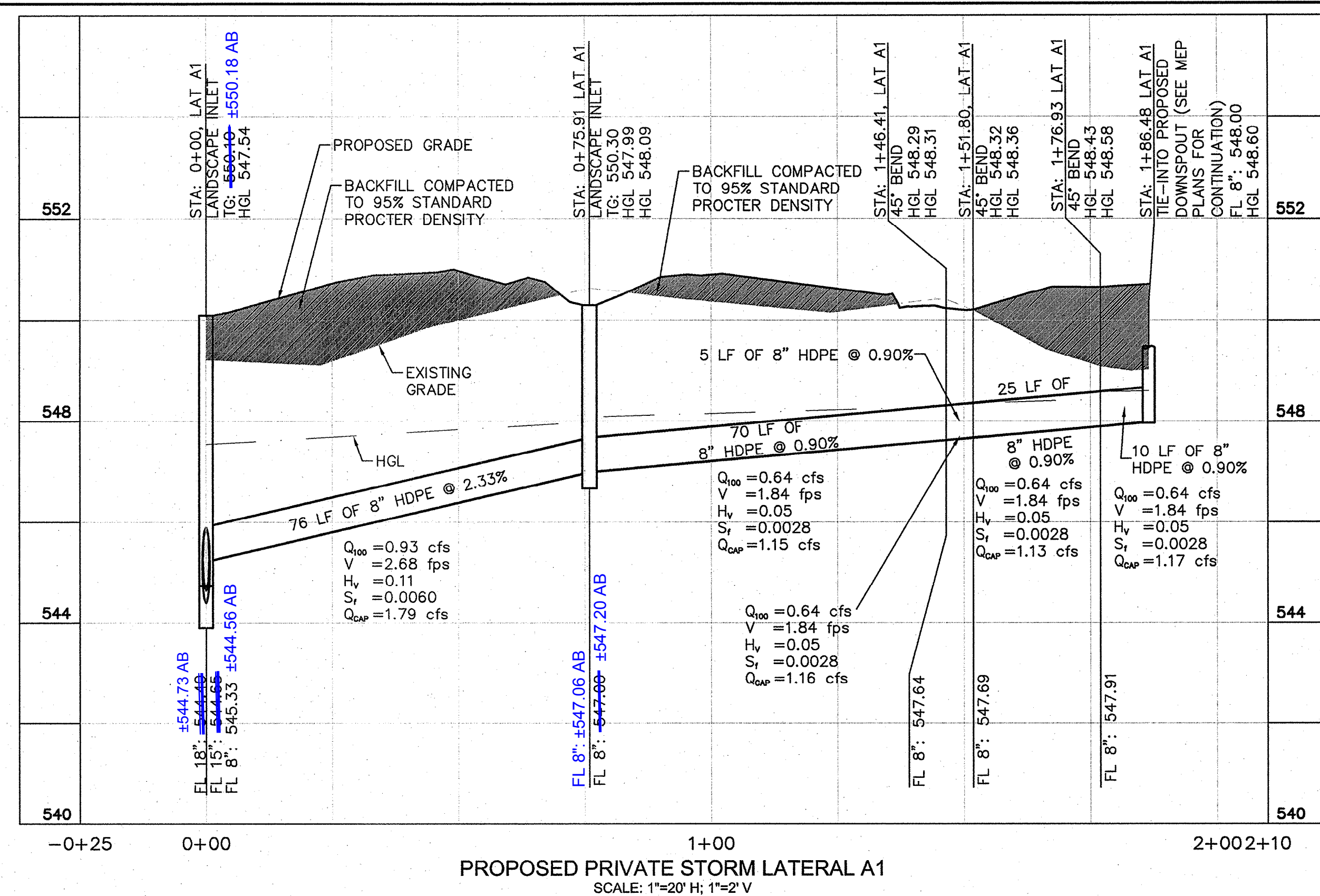
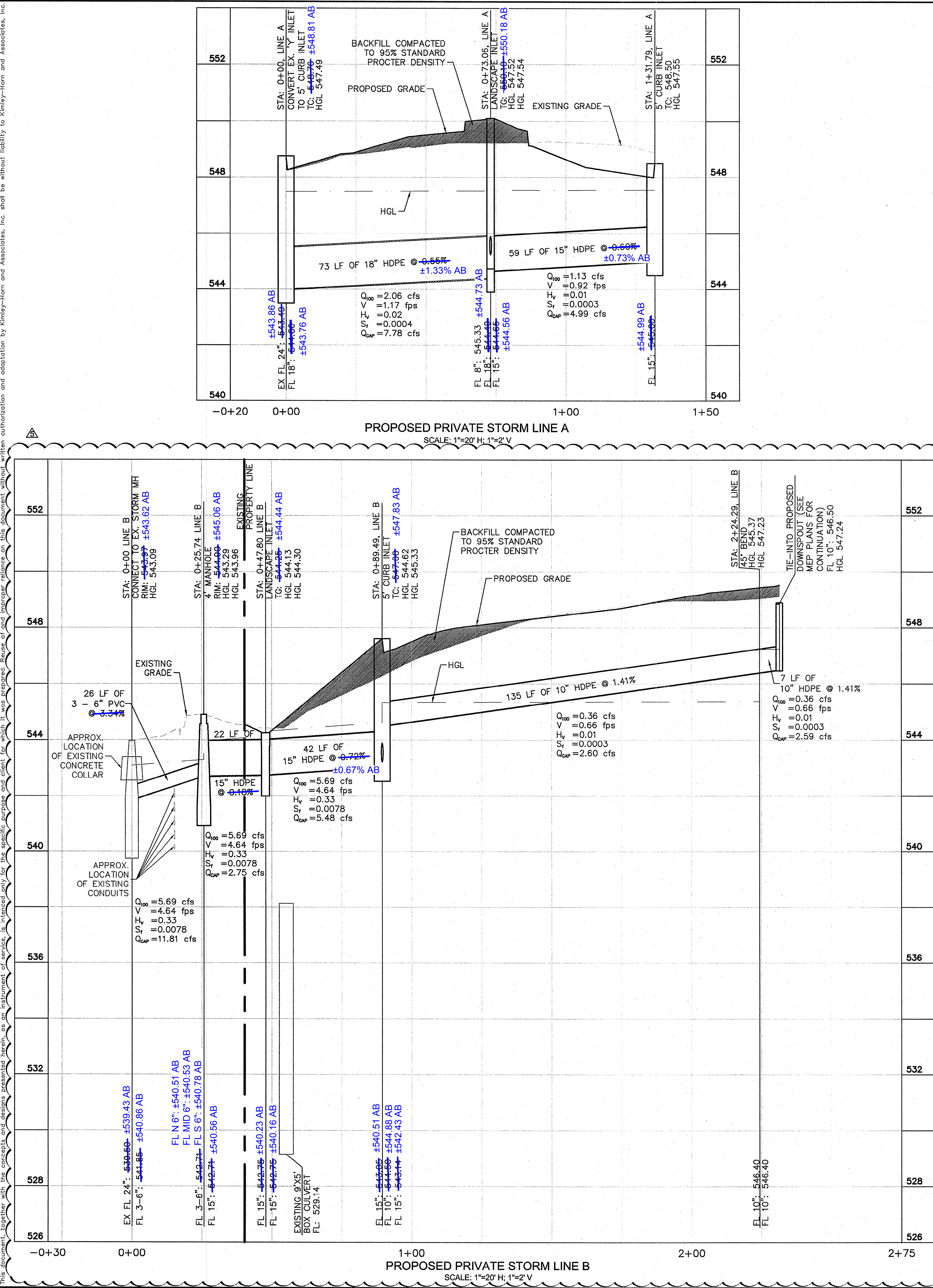
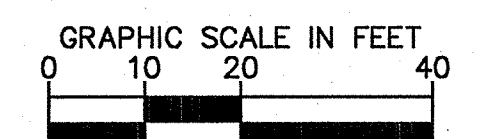

STOP!
CALL BEFORE YOU DIG
 DIG TESS
 1-800-DIG-TESS
 (@ least 72 hours prior to digging)

ALL RESPONSIBILITY FOR ADEQUACY OF DESIGN REMAINS WITH THE DESIGN ENGINEER. THE CITY OF ROCKWALL, IN REVIEWING AND RELEASING PLANS FOR CONSTRUCTION, ASSUMES NO RESPONSIBILITY FOR ADEQUACY OR ACCURACY OF DESIGN.

ALERT TO CONTRACTOR:
 1. THE PRESENCE OF GROUNDWATER SHOULD BE ANTICIPATED ON THIS PROJECT. CONTRACTOR'S BID SHALL INCLUDE CONSIDERATION FOR THIS ISSUE. WHEN PERFORMING GRADING OPERATIONS DURING PERIODS OF WET WEATHER, PROVIDE ADEQUATE DRAINAGE, DRAINAGE AND GROUND WATER MANAGEMENT TO CONTROL MOISTURE OF SOILS. REFER TO MASTER SITE SPECIFICATIONS.
 2. ALL WM GENERAL CONTRACTOR WORK TO BE COMPLETED (EARTHWORK, FINAL UTILITIES, AND FINAL GRADING) BY THE MILESTONE DATE IN PROJECT DOCUMENTS. OUTLOT AREA TO BE KEPT FREE OF JOB TRAILERS AND STORAGE AFTER THE CONTRACT MILESTONE DATE FOR THE OUTLOT. WM GENERAL CONTRACTOR TO PROVIDE CLEAR ACCESS FOR OUTLOT CONTRACTOR TO THE SPECIFIC PARCEL AT ALL TIMES AFTER MILESTONE DATE. PURCHASER OF OUTLOT TO PROVIDE PERMIT DOCUMENTS AND SWPPP REQUIRED BY STATE/LOCAL REQUIREMENTS FOR SPECIFIC OUTLOT.

KHA PROJECT	067781100	DATE	APRIL 2013	SCALE	AS SHOWN	DESIGNED BY	BAL	DRAWN BY	BAL	CHECKED BY	SCF
FIELD CONDITIONS	07/03/2013	CURB REVISION	06/17/2013	FIELD CONDITIONS	06/04/2013	STORM REVISION	05/15/2013	FIELD CONDITIONS	05/03/2013	REVISIONS	DATE

Kimley-Horn and Associates, Inc.
 2010 KIMLEY-HORN AND ASSOCIATES, INC.
 12012 WICKCHESTER LANE, SUITE 500, HOUSTON, TX 77079
 PHONE: 281-897-7600 FAX: 281-597-8032
 TBP# FIRM REGISTRATION 1-928

STATE OF TEXAS
 MARK KIRKLAND
 98342
 REGISTERED PROFESSIONAL ENGINEER
 7/20/13

STORM SEWER PROFILE

ROCKWALL BRANCH
 PREPARED FOR
MIDSOUTH BANK

CITY OF ROCKWALL
 SHEET NUMBER
C5.1