

1+50.00 Alley Sta. ~ Construct
10' Curb Inlet w/10' Of Curb On
Each Side Of Inlet, Inv.=565.77
TC=566.45, Lip=565.62, FL=561.95
Warp Invert To Drain Into Inlet

Pavement Sta. 14+40 ~
Construct Std. 10 Ft.
Curb Inlet
TC=565.20, FL=561.20

Pavement Sta. 0+55 ~
Construct Std. 15 Ft.
Curb Inlets
TC=565.29, FL=561.29

Pavement Sta. 0+55 ~
Construct Std. 10 Ft.
Curb Inlets
TC=565.29, FL=561.29

0+60.00 Alley Sta. ~ Construct
10' Curb Inlet w/10' Of Curb On
Each Side Of Inlet, Inv.=553.76
TC=554.44, Lip=553.61, FL=549.94
Warp Invert To Drain Into Inlet

Pavement Sta. 0+58 ~
Construct Std. 10 Ft.
Curb Inlet
TC=552.36, FL=548.36

REFER TO MEADOWCREEK ESTATES PHASE III
FOR EXISTING STORM SEWER IN FAIRCREST DRIVE

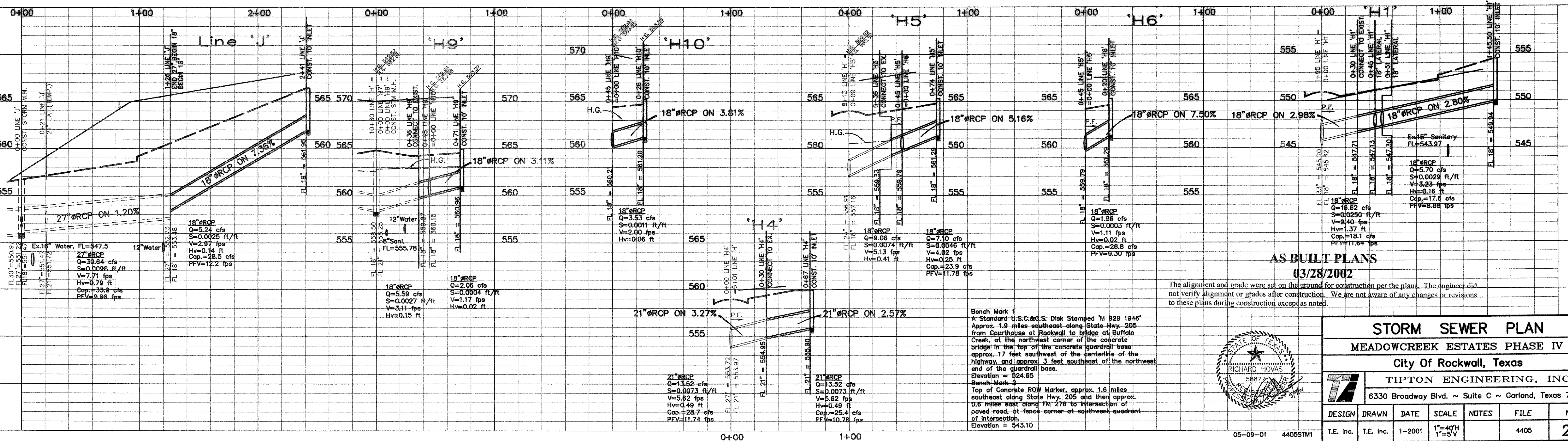

AS BUILT PLANS
03/28/2002

The alignment and grade were set on the ground for construction per the plans. The engineer did not verify alignment or grades after construction. We are not aware of any changes or revisions to these plans during construction except as noted.

Bench Mark 1
A Standard U.S.C.&G.S. Disk Stamped "M 929 1946"
Approx. 1.9 miles southeast along State Hwy. 205
from Courthouse at Rockwall to bridge at Buffalo
Creek, at the northwest corner of the concrete
bridge in the top of the concrete guardrail base
approx. 17 feet southwest of the centerline of the
highway, and approx. 3 feet southeast of the northwest
end of the guardrail base.
Elevation = 524.85
Bench Mark 2
Top of Concrete ROW Marker, approx. 1.6 miles
southeast along State Hwy. 205 and then approx.
0.6 miles east along FM 276 to intersection of
paved road, at fence corner at southwest quadrant
of intersection.
Elevation = 543.10

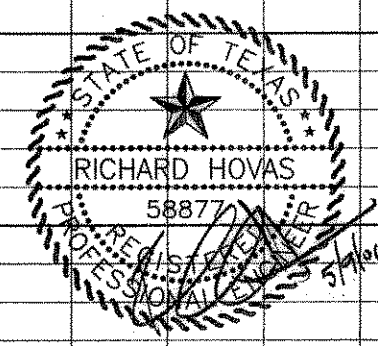

STORM SEWER PLAN						
MEADOWCREEK ESTATES PHASE IV						
City of Rockwall, Texas						
TIPTON ENGINEERING, INC.						
6330 Broadway Blvd. ~ Suite C ~ Garland, Texas 75043						
DESIGN	DRAWN	DATE	SCALE	NOTES	FILE	NO.
T.E. Inc.	T.E. Inc.	1-2001	1"=40' 1"=5'V		4405	23