

RELEASED FOR CONSTRUCTION
 ALL RESPONSIBILITY FOR ADEQUACY OF DESIGN
 REMAINS WITH THE DESIGN ENGINEER. THE CITY
 OF ROCKWALL, IN REVIEWING AND RELEASING
 PLANS FOR CONSTRUCTION, ASSUMES NO
 RESPONSIBILITY FOR ADEQUACY OR ACCURACY
 OF DESIGN.

11-18-10
 DATE

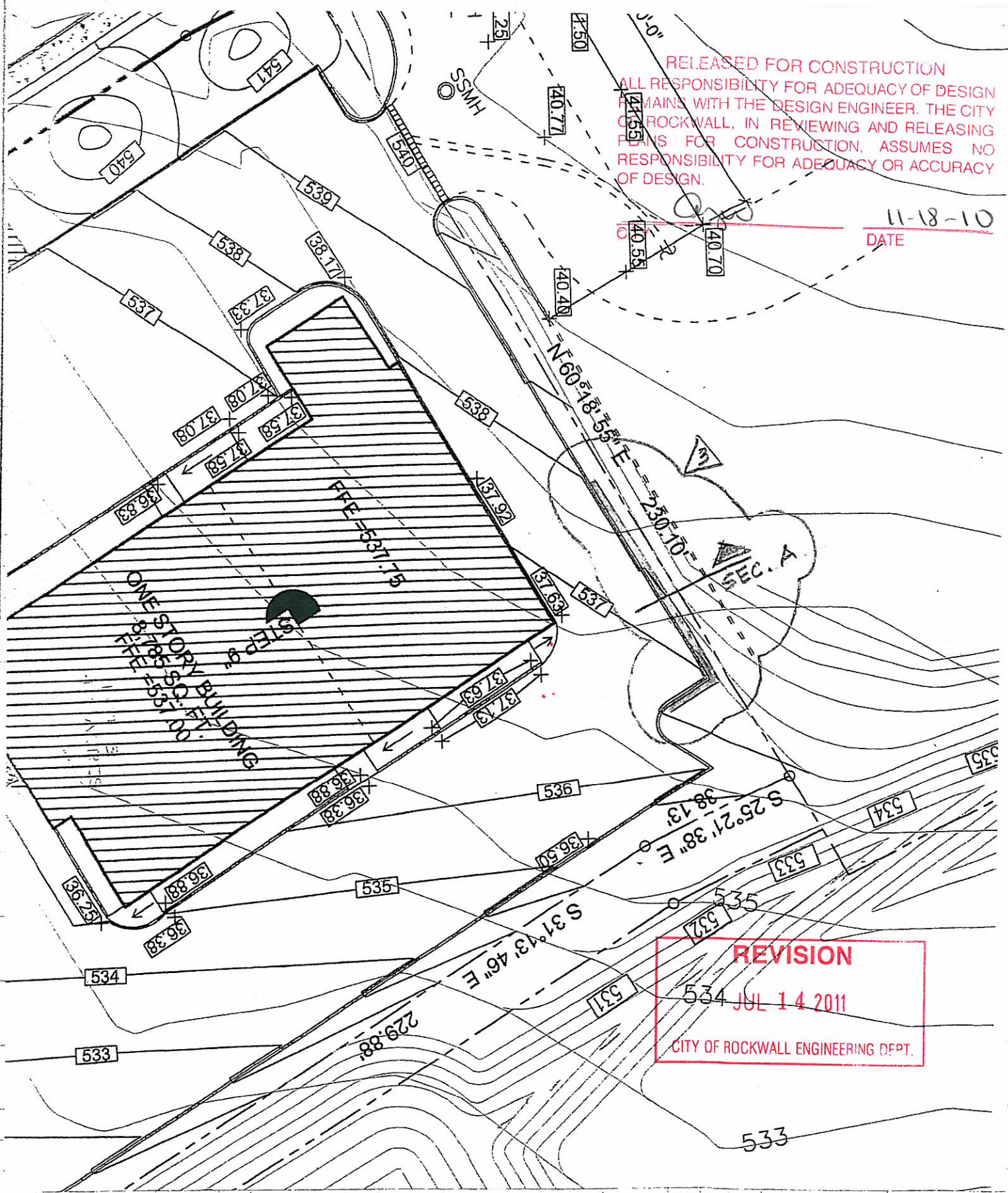

REVISION
 534 JUL 14 2011
 CITY OF ROCKWALL ENGINEERING DEPT.

SP Design & Build Inc.
 Consultant Engineers
 11500 N. Stemmons Freeway, Suite 144 Dallas, TX 75229
 Email: spham@spdb.net
 Tel. 972-241-4016
 Fax. 972-241-4018

PROJECT NAME: 205 PLAZA, ROCKWALL
 DATE: 7/14/11
 DETAIL: G2-GRADING PLAN
 APPROVED:

RELEASED FOR CONSTRUCTION
ALL RESPONSIBILITY FOR ADEQUACY OF DESIGN
REMAINS WITH THE DESIGN ENGINEER. THE CITY
OF ROCKWALL, IN REVIEWING AND RELEASING
PLANS FOR CONSTRUCTION, ASSUMES NO
RESPONSIBILITY FOR ADEQUACY OR ACCURACY
OF DESIGN.

CITY Opw DATE 11-18-10

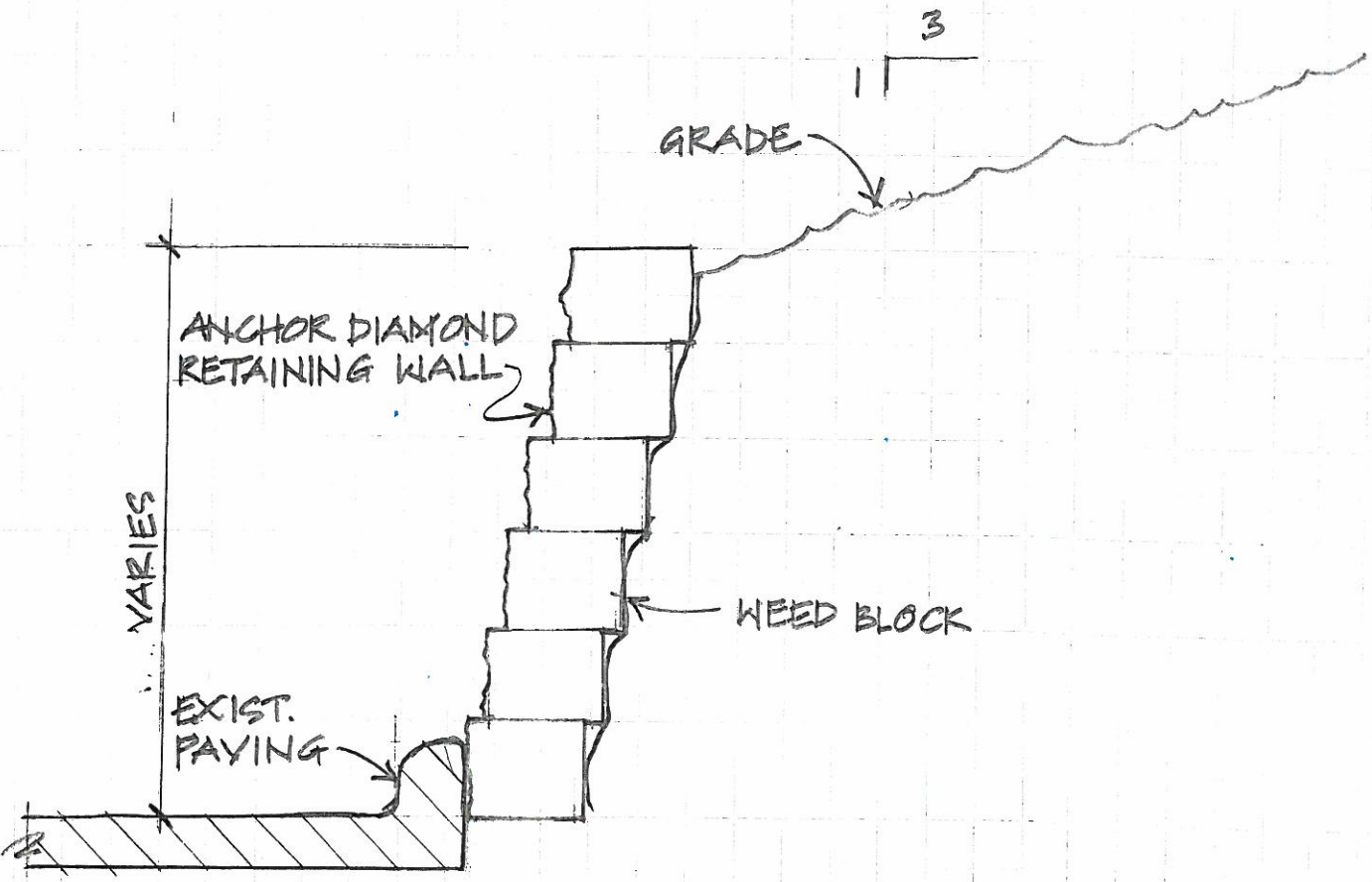

REVISION
JUL 14 2011
CITY OF ROCKWALL ENGINEERING DEPT

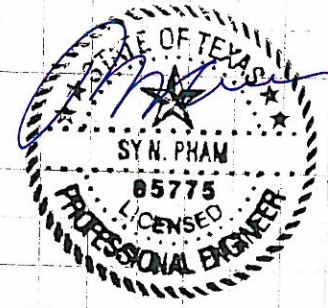

SP Design & Build Inc.
Consultant Engineers
11500 N. Stemmons Freeway, Suite 144 Dallas, TX 75229
Email: spham@spob.net
Tel. 972-241-4016
Fax. 972-241-4018

PROJECT NAME: 205 PLAZA, ROCKWALL

DETAIL: SECTION A

DATE: 7/7/11
APPROVED: