

PROFILE OF SD-1

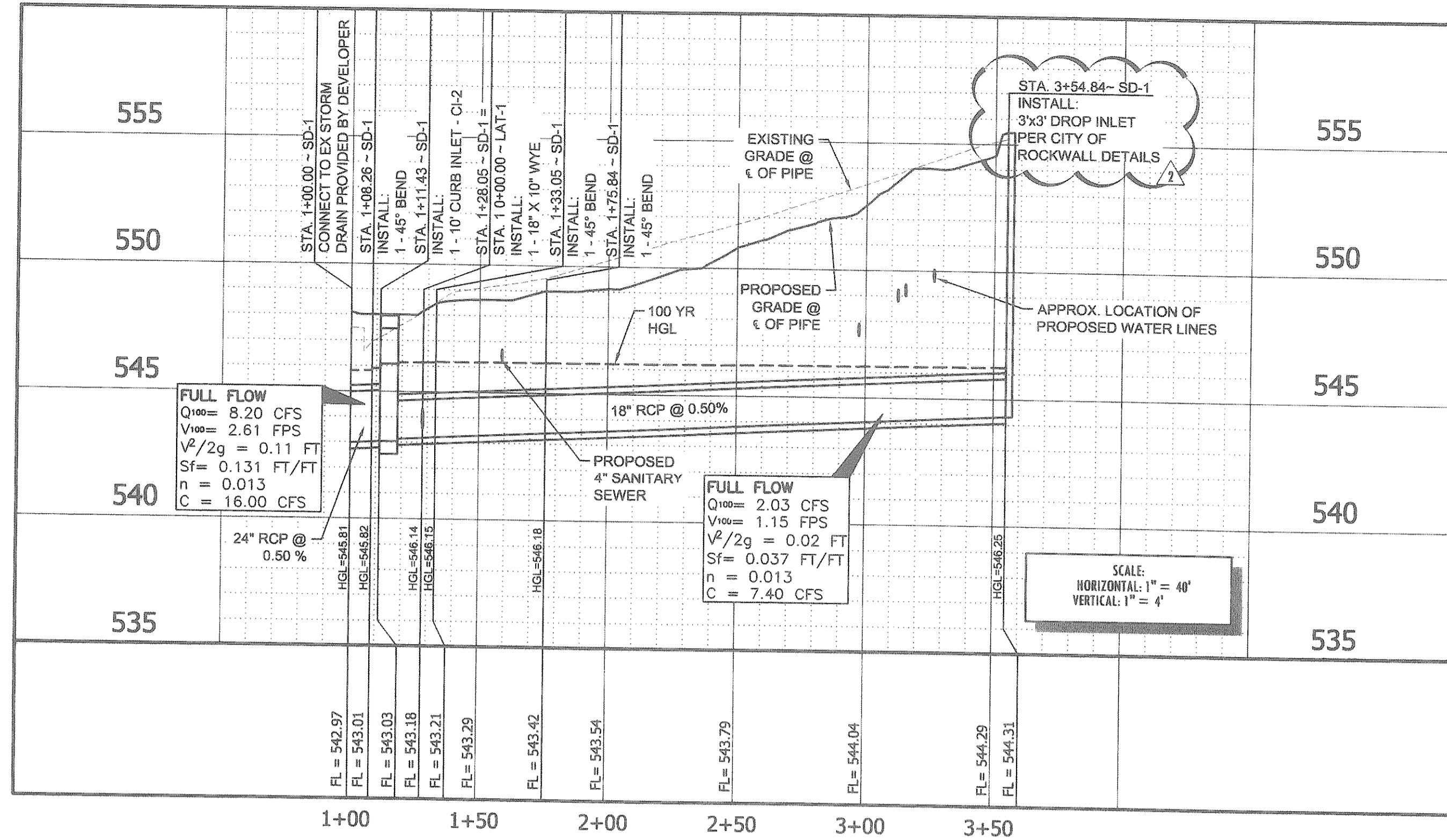

RECORD DRAWINGS August 2011

These plans have been revised to reflect those changes, if any, that deviated from the City approved construction plans. All revisions are based on construction records furnished to ADAMS by the contractor of record. We are not aware of any other changes as ADAMS was not on-site through the construction duration.

ENGINEER: *[Signature]*

#: 91918 DATE: 8-29-11

REV'S PER CITY 03/14/2011

1. ADDED DROP INLET SIZE.

OWNER INFORMATION

**McDONALD'S**  
511 E. CARPENTER FRWY, STE. 375  
IRVING, TEXAS 75082  
(972) 869-5382  
CONTACT: KEVIN MCKIBBEN

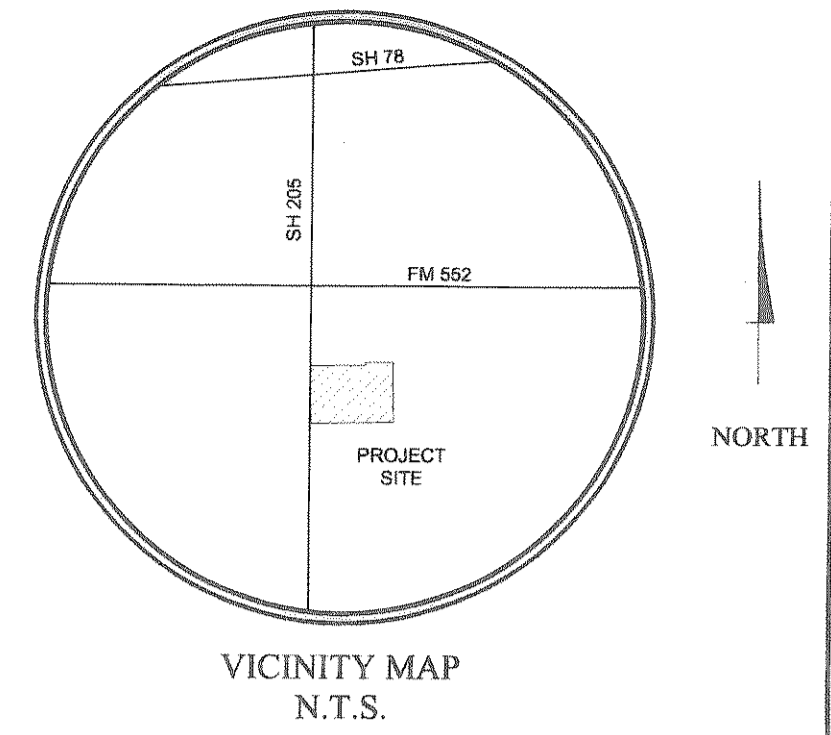

- GENERAL NOTES
- Bases, anchor bolts, conduit, and wiring for all signs are by the General Contractor.
  - 3/4" empty conduit to locations shown at the lot perimeter for lot lighting is by the General Contractor. Lighting fixtures, bases, poles, conduit, and wiring are by the General Contractor.
  - Lot lighting concrete footings to conform with the soils report recommendations for this site.
  - Bases for flagpoles are by the General Contractor. Anchor bolts are by the flagpole supplier. General contractor shall coordinate with flag pole supplier prior to construction.
  - The Contractor shall coordinate with all utility companies to determine exact point of service connection at existing utility. Refer to the building electrical and plumbing drawings for utility service entrance locations, sizes, and circuiting.
  - General Contractor must provide "as built" information upon completion.
  - All elevations shown are in reference to the benchmark and must be verified by the General Contractor at groundbreak.
  - Curb elevations shall be 6" above finish pavement unless noted otherwise.
  - All landscape areas shall be rough graded to 6" below top of all walks and curbs. Finished grading, landscaping and sprinkler systems are by the Owner/Operator.
  - It is strongly recommended that no contractual agreements of any kind be signed prior to receiving and thoroughly reviewing all approvals from all of the regulatory authorities having jurisdiction over this project.
  - Due to the nature of the work, all dimensions shown shall be considered approximate. Contractor shall field verify all dimensions prior to beginning construction. Shop drawings shall be submitted to the Architect and Engineer for approval prior to fabrication or installation of any item. Failure to adhere to this procedure shall place full responsibility for any errors directly upon the Contractor.
  - Contractor shall contact appropriate jurisdictional agencies prior to construction to confirm if independent testing or inspections will be required prior to their acceptance of work. Contractor shall make necessary arrangements to insure proper testing & inspections are documented such that work will be accepted at project completion.
  - Sidewalks around building shall have some subgrade preparation as building foundation.
  - All materials and construction within easements and R.O.W. shall conform to all governing authorities' jurisdictional standard construction details and specifications.
  - Topographic information taken from a Topographic Survey performed by AJ BEDFORD GROUP, INC. The Contractor shall notify the Engineer immediately, in writing, of any discrepancies or omissions to the topographic information. The Contractor(s) shall be responsible for confirming the location (horizontal/vertical) of any buried cables, conduits, pipes, and structures (storm sewer, sanitary sewer, water, gas, television, telephone, etc.) which impact the construction site. The Contractor(s) shall notify the Owner and Engineer if any discrepancies are found between the actual conditions versus the data contained in the construction plans. Any costs incurred as the result of not confirming the actual location (horizontal/vertical) of said cables, conduits, pipes, and structures shall be borne by the Contractor. Additionally, the Contractor(s) shall notify the Owner and Engineer if any errors or discrepancies are found on the construction documents (plans), which negatively impact the project. The Engineer and Owner shall be indemnified of problems and/or cost which may result from Contractor's failure to notify Engineer and Owner.
  - McDonald's reserves the right to request a compaction and/or a core sample. If tests prove correct, per the soils report, tests will be at the expense of McDonald's, otherwise G.C. will be charged.
  - Contractor shall comply to the fullest extent with the latest standards of OSHA directives or any other agency having jurisdiction for excavation and trenching procedure. Contractor shall use support systems, sloping, benching, or other means of protection, including but is not limited to, access and egress from all excavation and trenching. Contractor is responsible to comply with performance criteria for OSHA.

Adams ENGINEERING  
1015 S. Keller Avenue • Suite 100 • Fort Worth, TX 76102

STATE OF TEXAS  
TED A. MURDAY  
91918  
LICENSED PROFESSIONAL ENGINEER  
8-29-11

McDONALD'S  
THESE PLANS AND SPECIFICATIONS ARE THE PROPERTY OF McDONALD'S CORPORATION AND SHALL NOT BE REPRODUCED WITHOUT THEIR WRITTEN PERMISSION.  
TYPE Registration #: F-1002  
McDONALD'S, L.C. 042-2854  
ADAMS ENGINEERING No. 2008-101

OFFICE: GREATER SOUTHWEST  
ADDRESS: KROC DRIVE - OAK BROOK, ILLINOIS 60521

PLAN APPROVALS  
SIGNATURE (2 REQUIRED) DATE

CO-SIGN SIGNATURES  
REGIONAL MGR. CONST. MGR. OPERATIONS DEPT. REAL ESTATE DEPT. CONTRACTOR OWNER

STATUS DATE BY

PLAN CHECKED

AS-BUILT

L/C NUMBER: 042-2854  
CORPORATE DWG. NAME: STORM SEWER PROFILE

C8.2

PROFILE OF SD-2

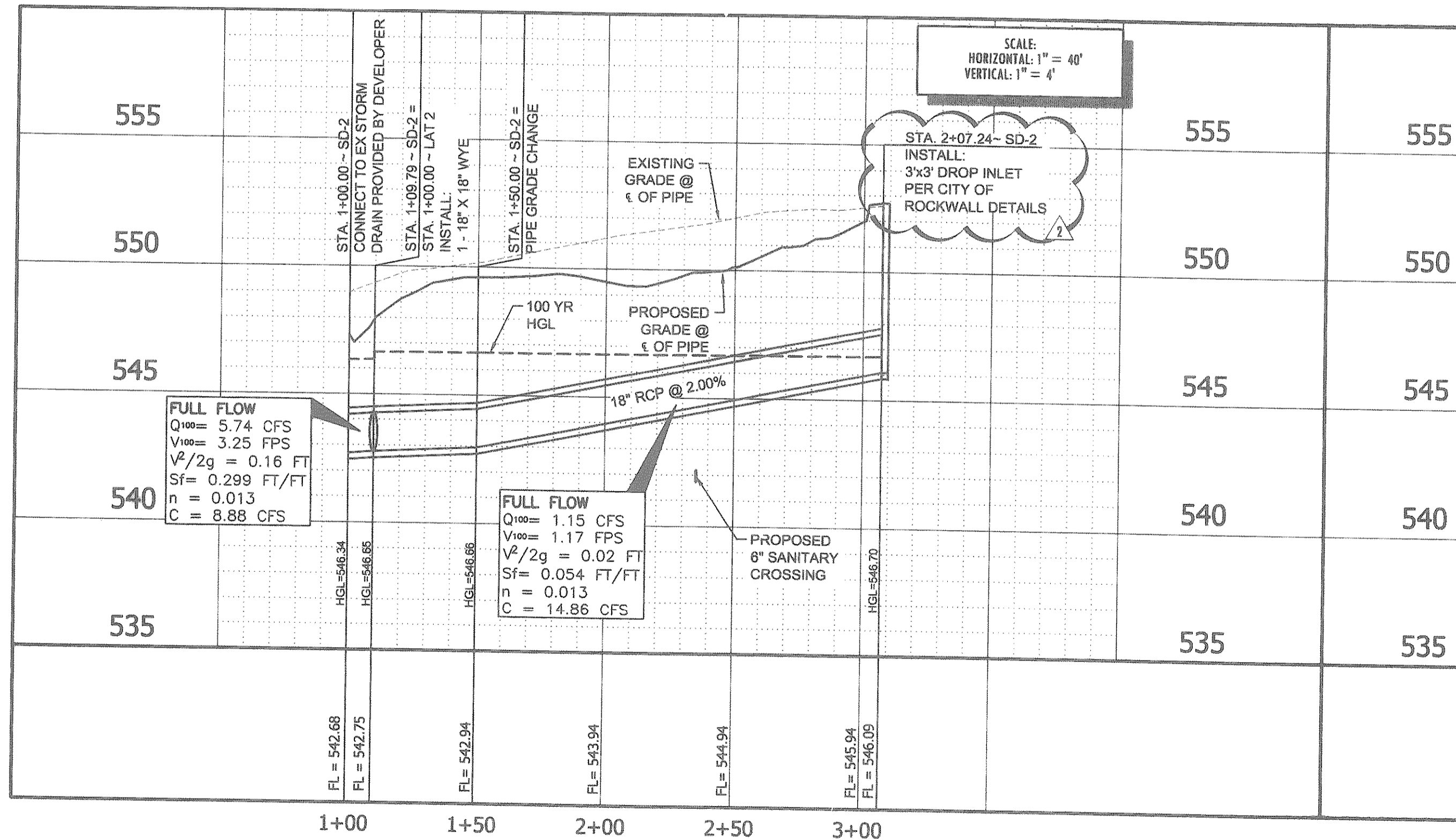

PROFILE OF LAT 2

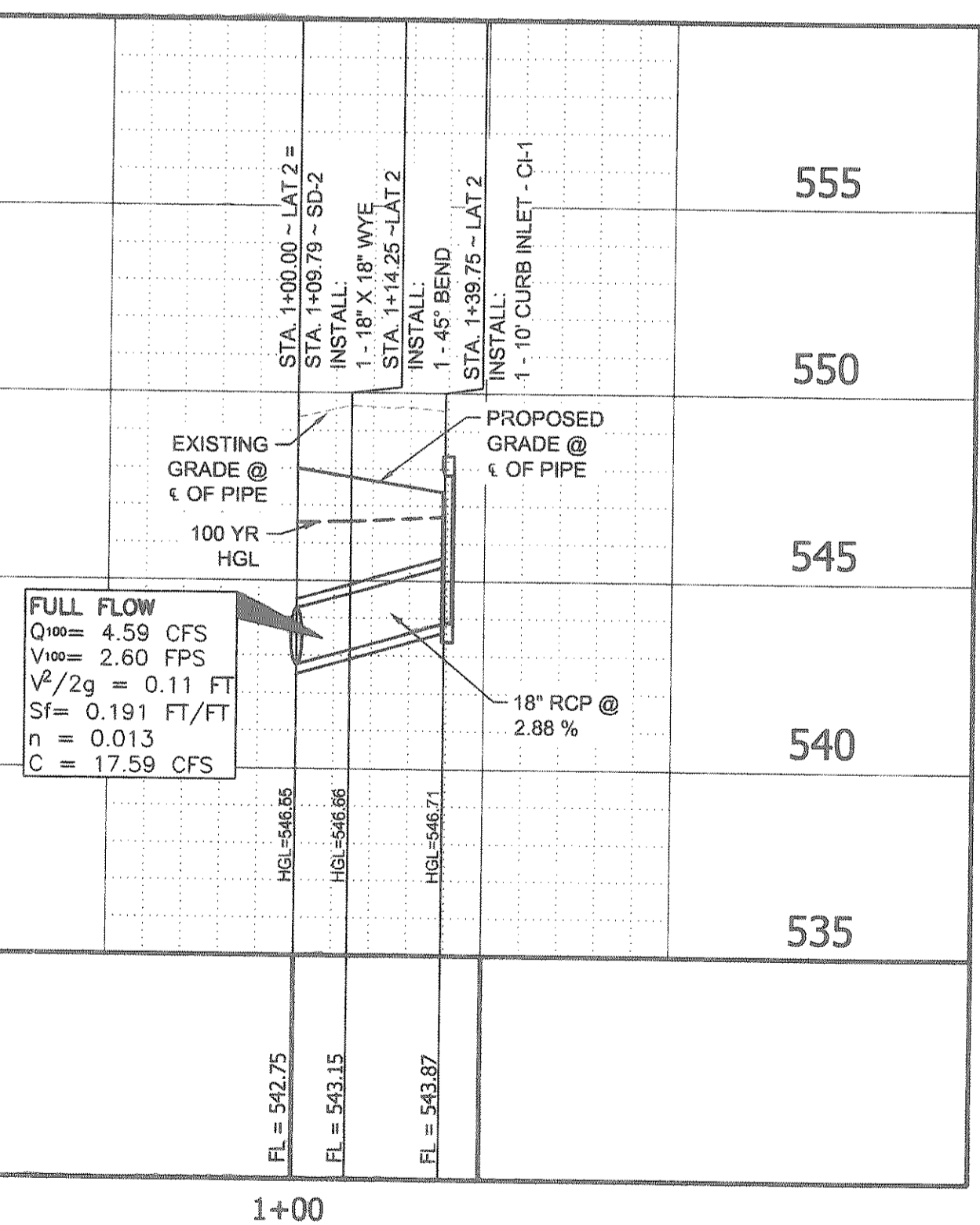

STORM SEWER SUMMARY

Line ID	Line Length (ft)	Line Size (in)	Line Slope (%)	Q <sub>design</sub> (cfs)	Q <sub>cap</sub> (cfs)	Average Velocity (ft/s)	Upstream Elevations			Downstream Elevations			S	Minor Losses (ft)	Loss Coeff.
							Invert (ft)	Ground/Rim (ft)	HGL (ft)	Invert (ft)	Ground/Rim (ft)	HGL (ft)			
SD-1 PIPE 1	8.00	24	0.50	8.20	16.00	2.61	543.01	548.00	545.82	542.97	546.50	545.81	0.131	0.08	0.75
SD-1 PIPE 2	3.17	24	0.63	8.20	17.97	2.61	543.03	547.45	545.90	543.01	548.00	545.9	0.131	0.11	1.00
SD-1 PIPE 3	10.18	18	0.49	2.91	7.36	1.65	543.18	548.20	546.08	543.13	547.45	546.07	0.077	0.03	0.75
SD-1 PIPE 4	5.00	18	0.60	2.03	8.14	1.15	543.21	548.30	546.14	543.18	548.20	546.13	0.037	0.02	0.75
SD-1 PIPE 5	42.79	18	0.49	2.03	7.36	1.15	543.42	548.80	546.17	543.21	548.30	546.15	0.037	0.02	0.75
SD-1 PIPE 6	179.00	18	0.50	2.03	7.40	1.15	544.31	555.00	546.25	543.42	548.80	546.18	0.037	0.02	1.00
LAT-1 PIPE 1	44.44	18	0.99	0.88	2.18	1.61	543.95	550.20	546.19	543.51	548.20	546.12	0.162	0.04	1.00
SD-2 PIPE 1	9.79	18	0.47	1.15	6.88	3.25	542.75	548.00	546.37	542.68	547.00	546.34	0.299	0.12	0.75
SD-2 PIPE 2	40.21	18	0.47	1.15	7.22	0.65	542.94	549.44	546.65	542.75	548.00	546.65	0.012	0.00	0.15
SD-2 PIPE 3	157.24	18	2.00	1.15	14.88	1.17	548.09	552.60	548.70	542.94	549.44	546.66	0.054	0.04	1.00
LAT-2 PIPE 1	14.25	18	2.88	4.59	17.82	2.60	543.15	548.50	546.58	542.75	548.00	546.55	0.191	0.08	0.75
LAT-2 PIPE 2	25.00	18	2.88	4.59	17.82	2.60	543.87	547.37	546.71	543.15	548.50	546.66	0.191	0.10	1.00



THESE PLANS ARE SUBJECT TO REVIEW & APPROVAL BY JURISDICTIONAL ENTITIES.