

CIVIL CONSTRUCTION PLANS FOR McDONALD'S - L/C: 042-2854 McDONALD'S RESTAURANT SH 205 & SH 552 ROCKWALL, ROCKWALL COUNTY, TEXAS

McDONALD'S RESTAURANT
LOT 6, BLOCK A
STONE CREEK RETAIL ADDTION



OWNER: McDonald's
511 E. CARPENTER FRWY., SUITE 375
IRVING, TX 75062
ATTN: KEVIN McKIBBEN
PHONE: (972) 869-5392

CIVIL ENGINEER: ADAMS ENGINEERING
910 S. KIMBALL AVE.
SOUTHLAKE, TEXAS 76092
PHONE: (817) 328-3200
CONTACT: CAMERON SLOWN, P.E.

PROJECT LOCATION: SH 205 & SH 552
ROCKWALL, TEXAS

ADAMS ENGINEERING JOB NUMBER: 2008.101

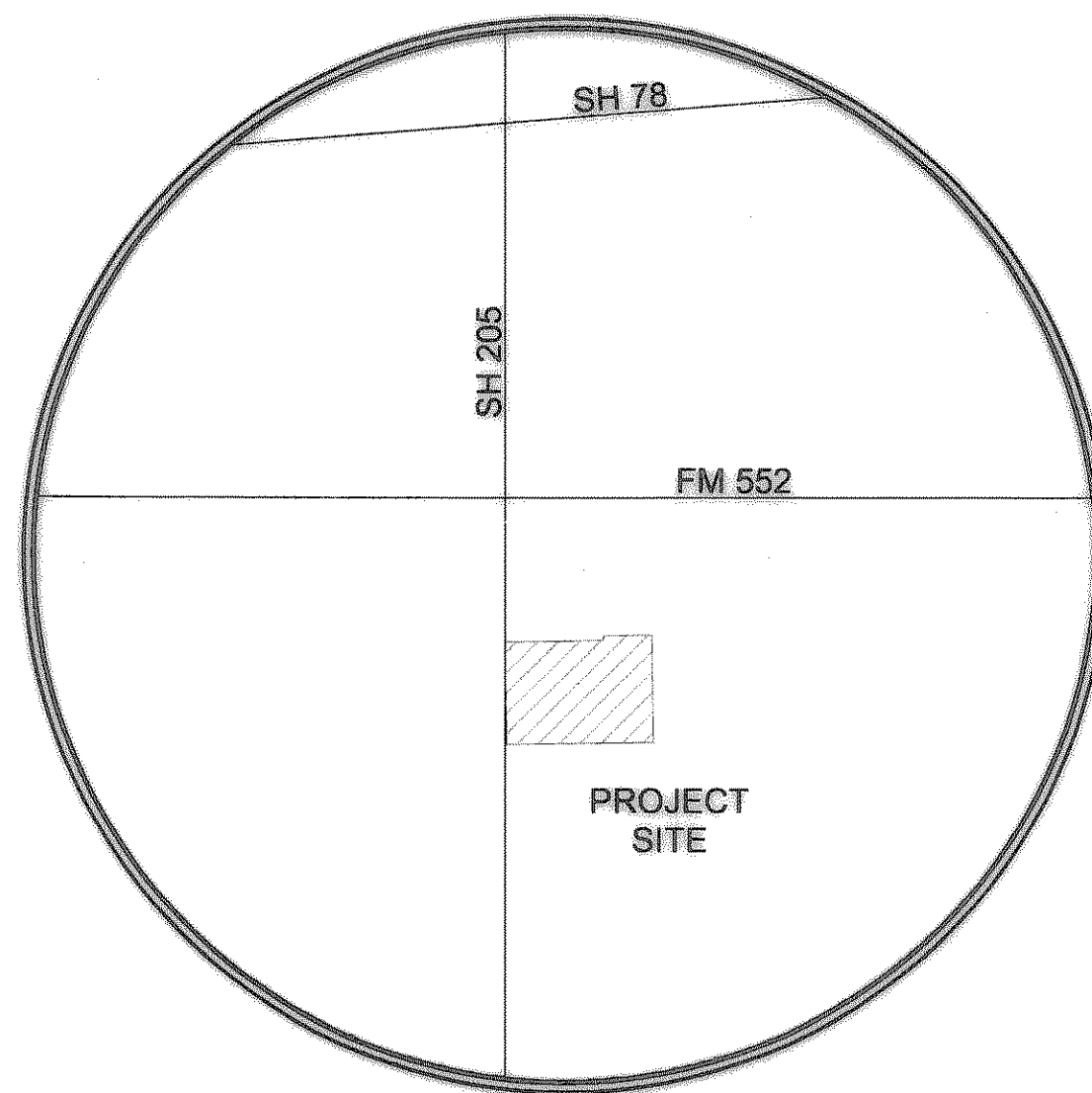

VICINITY MAP
N.T.S.

RECORD DRAWINGS August 2011
These plans have been revised to reflect those changes, if any, that deviated from the City approved construction plans. All revisions are based on construction records furnished to ADAMS by the contractor of record. We are not aware of any other changes as ADAMS was not on-site through the construction duration.

ENGINEER: *[Signature]*
#: 91918 DATE: 8-29-11

Sheet List Table	
Sheet Number	Sheet Title
C1.0	COVER SHEET
--	TOPO SURVEY (1 OF 2)
--	TOPO SURVEY (2 OF 2)
C2.0	DEMO PLAN
C3.0	EROSION CONTROL PLAN
C3.1	EROSION CONTROL DETAILS
C4.0	SITE PLAN
C5.0	DRIVE THRU & STRIPING PLAN
C6.0	PAVING PLAN
C7.0	GRADING PLAN
--	EXISTING DRAINAGE AREA MAP
C8.1	POST DEVELOPED DRAINAGE PLAN
C8.2	STORM SEWER PROFILE
C9.0	SEWER & WATER PLAN
C9.1	UTILITY PLAN
L1.0	LANDSCAPE PLAN

**** FEMA NOTE ****
Flood Statement: According to Community Panel No. 48397C0030L, Dated 09/26/2008, of the Federal Emergency Management Agency, National Flood Insurance Program Map, this property is within flood zone "X", which is not a special flood hazard area. If this site is not within an identified special flood hazard area, this flood statement does not imply that the property and/or the structures thereon will be free from flooding or flood damage. On rare occasions, greater floods can and will occur and flood heights may be increased by man-made or natural causes. This statement shall not create liability on the part of Adams Engineering.

**** NOTICE TO CONTRACTOR - BIDDING ****
All questions regarding the General Contractor's preparation of his bid shall be directed to the McDonald's Construction Department. Sub-contractors must direct their questions through the General Contractor only. The Consulting Architect and/or Engineer shall not be contacted by the General Contractors, Sub-contractors, or Suppliers without direct prior authorization from McDonald's.

**** NOTICE TO CONTRACTORS - TOPOGRAPHIC SURVEY ****
Topographic information taken from a Topographic Survey performed by AJ BEDFORD GROUP, INC. The Contractor shall notify the Engineer immediately, in writing, of any discrepancies or omissions to the topographic information. The Contractor(s) shall be responsible for confirming the location (horizontal/vertical) of any buried cables, conduits, pipes, and structures (storm sewer, sanitary sewer, water, gas, television, telephone, etc.) which impact the construction site. The Contractor(s) shall notify the Owner and Engineer if any discrepancies are found between the actual conditions versus the data contained in the construction plans. Any costs incurred as the result of not confirming the actual location (horizontal/vertical) of said cables, conduits, pipes, and structures shall be borne by the Contractor. Additionally, the Contractor(s) shall notify the Owner and Engineer if any errors or discrepancies are found on the construction documents (ps&s), which negatively impact the project. The Engineer and Owner shall be indemnified of problems and/or cost which may result from Contractor's failure to notify Engineer and Owner.

REV'S PER CITY 03/03/2011
1. REMOVED PHOTOMETRIC LIGHTING PLAN, TRASH ENCLOSURE DETAIL AND IRRIGATION FROM SHEET LIST TABLE.
THESE PLANS ARE SUBJECT TO REVIEW & APPROVAL BY JURISDICTIONAL ENTITIES.



Know what's below.
Call before you dig.

NOTE:
CONTRACTOR TO NOTIFY NORTH TEXAS MUNICIPAL WATER DISTRICT ENGINEERING DEPARTMENT (BOB QUINN 972-442-5405) 48 HOURS PRIOR TO CONSTRUCTION.

BENCHMARK
1. STANDARD CITY OF ROCKWALL MONUMENT STATION NO. 10 IS 2" BRASS DISC SET IN THE CENTER MEDIAN OF NORTH LAKESHORE DRIVE NEAR THE INTERSECTION OF NORTH LAKESHORE DRIVE AND NORTH ALAMO. POSTED ELEVATION = 524.79

PLAN APPROVALS		OFFICE		GREATER SOUTHWEST	
SIGNATURE (2 REQUIRED)	DATE	ADDRESS	OFFICE	ADDRESS	ADDRESS
REGIONAL MGR.		McDONALD'S L/C: 042-2854	McDONALD'S L/C: 042-2854	McDONALD'S L/C: 042-2854	McDONALD'S L/C: 042-2854
CONTR. MGR.		ADAMS ENGINEERING No. 2008.101	ADAMS ENGINEERING No. 2008.101	ADAMS ENGINEERING No. 2008.101	ADAMS ENGINEERING No. 2008.101
OPERATIONS DEPT.					
REAL ESTATE DEPT.					
CONTRACTOR					
OWNER					
STATUS	DATE	BY			
PLAN CHECKED	FEB 2011	CC			
AS-BUILT					
C1.0					

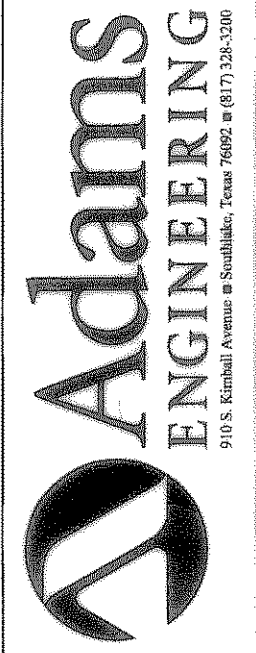

REV	DATE	DESCRIPTION	BY	ISSUE RE
1	03/03/2011	REVISIONS PER CITY COMMENTS	RL	
	08/25/2011	RECORD DRAWINGS	BS	

FULL PRINT: \\pfs01\adams\2008\101\Rockwall\101\042-2854\042-2854.dwg
 PLOTTER: HP 9000
 PLOT TIME: 1:15:04 AM
 PLOT DATE: Thursday, August 25, 2011
 PLOTTED BY: Bryan G. Hale