

**CAUTION !!!**  
EXISTING UTILITIES

EXISTING UTILITIES AND UNDERGROUND FACILITIES INDICATED ON THESE PLANS HAVE BEEN LOCATED FROM REFERENCE INFORMATION. IT SHALL BE THE RESPONSIBILITY OF THE CONTRACTOR TO VERIFY BOTH HORIZONTALLY AND VERTICALLY THE LOCATION OF ALL EXISTING UTILITIES AND UNDERGROUND FACILITIES PRIOR TO CONSTRUCTION. TO TAKE NECESSARY PRECAUTIONS IN ORDER TO PROTECT ALL FACILITIES ENCOUNTERED. THE CONTRACTOR SHALL PRESERVE AND PROTECT ALL EXISTING UTILITIES FROM DAMAGE DURING CONSTRUCTION.

Note!!  
Construct Barrier Free Ramps With Street Paving At All Intersections As Per City Standards.

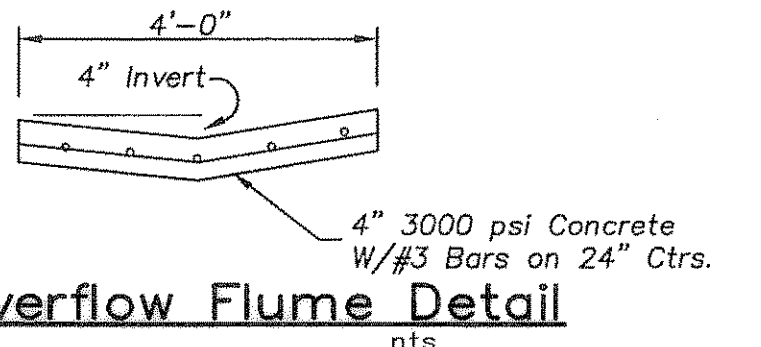

Bench Mark 1  
A Standard U.S.C.&G.S. Disk Stamped 'M 929 1946'  
Approx. 1.9 miles southeast along State Hwy. 205 from Courthouse at Rockwall to bridge at Buffalo Creek, at the northwest corner of the concrete bridge in the top of the concrete guardrail base approx. 17 feet southwest of the centerline of the highway, and approx. 3 feet southeast of the northwest end of the guardrail base.  
Elevation = 524.65

Bench Mark 2  
Top of Concrete ROW Marker, approx. 1.6 miles southeast along State Hwy. 205 and then approx. 0.6 miles east along FM 276 to intersection of paved road, at fence corner at southwest quadrant of intersection.  
Elevation = 543.10

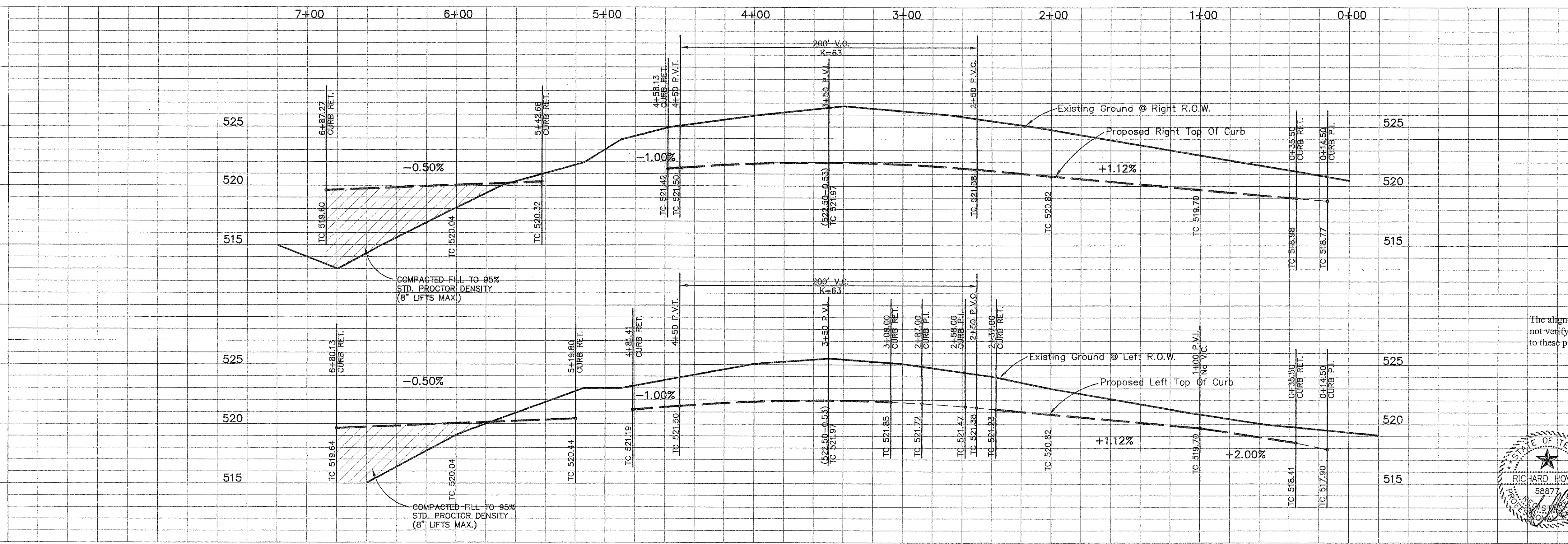

**AS BUILT PLANS**  
01/12/2005

The alignment and grade were set on the ground for construction per the plans. The engineer did not verify alignment or grades after construction. We are not aware of any changes or revisions to these plans during construction except as noted.

**WESTON COURT, ALLEY '3'**

PAVING PLAN	
Lynden Park Estates Phase 4	
City Of Rockwall, Texas	
RICHARD HOVAS 58877	
6330 Broadway Blvd. ~ Suite C ~ Garland, Texas 75043	
DESIGN	DRAWN
T.E. Inc.	T.E. Inc.
DATE	SCALE
8-2002	1"=40' Hor 1"=5' Vert
NOTES	FILE
	4580
	6

