

DEVELOPMENT PLANS

FOR

LYNDEN PARK ESTATES PHASE 2

CITY OF ROCKWALL, TEXAS

- GENERAL NOTES**
1. All street and alleys intersections and connections shall be built by the developer.
 2. Excavation from streets to be deposited in low areas to allow proper drainage.
 3. All existing ditches, except as noted on drainage plans, are to be filled to conform to surrounding terrain.
 4. It will be the responsibility of the developer and/ or the contractor to protect and maintain to proper line and grade all public utilities, manholes, cleanouts, valve boxes, fire hydrants, etc. during the construction of this project, prior to and after placing permanent pavement.
 5. All materials and workmanship shall conform to the City Standards and Specifications.

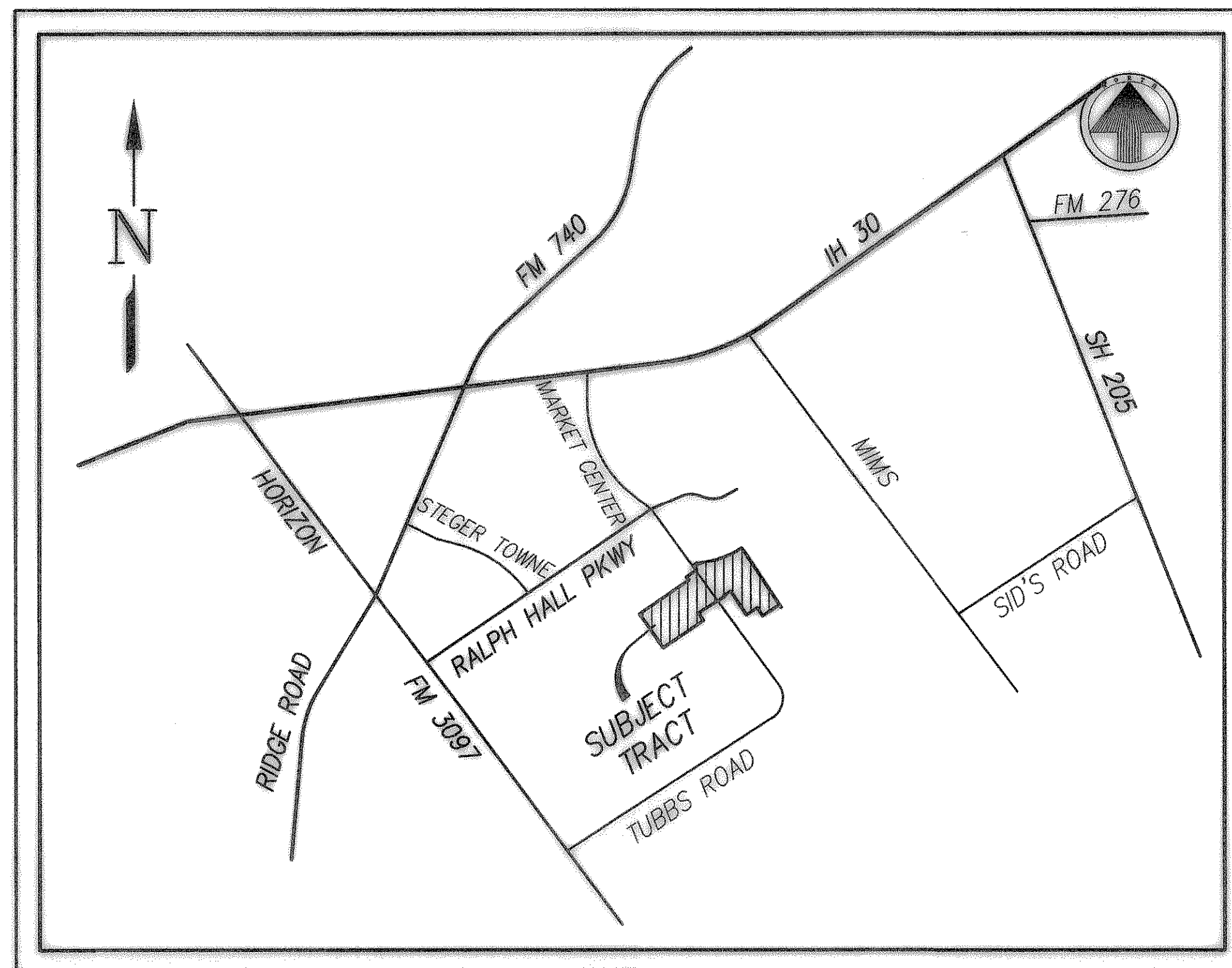

LOCATION MAP
NOT TO SCALE

INDEX

Sheet No.	Description
1-2	Final Plat
3-10	Paving Plans
11	Alley Profiles
12	Drainage Area Map
13-15	Storm Sewer Plans
16	Water & Sewer Plan
17	Sanitary Sewer Profiles
18-19	Lot Grading Plans
20	Storm Water Pollution Prevention Plan

PREPARED FOR

KIMBALL HILL HOMES

1422 West Main Street ~ Suite 201 ~ Lewisville, Texas 75067



TIPTON ENGINEERING, INC.

6330 Broadway Blvd. ~ Suite C ~ Garland, Texas 75043 (972) 226-2967

AS BUILT PLANS

04/27/2001

The alignment and grade were set on the ground for construction per the plans. The engineer did not verify alignment or grades after construction. We are not aware of any changes or revisions to these plans during construction except as noted.

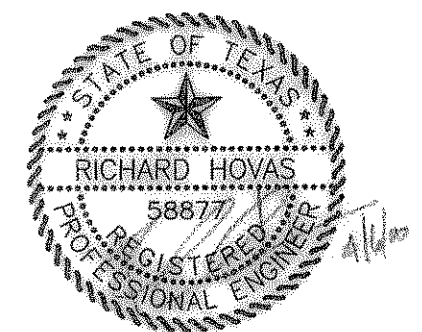

LYNDEN PARK ESTATES PHASE 2