

CONSTRUCTOR SHALL PROVIDE LAY DOWN CURB AT ALL STREET INTERSECTIONS.

BENCHMARKS:
 "□" cut on top of curb, center of inlet on the Northwest side of Rockwall Pkwy. approx. 140' Northeast of Woodcreek Dr.
 ELEVATION = 527.25

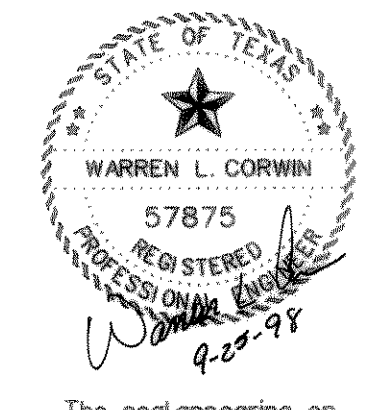
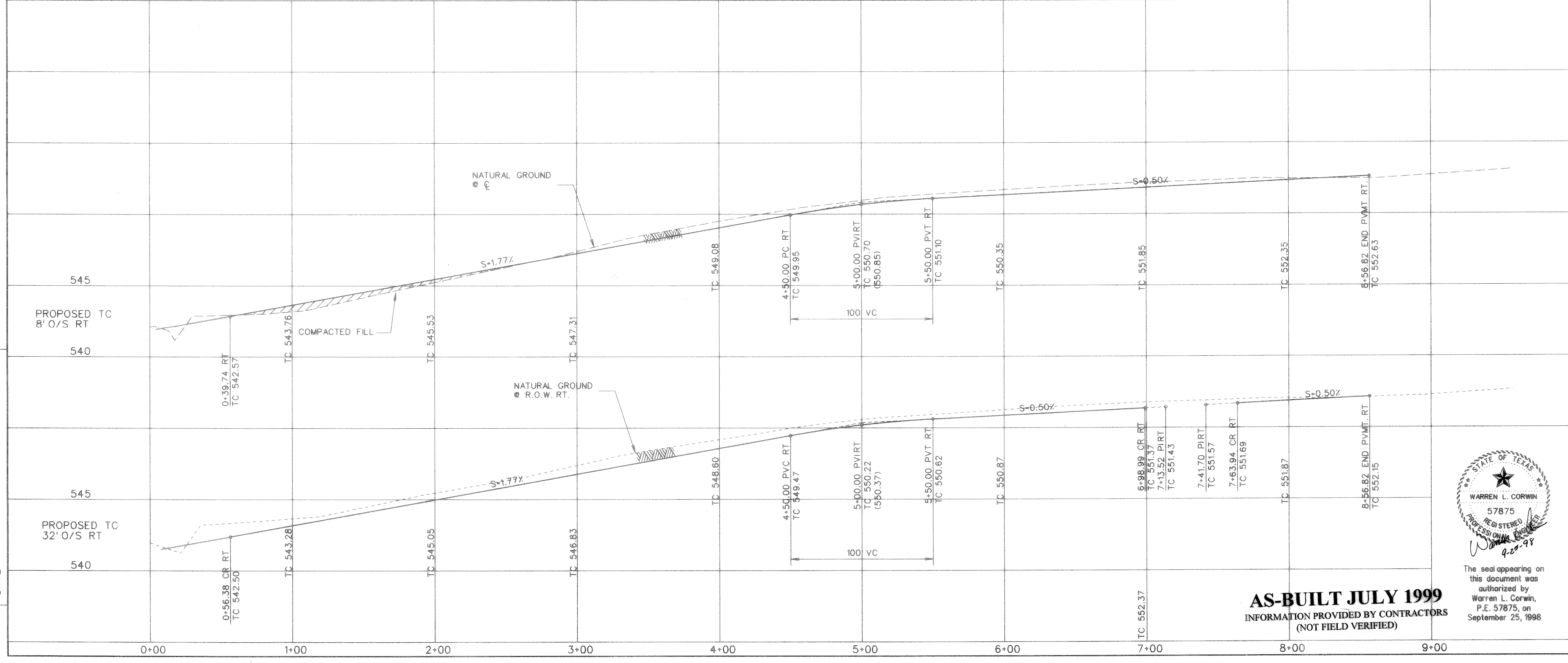
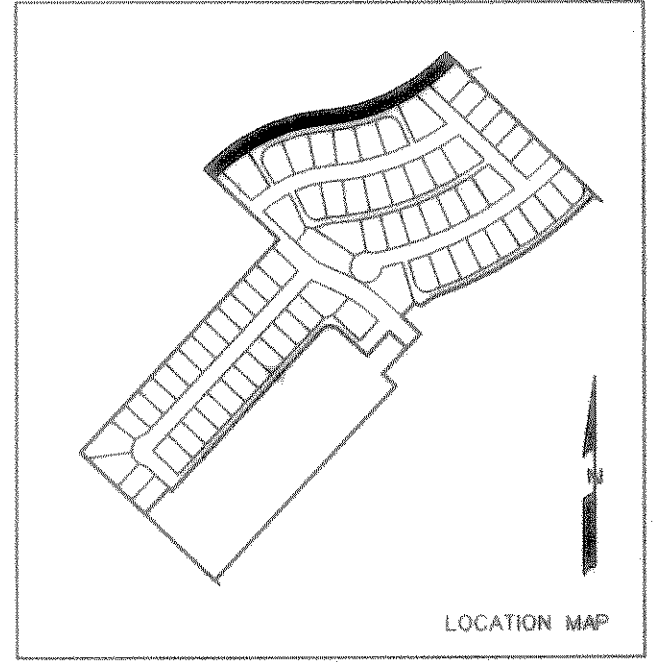

The seal appearing on this document was authorized by Warren L. Corwin, P.E. 57875, on September 25, 1998

AS-BUILT JULY 1999
 INFORMATION PROVIDED BY CONTRACTORS
 (NOT FIELD VERIFIED)

1	REVISED GRADES PER WEIR & ASSOC.	PJB	9-24-98
NO.	REVISIONS	BY	DATE

CORWIN ENGINEERING, INC.
 8131 LBJ FREEWAY, SUITE 333
 DALLAS, TEXAS 75251 (972) 480-0305

DEVELOPMENT PLANS FOR
LYNDEN PARK ESTATES PHASE IA
 ROCKWALL, TEXAS

RALPH HALL PARKWAY

DRAWN BY RDS	DESIGNED BY CEI	CHECKED BY CEI	SHEET NO. 5 OF 24
JOB NUMBER 9702	DATE JANUARY 1997	SCALE: 1"=4' V 1"=40' H	

PF:
 FILE: 9702FUT.DGN
 REF. FILE: 9702AL.DGN
 VIEW:
 DATE: