

CAUTION EXISTING UTILITIES !!!
CALL TEXAS 811!!! EXISTING UTILITIES AND UNDERGROUND FACILITIES INDICATED ON THESE PLANS HAVE BEEN LOCATED FROM REFERENCE INFORMATION. IT SHALL BE THE RESPONSIBILITY OF THE CONTRACTOR TO VERIFY BOTH HORIZONTALLY AND VERTICALLY THE LOCATION OF ALL EXISTING UTILITIES AND UNDERGROUND FACILITIES PRIOR TO CONSTRUCTION, TO TAKE THE NECESSARY PRECAUTIONS IN ORDER TO PROTECT ALL FACILITIES ENCOUNTERED. THE CONTRACTOR SHALL PRESERVE AND PROTECT ALL EXISTING UTILITIES FROM DAMAGE DURING CONSTRUCTION.

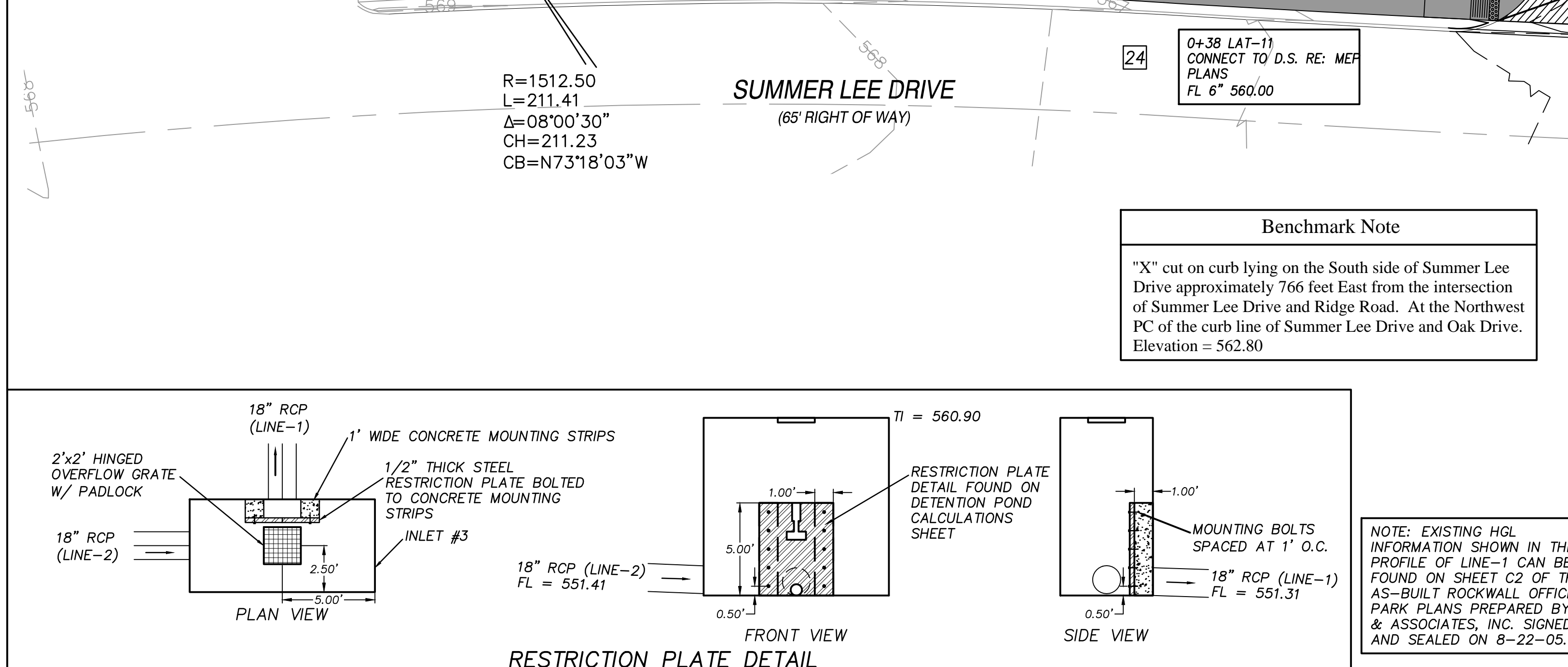

Benchmark Note
"X" cut on curb lying on the South side of Summer Lee Drive approximately 766 feet East from the intersection of Summer Lee Drive and Ridge Road. At the Northwest PC of the curb line of Summer Lee Drive and Oak Drive. Elevation = 562.80

NOTE: EXISTING HGL INFORMATION SHOWN IN THE PROFILE OF LINE-1 CAN BE FOUND ON SHEET C2 OF THE AS-BUILT ROCKWALL OFFICE PARK PLANS PREPARED BY LIM & ASSOCIATES, INC. SIGNED AND SEALED ON 8-22-05.

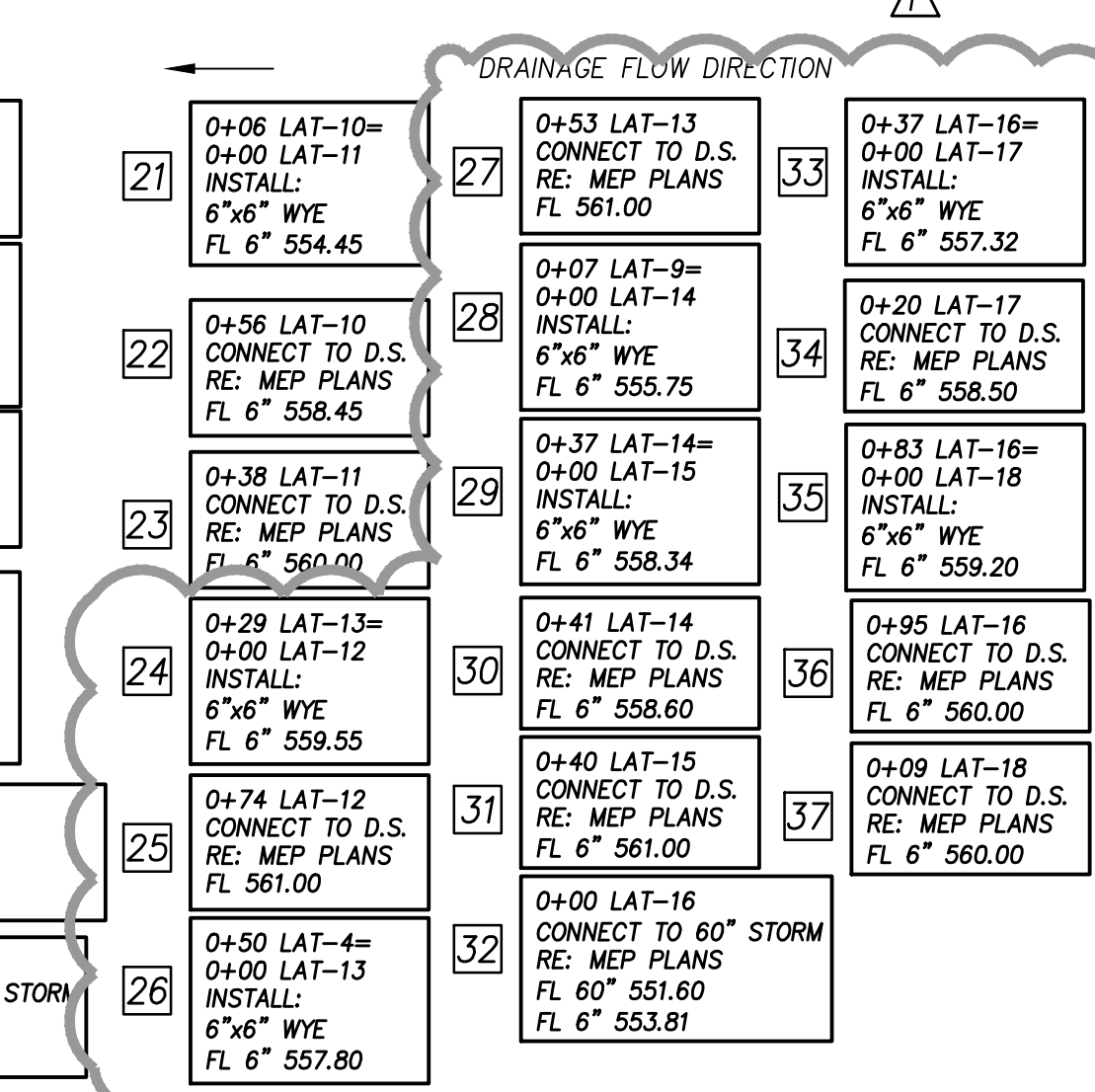
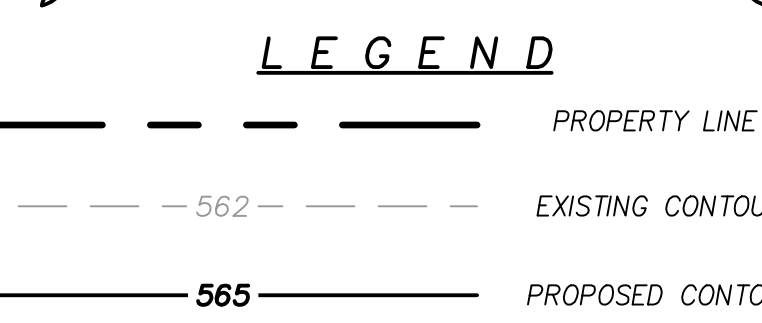
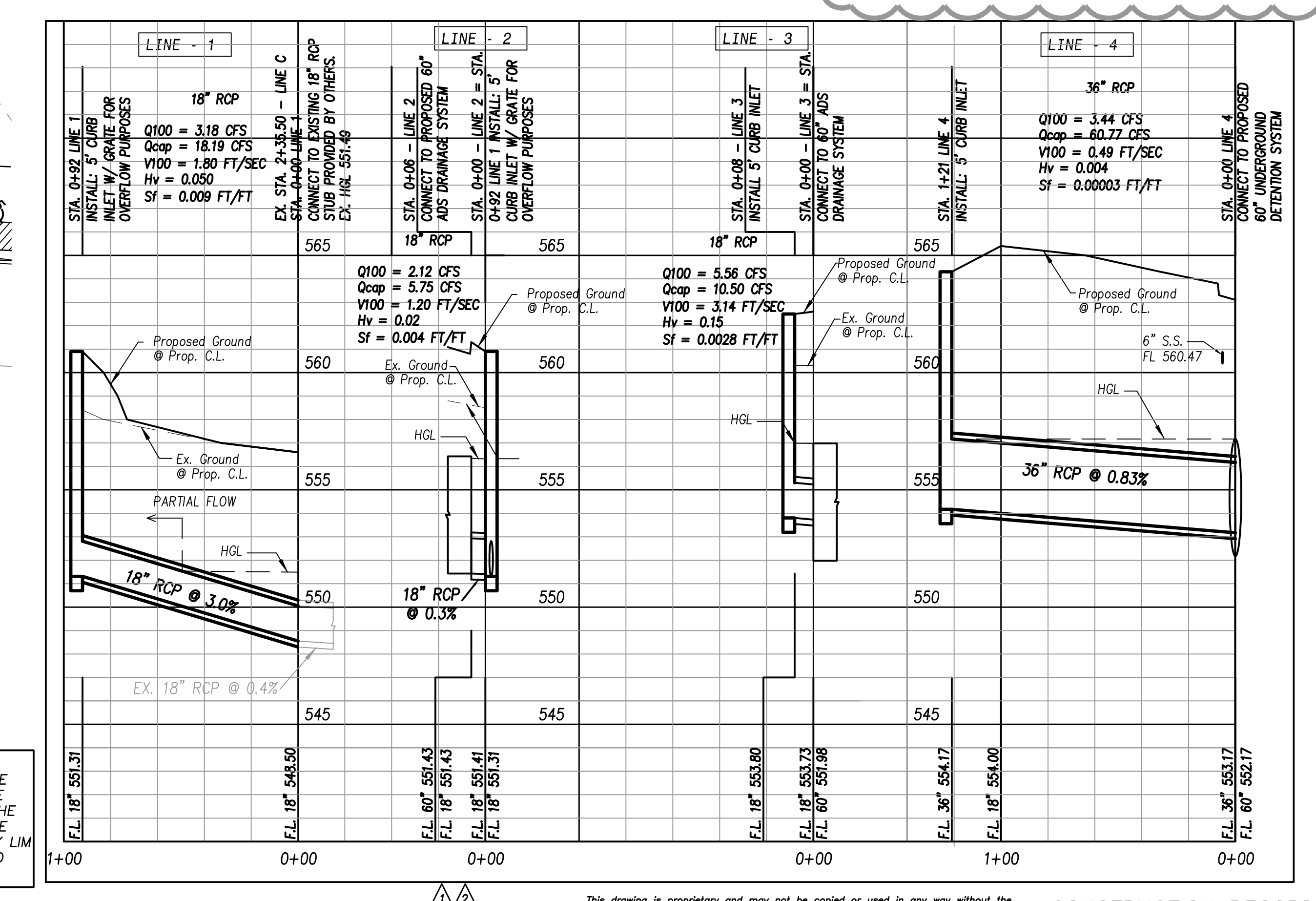

Revision	Date	Description
1	1/19/16	UPDATED TRASH ENCLOSURE AND DOWNSPOUTS

Owner: **LOWDENT, LLC.**
17393 Adams Trail • Forney, TX 75126 • (214) 869-7181

LOWRANCE / YOUNG
MEDICAL OFFICE BUILDINGS
Rockwall, Texas

~ Civil Engineer ~
F.C. CUNY CORPORATION
#2 Horizon Court • Heath, Texas 75032 • (469) 402-7700
Texas Registered Engineering Firm F-7449

7/28/2016

Drawn By: F.C. CUNY
Checked By: F.C. CUNY
Date: 04/15
Project No.:
Sheet Title: **Storm Sewer & Detention Plan**
Scale: 1" = 20'
Sheet No.: 8 of 9