

CIVIL CONSTRUCTION PLANS

REPLAT OF

Love's

ADDITION NO. 1

LOT 1, BLOCK A

J. LOCKHART SURVEY, ABSTRACT NO. 134

CITY OF ROCKWALL

ROCKWALL COUNTY, TEXAS

6.21 AC.

GENERAL NOTES
(APPLICABLE TO ALL SHEETS)

1. Excavated material shall be placed as directed by the Owner.
2. Construction shall meet the requirements of the latest revision of the Standards of Design and Standard Details for the City of Rockwall.
3. All fill areas to be density controlled and compacted to 95% density at optimum moisture content.
4. Pavement thickness shall be a minimum of 6" thickness with a strength of 3000 psi at 28 days and reinforced with No.3 bar at 24" centers each way. Firelane to be 6" thickness with 3500 psi concrete 6 sack min. and 6 1/2 sack for hand pours.
5. All streets shall be constructed with 6% lime stabilized subgrade compacted to 95% standard proctor density.
6. It shall be the responsibility of the Contractor to locate and verify all existing utilities prior to the beginning of construction to insure no conflicts between all utility lines.
7. Where water pipelines either cross or otherwise come within 9 feet of a sanitary sewer pipeline, the sewer pipeline shall be with a minimum working pressure Class 150 psi.
8. All water lines installed to be PVC pipe Class 200 conforming to AWWA Standard C-900, fitting shall be mechanical or O-ring.
9. All water lines are to be installed a minimum of 48" deep measured from top of pipe.
10. All storm inlets shall be cast-in-place.
11. Utility contractor shall use MEGALUGS when install the water line and double strap services when installing the services.
12. All water lines shall be pressure tested and disinfected in accordance with AWWA C 601.
13. All gate valves shall be Mueller or approved equal and conform to AWWA C-500 specifications. All gate valves shall be iron body, bronze mounted, double disk, parallel seat, non-rising stem, internal wedging type.
14. All fire hydrants shall be Mueller or approved equal.
15. Water services shall be a minimum of 2 1/2" sch. 40 polyethylene pipe.

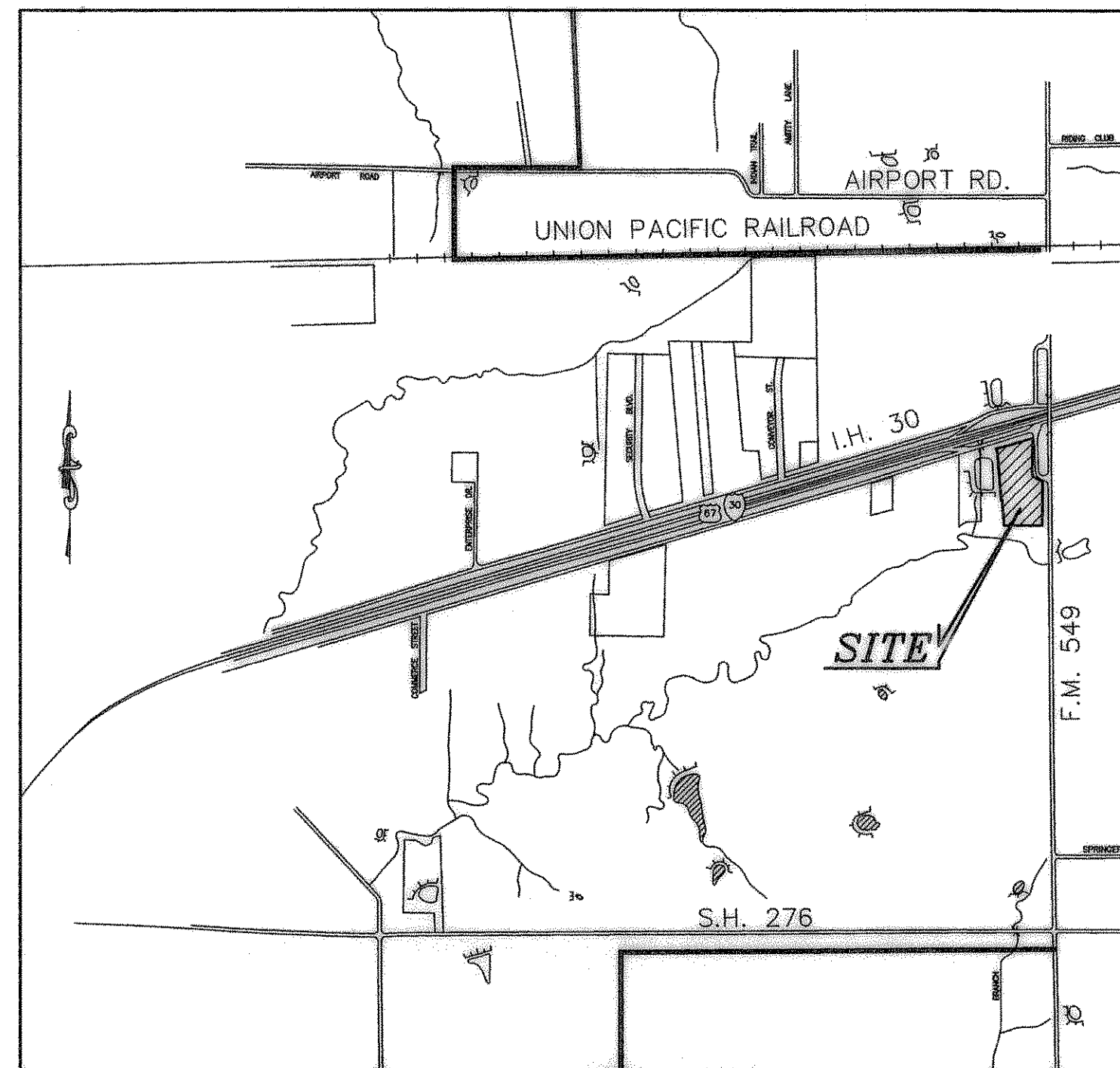

VICINITY MAP

SHEET INDEX

1. COVER SHEET
2. FINAL PLAT
3. SITE PLAN
- 3A. UTILITY PLAN
4. DRAINAGE AREA MAP
5. GRADING PLAN
6. PAVING PLAN
- 6A. EXPANSION & SAW JOINT PLAN
7. STORM PLAN & PROFILE
- 7A. CHANNEL PLAN & PROFILE
- 7B. EROSION CONTROL PLAN
- 7C. EROSION DETAILS
8. GRADING DETAILS
- 9 & 9A. PAVING DETAILS
- 9B. OIL/WATER SEPARATOR DETAILS

RECORD DRAWINGS:

THE INTENT OF THE OWNER AND ENGINEER WAS TO CONSTRUCT THESE FACILITIES ACCORDING TO THESE PLANS AS APPROVED BY THE CITY OF Rockwall. THE LINES AND GRADES WERE SET ON THE GROUND FOR CONSTRUCTION ACCORDING TO SAID PLANS. THE CITY OF Rockwall INSPECTED THE CONSTRUCTION. THE OWNER NOR ENGINEER DID NOT VERIFY LINES OR GRADES AFTER CONSTRUCTION. WE ARE NOT AWARE OF ANY CHANGES OR REVISIONS TO THESE PLANS DURING CONSTRUCTION EXCEPT AS NOTED

NOTE: CONTRACTOR TO VERIFY IN THE FIELD THE LOCATION OF ALL EXISTING UTILITIES PRIOR TO CONSTRUCTION. INFORMATION PROVIDED WITHIN THESE PLANS DOES NOT RELIEVE THE CONTRACTOR OF THE FULL AND TOTAL RESPONSIBILITY FOR THE PROTECTION OF EXISTING UTILITIES NOR ANY DAMAGES CAUSED BY SAID CONTRACTOR DURING CONSTRUCTION.

REVISED FOR
CONSTRUCTION

CHANGED DETENTION POND
& PARKING LAYOUT.
AUG. 30, 2000

OWNER/DEVELOPER:
LOVE'S COUNTRY STORES, INC.
ATTN. MIKE L. ASHLEY
4214 PURDUE
HOUSTON, TEXAS 77005
(713)661-4102

DOUPHRADE & ASSOCIATES, INC.
ENGINEERING • PROJECT MANAGEMENT • SURVEYING
2235 RIDGE ROAD, SUITE 200 ROCKWALL, TEXAS 75087
PHONE: (972)771-9004 FAX: (972)771-9005

THE SEAL APPEARING ON THIS
DOCUMENT WAS AUTHORIZED BY
W.L. DOUPHRADE II TEXAS P.E.
NO. 60102 ON 8/31/00

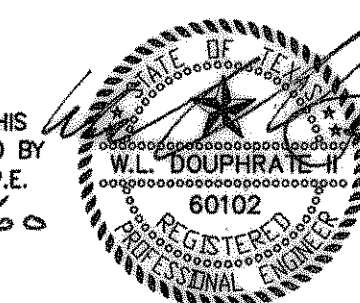

MARCH 2000

REPLAT OF LOVE'S ADDITION NO. 1

* 0007