

CITY OF ROCKWALL, TEXAS
COMPUTATION SHEET FOR DETERMINING
CAPACITY OF CURB OPENING INLET

INLET		D.A.	Q _p	CARRY-OVER FLOW	TOTAL FLOW	Z	Z/N	S ₀	Y ₀	PONDED WIDTH	L ₀	L ₀ ²	L	L ₀	Q ₀	Q ₀ ²	CARRY-OVER FLOW	REMARKS	
TYPE NO.	STATION	NO.	C.F.S.	1	Q ₀		FT/FT	FT.	FT.		FT.	FT.	FT.	FT.	FT.	FT.	1		
1	2	3	4	5	6	7	8	9	10	11	12	13	14	15	16	17	18	19	
15'	-	2	35.96	-	35.96	16	1000	0.0028	0.60	9.6	1.27	28.31	15	0.52	0.69	24.81	11.15		
10'	-	2	-	11.15	11.15	16	1000	0.0028	0.56	8.9	1.22	9.13	10	1.09	1.0	11.15	0		

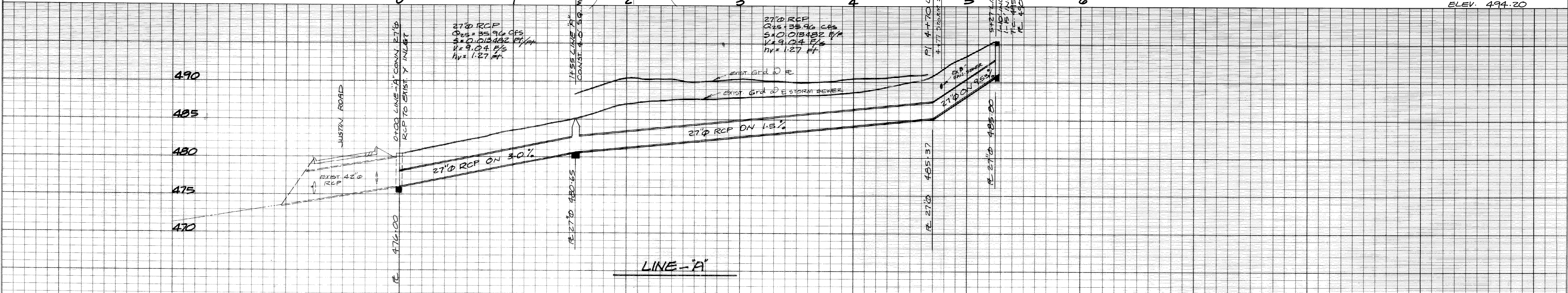

BENCH MARK:
"I" CUT IN DRIVEWAY TO ROCKWALL
MANUFACTORY CO. ON STATE HWY
NO 205
ELEV. 494.20

AS BUILT

REVISION DESCRIPTION		DATE	SCALE	DESIGN	DRAWN	HAROLD L. EVANS & ASSOCIATES Consulting Engineers P. O. Box 28355 2331 Gus Thomasson Road, Suite 102 Dallas, Texas 75228 (214) 328-8133	STORM SEWER PLAN REPLAT PART OF LOT 1 BLOCK-"A" LOPLAND INDUSTRIAL PARK CITY OF ROCKWALL ROCKWALL COUNTY, TEXAS	SHEET NO.
		4-21-87	1" = 40' H 1" = 6' V	A.S.	A.S.			C-6
							JOB NO.	
							8771	