

**CURVE REPORT**

CURVE	RADIUS	DELTA	TANGENT	LENGTH	CHORD	BEARING
C-12	36.00'	90°00'00"	36.00'	56.55'	50.91'	N46°47'30"W

**LEGEND**

TC	Top of Curb
TP	Top of Pavement
CR	Curve Return
FL	Flow Line
1	Street Station
2	Handicap Ramp
PP	Power Pole
WV	Water Valve
TP	Telephone Pedestal
WM	Water Meter
FH	Fire Hydrant
LP	Light Pole
IV	Irrigation Valve
TSN	Traffic Signs
SSMH	Sanitary Sewer Manhole
STMH	Storm Sewer Manhole
WMK	Water Marker
→	Flow line

207' L.F. OF 5.0' SIDEWALK TO BE BUILT BY DEVELOPER

STA. 5+40.21 (39.96' LT.) HAYMAKER DRIVE = CONST. 1-5' STD. CURB INLET  
 TC = 574.47  
 FL = 570.47  
 Hg = 571.63

STA. 5+41.27 HAYMAKER DRIVE = CENTER OF CUL-DE-SAC

PT STA. 5+16.27 HAYMAKER DRIVE

CR STA. 4+15.02 (16.1' LT.) ALLEY "12"  
 TC 574.80

CR STA. 4+05.05 (14.5' LT.) ALLEY "12"  
 INV 574.37

CR STA. 4+88.77 (14.5' LT.) HAYMAKER DRIVE  
 TC 575.10

CR STA. 4+05.05 (14.5' RT.) ALLEY "12"  
 INV 574.37

PI STA. 2+30.77 (14.5' LT.) HAYMAKER DRIVE = 19+61.60 (14.5' RT.) NEW HOLLAND DRIVE  
 TC 578.64

CR STA. 0+24.50 (14.5' RT.) ALLEY "12"  
 INV 577.16

CR STA. 0+24.50 (14.5' LT.) ALLEY "12"  
 INV 577.16

CR STA. 1+81.77 (14.5' LT.) HAYMAKER DRIVE  
 TC 580.67

PI STA. 2+01.77 (14.5' LT.) HAYMAKER DRIVE = 19+32.60 (14.5' LT.) NEW HOLLAND DRIVE  
 TC 578.94

CR STA. 0+44.92 (14.5' LT.) HAYMAKER DRIVE  
 TP 585.63

STA. 0+28.94 HAYMAKER DRIVE END CONCRETE PAVEMENT BEGIN ASPHALT PAVEMENT  
 TC 586.40  
 TP 585.90

CR STA. 0+14.92 (14.5' LT.) HAYMAKER DRIVE  
 TP 585.68

CR STA. 0+14.92 (44.49' LT.) HAYMAKER DRIVE

CR STA. 0+26.94 (44.51' RT.) HAYMAKER DRIVE

PI STA. 0+26.94 (14.5' RT.) HAYMAKER DRIVE  
 TC 585.40  
 TP 585.90

STA. 0+00 HAYMAKER DRIVE = CONNECT TO EXISTING ASPHALT PAVEMENT

CR STA. 0+14.92 (14.5' LT.) HAYMAKER DRIVE  
 TP 585.68

CR STA. 0+14.92 (44.49' LT.) HAYMAKER DRIVE

CR STA. 0+14.92 (14.5' LT.) HAYMAKER DRIVE  
 TP 585.68

CR STA. 0+14.92 (14.5' LT.) HAYMAKER DRIVE  
 TP 585.68

CR STA. 0+14.92 (14.5' LT.) HAYMAKER DRIVE  
 TP 585.68

CR STA. 0+14.92 (14.5' LT.) HAYMAKER DRIVE  
 TP 585.68

CR STA. 0+14.92 (14.5' LT.) HAYMAKER DRIVE  
 TP 585.68

CR STA. 0+14.92 (14.5' LT.) HAYMAKER DRIVE  
 TP 585.68

CR STA. 0+14.92 (14.5' LT.) HAYMAKER DRIVE  
 TP 585.68

CR STA. 0+14.92 (14.5' LT.) HAYMAKER DRIVE  
 TP 585.68

CR STA. 0+14.92 (14.5' LT.) HAYMAKER DRIVE  
 TP 585.68

CR STA. 0+14.92 (14.5' LT.) HAYMAKER DRIVE  
 TP 585.68

CR STA. 0+14.92 (14.5' LT.) HAYMAKER DRIVE  
 TP 585.68

CR STA. 0+14.92 (14.5' LT.) HAYMAKER DRIVE  
 TP 585.68

CR STA. 0+14.92 (14.5' LT.) HAYMAKER DRIVE  
 TP 585.68

CR STA. 0+14.92 (14.5' LT.) HAYMAKER DRIVE  
 TP 585.68

CR STA. 0+14.92 (14.5' LT.) HAYMAKER DRIVE  
 TP 585.68

CR STA. 0+14.92 (14.5' LT.) HAYMAKER DRIVE  
 TP 585.68

CR STA. 0+14.92 (14.5' LT.) HAYMAKER DRIVE  
 TP 585.68

CR STA. 0+14.92 (14.5' LT.) HAYMAKER DRIVE  
 TP 585.68

CR STA. 0+14.92 (14.5' LT.) HAYMAKER DRIVE  
 TP 585.68

CR STA. 0+14.92 (14.5' LT.) HAYMAKER DRIVE  
 TP 585.68

CR STA. 0+14.92 (14.5' LT.) HAYMAKER DRIVE  
 TP 585.68

CR STA. 0+14.92 (14.5' LT.) HAYMAKER DRIVE  
 TP 585.68

CR STA. 0+14.92 (14.5' LT.) HAYMAKER DRIVE  
 TP 585.68

CR STA. 0+14.92 (14.5' LT.) HAYMAKER DRIVE  
 TP 585.68

CR STA. 0+14.92 (14.5' LT.) HAYMAKER DRIVE  
 TP 585.68

CR STA. 0+14.92 (14.5' LT.) HAYMAKER DRIVE  
 TP 585.68

CR STA. 0+14.92 (14.5' LT.) HAYMAKER DRIVE  
 TP 585.68

CR STA. 0+14.92 (14.5' LT.) HAYMAKER DRIVE  
 TP 585.68

CR STA. 0+14.92 (14.5' LT.) HAYMAKER DRIVE  
 TP 585.68

CR STA. 0+14.92 (14.5' LT.) HAYMAKER DRIVE  
 TP 585.68

Winkelmann & Associates, Inc. hereby states that this plan, to the best of our knowledge is "As Built." Modifications from the originally approved construction documents have been made as per information provided by the contractor. Winkelmann & Associates, Inc. does not certify as to the correctness or quality of construction as no final inspection was performed.

*W. Winkelmann* 6/17/05  
 WINKELMANN & ASSOCIATES, INC. DATE

THESE CONSTRUCTION PLANS WERE PREPARED UNDER THE CLOSE PERSONAL SUPERVISION OF MD. NAIM UDDIN KHAN, REGISTERED PROFESSIONAL ENGINEER NO. 87776

*W. Winkelmann* 6/17/05  
 WINKELMANN & ASSOCIATES, INC. DATE

BENCHMARK: ELEV. = 600.69  
 CITY OF ROCKWALL R-19  
 BRASS MONUMENT AT THE N/W CORNER OF SILVERVIEW & DIAMOND WAY. 500' ± SOUTH OF S.H. 276.

BENCHMARK: ELEV. = 583.56  
 R.R. SPIKE SET IN THE CENTERLINE OF S.H. 276  
 3600± WEST OF F.M. 549

THE SEAL APPEARING ON THIS DOCUMENT WAS AUTHORIZED BY MD. NAIM UDDIN KHAN, P.E. #87776

W.H. BAIRD SURVEY, ABSTRACT NO. 25  
 CITY OF ROCKWALL, TEXAS

D.R. HORTON  
 4306 MILLER ROAD, SUITE-A  
 ROWLETT, TEXAS 75068

LOFLAND FARMS, PHASE 5B  
 CITY OF ROCKWALL, TEXAS

THE SEAL APPEARING ON THIS DOCUMENT WAS AUTHORIZED BY MD. NAIM UDDIN KHAN, P.E. #87776

Scale: 1" = 40'

Designed By: RB  
 Drawn By: MK  
 Checked By: NK  
 File: 3200458P7.DWG View:  
 Project No.: 32004-01

SHEET 9 OF 28

DATE: 07-09-04

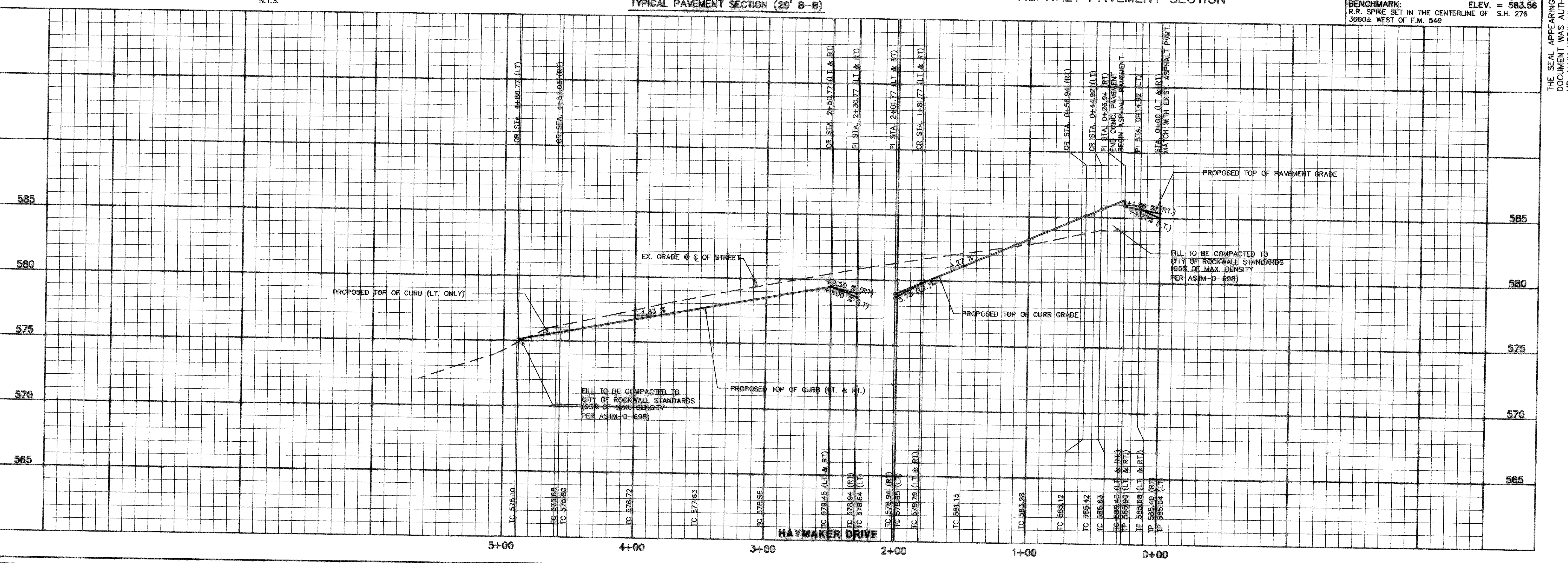
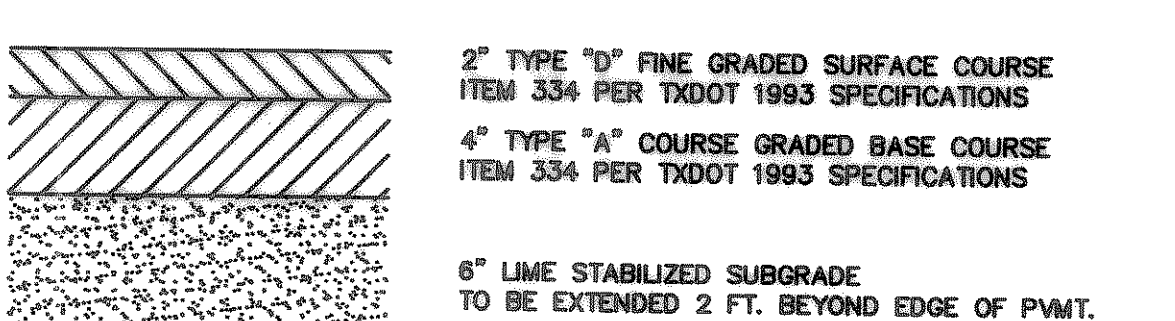
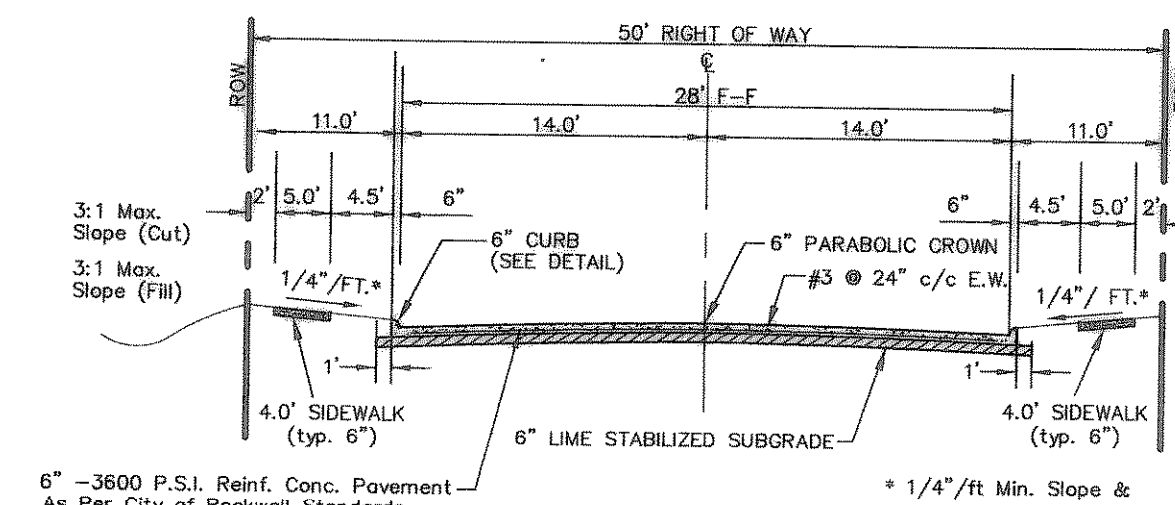
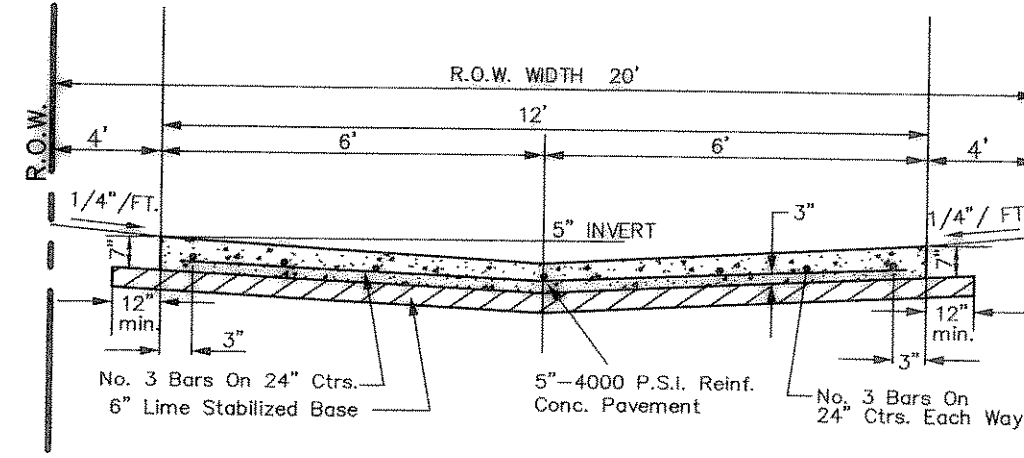
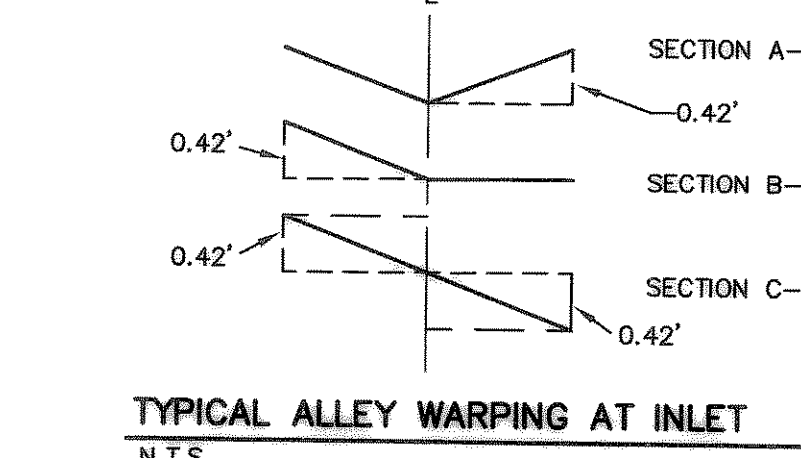

**Winkelmann & Associates, Inc.**  
 CONSULTING CIVIL ENGINEERS & SURVEYORS  
 6750 Hillcrest Plaza, Suite 100  
 Dallas, Texas 75230  
 (972) 492-7888 FAX  
 www.winkelmann.com

THE SEAL APPEARING ON THIS DOCUMENT WAS AUTHORIZED BY MD. NAIM UDDIN KHAN, P.E. #87776

**PAVING PLAN & PROFILE**  
**HAYMAKER DRIVE**  
**STA. 0+00 TO STA. 5+41.27**  
**PAVING PLAN - ALLEY 12 STA. 0+00 TO 4+29.55**

Scale: 1" = 40'  
 Date: 07-09-04  
 Designed By: RB  
 Drawn By: MK  
 Checked By: NK  
 File: 3200458P7.DWG View:  
 Project No.: 32004-01

SHEET 9 OF 28