

NOTE:
 1) PAVEMENT FOR STREETS SHALL CONSIST OF 6" 3600 P.S.I. REINFORCED CONCRETE AND 6" LIME-STABILIZED SUBGRADE WITH 6" PARABOLIC CROWN.
 2) PAVEMENT FOR ALLEYS SHALL CONSIST OF 4000 P.S.I. REINFORCED CONCRETE AND 6" LIME-STABILIZED SUBGRADE WITH 5" INVERT. TYPICAL ALLEY SECTION WILL BE 7'-5"-7".
 3) CONTRACTOR TO RUN LIME SERIES BEFORE CONSTRUCTION.

- LEGEND
- TC Top of Curb
 - TP Top of Pavement
 - CR Curve Return
 - FL Flow Line
 - 2 Street Station
 - Handicap Ramp
 - PP Power Pole
 - WP Water Valve
 - TP Telephone Pedestal
 - WM Water Meter
 - FH Fire Hydrant
 - LP Light Pole
 - IV Irrigation Valve
 - TSN Traffic Signs
 - SSMH Sanitary Sewer Manhole
 - STMH Storm Sewer Manhole
 - WMK Water Marker
 - Flow line

STA. 21+57.11 (14.5' LT.)
 NEW HOLLAND DRIVE =
 CONST. 1-10' STD. CURB INLET
 TC = 576.61
 FL = 572.61
 Hg = 573.05

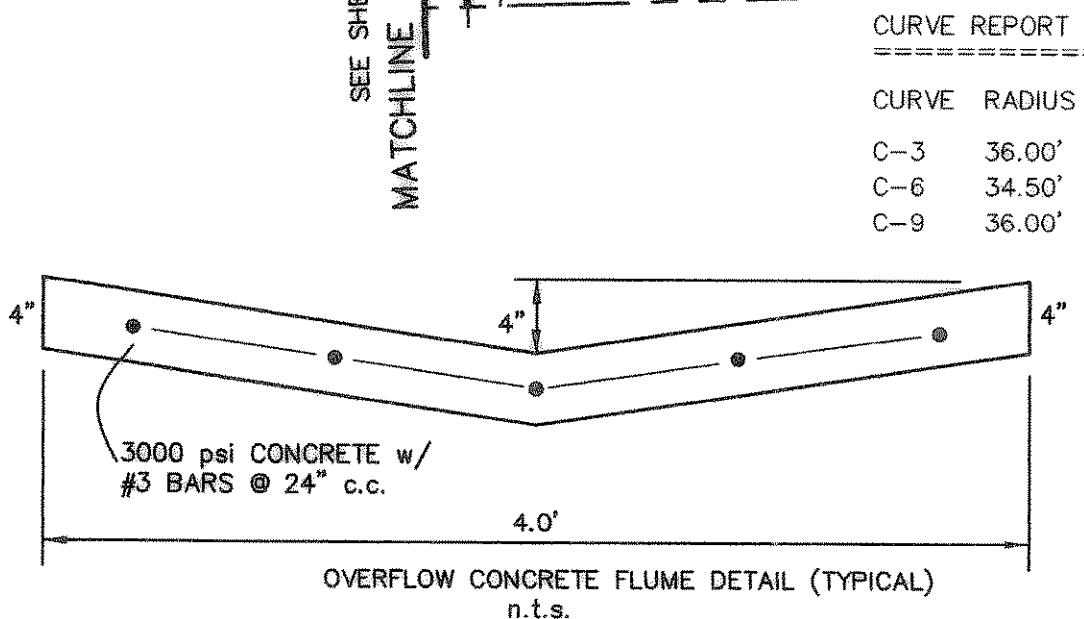

CURVE REPORT

CURVE RADIUS	DELTA	TANGENT	LENGTH	CHORD	BEARING
C-3 36.00'	90°00'00"	36.00'	56.55'	50.91'	S43°12'30"W
C-6 34.50'	89°58'49"	34.49'	54.18'	48.78'	S46°46'54"E
C-9 36.00'	90°00'00"	36.00'	56.55'	50.91'	S46°47'30"E

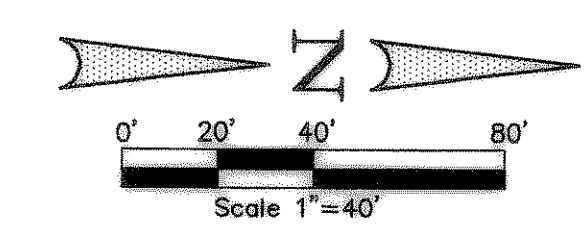
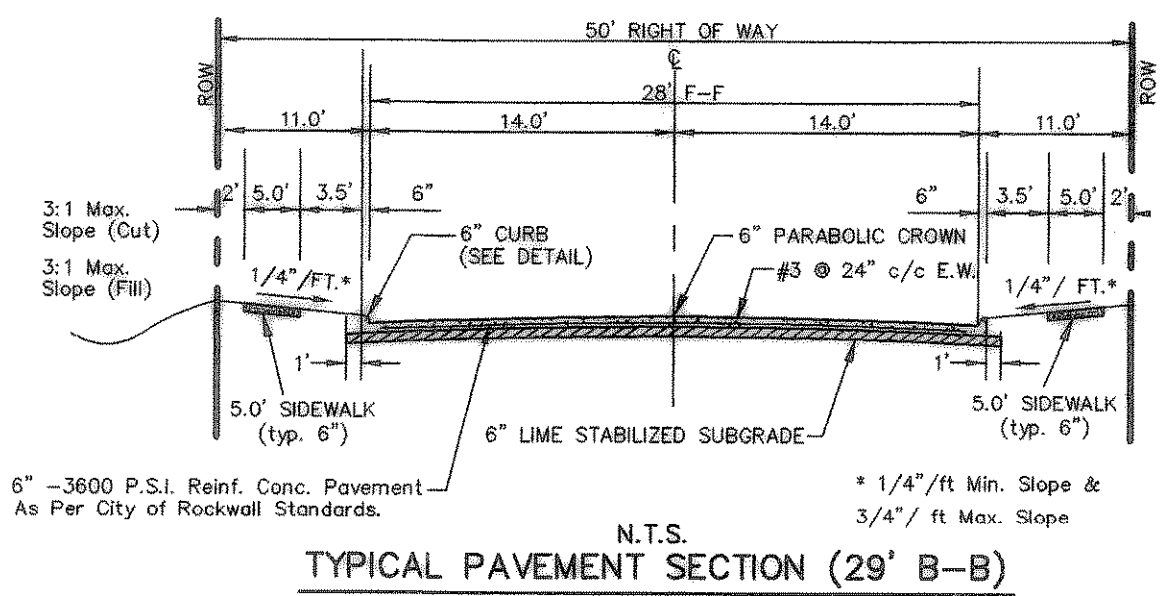
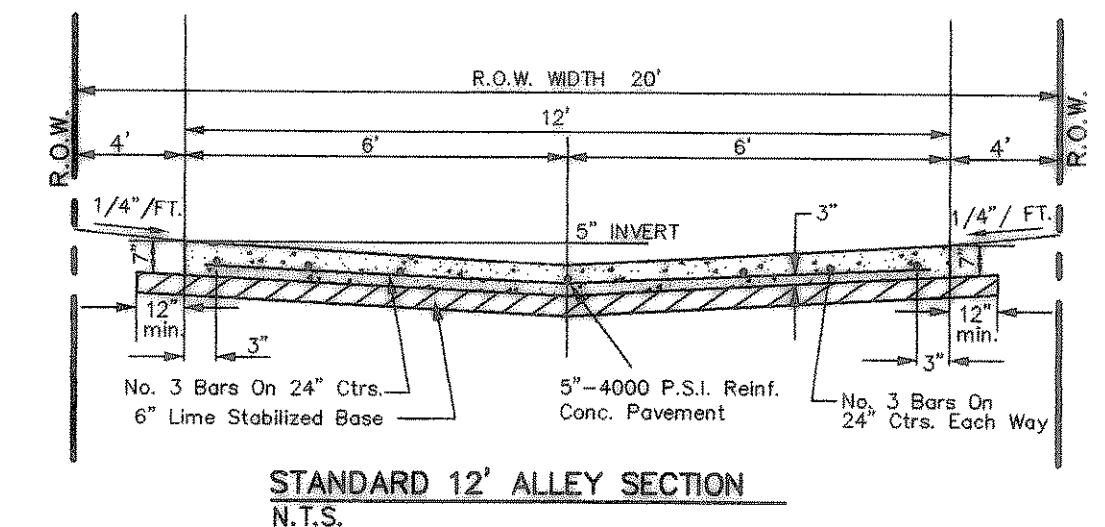
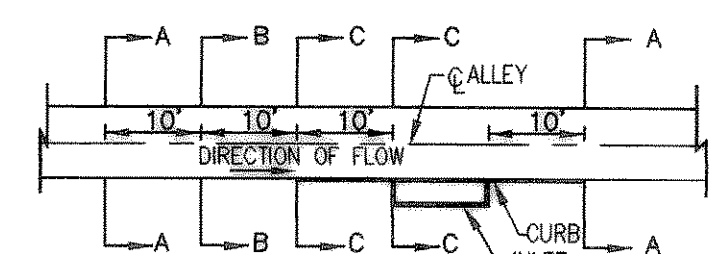

BENCHMARK: ELEV. = 600.69
 CITY OF ROCKWALL R-19
 BRASS MONUMENT AT THE N/W CORNER OF
 SILVERVIEW & DIAMOND WAY, 500' ± SOUTH OF
 S.H. 276

BENCHMARK: ELEV. = 583.56
 R.R. SPIKE SET IN THE CENTERLINE OF S.H. 276
 3600± WEST OF F.M. 549

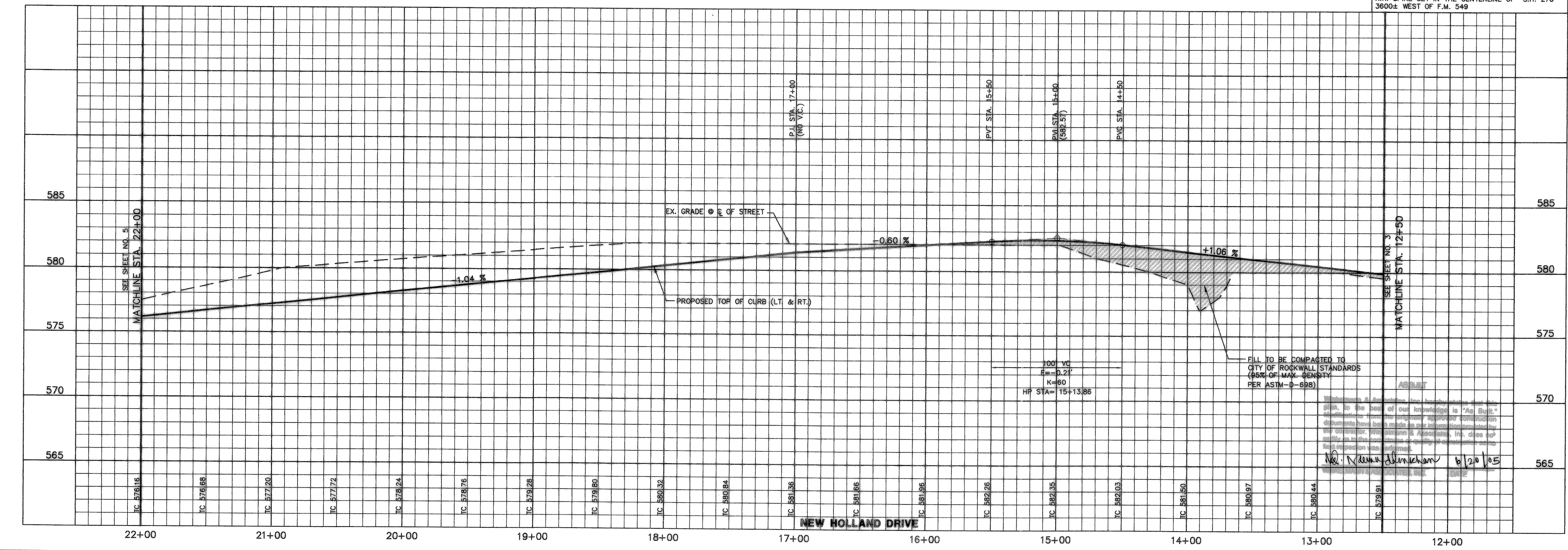

THESE CONSTRUCTION PLANS WERE PREPARED UNDER THE RESPONSIBLE SUPERVISION OF M.D. NAIM UDDIN KHAN, REGISTERED PROFESSIONAL ENGINEER NO. 87776.

THE SEAL APPEARING ON THIS DOCUMENT WAS AUTHORIZED BY M.D. NAIM UDDIN KHAN, P.E. #87776

Winkelmann & Associates, Inc.
 CONSULTING CIVIL ENGINEERS & SURVEYORS
 8776 Highway 280, Suite 100
 Rockwall, Texas 75087
 (972) 462-7900
 www.winkelmann.com

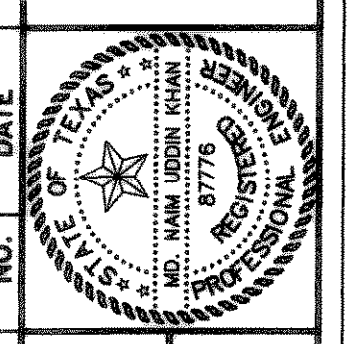

LOFLAND FARMS, PHASE 5B
 W.H. BAIRD CIVIL ENGINEERING, INC.
 ROCKWALL COUNTY, TEXAS

D.R. HORTON
 4306 MILLER ROAD, SUITE-A
 ROWLETT, TEXAS 75088

PAVING PLAN & PROFILE
 AVERY DRIVE - STA. 12+50 TO STA. 19+38.85
 NEW HOLLAND DR. STA. 13+38.85 TO STA. 22+00
 PAVING PLAN - ALLEY 10 STA. 3+00 TO 13+23.58
 PAVING PLAN - ALLEY 13 STA. 0+00 TO 3+00

Scale: 1"=40' Date: 07/09/04
 Designed By: RB
 Drawn By: MK
 Checked By: NK
 File: 320045B2.DWG View:
 Project No.: 32004.01

SHEET
4
 OF
28