

LEGEND

TC	Top of Curb
TP	Top of Pavement
CR	Curve Return
FL	Flow Line
?	Street Station
△	Handicap Ramp @ Street & Street Intersection
□	Handicap Ramp @ Street & Alley Intersection
PP	Power Pole
WV	Water Valve
TP	Telephone Pedestal
WM	Water Meter
FH	Fire Hydrant
LP	Light Pole
IV	Irrigation Valve
TSN	Traffic Signs
SSMH	Sanitary Sewer Manhole
STMH	Storm Sewer Manhole
WMK	Water Marker
B-B	Back to Back
C-C	Center to Center

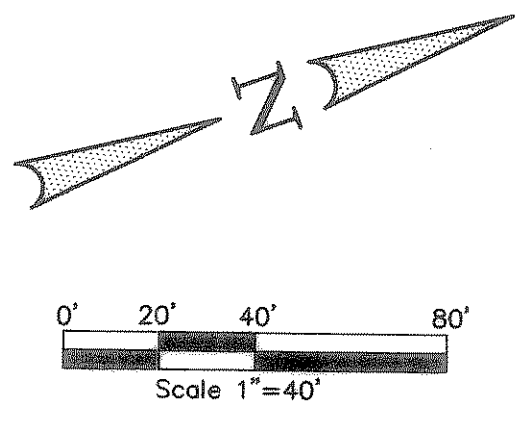
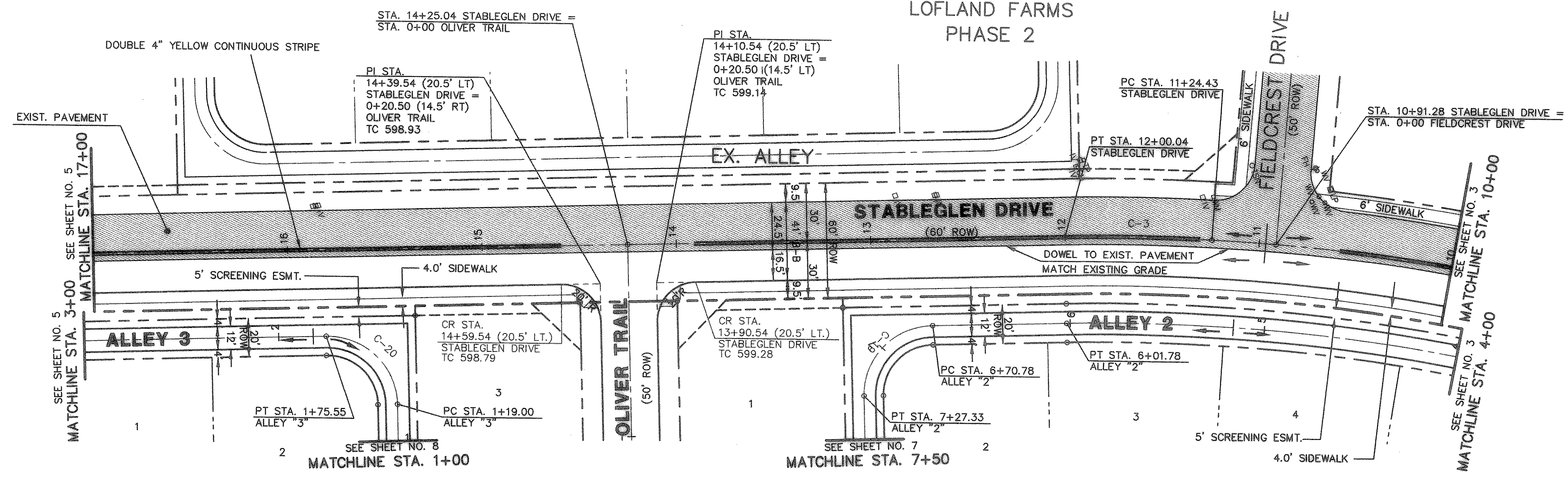

CURVE REPORT

CURVE	RADIUS	DELTA	TANGENT	LENGTH	CHORD	BEARING
C-3	1000.00'	04°19'55"	37.82'	75.60'	75.59'	S20°23'39"W
C-19	36.00'	90°00'00"	36.00'	56.55'	50.91'	S26°46'18"E
C-20	36.00'	90°00'00"	36.00'	56.55'	50.91'	S63°13'42"W

- NOTE:**
- 1) PAVEMENT FOR STREETS SHALL CONSIST OF 6" 3600 P.S.I. REINFORCED CONCRETE AND 6" LIME-STABILIZED SUBGRADE WITH 6" PARABOLIC CROWN.
 - 2) PAVEMENT FOR ALLEYS SHALL CONSIST OF 4000 P.S.I. REINFORCED CONCRETE AND 6" LIME-STABILIZED SUBGRADE WITH 5" INVERT. TYPICAL ALLEY SECTION WILL BE 7"-5"-7".
 - 3) CONTRACTOR TO RUN LIME SERIES BEFORE CONSTRUCTION.

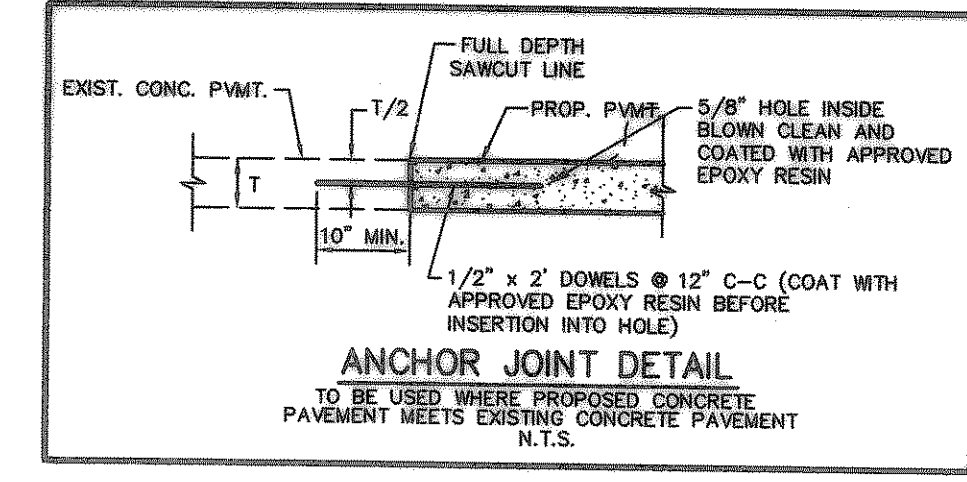
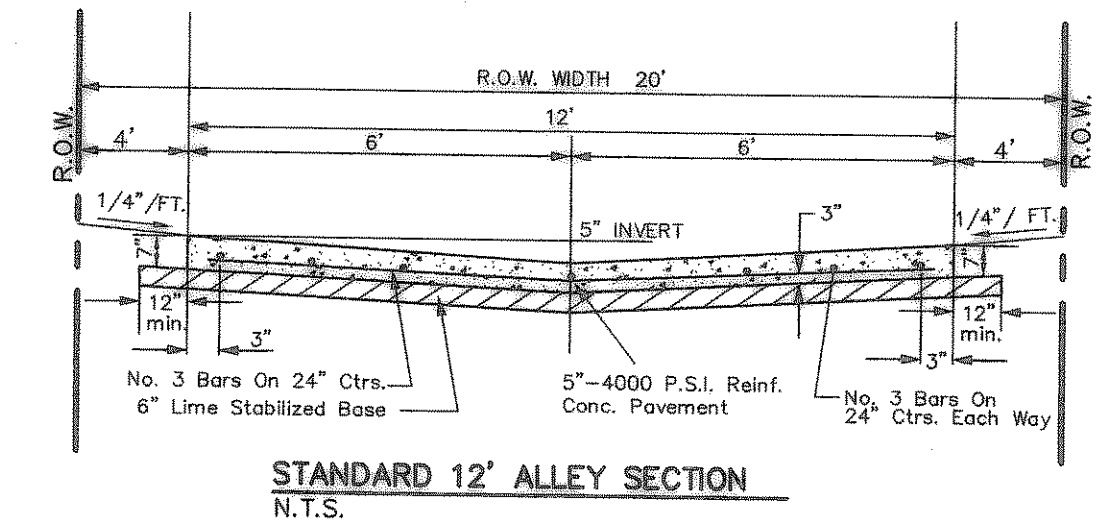
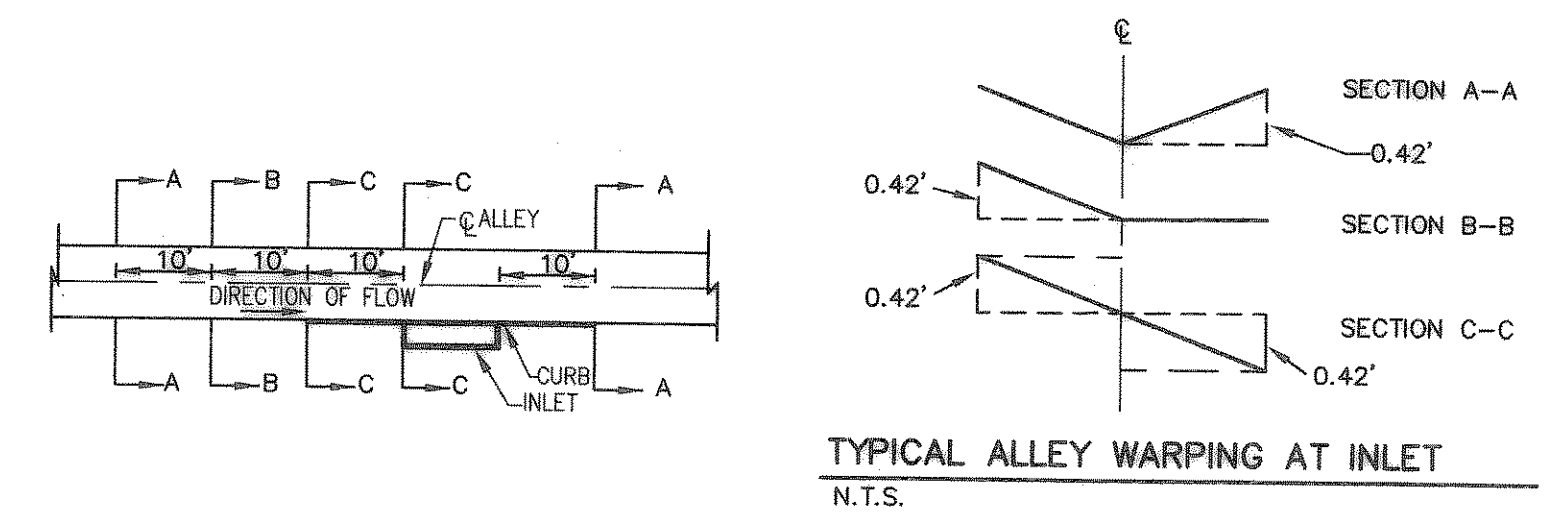

BENCHMARK: ELEV. = 600.69
CITY OF ROCKWALL R-19 BRASS MONUMENT AT THE N/W CORNER OF SILVERVIEW & DIAMOND WAY, 500' ± SOUTH OF S.H. 276.

BENCHMARK: ELEV. = 583.56
R.R. SPIKE SET IN THE CENTERLINE OF S.H. 276 3600± WEST OF F.M. 549

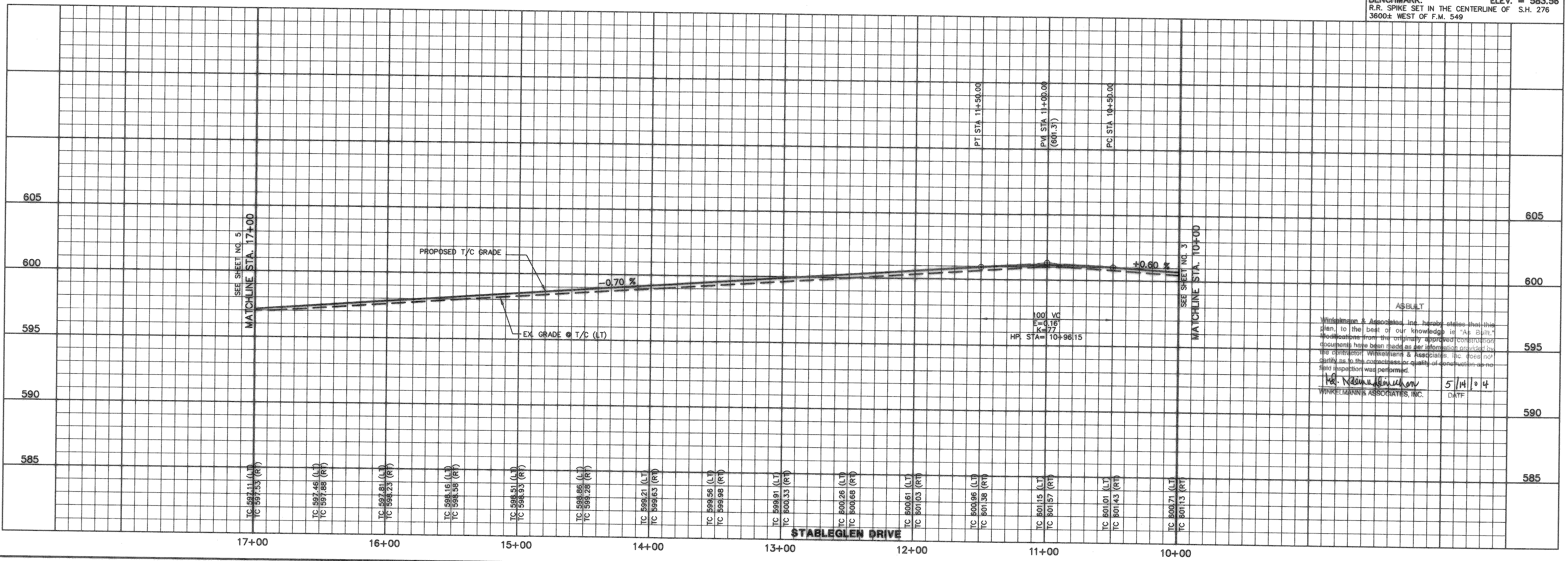

Winkelmann & Associates, Inc. hereby states that this plan, to the best of our knowledge is "As Built." Indications from the original approved construction documents have been made as far as possible by the contractor, Winkelmann & Associates, Inc. For further details as to the correctness or quality of construction, the field inspector was performed.

W. Winkelmann
WINKELMANN ASSOCIATES, INC.
DATE: 5/14/04

THESE CONSTRUCTION PLANS WERE PREPARED UNDER THE RESPONSIBLE SUPERVISION OF MD. NAIM UDDIN KHAN, REGISTERED PROFESSIONAL ENGINEER NO. 87776

THE SEAL APPEARING ON THIS DOCUMENT WAS AUTHORIZED BY MD. NAIM UDDIN KHAN, # 87776

Winkelmann & Associates, Inc.
CONSULTING CIVIL ENGINEERS & SURVEYORS
6250 Wilshire Plaza, Suite 100
Dallas, Texas 75230
(972) 492-2092 FAX
www.winkelmann.com

STATE OF TEXAS
N. NAIM UDDIN KHAN
REGISTERED PROFESSIONAL ENGINEER
NO. 87776

LOFLAND FARMS, PHASE 5A
W.H. BAIRD SURVEY, ABSTRACT NO. 25
CITY OF ROCKWALL,
ROCKWALL COUNTY, TEXAS

CONTINENTAL HOMES
621 WEST COLLEGE STREET
GRAPEVINE, TEXAS 76051

PAVING PLAN & PROFILE
STABLEGLEN DRIVE - STA. 10+00 TO 17+00
PAVING PLAN - ALLEY 2 STA. 4+00 TO 7+50
PAVING PLAN - ALLEY 3 STA. 1+00 TO 3+00

Scale: 1" = 40' Date: 5-14-04
Designed By: RB
Drawn By: MK
Checked By: MK
File: 320046A2.DWG View:
Project No.: 32004.01

SHEET
4
OF
35