

- NOTE:
- 1) PAVEMENT FOR STREETS SHALL CONSIST OF 6" 3600 P.S.I. REINFORCED CONCRETE AND 6" LIME-STABILIZED SUBGRADE WITH 6" PARABOLIC CROWN.
 - 2) PAVEMENT FOR ALLEYS SHALL CONSIST OF 4000 P.S.I. REINFORCED CONCRETE AND 6" LIME-STABILIZED SUBGRADE WITH 5" INVERT. TYPICAL ALLEY SECTION WILL BE 7'-5"-7".
 - 3) CONTRACTOR TO RUN LIME SERIES BEFORE CONSTRUCTION.

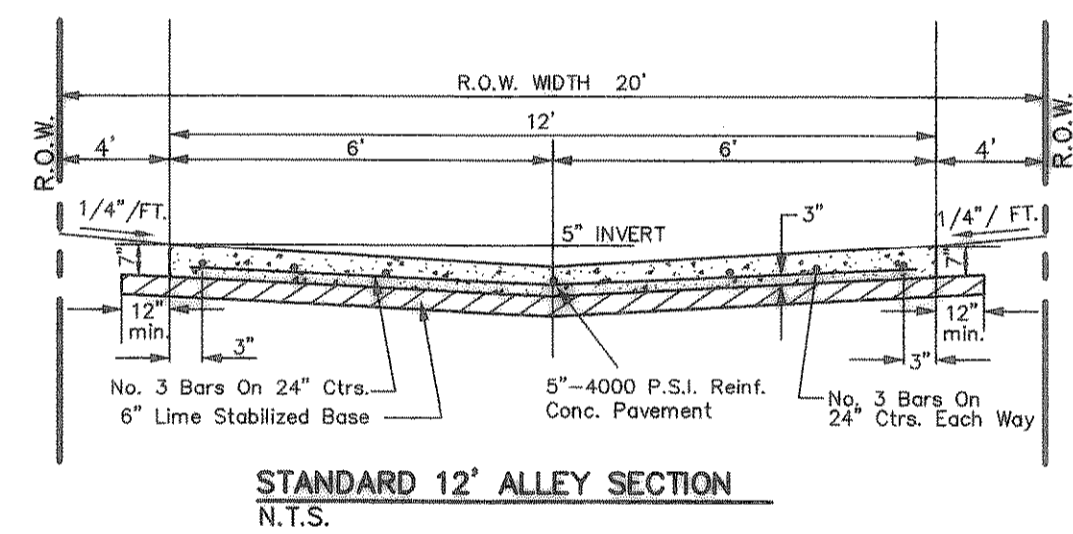

CURVE REPORT

CURVE	RADIUS	DELTA	TANGENT	LENGTH	CHORD	BEARING
C-1	500.00'	45°52'44"	211.61'	400.37'	389.76'	S21°55'43"W
C-2	1000.00'	22°18'29"	197.17'	389.35'	386.89'	S33°42'50"W
C-5	36.00'	85°27'32"	33.25'	53.70'	48.85'	N10°27'59"W
C-6	545.00'	33°16'26"	162.85'	316.50'	312.07'	N15°37'34"E
C-7	36.00'	89°59'44"	36.00'	56.55'	50.91'	N43°59'13"E
C-17	36.00'	91°05'56"	36.70'	57.24'	51.40'	S89°10'07"W
C-18	955.00'	25°32'27"	216.45'	425.71'	422.20'	S30°59'55"W

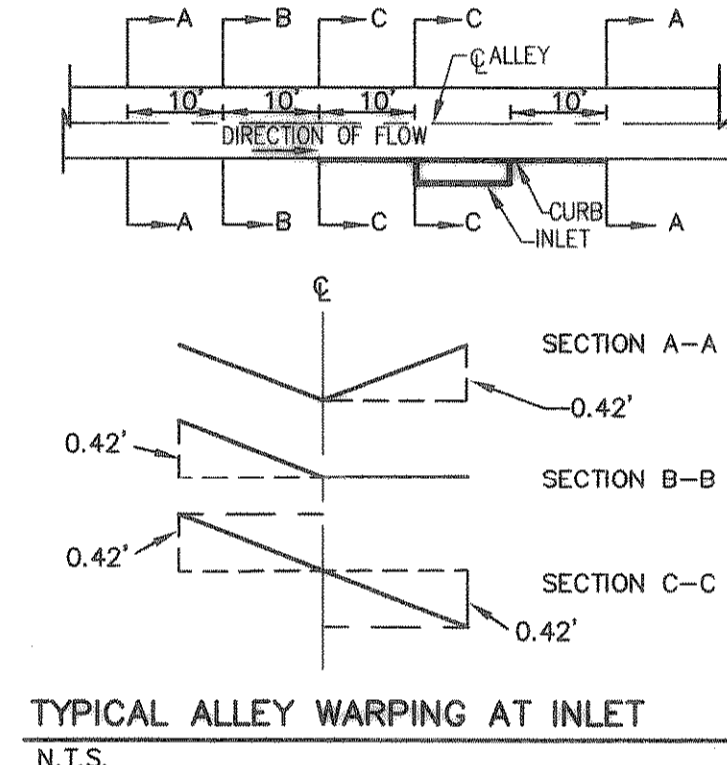
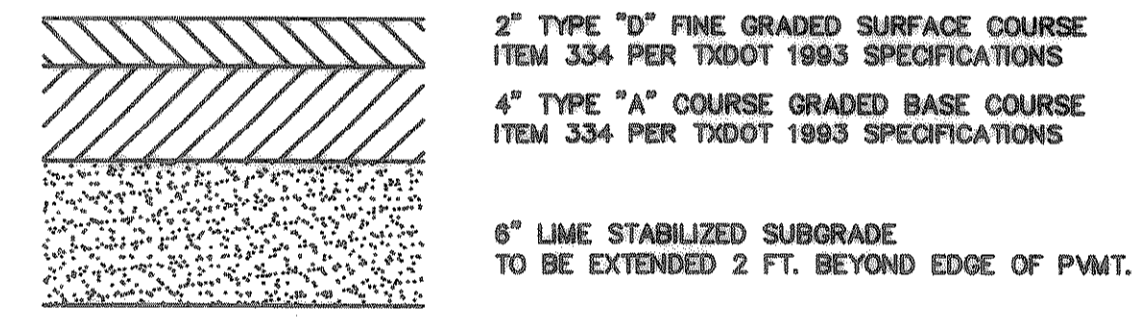

- LEGEND**
- TC Top of Curb
 - TP Top of Pavement
 - CR Curve Return
 - FL Flow Line
 - 2 Street Station
 - Handicap Ramp @ Street & Street Intersection
 - Handicap Ramp @ Street & Alley Intersection
 - PP Power Pole
 - WV Water Valve
 - TP Telephone Pedestal
 - WM Water Meter
 - FH Fire Hydrant
 - LP Light Pole
 - IV Irrigation Valve
 - TSN Traffic Signs
 - SSMH Sanitary Sewer Manhole
 - STMH Storm Sewer Manhole
 - WMK Water Marker
 - B-B Back to Back
 - C-C Center to Center

BENCHMARK: ELEV. = 600.69
CITY OF ROCKWALL R-19
BRASS MONUMENT AT THE N/W CORNER OF
SILVERVIEW & DIAMOND WAY, 500' ± SOUTH OF
S.H. 276.

BENCHMARK: ELEV. = 583.56
R.R. SPIKE SET IN THE CENTERLINE OF S.H. 276
3600± WEST OF F.M. 549

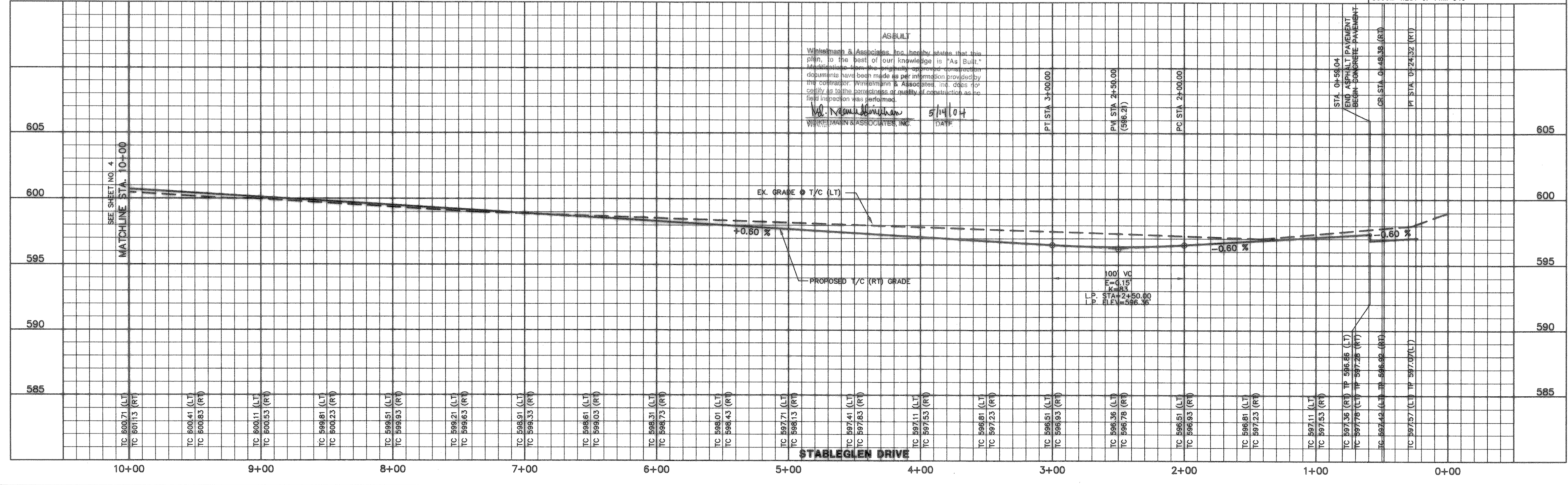

ASBUILT
Winkelmann & Associates, Inc. hereby states that this plan, to the best of our knowledge is "As Built."
Multiple copies of this plan were prepared and distributed. If any discrepancies have been made as per information provided by the contractor, Winkelmann & Associates, Inc. does not assume any liability for the accuracy or quality of construction as no field inspection was performed.
Winkelmann & Associates, Inc. 5/14/04
WINKELMANN & ASSOCIATES, INC.

THESE CONSTRUCTION PLANS WERE PREPARED UNDER THE RESPONSIBLE SUPERVISION OF
MD. NAIM UDDIN KHAN, REGISTERED PROFESSIONAL ENGINEER NO. 87776

DATE: 5/14/04

NO. 15103

W.H. BAIRD SURVEY ABSTRACT NO. 25
CITY OF ROCKWALL, TEXAS

LOT AND FARMS, PHASE 5A
ROCKWALL, TEXAS

CONTINENTAL HOMES
621 WEST COLLEGE STREET
GRAPEVINE, TEXAS 76051

THE SEAL APPEARING ON THIS DOCUMENT WAS AUTHORIZED BY
MD. NAIM UDDIN KHAN, # 87776

PAVING PLAN & PROFILE
STABLEGLEN DRIVE - STA. 0+00 TO STA. 10+00
ALLEY 1 STA. 1+00 TO 6+50
ALLEY 2 STA. 1+00 TO 4+00

Scale: 1" = 40'
Date: 9-04-03
Designed By: RB
Drawn By: MK
Checked By: NK
File: 320045A(P)DWG View:
Project No.: 32004.01

Winkelmann & Associates, Inc.
CONSULTING CIVIL ENGINEERS & SURVEYORS
6710 Wilshire Place, Suite 400, Dallas, Texas 75220
(972) 799-7742
www.winkelmann.com

APPROV. _____
REVISION _____
DATE _____

SHEET 3 OF 35