

TYPICAL ALLEY WARPING AT INLET  
N.T.S.

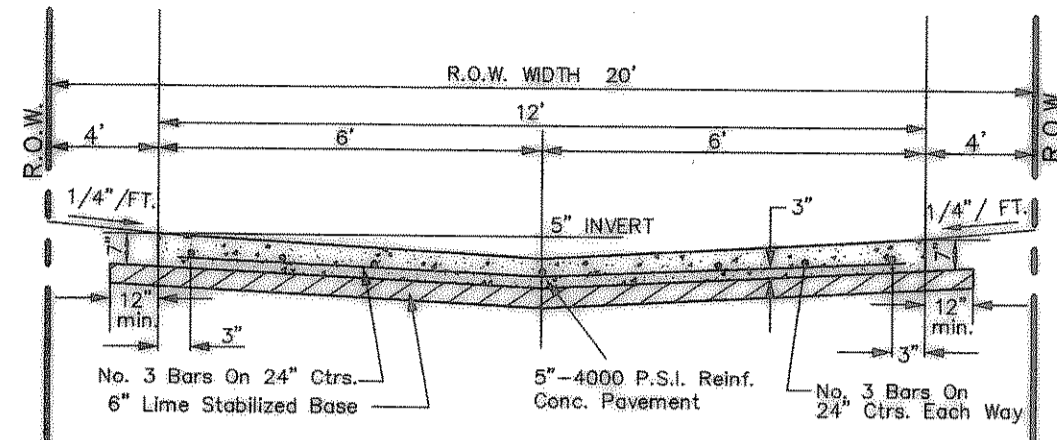

STANDARD 12' ALLEY SECTION  
N.T.S.

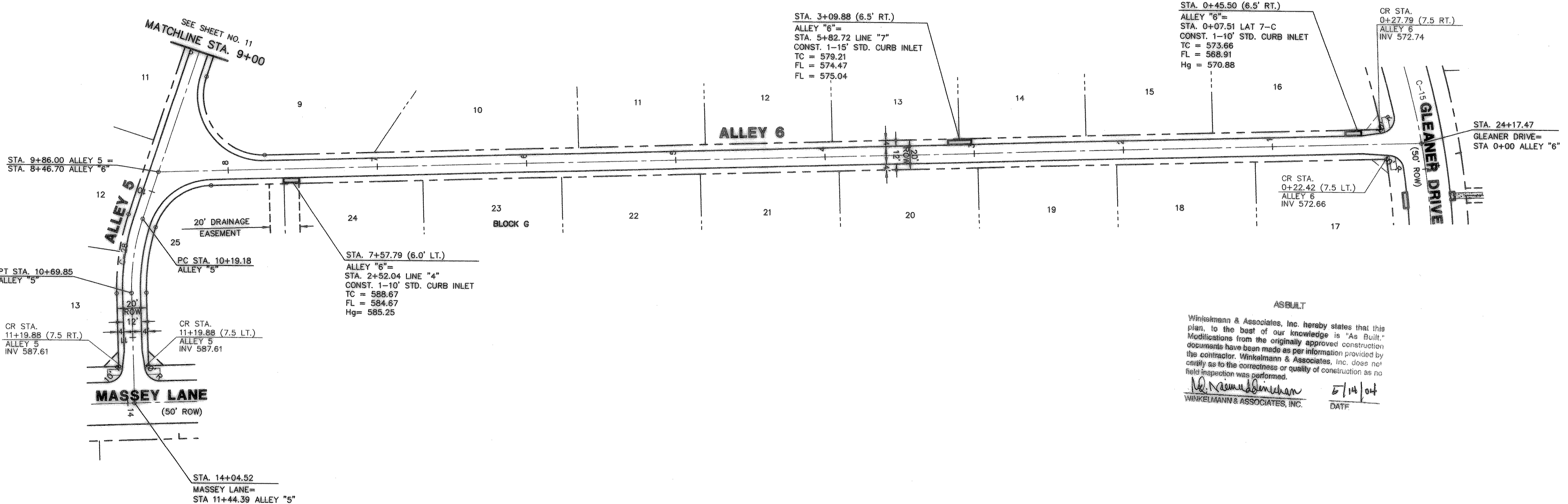

- NOTE:
- 1) PAVEMENT FOR STREETS SHALL CONSIST OF 6" 3600 P.S.I. REINFORCED CONCRETE AND 6" LIME-STABILIZED SUBGRADE WITH 6" PARABOLIC CROWN.
  - 2) PAVEMENT FOR ALLEYS SHALL CONSIST OF 4000 P.S.I. REINFORCED CONCRETE AND 6" LIME-STABILIZED SUBGRADE WITH 5" INVERT. TYPICAL ALLEY SECTION WILL BE 7"-5"-7".
  - 3) CONTRACTOR TO RUN LIME SERIES BEFORE CONSTRUCTION.

CURVE REPORT

CURVE	RADIUS	DELTA	TANGENT	LENGTH	CHORD	BEARING
C-15	500.00'	24°40'34"	109.37'	215.34'	213.68'	N14°07'28"W
C-28	145.00'	20°01'25"	25.60'	50.67'	50.42'	S08°12'59"W

- LEGEND
- TC TOP OF CURB
  - TP TOP OF PAVEMENT
  - CR CURVE RETURN
  - FL FLOW LINE
  - STREET STATION
  - Handicap Ramp @ Street & Street Intersection
  - Handicap Ramp @ Street & Alley Intersection

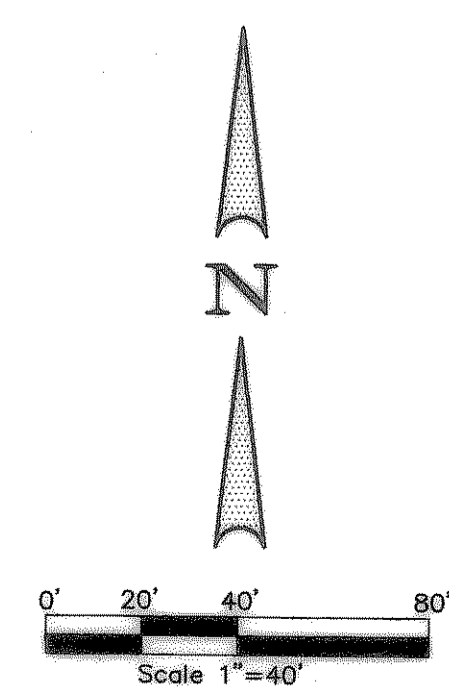

BENCHMARK: ELEV. = 600.69  
CITY OF ROCKWALL R-19  
BRASS MONUMENT AT THE N/W CORNER OF  
SILVERVIEW & DIAMOND WAY. 500' ± SOUTH OF  
S.H. 276.

BENCHMARK: ELEV. = 583.56  
R.R. SPIKE SET IN THE CENTERLINE OF S.H. 276  
3600± WEST OF F.M. 549

THESE CONSTRUCTION PLANS WERE PREPARED UNDER THE RESPONSIBLE SUPERVISION OF M.D. NAIM UDDIN KHAN, REGISTERED PROFESSIONAL ENGINEER NO. 87776.

THE SEAL APPEARING ON THIS DOCUMENT WAS AUTHORIZED BY M.D. NAIM UDDIN KHAN, # 87776

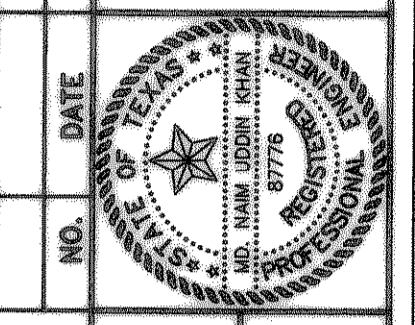

LOFLAND FARMS, PHASE 5A  
SURVEY, ABSTRACT NO. 25  
ROCKWALL COUNTY, TEXAS  
CONTINENTAL HOMES  
621 WEST COLLEGE STREET  
GRAPEVINE, TEXAS 76051

**ASBUILT**

Winkelman & Associates, Inc. hereby states that this plan, to the best of our knowledge is "As Built." Modifications from the originally approved construction documents have been made as per information provided by the contractor. Winkelman & Associates, Inc. does not certify as to the correctness or quality of construction as no field inspection was performed.

*M.D. Naim Uddin Khan* 5/14/04  
WINKELMANN & ASSOCIATES, INC. DATE

Scale: 1" = 40'  
Designed By: RB  
Drawn By: MK  
Checked By: NK  
File: 320045A.P10.DWG View:  
Project No.: 32004.01

SHEET  
14  
OF  
35

APPROV:  
REVISION  
NO. DATE

**Winkelman & Associates, Inc.**  
CONSULTING CIVIL ENGINEERS & SURVEYORS  
6000 Industrial Plaza Drive, Suite 100  
Rockwall, Texas 75087  
(972) 462-7900  
www.winkelman.com