

- LEGEND
- TC TOP OF CURB
 - TP TOP OF PAVEMENT
 - INV INVERT
 - CR CURB RETURN
 - FL FLOW LINE
 - BFR BARRIER FREE RAMP
 - ± STREET STATION
 - ± FLOW ARROW

BENCHMARK: CITY OF ROCKWALL R-19
BRASS MONUMENT AT THE N/W CORNER OF SILVERVIEW & DIAMOND WAY, 500' ± SOUTH OF S.H. 278
ELEV. = 600.69

BENCHMARK: F.R. SPIKE SET IN THE CENTERLINE OF S.H. 278 3600' WEST OF F.M. 949
ELEV. = 583.56

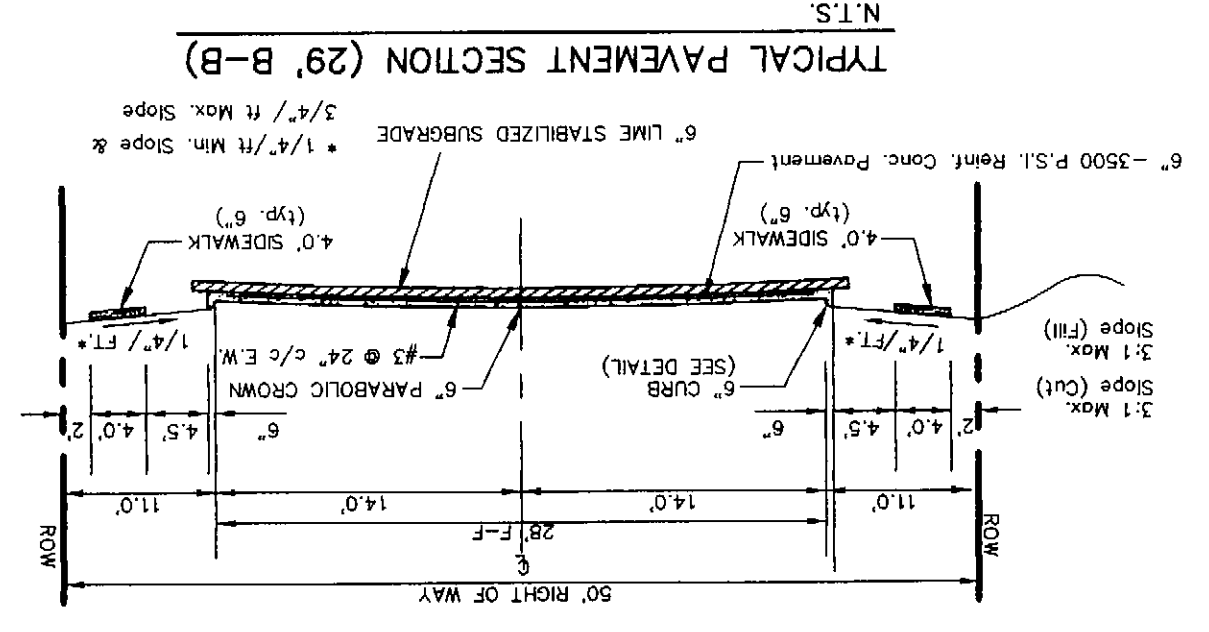
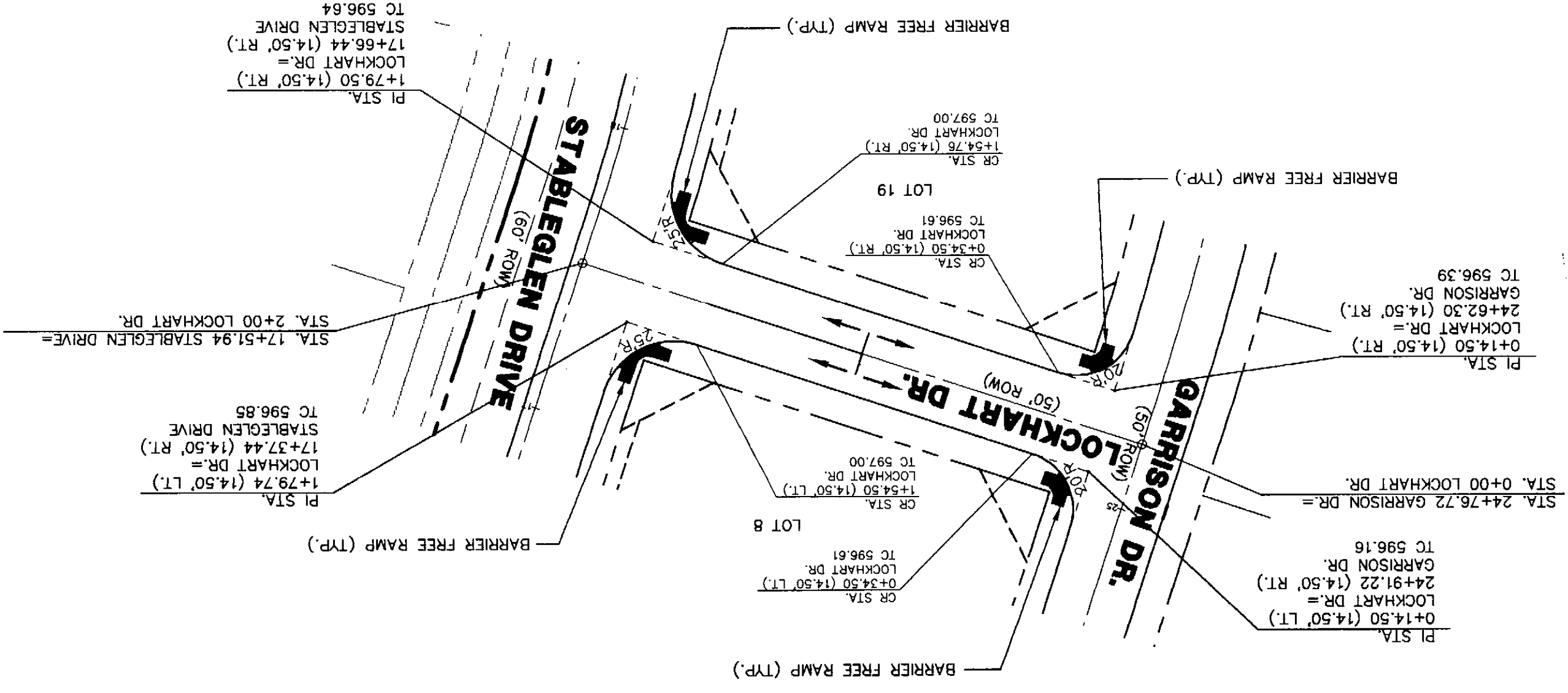
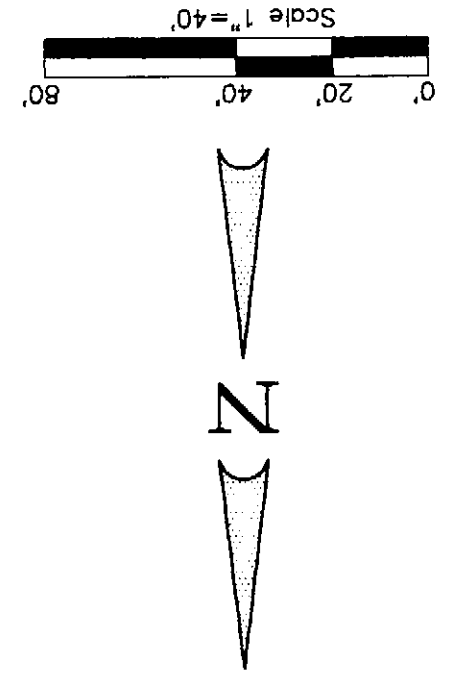

NOTE:

- 1) PAVEMENT FOR STREETS SHALL CONSIST OF 6" LIME-STABILIZED SUBGRADE WITH 6" AND 6" LIME-STABILIZED CONCRETE INVERT. TYPICAL ALLEY SECTION WILL BE 7'-5"-7".
- 2) PAVEMENT FOR ALLEYS SHALL CONSIST OF MIN. 5" 4000 P.S.I. REINFORCED CONCRETE AND 6" LIME-STABILIZED SUBGRADE WITH 5" INVERT. TYPICAL ALLEY SECTION WILL BE 7'-5"-7".

Written & Associates, Inc. hereby states that this plan, to the best of our knowledge and belief, conforms with the information provided by the contractor. Written & Associates, Inc. does not warrant or assume any liability for the accuracy or completeness of the information provided by the contractor. Written & Associates, Inc. is not responsible for the accuracy or completeness of the information provided by the contractor. Written & Associates, Inc. is not responsible for the accuracy or completeness of the information provided by the contractor.

DATE: 12-10-01

Scale: 1" = 40'
Date: 02/14/01
Designed By: RB
Checked By: FEU
Project No.: 32001P15.DWG

PAVING PLAN & PROFILE
LOCKHART DR.
LOFLAND FARMS, PHASE 2

THESE CONSTRUCTION PLANS WERE PREPARED UNDER THE RESPONSIBLE SUPERVISION OF F.E. MIDDLETON, JR., REGISTERED PROFESSIONAL ENGINEER NO. 87449

W.H. BARD SURVEY, ABSTRACT NO. 25
CITY OF ROCKWALL
ROCKWALL COUNTY, TEXAS

CONTINENTAL HOMES
621 WEST COLLEGE STREET
GRAPEVINE, TEXAS 76051

Winkelmann & Associates, Inc.
CONSULTING CIVIL ENGINEERS & SURVEYORS
4799 Hillwood Road, Suite 100
Dallas, Texas 75230
(972) 462-7039 FAX

APPROV. DATE REVISION