

NOTE:
 1) PAVEMENT FOR STREETS SHALL CONSIST OF 6" 3500 P.S.I. REINFORCED CONCRETE AND 6" LIME-STABILIZED SUBGRADE WITH 6" PARABOLIC CROWN.
 2) PAVEMENT FOR ALLEYS SHALL CONSIST OF MIN. 5" 4000 P.S.I. REINFORCED CONCRETE AND 6" LIME-STABILIZED SUBGRADE WITH 5" INVERT. TYPICAL ALLEY SECTION WILL BE 7'-5"-7'.

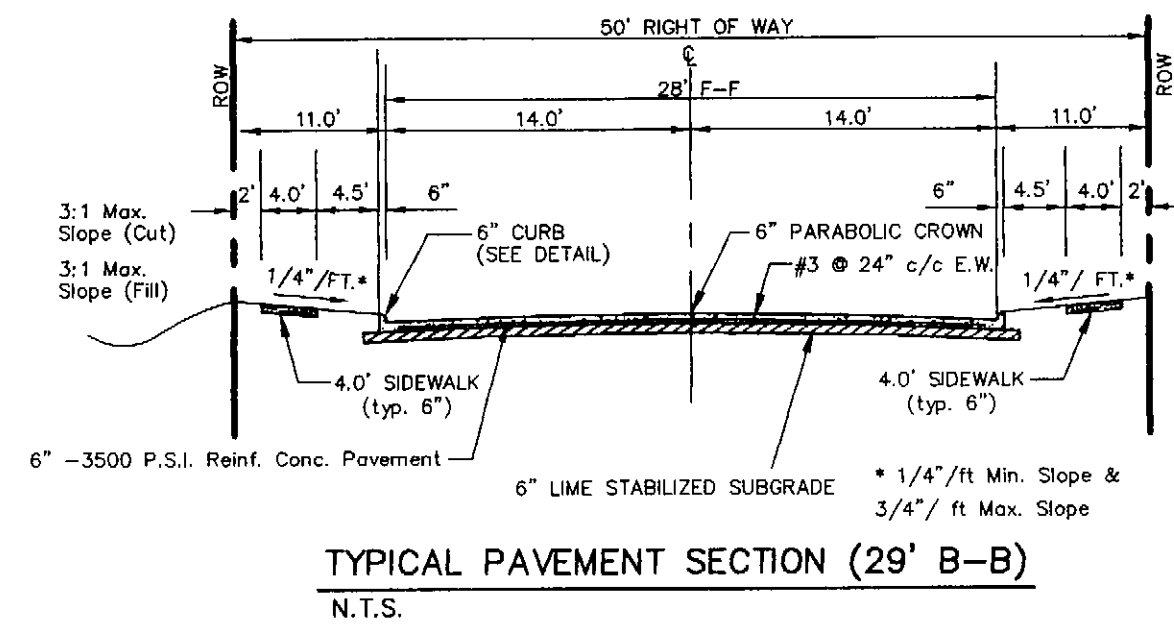

LEGEND

TC	TOP OF CURB
TP	TOP OF PAVEMENT
INV	INVERT
CR	CURB RETURN
FL	FLOW LINE
BFR	BARRIER FREE RAMP
+	STREET STATION
→	FLOW ARROW

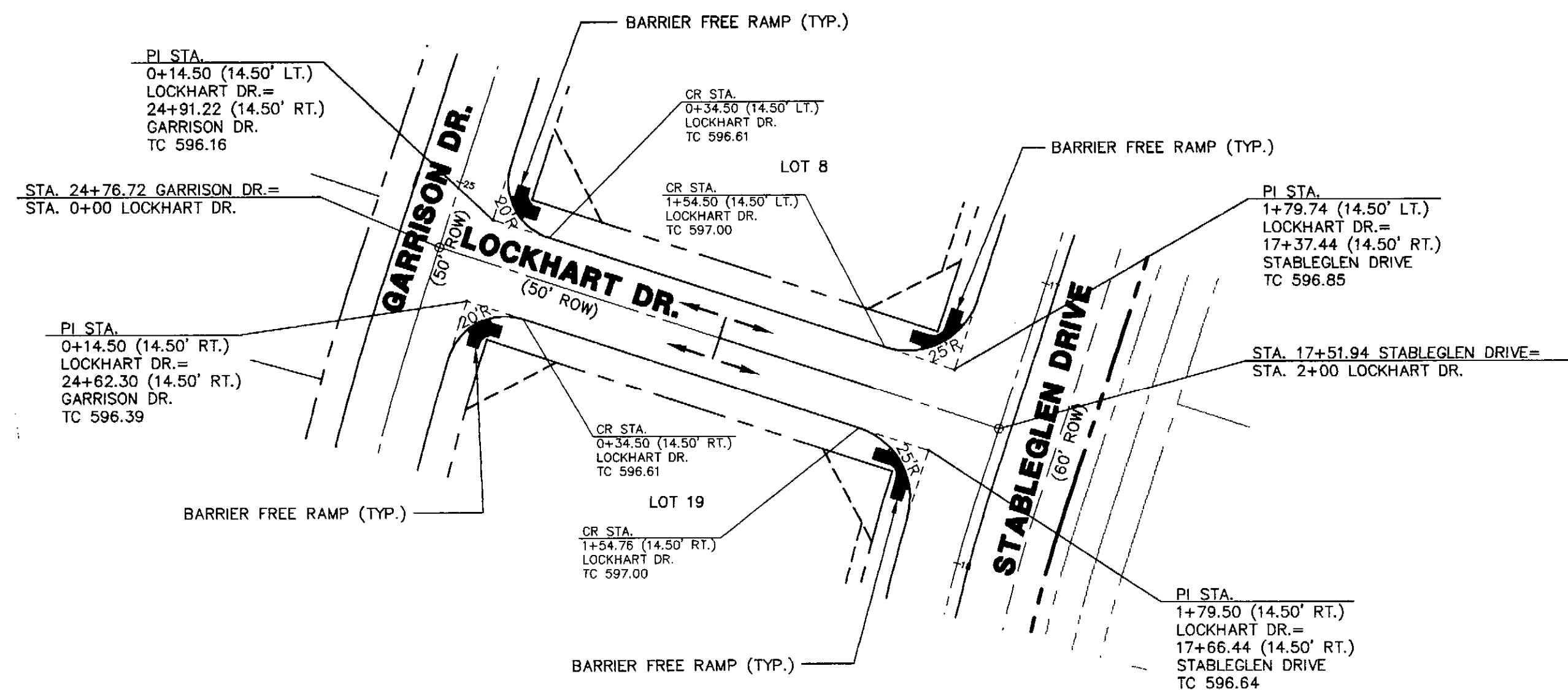
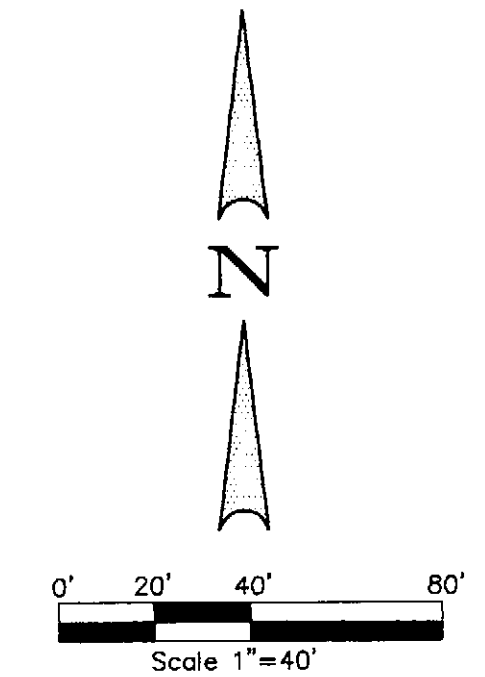

BENCHMARK: ELEV. = 600.69
 CITY OF ROCKWALL R-19
 BRASS MONUMENT AT THE N/W CORNER OF
 SILVERVIEW & DIAMOND WAY, 500' ± SOUTH OF
 S.H. 276.
 BENCHMARK: ELEV. = 583.56
 R.R. SPIKE SET IN THE CENTERLINE OF S.H. 276
 3600± WEST OF F.M. 549

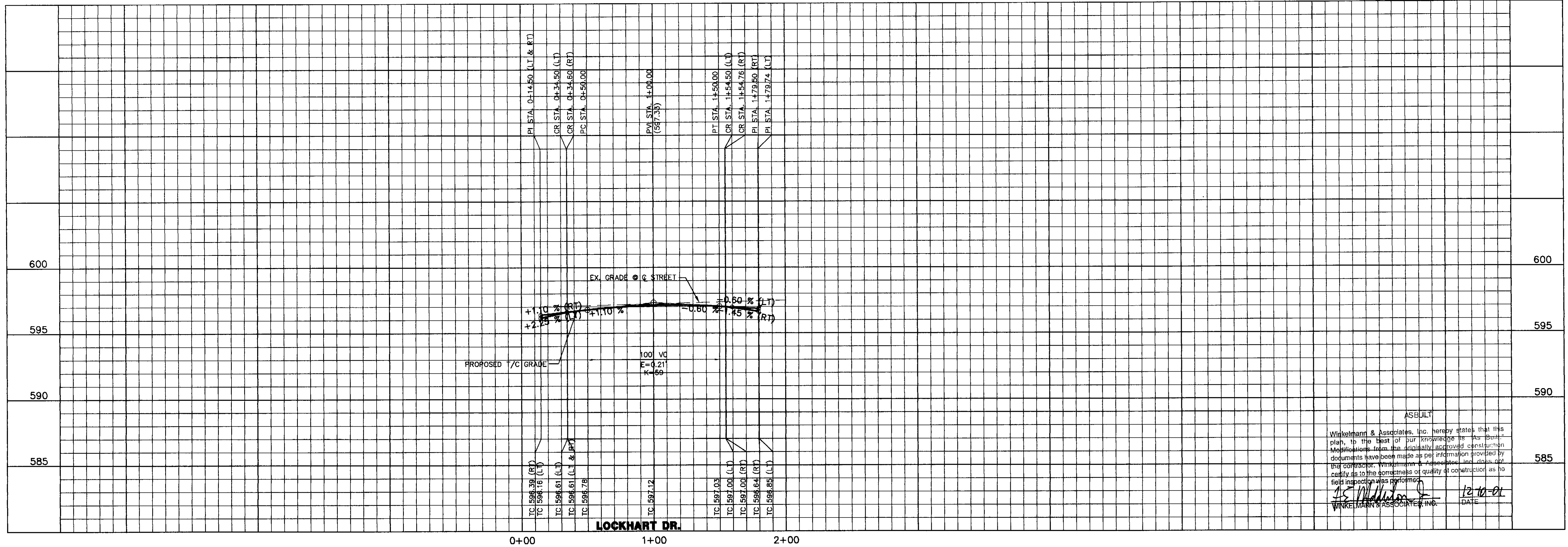

THESE CONSTRUCTION PLANS WERE PREPARED UNDER THE RESPONSIBLE SUPERVISION OF F.E. MIDDLETON, JR., REGISTERED PROFESSIONAL ENGINEER NO. 67449.

THE SEAL APPEARING ON THIS DOCUMENT WAS AUTHORIZED BY F.E. MIDDLETON, JR., P.E. #67449

PAVING PLAN & PROFILE
LOCKHART DR.
LOFLAND FARMS, PHASE 2

Scale: 1" = 40'
 Date: 02/14/01
 Designed By: RB
 Drawn By: DA
 Checked By: FEM
 File: 3200IP15.DWG
 View:
 Project No.: 32001.01

SHEET
 7
 OF
 20

W.H. BAIRD SURVEY, ABSTRACT NO. 25
 CITY OF ROCKWALL
 ROCKWALL COUNTY, TEXAS
 CONTINENTAL HOMES
 621 WEST COLLEGE STREET
 GRAPEVINE, TEXAS 76051

Winkelmann & Associates, Inc.
 CONSULTING CIVIL ENGINEERS & SURVEYORS
 6750 Wilcrest Plaza, Suite 104
 Dallas, Texas 75230
 (972) 462-7929 FAX
 www.winkelmann.com

