

NOTE:
 1) PAVEMENT FOR STREETS SHALL CONSIST OF 6" 3500 P.S.I. REINFORCED CONCRETE AND 6" LIME-STABILIZED SUBGRADE WITH 6" PARABOLIC CROWN.
 2) PAVEMENT FOR ALLEYS SHALL CONSIST OF 4000 P.S.I. REINFORCED CONCRETE AND 6" LIME-STABILIZED SUBGRADE WITH 5" INVERT. TYPICAL ALLEY SECTION WILL BE 7'-5"-7".
 3) CONTRACTOR TO RUN LIME SERIES BEFORE CONSTRUCTION.

LEGEND

TC	TOP OF CURB
CR	CURB RETURN
FL	FLOW LINE
+	STREET STATION
→	FLOW ARROW

Winkelmann & Associates, Inc.
 CONSULTING CIVIL ENGINEERS & SURVEYORS
 8750 Mineral Wells Drive, Suite 100
 Dallas, Texas 75230
 (972) 492-7999 FAX
 www.winkelmanna.com

W.H. BAIRD SURVEY, ABSTRACT NO. 25
 CITY OF ROCKWALL
 ROCKWALL COUNTY, TEXAS
 CONTINENTAL HOMES
 621 WEST COLLEGE STREET
 GRAPEVINE, TEXAS 76051

CURVE TABLE

CURVE	RADIUS	DELTA	TANGENT	LENGTH	CHORD	BEARING
C-1	36.00'	89°34'44"	36.00'	56.55'	50.91'	N 43°59'13" E

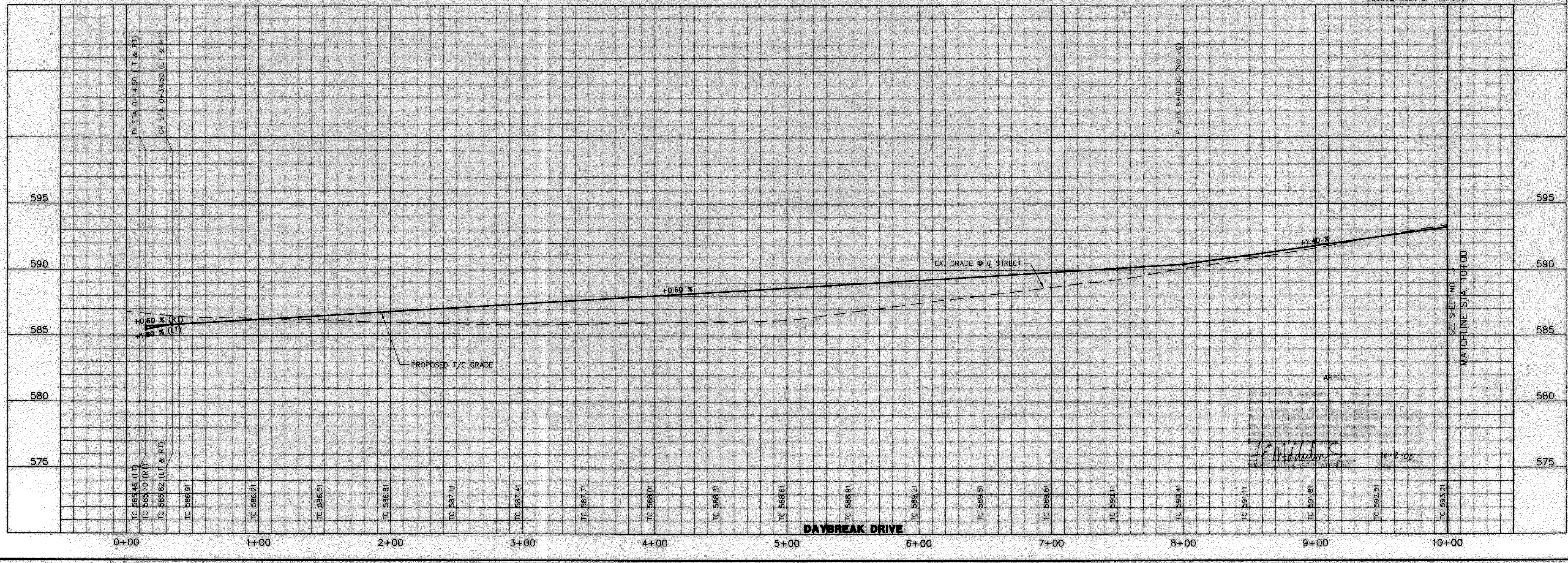

PAVING PLAN & PROFILE DAYBREAK DRIVE
STA. 0+00 TO 10+00
PAVING PLAN ALLEY 1 STA. 0+00 TO 10+50
PAVING PLAN ALLEY 2 STA. 0+00 TO 0+50

Date: 2/9/00
 Designed By: MK
 Drawn By: DA
 Checked By: FEM
 File: 3200PI.DWG View:
 Project No.: 32001.01

SHEET
 2
 OF
 32