

CURVE	RADIUS	DELTA	TANGENT	LENGTH	CHORD	BEARING
C-1	715.00'	06°01'43"	37.65'	75.23'	75.20'	S 86°52'33" E
C-2	715.00'	06°01'44"	37.65'	75.23'	75.20'	N 86°49'16" W
C-3	715.00'	06°12'01"	38.72'	77.37'	77.34'	S 86°02'55" W
C-4	714.90'	06°13'03"	38.83'	77.58'	77.54'	N 83°50'03" E
C-5	715.00'	06°01'46"	37.66'	75.24'	75.21'	S 84°47'27" W
C-6	715.00'	06°01'46"	37.66'	75.24'	75.21'	N 84°47'27" E
C-7	2.75'	131°38'30"	6.12'	6.32'	5.02'	S 23°09'50" W
C-8	2.75'	131°38'30"	6.12'	6.32'	5.02'	N 23°09'50" E

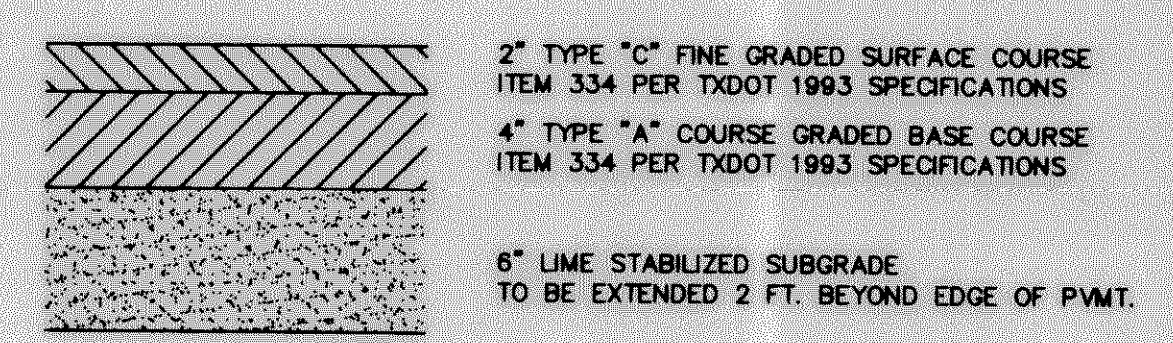

ASPHALT PAVEMENT SECTION

NOTES: ALL BARRICADES, LANE MARKINGS, AND TRAFFIC CONTROL TO BE PER TXDOT SPECIFICATIONS

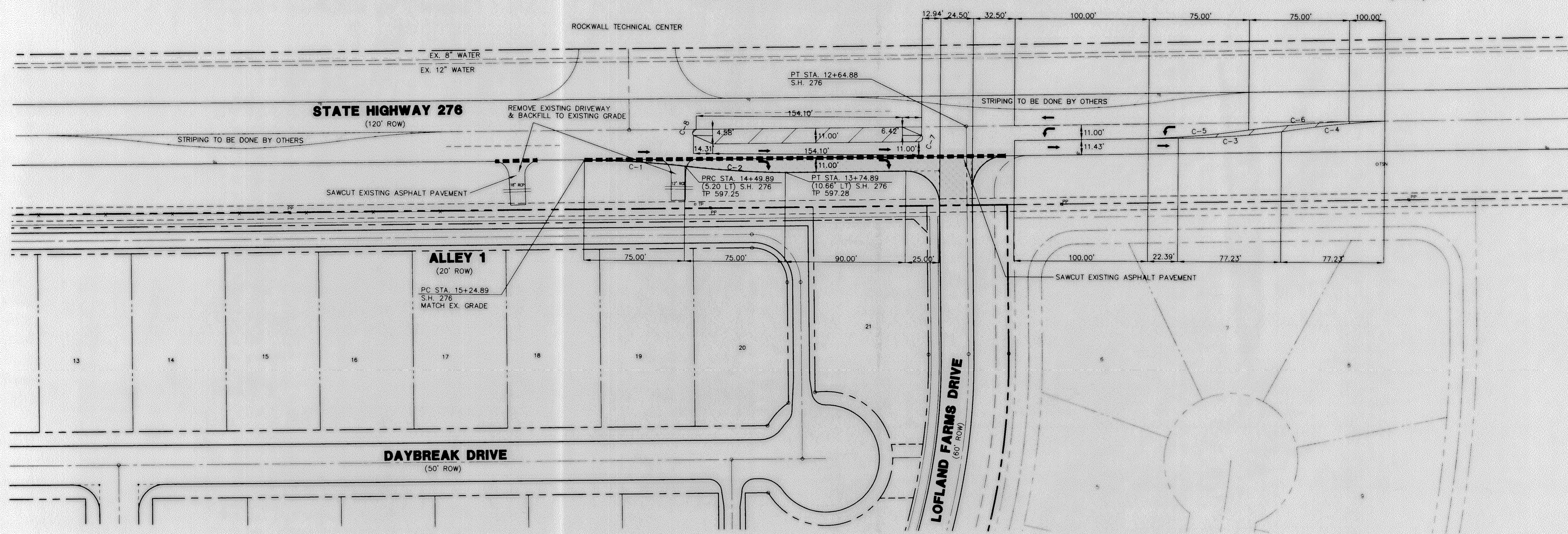
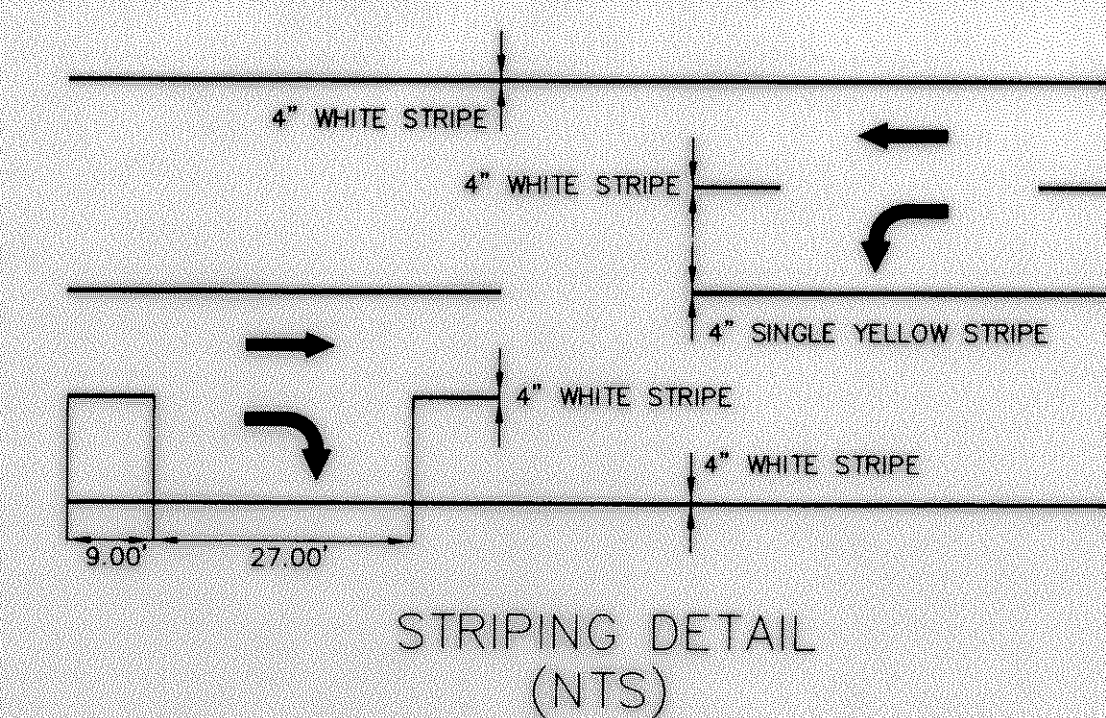
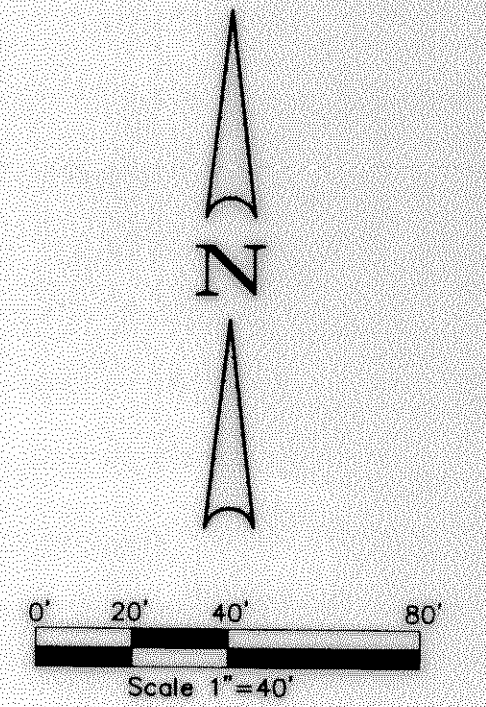
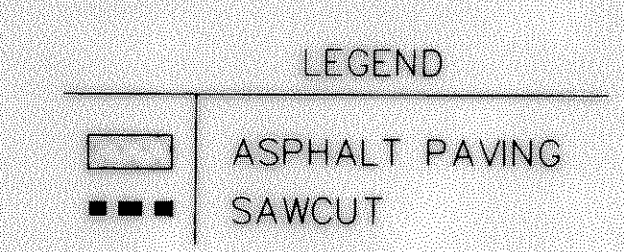

BENCHMARK: ELEV. = 600.69
 CITY OF ROCKWALL R-19
 BRASS MONUMENT AT THE N/W CORNER OF
 SILVERVIEW & DIAMOND WAY, 500' ± SOUTH OF
 S.H. 276.
 BENCHMARK: ELEV. = 583.56
 R.R. SPIKE SET IN THE CENTERLINE OF S.H. 276
 3600± WEST OF F.M. 549

NO.	DATE	REVISION	APPROV.

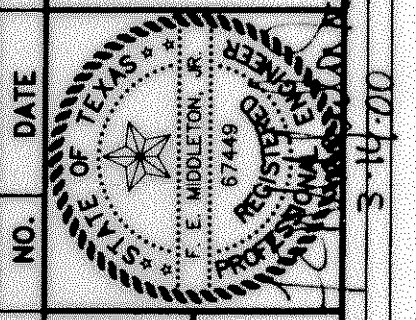

Winkelmann & Associates, Inc.
 CONSULTING CIVIL ENGINEERS & SURVEYORS
 8700 Hillcrest Place, Suite 100
 Dallas, Texas 75230
 (972) 466-7067 FAX
 www.winkelmanna.com

W.H. BAIRD SURVEY, ABSTRACT NO. 25
 CITY OF ROCKWALL
 ROCKWALL COUNTY, TEXAS
 CONTINENTAL HOMES
 621 WEST COLLEGE STREET
 GRAPEVINE, TEXAS 76051

STATE HIGHWAY 276 & LOFLAND FRAMS DRIVE PAVING & STRIPING PLAN

Scale: 1"=40' Date: 2/9/00
 Designed By: DA
 Drawn By: DA
 Checked By: FEM
 File: 3200IP2.DWG View:
 Project No.: 32001.01

SHEET
10B
 OF
32