

- NOTE
- 1) PAVEMENT FOR STREETS SHALL CONSIST OF 6" 3500 P.S.I. REINFORCED CONCRETE AND 6" LIME-STABILIZED SUBGRADE WITH 6" PARABOLIC CROWN.
 - 2) PAVEMENT FOR ALLEYS SHALL CONSIST OF 4000 P.S.I. REINFORCED CONCRETE AND 6" LIME-STABILIZED SUBGRADE WITH 5" INVERT. TYPICAL ALLEY SECTION WILL BE 7'-5" W.
 - 3) CONTRACTOR TO RUN LIME SERIES BEFORE CONSTRUCTION.

LEGEND

TC	TOP OF CURB
CR	CURB RETURN
FL	FLOW LINE
+	STREET STATION
→	FLOW ARROW

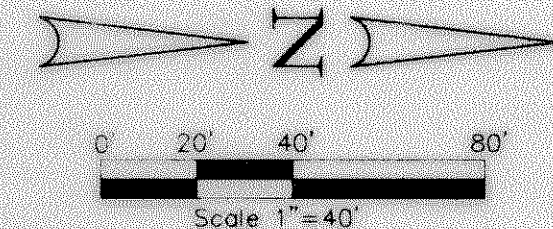

BENCHMARK: ELEV. = 600.69
CITY OF ROCKWALL R-19
BRASS MONUMENT AT THE N/W CORNER OF
SILVERVIEW & DIAMOND WAY, 500' ± SOUTH OF
S.H. 276

BENCHMARK: ELEV. = 583.56
R.R. SPIKE SET IN THE CENTERLINE OF
3600± WEST OF F.M. 549

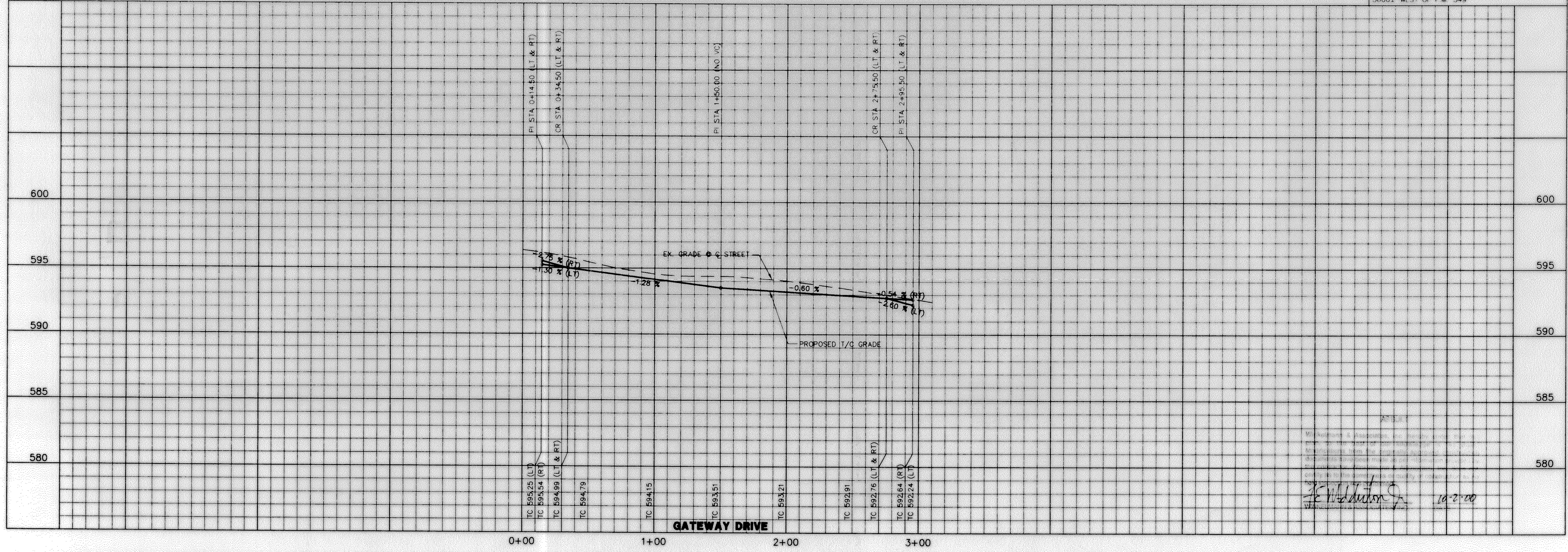

PAVING PLAN & PROFILE
GATEWAY DRIVE
STA. 0+00 TO 3+10.00

Scale: 1" = 40'
 Date: 2/9/00
 Designed By: MK
 Drawn By: DA
 Checked By: FEM
 File: 3200P9.DWG
 View:
 Project No.: 32001.01

SHEET
 10
 OF
 32

W.H. BAIRD SURVEY, ABSTRACT NO. 25
 CITY OF ROCKWALL
 ROCKWALL COUNTY, TEXAS
 CONTINENTAL HOMES
 621 WEST COLLEGE STREET
 GRAPEVINE, TEXAS 76051

Winkelman & Associates, Inc.
 CONSULTING CIVIL ENGINEERS & SURVEYORS
 8750 West Loop, Suite 150
 Dallas, Texas 75240
 (972) 462-2009 FAX
 www.winkelman.com

APPROV. _____
 REVISION _____
 NO. _____ DATE _____