

PLAN OF RECORD

This record drawing is a compilation of the sealed engineering drawing for permit and construction, by others; modified based on a field observation by BIG RED DGS. The information shown on the record drawings that was provided for permit and construction, by others not associated with the record drawing engineer, cannot be verified for accuracy or completeness. Review is for general conformance with construction documents and on-site improvements. The original approved sealed drawings are on file at the offices of the City of Rockwall.

Therefore, with the exceptions noted and clouded, this "Plan of Record" is true and correct to the best of my knowledge and was prepared under my supervision.

[Signature]

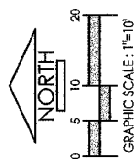
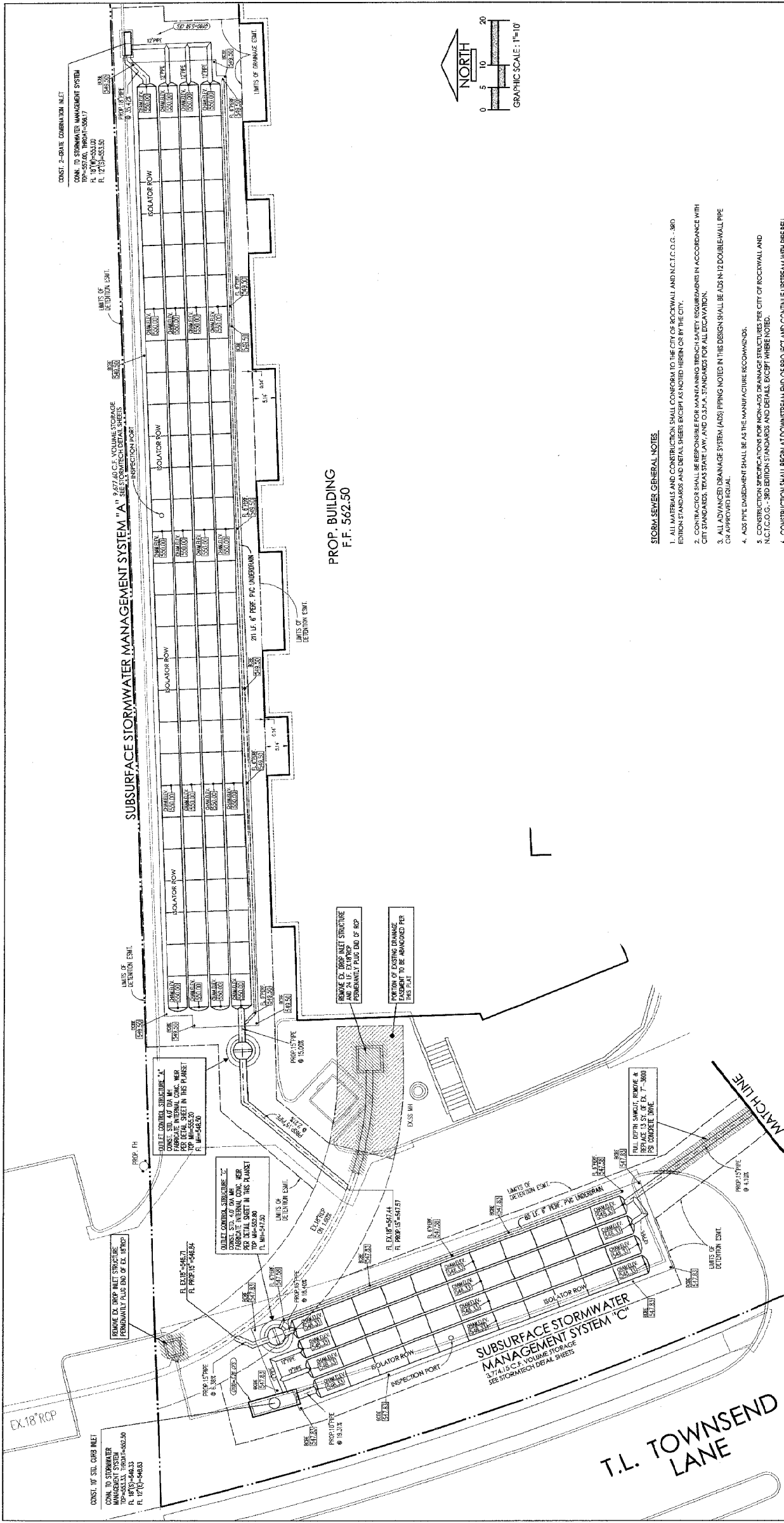

STORM SEWER GENERAL NOTES

1. ALL MATERIALS AND CONSTRUCTION SHALL CONFORM TO THE CITY OF ROCKWALL AND M.C.T.C.O.G. ... 3RD EDITION STANDARDS AND DETAILS EXCEPT AS NOTED HEREIN OR BY THE CITY.
2. CONTRACTOR SHALL BE RESPONSIBLE FOR MAINTAINING TRENCH SAFETY REQUIREMENTS IN ACCORDANCE WITH CITY STANDARDS, TEXAS STATE LAW, AND O.S.H.A. STANDARDS FOR ALL EXCAVATION.
3. ALL ADVANCED DRAINAGE SYSTEM (ADS) PIPING NOTED IN THIS DESIGN SHALL BE ADS N12 DOUBLEWALL PIPE OR APPROVED EQUAL.
4. ADS PIPE DIMENSION SHALL BE AS THE MANUFACTURE RECOMMENDS.
5. CONSTRUCTION SPECIFICATIONS FOR NON-ADS DRAINAGE STRUCTURES PER CITY OF ROCKWALL AND M.C.T.C.O.G. - 3RD EDITION STANDARDS AND DETAILS EXCEPT WHERE NOTED.
6. CONSTRUCTION SHALL BEGIN AT DOWNSTREAM END OF PROJECT AND CONTINUE UPSTREAM WITH PIPE BELL FACING UPSTREAM.
7. REINFORCED CONCRETE PIPE SLOPEMENT SHALL BE AS REQUIRED IN THE CITY OF ROCKWALL AND M.C.T.C.O.G. - 3RD EDITION DETAIL SHEET.
8. CONTRACTOR SHALL PROTECT ALL PUBLIC UTILITIES IN THE CONSTRUCTION OF THIS PROJECT.
9. THE LOCATION OF ALL UTILITIES INDICATED ON THESE PLANS ARE TAKEN FROM EXISTING PUBLIC RECORDS. THE CONTRACTOR MUST DETERMINE THE EXACT LOCATION AND DEPTH OF ALL PUBLIC UTILITIES.
10. IT SHALL BE THE DUTY OF THE CONTRACTOR TO ASCERTAIN WHETHER ANY ADDITIONAL FACILITIES OTHER THAN THOSE SHOWN ON THE PLANS MAY BE PRESENT.
11. IF ROCKS ARE ENCOUNTERED IN THE TRENCH, ROCK SPOIL SHALL NOT BE USED. THE TRENCHES TO BE BACKFILLED ONLY WITH QUALITY TOPSOIL.
12. ALL REINFORCED CONCRETE PIPE WYES AND BENDS TO BE PREPARED BY THE PIPE MANUFACTURER.

LEGEND

STORMTECH SC-740 CHAMBER ELEVATION	REGIONS
BOTTOM OF CHAMBER BASE ELEVATION	DATE
PROPOSED 12\"/>	



SITE BENCHMARK:
 CUTXK ON TOP OF NORTH CURBLINE OF EXISTING CONCRETE DRIVE APPROX. 45 FEET SOUTH OF SOUTH BUILDING WALL OF GALAXY RANCH PRIVATE SCHOOL AND 148 FEET +/- EAST OF EXISTING EAST CURBLINE OF T.L. TOWNSEND LANE.
 ELEVATION = 554.56

CONTRACTOR SHALL CONTACT UNDERGROUND UTILITY LOCATOR SERVICE NO EARLIER THAN 14 DAYS AND LOCATOR PROFILES MUST BE MADE TO ANY EXCAVATION PROCEEDING DEEPER THAN 4 FEET.
 1-800-DIG-TESS

ENGINEER:
 NATHAN D. MAIER CONSULTING ENGINEERS, INC.
 CONTACT: MIE DAMEL (214) 739-4741

SUBSURFACE STORMWATER MANAGEMENT SYSTEM
 LARSEN RETAIL DEVELOPMENT
 3111 TOWNSEND LANE, ROCKWALL, TEXAS 75087

NDM
 NATHAN D. MAIER CONSULTING ENGINEERS, INC.
 3111 TOWNSEND LANE, ROCKWALL, TEXAS 75087
 Dallas, Texas 75221 214-739-4741

DESIGN	SCALE	DATE	REVISION

SHEET NO. **7** OF **16**

DATE: 08-14-2018

S-C-17