

**PLAN OF RECORD**

This record drawing is a compilation of the sealed engineering drawing for permit and construction, by others; modified based on a field observation by BIG RED DOG. The information shown on the record drawings that was provided for permit and construction, by others not associated with the record drawing engineer, cannot be verified for accuracy or completeness. Review is for general conformance with construction documents and on-site improvements. The original approved sealed drawings are on file at the offices of the City of Rockwall.

Therefore, with the exceptions noted and clouded, this "Plan of Record" is true and correct to the best of my knowledge and was prepared under my supervision.

*[Signature]*

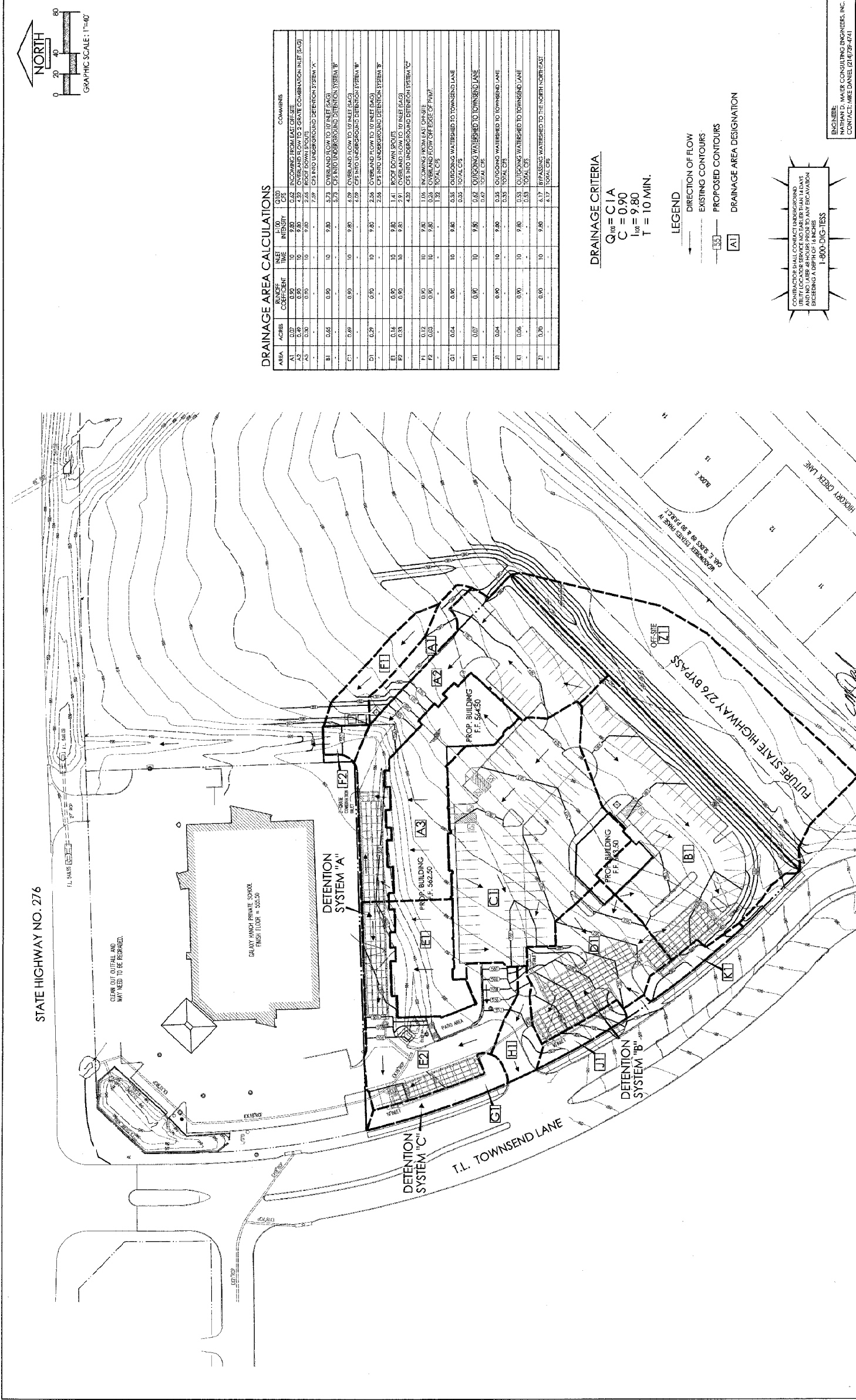

**DRAINAGE AREA CALCULATIONS**

AREA	ACREAGE	COEFFICIENT	TIME TO TRAVEL TO INLET (MIN)	INLET ELEVATION (FT)	COMMENTS
A1	0.07	0.90	10	528.0	INCOMING FLOW TO EAST OFF-SE
A2	0.49	0.90	10	528.0	OVERLAND FLOW TO 2 GRAVE COMBINATION INLET (S&S)
A3	0.30	0.90	10	528.0	OVERLAND FLOW TO 2 GRAVE COMBINATION INLET (S&S)
B1	0.05	0.90	10	528.0	OVERLAND FLOW TO 10 INLET BAGS
B2	0.05	0.90	10	528.0	OVERLAND FLOW TO 10 INLET BAGS
B3	0.05	0.90	10	528.0	OVERLAND FLOW TO 10 INLET BAGS
B4	0.05	0.90	10	528.0	OVERLAND FLOW TO 10 INLET BAGS
B5	0.05	0.90	10	528.0	OVERLAND FLOW TO 10 INLET BAGS
B6	0.05	0.90	10	528.0	OVERLAND FLOW TO 10 INLET BAGS
B7	0.05	0.90	10	528.0	OVERLAND FLOW TO 10 INLET BAGS
B8	0.05	0.90	10	528.0	OVERLAND FLOW TO 10 INLET BAGS
B9	0.05	0.90	10	528.0	OVERLAND FLOW TO 10 INLET BAGS
B10	0.05	0.90	10	528.0	OVERLAND FLOW TO 10 INLET BAGS
B11	0.05	0.90	10	528.0	OVERLAND FLOW TO 10 INLET BAGS
B12	0.05	0.90	10	528.0	OVERLAND FLOW TO 10 INLET BAGS
B13	0.05	0.90	10	528.0	OVERLAND FLOW TO 10 INLET BAGS
B14	0.05	0.90	10	528.0	OVERLAND FLOW TO 10 INLET BAGS
B15	0.05	0.90	10	528.0	OVERLAND FLOW TO 10 INLET BAGS
B16	0.05	0.90	10	528.0	OVERLAND FLOW TO 10 INLET BAGS
B17	0.05	0.90	10	528.0	OVERLAND FLOW TO 10 INLET BAGS
B18	0.05	0.90	10	528.0	OVERLAND FLOW TO 10 INLET BAGS
B19	0.05	0.90	10	528.0	OVERLAND FLOW TO 10 INLET BAGS
B20	0.05	0.90	10	528.0	OVERLAND FLOW TO 10 INLET BAGS
B21	0.05	0.90	10	528.0	OVERLAND FLOW TO 10 INLET BAGS
B22	0.05	0.90	10	528.0	OVERLAND FLOW TO 10 INLET BAGS
B23	0.05	0.90	10	528.0	OVERLAND FLOW TO 10 INLET BAGS
B24	0.05	0.90	10	528.0	OVERLAND FLOW TO 10 INLET BAGS
B25	0.05	0.90	10	528.0	OVERLAND FLOW TO 10 INLET BAGS
B26	0.05	0.90	10	528.0	OVERLAND FLOW TO 10 INLET BAGS
B27	0.05	0.90	10	528.0	OVERLAND FLOW TO 10 INLET BAGS
B28	0.05	0.90	10	528.0	OVERLAND FLOW TO 10 INLET BAGS
B29	0.05	0.90	10	528.0	OVERLAND FLOW TO 10 INLET BAGS
B30	0.05	0.90	10	528.0	OVERLAND FLOW TO 10 INLET BAGS
B31	0.05	0.90	10	528.0	OVERLAND FLOW TO 10 INLET BAGS
B32	0.05	0.90	10	528.0	OVERLAND FLOW TO 10 INLET BAGS
B33	0.05	0.90	10	528.0	OVERLAND FLOW TO 10 INLET BAGS
B34	0.05	0.90	10	528.0	OVERLAND FLOW TO 10 INLET BAGS
B35	0.05	0.90	10	528.0	OVERLAND FLOW TO 10 INLET BAGS
B36	0.05	0.90	10	528.0	OVERLAND FLOW TO 10 INLET BAGS
B37	0.05	0.90	10	528.0	OVERLAND FLOW TO 10 INLET BAGS
B38	0.05	0.90	10	528.0	OVERLAND FLOW TO 10 INLET BAGS
B39	0.05	0.90	10	528.0	OVERLAND FLOW TO 10 INLET BAGS
B40	0.05	0.90	10	528.0	OVERLAND FLOW TO 10 INLET BAGS
B41	0.05	0.90	10	528.0	OVERLAND FLOW TO 10 INLET BAGS
B42	0.05	0.90	10	528.0	OVERLAND FLOW TO 10 INLET BAGS
B43	0.05	0.90	10	528.0	OVERLAND FLOW TO 10 INLET BAGS
B44	0.05	0.90	10	528.0	OVERLAND FLOW TO 10 INLET BAGS
B45	0.05	0.90	10	528.0	OVERLAND FLOW TO 10 INLET BAGS
B46	0.05	0.90	10	528.0	OVERLAND FLOW TO 10 INLET BAGS
B47	0.05	0.90	10	528.0	OVERLAND FLOW TO 10 INLET BAGS
B48	0.05	0.90	10	528.0	OVERLAND FLOW TO 10 INLET BAGS
B49	0.05	0.90	10	528.0	OVERLAND FLOW TO 10 INLET BAGS
B50	0.05	0.90	10	528.0	OVERLAND FLOW TO 10 INLET BAGS
B51	0.05	0.90	10	528.0	OVERLAND FLOW TO 10 INLET BAGS
B52	0.05	0.90	10	528.0	OVERLAND FLOW TO 10 INLET BAGS
B53	0.05	0.90	10	528.0	OVERLAND FLOW TO 10 INLET BAGS
B54	0.05	0.90	10	528.0	OVERLAND FLOW TO 10 INLET BAGS
B55	0.05	0.90	10	528.0	OVERLAND FLOW TO 10 INLET BAGS
B56	0.05	0.90	10	528.0	OVERLAND FLOW TO 10 INLET BAGS
B57	0.05	0.90	10	528.0	OVERLAND FLOW TO 10 INLET BAGS
B58	0.05	0.90	10	528.0	OVERLAND FLOW TO 10 INLET BAGS
B59	0.05	0.90	10	528.0	OVERLAND FLOW TO 10 INLET BAGS
B60	0.05	0.90	10	528.0	OVERLAND FLOW TO 10 INLET BAGS
B61	0.05	0.90	10	528.0	OVERLAND FLOW TO 10 INLET BAGS
B62	0.05	0.90	10	528.0	OVERLAND FLOW TO 10 INLET BAGS
B63	0.05	0.90	10	528.0	OVERLAND FLOW TO 10 INLET BAGS
B64	0.05	0.90	10	528.0	OVERLAND FLOW TO 10 INLET BAGS
B65	0.05	0.90	10	528.0	OVERLAND FLOW TO 10 INLET BAGS
B66	0.05	0.90	10	528.0	OVERLAND FLOW TO 10 INLET BAGS
B67	0.05	0.90	10	528.0	OVERLAND FLOW TO 10 INLET BAGS
B68	0.05	0.90	10	528.0	OVERLAND FLOW TO 10 INLET BAGS
B69	0.05	0.90	10	528.0	OVERLAND FLOW TO 10 INLET BAGS
B70	0.05	0.90	10	528.0	OVERLAND FLOW TO 10 INLET BAGS
B71	0.05	0.90	10	528.0	OVERLAND FLOW TO 10 INLET BAGS
B72	0.05	0.90	10	528.0	OVERLAND FLOW TO 10 INLET BAGS
B73	0.05	0.90	10	528.0	OVERLAND FLOW TO 10 INLET BAGS
B74	0.05	0.90	10	528.0	OVERLAND FLOW TO 10 INLET BAGS
B75	0.05	0.90	10	528.0	OVERLAND FLOW TO 10 INLET BAGS
B76	0.05	0.90	10	528.0	OVERLAND FLOW TO 10 INLET BAGS
B77	0.05	0.90	10	528.0	OVERLAND FLOW TO 10 INLET BAGS
B78	0.05	0.90	10	528.0	OVERLAND FLOW TO 10 INLET BAGS
B79	0.05	0.90	10	528.0	OVERLAND FLOW TO 10 INLET BAGS
B80	0.05	0.90	10	528.0	OVERLAND FLOW TO 10 INLET BAGS
B81	0.05	0.90	10	528.0	OVERLAND FLOW TO 10 INLET BAGS
B82	0.05	0.90	10	528.0	OVERLAND FLOW TO 10 INLET BAGS
B83	0.05	0.90	10	528.0	OVERLAND FLOW TO 10 INLET BAGS
B84	0.05	0.90	10	528.0	OVERLAND FLOW TO 10 INLET BAGS
B85	0.05	0.90	10	528.0	OVERLAND FLOW TO 10 INLET BAGS
B86	0.05	0.90	10	528.0	OVERLAND FLOW TO 10 INLET BAGS
B87	0.05	0.90	10	528.0	OVERLAND FLOW TO 10 INLET BAGS
B88	0.05	0.90	10	528.0	OVERLAND FLOW TO 10 INLET BAGS
B89	0.05	0.90	10	528.0	OVERLAND FLOW TO 10 INLET BAGS
B90	0.05	0.90	10	528.0	OVERLAND FLOW TO 10 INLET BAGS
B91	0.05	0.90	10	528.0	OVERLAND FLOW TO 10 INLET BAGS
B92	0.05	0.90	10	528.0	OVERLAND FLOW TO 10 INLET BAGS
B93	0.05	0.90	10	528.0	OVERLAND FLOW TO 10 INLET BAGS
B94	0.05	0.90	10	528.0	OVERLAND FLOW TO 10 INLET BAGS
B95	0.05	0.90	10	528.0	OVERLAND FLOW TO 10 INLET BAGS
B96	0.05	0.90	10	528.0	OVERLAND FLOW TO 10 INLET BAGS
B97	0.05	0.90	10	528.0	OVERLAND FLOW TO 10 INLET BAGS
B98	0.05	0.90	10	528.0	OVERLAND FLOW TO 10 INLET BAGS
B99	0.05	0.90	10	528.0	OVERLAND FLOW TO 10 INLET BAGS
B100	0.05	0.90	10	528.0	OVERLAND FLOW TO 10 INLET BAGS

**DRAINAGE CRITERIA**  
 $Q_{10} = C I A$   
 $C = 0.90$   
 $I_{10} = 9.80$   
 $T = 10 \text{ MIN.}$

**LEGEND**  
 - - - DIRECTION OF FLOW  
 - - - EXISTING CONTOURS  
 - - - PROPOSED CONTOURS  
 [A1] DRAINAGE AREA DESIGNATION

CONTRACTOR SHALL CONTACT UNDERGROUND UTILITY LOCATOR SERVICE NO EARLIER THAN 14 DAYS BEFORE ANY EXCAVATION EXCEEDING A DEPTH OF 18 INCHES  
 1-800-DIG-TESS

**DRAINAGE AREA MAP**  
 LARSEN RETAIL DEVELOPMENT  
 3000 PLYMOUTH LANE  
 ROCKWALL, TEXAS 75087

ENGINEER: NATHAN D. MAIER CONSULTING ENGINEERS, INC.  
 NATHAN D. MAIER  
 CONTACT: WEE DANIEL (214) 239-4741

SHEET NO. 6 OF 16  
 DATE: 2011.04.05  
 SCALE: 1"=40'

**NDM**  
 NATHAN D. MAIER  
 CONSULTING ENGINEERS, INC.  
 3000 PLYMOUTH LANE  
 ROCKWALL, TEXAS 75087

Two Northpark, 8000 Plymouth Lane, Suite 600  
 Dallas, Texas 75231 214-239-4741

REVISIONS	DATE

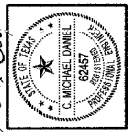

**SITE BENCHMARK:**  
 CITY OF ROCKWALL  
 DRIVE APPROX. 45 FEET SOUTH OF SOUTH BUILDING WALL OF GALAXY RANCH PRIVATE SCHOOL AND 148 FEET +/- EAST OF EXISTING EAST CURBLINE OF T.L. TOWNSEND LANE  
 ELEVATION = 554.56

5-2-11