

BENCHMARK:
BRASS CAP MONUMENT NO. 10 SET IN
CONCRETE IN THE CENTER OF GRASS
MEDIAN IN MASTERS DRIVE BETWEEN
NORTH LAKESHORE & SHORES BLVD.
N 7032464.6317, E 2589554.1518
ELEV. = 524.62

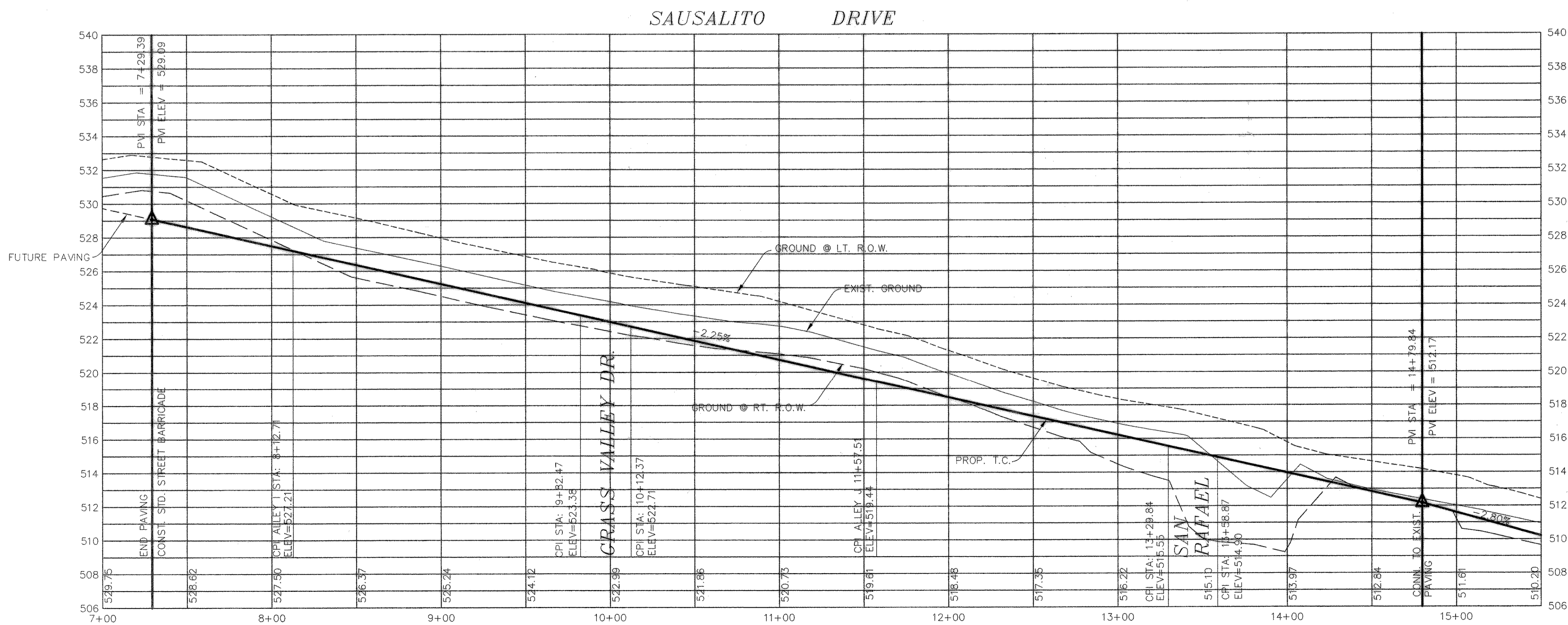

RECORD DRAWINGS:
THE INTENT OF THE OWNER AND ENGINEER
WAS TO CONSTRUCT THESE FACILITIES
ACCORDING TO THESE PLANS AS APPROVED BY
THE CITY OF ROCKWALL. THE LINES
AND GRADES WERE SET ON THE GROUND FOR
CONSTRUCTION ACCORDING TO SAID PLANS.
THE CITY OF ROCKWALL INSPECTED
THE CONSTRUCTION. THE OWNER NOR
ENGINEER DID NOT VERIFY LINES OR GRADES
AFTER CONSTRUCTION. WE ARE NOT AWARE
OF ANY CHANGES OR REVISIONS TO THESE
PLANS DURING CONSTRUCTION EXCEPT AS
NOTED 4/16/00.

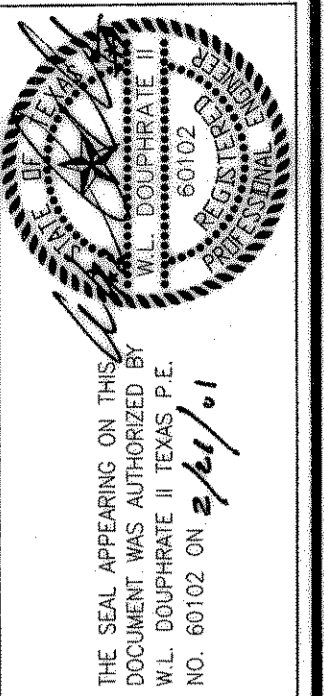

DOUPHRADE & ASSOCIATES, INC.
ENGINEERING - PROJECT MANAGEMENT - SURVEYING
2235 RIDGE RD., # 200 ROCKWALL, TEXAS 75087
PHONE: (972)771-9004 FAX: (972)771-9005

PAVING PLAN & PROFILE
SAUSALITO DR. STA. 7+29.39 TO 14+79.84
LAKEVIEW SUMMIT PHASE 1A
CITY OF ROCKWALL, COUNTY OF ROCKWALL

REVISION	W.L.D. CHECKED
	K.E.B. DRAWN
	8/14/00 DATE
	9919-1APV5 PROJECT
	15 OF