

BENCHMARK:
BRASS CAP MONUMENT NO. 10 SET IN
CONCRETE IN THE CENTER OF GRASS
MEDIAN IN MASTERS DRIVE BETWEEN
NORTH LAKESHORE & SHORES BLVD.
N 7032464.6317, E 2589554.1518
ELEV. = 524.62

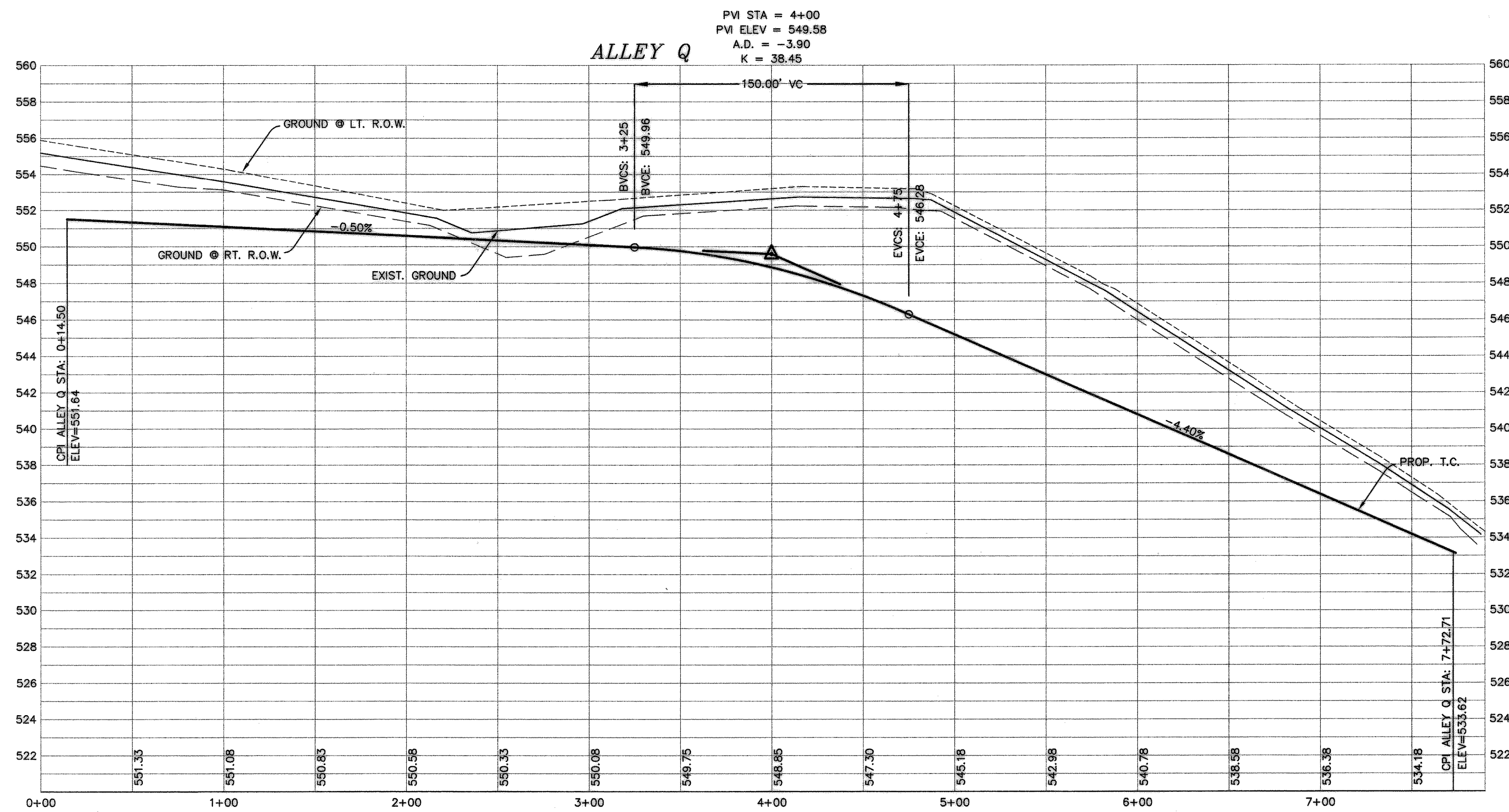

RECORD DRAWINGS:
THE INTENT OF THE OWNER AND ENGINEER WAS TO CONSTRUCT THESE FACILITIES ACCORDING TO THESE PLANS AS APPROVED BY THE CITY OF ROCKWALL. THE LINES AND GRADES WERE SET ON THE GROUND FOR CONSTRUCTION ACCORDING TO SAID PLANS. THE CITY OF ROCKWALL INSPECTED THE CONSTRUCTION. THE OWNER NOR ENGINEER DID NOT VERIFY LINES OR GRADES AFTER CONSTRUCTION. WE ARE NOT AWARE OF ANY CHANGES OR REVISIONS TO THESE PLANS DURING CONSTRUCTION EXCEPT AS NOTED 4/18/02

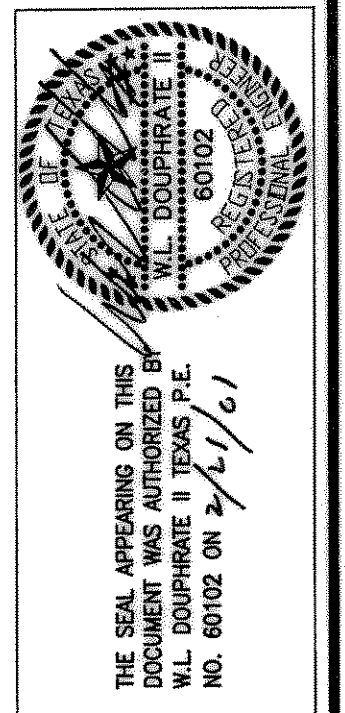

DOUPHRATE & ASSOCIATES, INC.
CONSULTING - PROJECT MANAGEMENT - SURVEYING
2836 RIDGE RD., # 200 ROCKWALL, TEXAS 75087
PHONE: (972)771-9004 FAX: (972)771-9005

PAVING PLAN & PROFILE
ALLEY Q
LAKEVIEW SUMMIT PHASE 1A
CITY OF ROCKWALL, COUNTY OF ROCKWALL

REVISION
W.L.D. CHECKED
K.E.B. DRAWN
8/14/00 DATE
9919-1APV18 PROJECT