

SANITARY SEWER LINE G

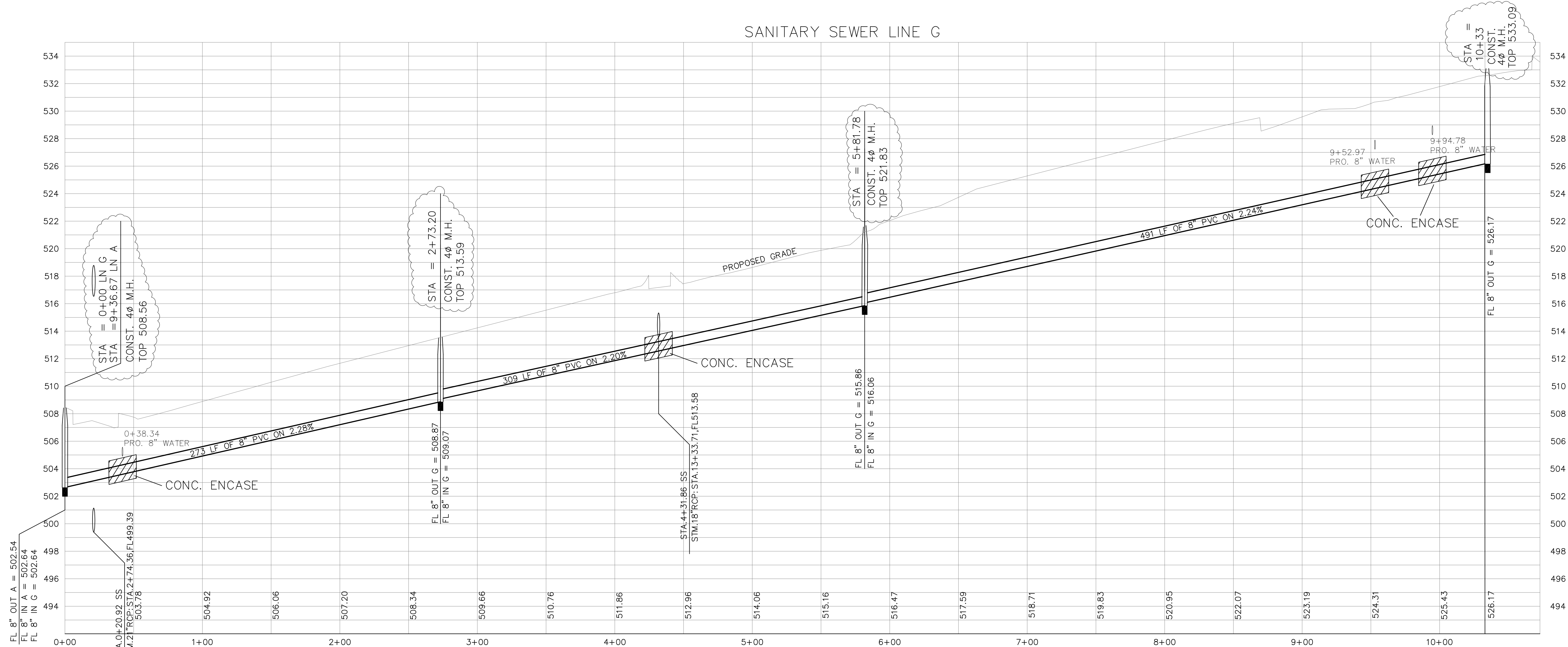

SANITARY SEWER LINE H

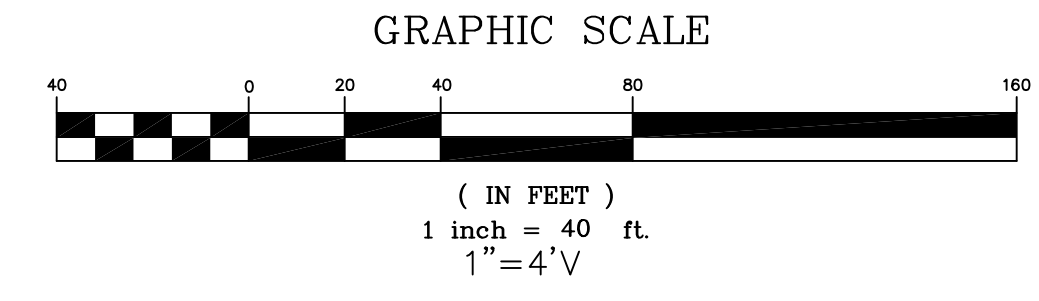
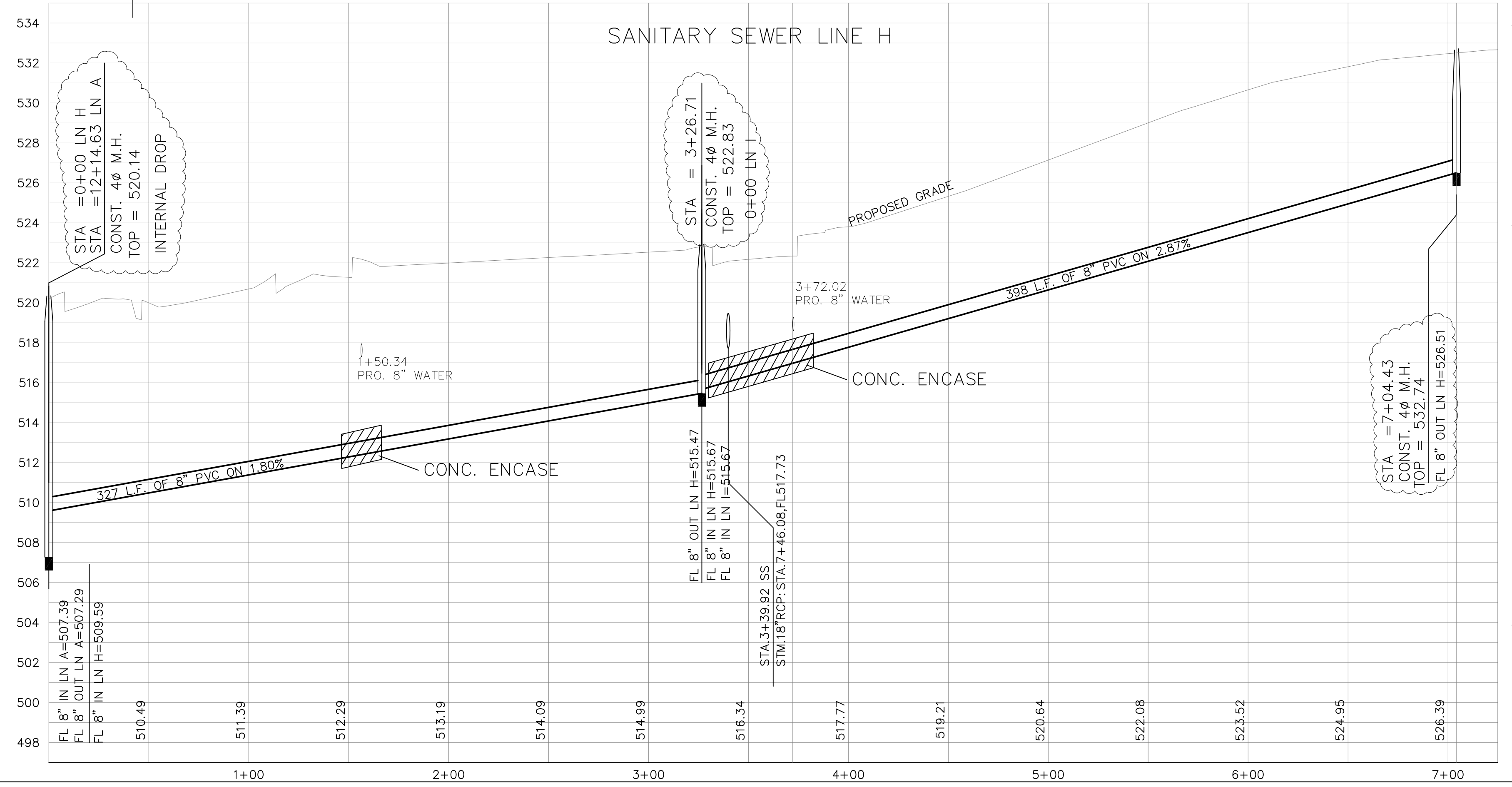

NOTE:
 PROPOSED GRADE LINE AT PAVEMENT
 CROSSINGS DEPICTS PAVING SUBGRADE.

- REVISIONS:
 1. 4-19-15 SHORTENED LINE G 40.03'
 2. 4-24-15 SHORTENED LINE H 20.50'
 3. 9-24-15 REVISED TOP ELAVATIONS

LEGEND

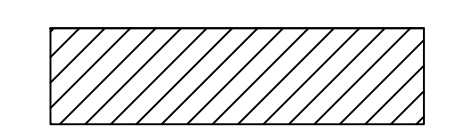

CONCRETE ENCASEMENT

BENCHMARKS:
 BRASS CAP MONUMENT NO. 10 SET IN
 CONCRETE IN THE CENTER OF GRASS
 MEDIAN IN MASTERS DRIVE BETWEEN
 NORTH LAKESHORE & SHORES BLVD.
 N 7032464.6317, E 2589554.1518
 ELEV. = 524.62



THE SEAL APPEARING ON THIS
 DOCUMENT WAS AUTHORIZED BY
 W.L. DOUPHRATE II
 STATE OF TEXAS
 NO. 60102
 DATE: OCT. 3, 2014

DOUPHRATE & ASSOCIATES, INC.
 ENGINEERING - PROJECT MANAGEMENT - SURVEYING
 2235 RIDGE RD., # 200 ROCKWALL, TEXAS 75087
 PHONE: (972)771-9004 FAX: (972)771-9005

SANITARY SEWER PROFILE
 LINE G - LINE H
 LAKEVIEW SUMMIT, PHASE 4
 CITY OF ROCKWALL, ROCKWALL COUNTY, TEXAS

REVISION
W.L.D. CHECKED
K.E.B. DRAWN
10/14 DATE
9919-4SS4 PROJECT
10.4 OF