

STA = 5+57.01 LN E  
 STA = 5+52.81 LN B  
 CONST. 4ø M.H.  
 TOP 486.18

SANITARY SEWER LINE E FORCE MAIN

0+24.40, 3' LT.  
 CONNECT TO PROPOSED LIFT STATION

2" FORCE MAIN ON 0.66%

PVI STA = 1+75.67  
 PVI ELEV = 465.00

PROPOSED GRADE

2" FORCE MAIN ON 3.79%

FL 8" OUT = 479.43 LN B  
 FL 2" IN = 479.51 LN E

464.00 464.17 464.50 464.83 465.92 467.82 469.71 471.60 473.50 475.39 477.29 479.18

**BENCHMARKS:**  
 BRASS CAP MONUMENT NO. 10 SET IN CONCRETE IN THE CENTER OF GRASS MEDIAN IN MASTERS DRIVE BETWEEN NORTH LAKESHORE & SHORES BLVD.  
 N 7032464.6317, E 2589554.1518  
 ELEV. = 524.62

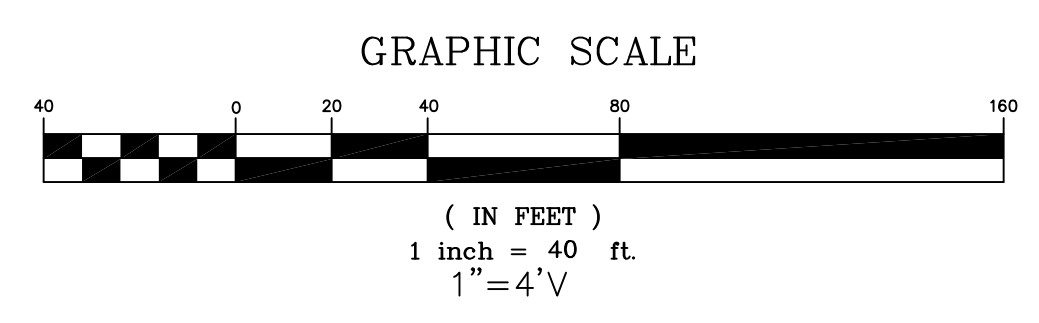

DOUPHRATE & ASSOCIATES, INC.  
 ENGINEERING + PROJECT MANAGEMENT + SURVEYING  
 2235 RIDGE RD., # 200 ROCKWALL, TEXAS 75087  
 PHONE: (972)771-9004 FAX: (972)771-9005

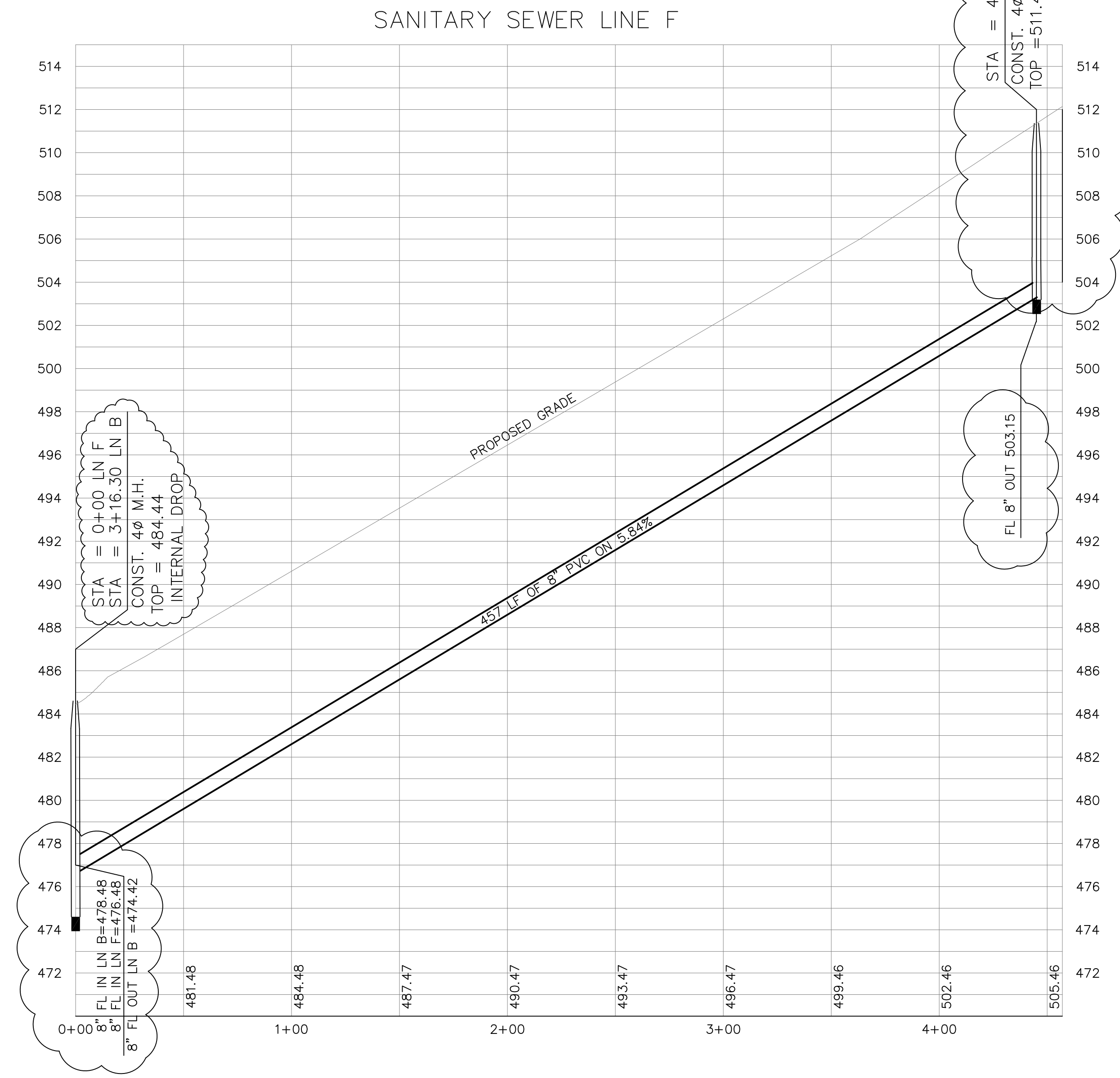

STA = 0+00 LN F  
 STA = 3+16.30 LN B  
 CONST. 4ø M.H.  
 TOP = 484.44  
 INTERNAL DROP

SANITARY SEWER LINE F

8" FL IN LN B = 476.48  
 8" FL IN LN F = 476.48  
 8" FL OUT LN B = 474.42

481.48 484.48 487.47 490.47 493.47 496.47 499.46 502.46 505.46

PROPOSED GRADE

4.57" LF OF 8" PVC ON 3.84%

FL 8" OUT 503.15

STA = 4+44.88  
 CONST. 4ø M.H.  
 TOP = 511.40

NOTE:  
 PROPOSED GRADE LINE AT PAVEMENT CROSSINGS DEPICTS PAVING SUBGRADE.

- REVISIONS:
- 9-23-15 SHORTENED LINE F
  - 12-17 M.H. STA 4+57.05 CHANGED TO STA 4+44.88
  - CHANGED RIM ELEV TO 511.6
  - CHANGED FL ELEV OUT TO 505.15
  - 9-24-15 REVISED TOP ELEVATIONS
  - 10-26-15 LOWERED LINE F 2 FT

SANITARY SEWER PROFILE  
 LINE E - LINE F  
 LAKEVIEW SUMMIT, PHASE 4  
 CITY OF ROCKWALL, ROCKWALL COUNTY, TEXAS

REVISION
W.L.D. CHECKED
K.E.B. DRAWN
10/14 DATE
9919-4SS3 PROJECT
10.3 OF