

PHASE ONE
CABINET D, SLIDE 9
P.R.R.C.T.

GENERAL TRAIL PAVING NOTES

1. THE LAYOUT OF ALL PROPOSED PAVING SHALL BE THE RESPONSIBILITY OF THE CONTRACTOR AND SHALL BE REVIEWED BY THE OWNER'S REPRESENTATIVE PRIOR TO CONSTRUCTION.
2. ALL PAVING CONSTRUCTION SHALL BE IN ACCORDANCE WITH THE CONSTRUCTION DETAILS SHOWN HEREIN.
3. THE SUB GRADE BENEATH ALL PAVING SHALL BE COMPACTED TO 95% STANDARD PROCTOR DENSITY.
4. THE EDGES OF ALL FINISHED TRAIL PAVING SHALL BE SMOOTH, GRACEFUL, CURVILINEAR OR STRAIGHT FORMS WITH NO INTERRUPTIONS SUCH AS CHORDS, WAVES, JOGS, OR MISSED TANGENTS. ANY PAVEMENT WITH SUCH INTERRUPTIONS SHALL BE SUBJECT TO REPLACEMENT AT NO COST TO THE OWNER.
5. ALL CONCRETE FOR TRAILS SHALL HAVE A MINIMUM COMPRESSIVE STRENGTH OF 4,000 PSI @ 28 DAYS, AND SHALL HAVE A MEDIUM BROOM FINISH.
6. CONCRETE SHALL NOT BE POURED UNTIL THE OWNER'S OR CITY'S REPRESENTATIVE HAS INSPECTED THE FORMS AND REINFORCING. THE CONTRACTOR SHALL NOTIFY THE PROJECT MANAGER AT LEAST 48 HOURS IN ADVANCE OF ALL CONCRETE POURS.
7. PROVIDE AN UNDERCUT HEADER WHEREVER PROPOSED CONCRETE PAVING IS TO ABUT EXISTING CONCRETE PAVING.
8. TRAIL / SIDEWALK SHALL BE IN ACCORDANCE WITH TEXAS ACCESSIBILITY STANDARDS (TAS) AND ADA REQUIREMENTS.
9. TRAIL / SIDEWALK SLOPE TO BE MAX 5% LONGITUDINAL AND MAX 2% CROSS SLOPE.

GENERAL NOTES:

1. TRAIL PAVING TO HAVE A MAX 2% CROSS SLOPE.
2. THE MATERIALS AND WORKMANSHIP FOR CONCRETE PAVING SHALL BE IN ACCORDANCE WITH M.C.T.C.D. SPECIFICATIONS OR AS MODIFIED BY CITY STANDARD CONSTRUCTION DETAILS FOR PUBLIC IMPROVEMENTS.

CONSTRUCTION NOTES:

- A. 4,000 PSI CONCRETE TRAIL (MIN. 6.5 SACK MIX)
- B. HEAVY BROOM FINISH
- C. AREA OF FORMING AS NOTED AND SHOWN ON THE PLANS
- D. FINISH GRADE
- E. #3 BARS 18" O.C. MAX. BOTH WAYS
- F. COMPACT SUBGRADE TO 95% STANDARD PROCTOR DENSITY

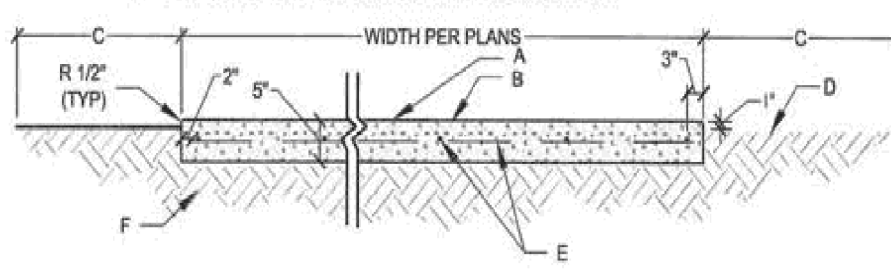

1 CONCRETE PAVING DETAIL
SCALE: 1/2" = 1'-0"

GENERAL NOTES:

1. LOCATE EXPANSION JOINTS ON MAXIMUM 40' CENTERS

CONSTRUCTION NOTES:

- A. #4 SMOOTH DOWEL 18" LONG EACH LUBRICATED, 10 PER JOINT @ 18" O.C. WITH CAP
- B. FILL EXPANSION JOINTS WITH SELF LEVELING URETHANE SEALANT. COLOR TO BE GRAY. INSTALL REDWOOD EXPANSION JOINT 1/2" BELOW FINISHED GRADE OF TRAIL.
- C. 5" CONCRETE PAVING WITH #3 BARS @ 18" O.C. BOTH WAYS

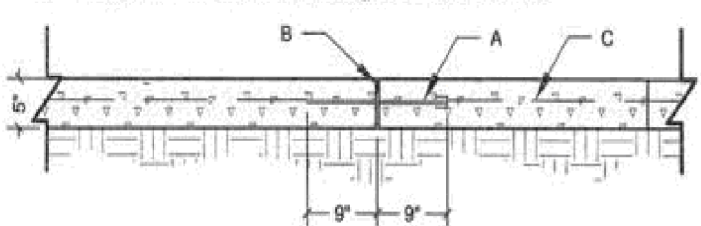

2 DOWELED EXPANSION JOINT
SCALE: 3/4" = 1'-0"

GENERAL NOTES:

- CONTROL JOINT SPACING SHALL BE WIDTH OF PAVING OR AS SHOWN ON THE PLANS.

CONSTRUCTION NOTES:

- A. SAWED CONTROL JOINTS 1" DEEP X 1/8" WIDE ON 10'-0" CENTERS MAX. OR AS SHOWN ON PLANS.
- B. 5" CONCRETE TRAIL WITH #3 BARS @ 18" O.C. BOTH WAYS

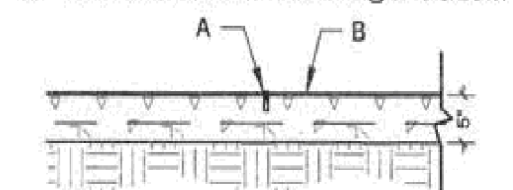

3 TYPICAL CONTROL JOINT
SCALE: 3/4" = 1'-0"

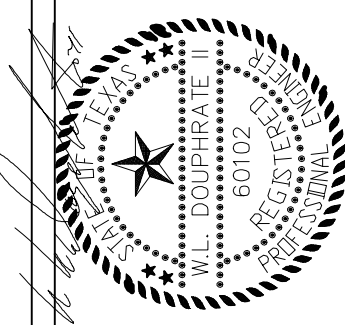
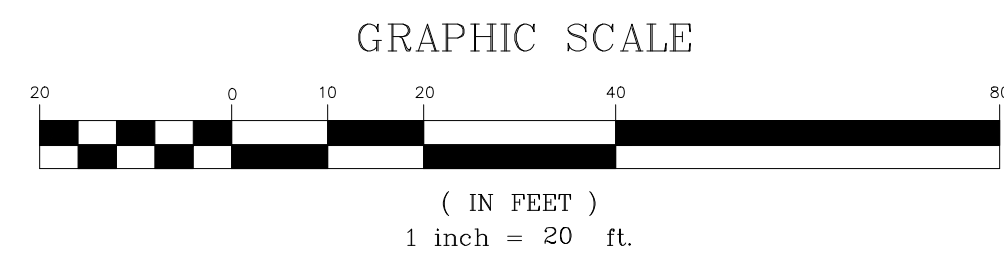

THE SEAL APPEARING ON THIS DOCUMENT WAS AUTHORIZED BY W.L. DOUPHRATE II, TEXAS P.E. LICENSE NO. 90102, EXPIRES ON DATE: OCT. 3, 2014

DOUPHRATE & ASSOCIATES, INC.
ENGINEERING • PROJECT MANAGEMENT • SURVEYING
2235 RIDGE RD., # 200 ROCKWALL, TEXAS 75087
PHONE: (972)771-9004 FAX: (972)771-9005

LEFT TURN LANE @ CARMEL & N. LAKESHORE DR.
LAKEVIEW SUMMIT PHASE 4
CITY OF ROCKWALL
ROCKWALL COUNTY, TEXAS

4-8-16 CONST. 15' RECESSED INLET AT END OF EXIST. LATERAL
4-8-16 REMOVE EXIST. INLET & PLUG LATERAL
REVISION

W.L.D. CHECKED
K.E.B. DRAWN
10/14 DATE
9919-4PV18 PROJECT
8/7 OF

CONTRACTOR TO VERIFY EXIST. 21" LATERAL AND CONSTRUCT 15' RECESSED INLET TC 526.47, FL 522.39
38 L.F. SAW-CUT
6.3 S.Y. CONC. REMOVAL
MATCH EXIST. CONC. PAVING

REMOVE EXIST. 15' RECESSED INLET PLUG EXIST. LATERAL
FL EX. 21" 522.50 PER ROCKWALL ELEMENTARY SCHOOL #9 PLANS

167 L.F. SAW CUT
REMOVE 36.1 S.Y. EXIST. CONC. CURB AND GUTTER
CONNECT TO EXIST. PAV. WITH LONGITUDINAL BUTT JOINT

285 L.F. SAW CUT
REMOVE 62.5 S.Y. EXIST. CONC. CURB AND GUTTER
CONNECT TO EXIST. PAV. WITH LONGITUDINAL BUTT JOINT
SEE BUTTON DETAIL SHEET 7.0

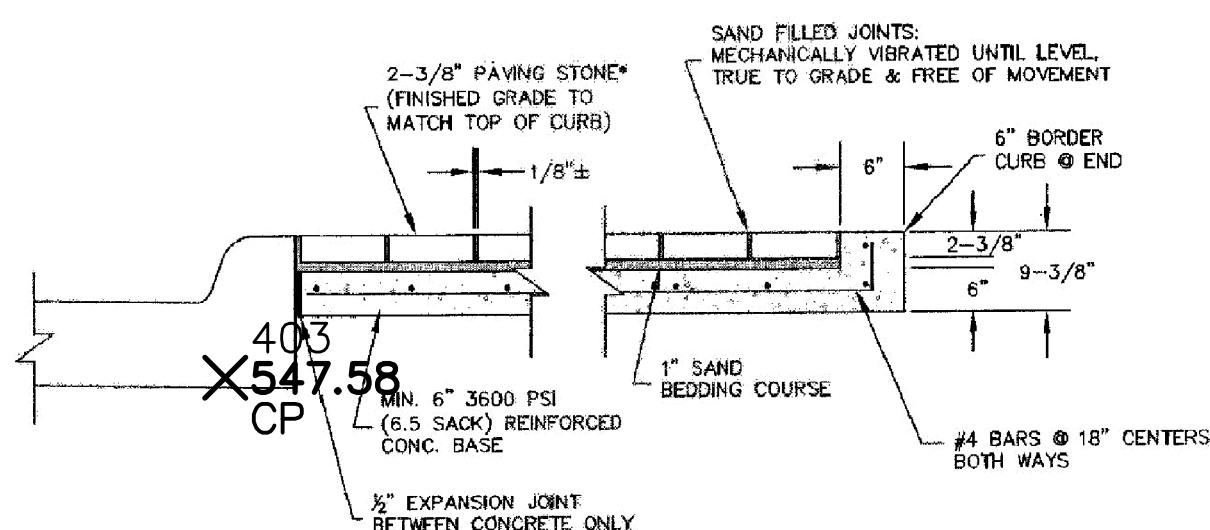

MEDIAN / BRICK PAVER CROSS SECTION
NOT TO SCALE

* PAVING STONE SHALL BE INTERLOCKING CONCRETE LANDSCAPE PAVERS. COLOR & PATTERN TO BE SELECTED BY OWNER.

REVISED TO CONFORM TO CONSTRUCTION RECORDS.
W. Douphrate
DATE: 12-1-16

BENCHMARKS:
BRASS CAP MONUMENT NO. 10 SET IN CONCRETE IN THE CENTER OF GRASS MEDIAN IN MASTERS DRIVE BETWEEN NORTH LAKESHORE & SHORES BLVD.
N 7032464.6317, E 2589554.1518
ELEV. = 524.62

