

LINE	LENGTH	BEARING
L1	197.51'	N14°33'14"W
L2	200.16'	N16°43'42"W
L3	200.22'	S11°34'31"E
L4	195.45'	S15°45'06"E
L5	195.45'	N12°49'04"W

CURVE	LENGTH	RADIUS	TANGENT	CH BRG	CH DIST	DELTA
C1	50.55	195.50	25.42	S21°37'42"E	50.41	14°48'55"
C2	50.55	195.50	25.42	N21°37'40"W	50.41	14°48'58"

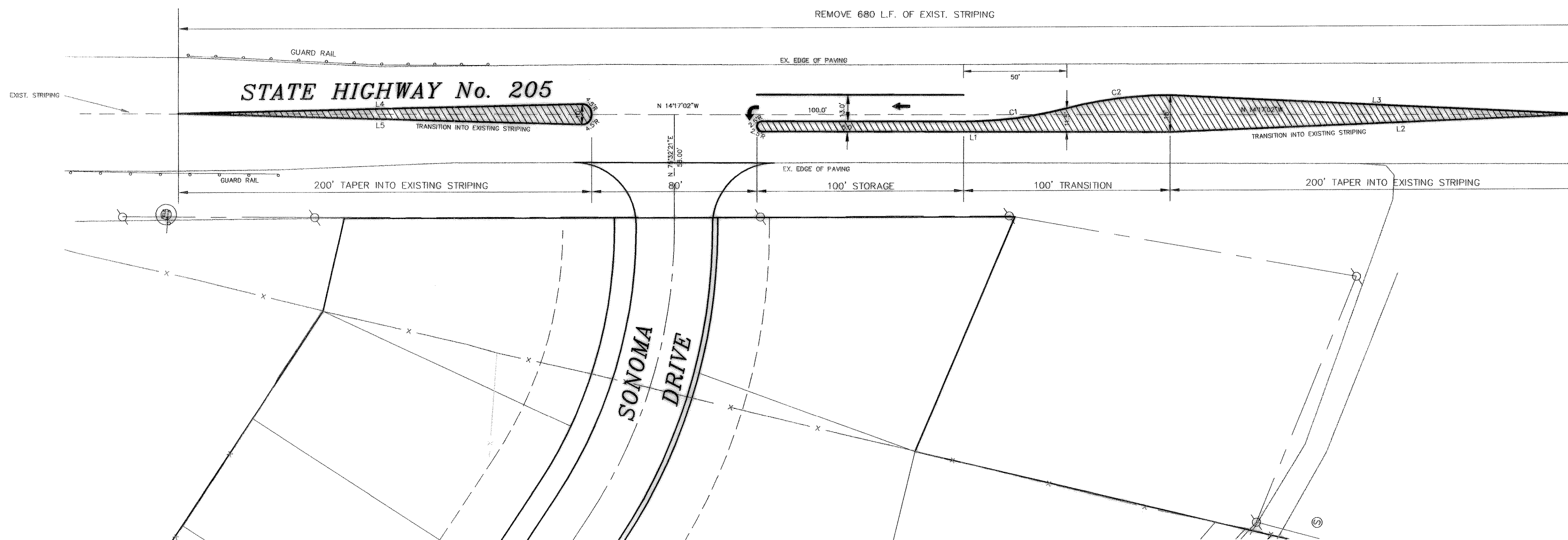

REVISED TO CONFORM TO CONSTRUCTION RECORDS.  
*W.L.D.*  
 DATE: 11-05-2002

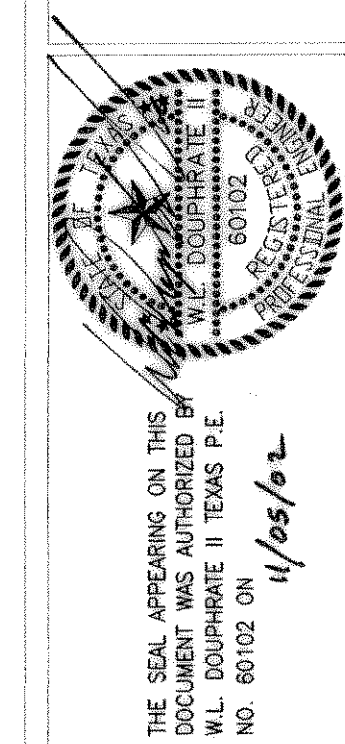

DOUPHRATE & ASSOCIATES, INC.  
 ENGINEERING • PROJECT MANAGEMENT • SURVEYING  
 2231 RIDGE RD., # 200 ROCKWALL, TEXAS 75087  
 PHONE: (972)771-9004 FAX: (972)771-9005

PLAN VIEW  
 LEFT TURN - SONOMA & HWY. 205  
 LAKEVIEW SUMMIT PHASE ONE  
 CITY OF ROCKWALL, ROCKWALL COUNTY, TEXAS

REVISED 80' OPENING 6/24/00  
 100' TRANSITION 5/22/00  
 REVISION

W.L.D.  
 CHECKED  
 K.E.B.  
 DRAWN  
 2/00  
 DATE  
 9919 N.TURNLANE  
 PROJECT

27A  
 OF  
 43