

GRAPHIC SCALE

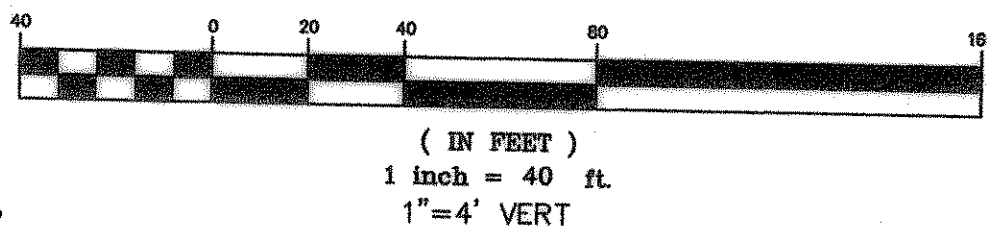

STA: 0+00 LN. "M" ~ CONST.
24" TYPE "B" HDWL. SKEWED 30°
& BEGIN 24" R.C.P.

LINE N

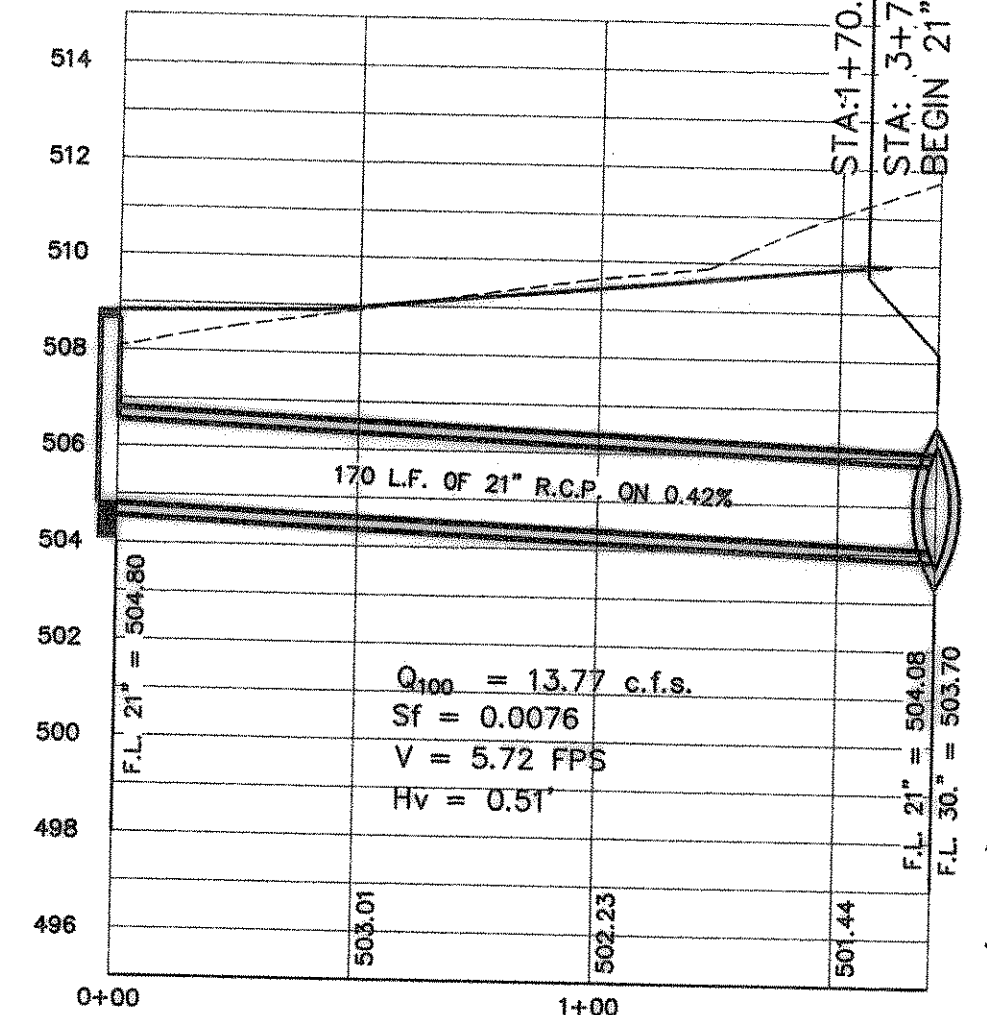

SECTION A - A

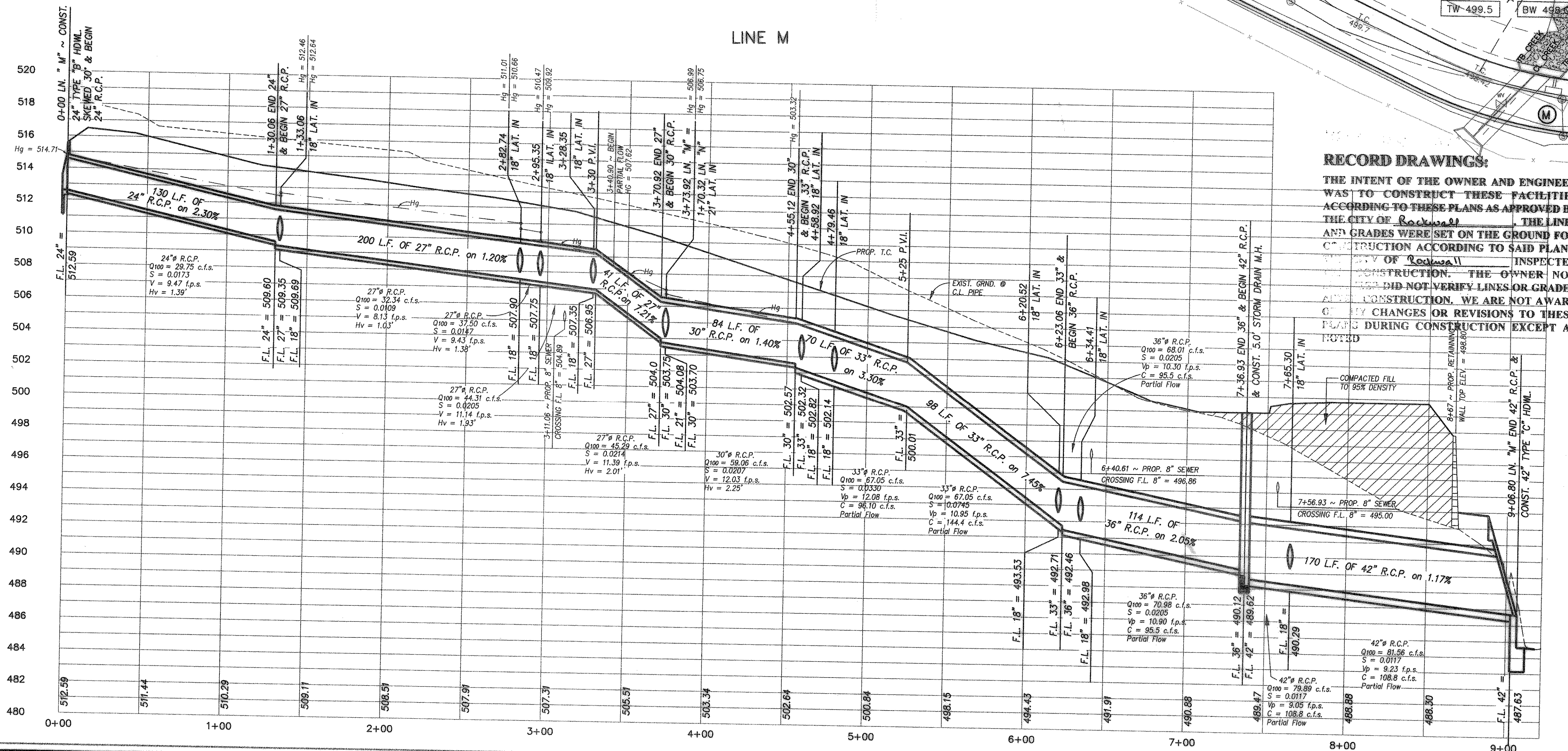
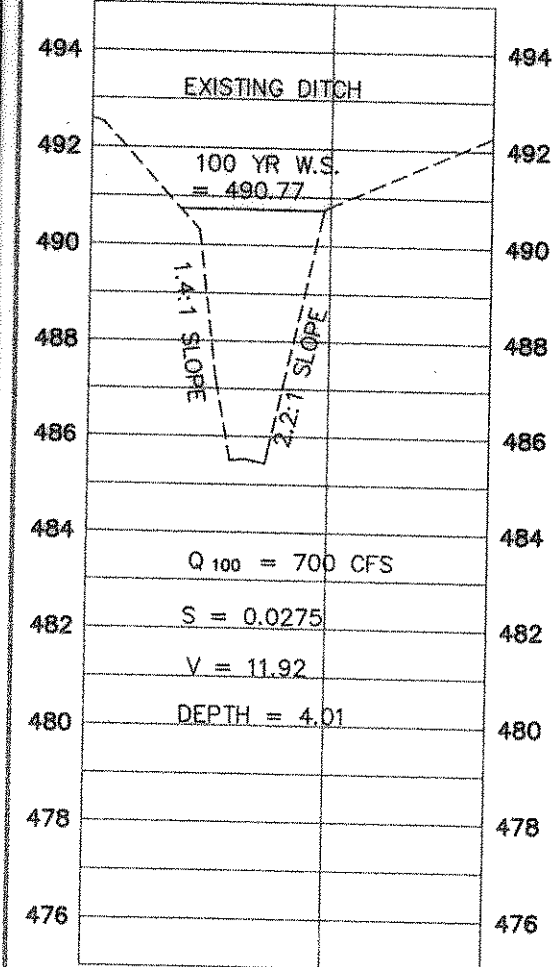

CURVE	LENGTH	RADIUS	TANGENT	CH BRG	CH DIST	DELTA
C1	61.70	100.00	31.86	S89°26'21"E	60.72	35°20'56"
C3	75.00	250.00	37.78	N82°30'06"W	74.72	17°11'19"
C4	28.41	250.00	14.22	S77°09'44"E	28.39	06°30'37"
C5	104.68	65.00	67.61	N34°17'25"W	93.71	92°15'14"
C7	39.09	350.00	19.56	N15°02'09"E	39.07	06°23'55"

LINE	LENGTH	BEARING
L2	80.00'	S88°54'14"W
L3	16.74'	S28°54'14"W
L4	33.96'	S25°05'37"E
L5	8.67'	N34°03'26"E
L11	37.57'	S02°06'12"E
L12	18.91'	S21°43'02"E
L14	39.84'	S31°05'46"E
L15	39.84'	S31°05'46"E
L16	37.09'	S19°42'16"E
L17	282.68'	N88°54'14"E
L18	80.24'	S73°54'26"E

INLET CHART

- INLET 12
5' CURB INLET
CL INLET = PAV: 1+26.00
TOP = 499.84
FL 18" = 495.84
Q 100 = 1.67
- INLET 11
10' CURB INLET
CL INLET = PAV: 1+26.00
TOP = 499.84
FL 18" = 495.84
Q 100 = 8.91
- INLET 10
10' CURB INLET
CL INLET = PAV: 23+92.12
TOP = 503.29
FL 18" = 499.29
Q 100 = 5.19
- INLET 9
5' CURB INLET
CL INLET = PAV: 23+90.75
TOP = 503.31
FL 18" = 499.31
Q 100 = 2.97
- INLET 3
10' CURB INLET
CL INLET = PAV: 20+52.33
TOP = 512.51
FL 18" = 508.51
Q 100 = 5.16
- INLET 1
10' CURB INLET
CL INLET = PAV: 11+41.35
TOP = 508.80
THROAT = 507.50
FL 21" = 504.80
Q 100 = 13.77
- INLET 7
10' CURB INLET
CL INLET = PAV: 0+40.46
TOP = 507.12
FL 18" = 503.12
Q 100 = 5.44
- INLET 8
10' CURB INLET
CL INLET = PAV: 22+27.62
TOP = 507.92
FL 18" = 503.92
Q 100 = 2.55
- INLET 6
CONST. 4 GRATE COMBO. INLET
5' CURB INLET
CL INLET = PAV: 515.64
FL 18" = 509.64
Q 100 = 0.98
- INLET 5
15' CURB INLET
CL INLET = PAV: 0+42.0
TOP = 513.79
FL 18" = 509.79
Q 100 = 6.81
- INLET 4
CONST. 4 GRATE COMBO. INLET
CL INLET = PAV: 0+40.15
TOP = 516.53
FL 18" = 512.53
Q 100 = 2.59
- INLET 13
CONST. 10' CURB INLET
CL INLET = PAV: 27+54.57
TOP = 498.22
FL 18" = 494.22
Q 100 = 5.73

RECORD DRAWINGS:

THE INTENT OF THE OWNER AND ENGINEER WAS TO CONSTRUCT THESE FACILITIES ACCORDING TO THESE PLANS AS APPROVED BY THE CITY OF ROCKWALL. THE LINES AND GRADES WERE SET ON THE GROUND FOR CONSTRUCTION ACCORDING TO SAID PLANS. THE CITY OF ROCKWALL INSPECTED THE CONSTRUCTION. THE OWNER NOR ENGINEER DID NOT VERIFY LINES OR GRADES AFTER CONSTRUCTION. WE ARE NOT AWARE OF ANY CHANGES OR REVISIONS TO THESE PLANS DURING CONSTRUCTION EXCEPT AS NOTED.



DOUPHRATE & ASSOCIATES, INC.
ENGINEERING • PROJECT MANAGEMENT • SURVEYING
2235 RIDGE RD., # 200 ROCKWALL, TEXAS 75087
PHONE: (972)771-9004 FAX: (972)771-9005

STORM SEWER PLAN & PROFILE
LINES M & N
LAKEVIEW SUMMIT, PHASE ONE
CITY OF ROCKWALL, ROCKWALL COUNTY, TEXAS

REVISION	DATE	PROJECT
1. REVISED AS PER CITY OF ROCKWALL REVISIONS 7/3/00		
2. ADDED EXISTING WELL & 6" PERFORATED FRENCH DRAIN ON EACH SIDE OF 24" R.C.P.	12/1/00	
W.L.D.	2/8/00	9919STMH
CHECKED		
DRAWN		
DATE		
PROJECT		
40		
OF		
42		